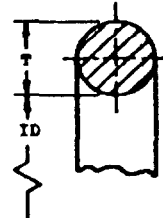
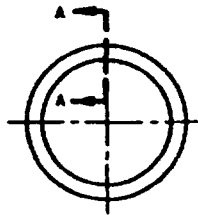

MS9967FED SUP CLASS
5330

SECTION A-A

PART NUMBER	ID IN.		ID (mm)		T IN.		T (mm)		APPROX MASS	
	MIN	MAX	MIN	MAX	MIN	MAX	MIN	MAX	LB/100	kg/100
MS9967-001	0.925	0.933	0.935	0.938	0.037	0.043	0.940	1.092	.0015	0.0007
MS9967-002	0.938	0.946	0.965	1.168	0.047	0.053	1.194	1.346	.003	0.0014
MS9967-003	0.952	0.960	1.321	1.324	0.057	0.063	1.448	1.600	.005	0.0023
MS9967-004	0.965	0.975	1.65	1.99	0.067	0.073	1.702	1.854	.008	0.0036
MS9967-005	0.996	1.196	2.44	2.69	0.067	0.073	1.702	1.854	.010	0.0045
MS9967-006	0.109	0.119	2.77	3.02	0.067	0.073	1.702	1.854	.011	0.005
MS9967-007	0.140	0.150	3.56	3.81	0.067	0.073	1.702	1.854	.013	0.006
MS9967-008	0.171	0.181	4.34	4.60	0.067	0.073	1.702	1.854	.015	0.007
MS9967-009	0.203	0.213	5.16	5.41	0.067	0.073	1.702	1.854	.017	0.008
MS9967-010	0.234	0.244	5.94	6.20	0.067	0.073	1.702	1.854	.018	0.008
MS9967-011	0.296	0.306	7.52	7.77	0.067	0.073	1.702	1.854	.022	0.010
MS9967-012	0.359	0.369	9.12	9.37	0.067	0.073	1.702	1.854	.025	0.011
MS9967-013	0.421	0.431	10.69	10.95	0.067	0.073	1.702	1.854	.029	0.013
MS9967-014	0.484	0.494	12.29	12.55	0.067	0.073	1.702	1.854	.033	0.015
MS9967-015	0.546	0.556	13.87	14.12	0.067	0.073	1.702	1.854	.037	0.017
MS9967-016	0.609	0.619	15.47	15.72	0.067	0.073	1.702	1.854	.040	0.018
MS9967-017	0.671	0.681	17.04	17.30	0.067	0.073	1.702	1.854	.044	0.020
MS9967-018	0.734	0.744	18.64	18.90	0.067	0.073	1.702	1.854	.048	0.022
MS9967-019	0.795	0.805	20.19	20.50	0.067	0.073	1.702	1.854	.051	0.023
MS9967-020	0.858	0.870	21.79	22.10	0.067	0.073	1.702	1.854	.055	0.025
MS9967-021	0.929	0.932	23.37	23.67	0.067	0.073	1.702	1.854	.059	0.027
MS9967-022	0.983	0.995	24.97	25.27	0.067	0.073	1.702	1.854	.062	0.028
MS9967-023	1.045	1.057	26.54	26.85	0.067	0.073	1.702	1.854	.066	0.030
MS9967-024	1.108	1.120	28.14	28.45	0.067	0.073	1.702	1.854	.070	0.030
MS9967-025	1.170	1.182	29.72	30.02	0.067	0.073	1.702	1.854	.074	0.034
MS9967-026	1.233	1.245	31.32	31.62	0.067	0.073	1.702	1.854	.077	0.035
MS9967-027	1.295	1.307	32.89	33.25	0.067	0.073	1.702	1.854	.083	0.038
MS9967-028	1.358	1.370	34.49	34.84	0.067	0.073	1.702	1.854	.085	0.038
MS9967-029	1.420	1.432	36.07	36.47	0.067	0.073	1.702	1.854	.092	0.042
MS9967-030	1.484	1.496	40.74	41.25	0.067	0.073	1.702	1.854	.100	0.045
MS9967-031	1.729	1.749	43.92	44.42	0.067	0.073	1.702	1.854	.107	0.048
MS9967-032	1.854	1.874	47.09	47.60	0.067	0.073	1.702	1.854	.115	0.052
MS9967-033	1.979	1.999	50.27	50.77	0.067	0.073	1.702	1.854	.122	0.055
MS9967-034	2.104	2.124	53.44	53.95	0.067	0.073	1.702	1.854	.129	0.058
MS9967-035	2.229	2.249	56.62	57.12	0.067	0.073	1.702	1.854	.137	0.062
MS9967-036	2.354	2.374	59.79	60.30	0.067	0.073	1.702	1.854	.144	0.065
MS9967-037	2.479	2.499	62.97	63.47	0.067	0.073	1.702	1.854	.151	0.068
MS9967-038	2.604	2.624	66.14	66.65	0.067	0.073	1.702	1.854	.159	0.072
MS9967-039	2.724	2.754	69.19	69.95	0.067	0.073	1.702	1.854	.166	0.075
MS9967-040	2.849	2.879	72.36	73.13	0.067	0.073	1.702	1.854	.174	0.079
MS9967-041	2.974	3.004	75.54	76.30	0.067	0.073	1.702	1.854	.181	0.082
MS9967-042	3.224	3.254	81.89	82.65	0.067	0.073	1.702	1.854	.196	0.089
MS9967-043	3.474	3.504	88.24	89.00	0.067	0.073	1.702	1.854	.210	0.095
MS9967-044	3.724	3.754	94.59	95.35	0.067	0.073	1.702	1.854	.225	0.102
MS9967-045	3.974	4.004	100.94	101.70	0.067	0.073	1.702	1.854	.240	0.109
MS9967-046	4.224	4.254	107.29	108.05	0.067	0.073	1.702	1.854	.255	0.116
MS9967-047	4.474	4.504	113.64	114.40	0.067	0.073	1.702	1.854	.270	0.122
MS9967-048	4.724	4.754	119.99	120.75	0.067	0.073	1.702	1.854	.285	0.129
MS9967-049	4.964	5.012	126.14	127.30	0.067	0.073	1.702	1.854	.300	0.136
MS9967-050	5.214	5.262	132.49	133.65	0.067	0.073	1.702	1.854	.314	0.142
MS9967-102	0.044	0.054	1.12	1.37	0.100	0.106	2.540	2.692	.020	0.010
MS9967-103	0.076	0.086	1.93	2.18	0.100	0.106	2.540	2.692	.024	0.011
MS9967-104	0.107	0.117	2.72	2.97	0.100	0.106	2.540	2.692	.028	0.013
MS9967-105	0.138	0.148	3.51	3.76	0.100	0.106	2.540	2.692	.032	0.015

Review activities:
Navy - AS
Air Force - 82

This standard has been approved by the Dept. of the Air Force (AF) and the Department of the Navy (AS) and is mandatory for use by that activity. All other military activities are required to comply with standard where applicable.

P. A. Air Force-11 Other Cost	INTERNATIONAL INTEREST	TITLE	MILITARY STANDARD
Navy - AS	ABCC 17/27	PACKING, PREPARED - AMS 7273, 'O' RING	MS9967
PROCUREMENT SPECIFICATION NONE	SUPERSEDES:	SHEET 1 OF 7	

DD FORM 672-1 (Limited circulation)

UTION OF 1 COPY MAY BE USED.

APPROVED 22 Dec 71 REVISED

MS9967

FED SUP CLASS
5330

PART NUMBER	ID IN.		ID (mm)		T IN.		T (mm)		APPROX MASS	
	MIN	MAX	MIN	MAX	MIN	MAX	MIN	MAX	LB/100	KG/100
MS9967-106	0.160	0.170	4.29	4.55	0.100	0.104	2.540	2.692	.036	0.016
MS9967-107	0.201	0.211	5.11	5.34	0.100	0.104	2.540	2.692	.040	0.018
MS9967-108	0.232	0.242	5.89	6.15	0.100	0.104	2.540	2.692	.044	0.020
MS9967-109	0.294	0.304	7.47	7.72	0.100	0.104	2.540	2.692	.051	0.023
MS9967-110	0.357	0.367	9.07	9.32	0.100	0.104	2.540	2.692	.060	0.027
MS9967-111	0.419	0.429	10.64	10.90	0.100	0.104	2.540	2.692	.068	0.031
MS9967-112	0.482	0.492	12.24	12.50	0.100	0.104	2.540	2.692	.075	0.034
MS9967-113	0.544	0.554	13.82	14.07	0.100	0.104	2.540	2.692	.084	0.038
MS9967-114	0.607	0.617	15.42	15.67	0.100	0.104	2.540	2.692	.092	0.042
MS9967-115	0.669	0.679	16.99	17.25	0.100	0.104	2.540	2.692	.099	0.045
MS9967-116	0.732	0.742	18.59	18.85	0.100	0.104	2.540	2.692	.108	0.049
MS9967-117	0.793	0.803	20.14	20.43	0.100	0.104	2.540	2.692	.116	0.053
MS9967-118	0.854	0.864	21.74	22.05	0.100	0.104	2.540	2.692	.124	0.056
MS9967-119	0.918	0.930	23.32	23.62	0.100	0.104	2.540	2.692	.132	0.060
MS9967-120	0.981	0.993	24.92	25.22	0.100	0.104	2.540	2.692	.140	0.064
MS9967-121	1.043	1.055	26.49	26.80	0.100	0.104	2.540	2.692	.148	0.067
MS9967-122	1.106	1.118	28.09	28.40	0.100	0.104	2.540	2.692	.156	0.071
MS9967-123	1.168	1.180	29.67	29.97	0.100	0.104	2.540	2.692	.164	0.074
MS9967-124	1.231	1.243	31.27	31.57	0.100	0.104	2.540	2.692	.172	0.078
MS9967-125	1.293	1.305	32.84	33.15	0.100	0.104	2.540	2.692	.180	0.082
MS9967-126	1.356	1.368	34.44	34.75	0.100	0.104	2.540	2.692	.188	0.085
MS9967-127	1.418	1.430	36.02	36.32	0.100	0.104	2.540	2.692	.196	0.089
MS9967-128	1.481	1.493	37.62	37.92	0.100	0.104	2.540	2.692	.204	0.092
MS9967-129	1.543	1.555	39.20	39.48	0.100	0.104	2.540	2.692	.212	0.096
MS9967-130	1.606	1.622	40.79	41.20	0.100	0.104	2.540	2.692	.220	0.100
MS9967-131	1.668	1.684	42.37	42.77	0.100	0.104	2.540	2.692	.228	0.103
MS9967-132	1.729	1.747	43.97	44.37	0.100	0.104	2.540	2.692	.236	0.107
MS9967-133	1.789	1.809	45.54	45.95	0.100	0.104	2.540	2.692	.244	0.111
MS9967-134	1.852	1.872	47.04	47.55	0.100	0.104	2.540	2.692	.252	0.114
MS9967-135	1.915	1.935	48.64	49.15	0.100	0.104	2.540	2.692	.260	0.118
MS9967-136	1.977	1.997	50.22	50.72	0.100	0.104	2.540	2.692	.268	0.122
MS9967-137	2.040	2.060	51.82	52.32	0.100	0.104	2.540	2.692	.276	0.125
MS9967-138	2.102	2.122	53.39	53.90	0.100	0.104	2.540	2.692	.284	0.129
MS9967-139	2.165	2.185	54.99	55.50	0.100	0.104	2.540	2.692	.292	0.132
MS9967-140	2.227	2.247	56.57	57.07	0.100	0.104	2.540	2.692	.300	0.136
MS9967-141	2.290	2.310	58.17	58.67	0.100	0.104	2.540	2.692	.308	0.140
MS9967-142	2.352	2.372	59.74	60.25	0.100	0.104	2.540	2.692	.316	0.143
MS9967-143	2.415	2.435	61.34	61.85	0.100	0.104	2.540	2.692	.324	0.147
MS9967-144	2.477	2.497	62.92	63.42	0.100	0.104	2.540	2.692	.332	0.151
MS9967-145	2.540	2.560	64.52	65.02	0.100	0.104	2.540	2.692	.340	0.154
MS9967-146	2.602	2.622	66.09	66.60	0.100	0.104	2.540	2.692	.348	0.158
MS9967-147	2.664	2.684	67.56	68.07	0.100	0.104	2.540	2.692	.356	0.161
MS9967-148	2.727	2.752	69.14	69.90	0.100	0.104	2.540	2.692	.364	0.165
MS9967-149	2.789	2.815	70.74	71.50	0.100	0.104	2.540	2.692	.372	0.169
MS9967-150	2.847	2.877	72.31	73.08	0.100	0.104	2.540	2.692	.381	0.173
MS9967-151	2.912	2.942	73.89	74.65	0.100	0.104	2.540	2.692	.396	0.180
MS9967-152	2.972	2.992	75.44	76.20	0.100	0.104	2.540	2.692	.408	0.184
MS9967-153	3.032	3.052	76.99	77.75	0.100	0.104	2.540	2.692	.420	0.189
MS9967-154	3.092	3.112	78.54	79.30	0.100	0.104	2.540	2.692	.432	0.193
MS9967-155	3.152	3.172	80.09	80.85	0.100	0.104	2.540	2.692	.444	0.197
MS9967-156	4.222	4.252	107.24	108.00	0.100	0.104	2.540	2.692	.556	0.252
MS9967-157	4.282	4.312	108.79	109.55	0.100	0.104	2.540	2.692	.568	0.256
MS9967-158	4.342	4.372	110.34	111.10	0.100	0.104	2.540	2.692	.580	0.260
MS9967-159	4.402	4.432	111.89	112.65	0.100	0.104	2.540	2.692	.592	0.264
MS9967-160	4.462	4.492	113.44	114.20	0.100	0.104	2.540	2.692	.604	0.268

Review activities:
NAVY - AS
Air Force - 82

This standard has been prepared by the Dept. of the Air Force (D) and the Department of the Navy (N) and is mandatory for use by all military activities in support of the standard shown herein.

P.A. Air Force - II Other Code Navy - AS	INTERNATIONAL INTEREST ASCC 17/27	TITLE PACKING, PREFORMED - AMS 7273, 'O' RING	MILITARY STANDARD MS9967
PROCUREMENT SPECIFICATION NONE	SUPERSEDES:	SHEET 2 OF	

DD FORM 672-1 (Limited coordination)

REVISION OF 1 SEP 67 MAY BE USED.

APPROVED 22 Dec 71 REVISED

MS9967

FED. SUP CLASS
5330

PART NUMBER	ID IN.		ID (mm)		T IN.		T (mm)		APPROX MASS	
	MIN	MAX	MIN	MAX	MIN	MAX	MIN	MAX	LB/100	KG/100
MS9967-161	5.464	5.510	138.79	139.95	0.100	0.104	2.540	2.692	.718	0.326
MS9967-162	5.714	5.760	145.14	146.30	0.100	0.104	2.540	2.692	.749	0.340
MS9967-163	5.964	6.010	151.49	152.65	0.100	0.104	2.540	2.692	.782	0.355
MS9967-164	6.214	6.260	157.84	159.00	0.100	0.104	2.540	2.692	.812	0.368
MS9967-165	6.464	6.510	164.19	165.35	0.100	0.104	2.540	2.692	.845	0.383
MS9967-166	6.714	6.760	170.54	171.70	0.100	0.104	2.540	2.692	.876	0.397
MS9967-167	6.964	7.010	176.89	178.05	0.100	0.104	2.540	2.692	.910	0.413
MS9967-168	7.207	7.267	183.06	184.56	0.100	0.106	2.540	2.692	.941	0.427
MS9967-169	7.457	7.517	189.41	190.93	0.100	0.106	2.540	2.692	.974	0.442
MS9967-170	7.707	7.767	195.76	197.28	0.100	0.106	2.540	2.692	1.015	0.460
MS9967-171	7.957	8.017	202.11	203.63	0.100	0.106	2.540	2.692	1.035	0.470
MS9967-172	8.207	8.267	208.46	209.98	0.100	0.106	2.540	2.692	1.070	0.486
MS9967-173	8.457	8.517	214.81	216.33	0.100	0.106	2.540	2.692	1.101	0.500
MS9967-174	8.707	8.767	221.16	222.68	0.100	0.106	2.540	2.692	1.132	0.514
MS9967-175	8.957	9.017	227.51	229.03	0.100	0.106	2.540	2.692	1.163	0.528
MS9967-176	9.207	9.267	233.86	235.38	0.100	0.106	2.540	2.692	1.199	0.544
MS9967-177	9.457	9.517	240.21	241.73	0.100	0.106	2.540	2.692	1.230	0.558
MS9967-178	9.707	9.767	246.56	248.08	0.100	0.106	2.540	2.692	1.260	0.572
MS9967-201	0.164	0.176	4.22	4.47	0.135	0.143	3.429	3.632	.073	0.033
MS9967-202	0.229	0.239	5.82	6.07	0.135	0.143	3.429	3.632	.088	0.040
MS9967-203	0.291	0.301	7.39	7.65	0.135	0.143	3.429	3.632	.102	0.046
MS9967-204	0.354	0.364	8.99	9.25	0.135	0.143	3.429	3.632	.117	0.053
MS9967-205	0.416	0.426	10.57	10.82	0.135	0.143	3.429	3.632	.132	0.060
MS9967-206	0.479	0.489	12.17	12.42	0.135	0.143	3.429	3.632	.147	0.067
MS9967-207	0.541	0.551	13.76	14.00	0.135	0.143	3.429	3.632	.161	0.073
MS9967-208	0.604	0.614	15.36	15.60	0.135	0.143	3.429	3.632	.176	0.080
MS9967-209	0.666	0.676	16.92	17.17	0.135	0.143	3.429	3.632	.191	0.087
MS9967-210	0.728	0.740	18.49	18.80	0.135	0.143	3.429	3.632	.204	0.092
MS9967-211	0.790	0.802	20.07	20.37	0.135	0.143	3.429	3.632	.219	0.099
MS9967-212	0.853	0.865	21.67	21.97	0.135	0.143	3.429	3.632	.233	0.106
MS9967-213	0.915	0.927	23.24	23.55	0.135	0.143	3.429	3.632	.248	0.112
MS9967-214	0.978	0.990	24.84	25.15	0.135	0.143	3.429	3.632	.262	0.119
MS9967-215	1.040	1.052	26.42	26.72	0.135	0.143	3.429	3.632	.277	0.126
MS9967-216	1.103	1.115	28.02	28.32	0.135	0.143	3.429	3.632	.292	0.132
MS9967-217	1.165	1.177	29.59	29.90	0.135	0.143	3.429	3.632	.306	0.139
MS9967-218	1.228	1.240	31.19	31.50	0.135	0.143	3.429	3.632	.322	0.146
MS9967-219	1.290	1.302	32.77	33.07	0.135	0.143	3.429	3.632	.335	0.152
MS9967-220	1.353	1.365	34.37	34.67	0.135	0.143	3.429	3.632	.350	0.159
MS9967-221	1.415	1.427	35.94	36.25	0.135	0.143	3.429	3.632	.364	0.165
MS9967-222	1.478	1.490	37.54	37.85	0.135	0.143	3.429	3.632	.379	0.172
MS9967-223	1.540	1.610	40.61	41.12	0.135	0.143	3.429	3.632	.408	0.185
MS9967-224	1.724	1.744	43.79	44.30	0.135	0.143	3.429	3.632	.437	0.198
MS9967-225	1.849	1.869	46.94	47.47	0.135	0.143	3.429	3.632	.466	0.211
MS9967-226	1.994	1.994	50.14	50.65	0.135	0.143	3.429	3.632	.496	0.225
MS9967-227	2.099	2.119	53.31	53.82	0.135	0.143	3.429	3.632	.526	0.239
MS9967-228	2.224	2.244	56.49	57.00	0.135	0.143	3.429	3.632	.555	0.252
MS9967-229	2.349	2.369	59.66	60.17	0.135	0.143	3.429	3.632	.585	0.265
MS9967-230	2.474	2.494	62.84	63.35	0.135	0.143	3.429	3.632	.612	0.278
MS9967-231	2.599	2.619	66.01	66.52	0.135	0.143	3.429	3.632	.642	0.291
MS9967-232	2.719	2.749	69.06	69.62	0.135	0.143	3.429	3.632	.671	0.304
MS9967-233	2.844	2.874	72.24	73.00	0.135	0.143	3.429	3.632	.700	0.318
MS9967-234	2.969	2.999	75.41	76.17	0.135	0.143	3.429	3.632	.730	0.331
MS9967-235	3.094	3.124	78.59	79.35	0.135	0.143	3.429	3.632	.758	0.344

Review activities:
None-AS
Air Force-02

This standard has been approved by the Dept. of the Air Force (AF) and the Department of the Navy (NAV) and is mandatory for use by all military activities. All other military activities are required to supply this standard when suitable.

P.A. Air Force-11 Other Code Navy-AS	INTERNATIONAL INTEREST	TITLE PACKING, PREPARED - AMS 7273, 'O' RING	MILITARY STANDARD
	ASCC 17/27		MS9967
PROCUREMENT SPECIFICATION NONE		SUPERSEDES:	SHEET 3 OF

DD FORM 672-1 (Limited circulation)

EDITION OF 1 SEP 71 MAY BE USED

APPROVED 22 Dec 71 REVISED

MS9967

FED SUP CLASS
5330Review extraction
Navy - AS
Air Force - 82This standard has been approved by the Dept. of the Air Force
Department of the Navy 2885 and is mandatory for use by
their activity. All other military activities are required
to employ this standard where applicable.

PART NUMBER	ID IN.		ID (mm)		T IN.		T (mm)		APPROX MASS	
	MIN	MAX	MIN	MAX	MIN	MAX	MIN	MAX	LB/100	kg/100
MS9967-236	3.219	3.249	81.76	82.52	0.135	0.143	3.429	3.632	.788	0.357
MS9967-237	3.344	3.374	84.94	85.70	0.135	0.143	3.429	3.632	.816	0.370
MS9967-238	3.469	3.499	88.11	88.87	0.135	0.143	3.429	3.632	.845	0.383
MS9967-239	3.594	3.624	91.29	92.05	0.135	0.143	3.429	3.632	.876	0.397
MS9967-240	3.719	3.749	94.46	95.22	0.135	0.143	3.429	3.632	.905	0.411
MS9967-241	3.844	3.874	97.64	98.40	0.135	0.143	3.429	3.632	.935	0.424
MS9967-242	3.969	3.999	100.81	101.57	0.135	0.143	3.429	3.632	.964	0.437
MS9967-243	4.094	4.124	103.99	104.75	0.135	0.143	3.429	3.632	.994	0.451
MS9967-244	4.219	4.249	107.16	107.92	0.135	0.143	3.429	3.632	1.021	0.463
MS9967-245	4.344	4.374	110.34	111.10	0.135	0.143	3.429	3.632	1.050	0.477
MS9967-246	4.469	4.499	113.51	114.27	0.135	0.143	3.429	3.632	1.080	0.490
MS9967-247	4.594	4.624	116.69	117.45	0.135	0.143	3.429	3.632	1.110	0.504
MS9967-248	4.719	4.749	119.86	120.62	0.135	0.143	3.429	3.632	1.138	0.516
MS9967-249	4.844	4.874	123.04	123.80	0.135	0.143	3.429	3.632	1.170	0.531
MS9967-250	4.969	4.999	126.21	126.97	0.135	0.143	3.429	3.632	1.200	0.545
MS9967-251	5.094	5.124	129.38	130.15	0.135	0.143	3.429	3.632	1.228	0.557
MS9967-252	5.219	5.257	132.56	133.33	0.135	0.143	3.429	3.632	1.257	0.571
MS9967-253	5.344	5.382	135.73	136.50	0.135	0.143	3.429	3.632	1.286	0.584
MS9967-254	5.469	5.507	138.91	139.68	0.135	0.143	3.429	3.632	1.315	0.597
MS9967-255	5.594	5.632	142.08	142.85	0.135	0.143	3.429	3.632	1.344	0.609
MS9967-256	5.719	5.757	145.26	146.03	0.135	0.143	3.429	3.632	1.373	0.623
MS9967-257	5.844	5.882	148.43	149.20	0.135	0.143	3.429	3.632	1.400	0.636
MS9967-258	5.969	6.007	151.61	152.38	0.135	0.143	3.429	3.632	1.430	0.649
MS9967-259	6.094	6.257	154.78	155.55	0.135	0.143	3.429	3.632	1.458	0.665
MS9967-260	6.219	6.507	157.96	158.73	0.135	0.143	3.429	3.632	1.488	0.675
MS9967-261	6.344	6.797	161.13	161.90	0.135	0.143	3.429	3.632	1.517	0.702
MS9967-262	6.469	6.907	164.31	165.08	0.135	0.143	3.429	3.632	1.547	0.702
MS9967-263	6.594	7.032	167.48	168.25	0.135	0.143	3.429	3.632	1.576	0.715
MS9967-264	6.719	7.157	170.66	171.43	0.135	0.143	3.429	3.632	1.605	0.730
MS9967-265	6.844	7.282	173.83	174.60	0.135	0.143	3.429	3.632	1.635	0.744
MS9967-266	6.969	7.407	177.01	177.78	0.135	0.143	3.429	3.632	1.664	0.758
MS9967-267	7.094	7.532	180.18	180.95	0.135	0.143	3.429	3.632	1.694	0.772
MS9967-268	7.219	7.657	183.36	184.13	0.135	0.143	3.429	3.632	1.723	0.786
MS9967-269	7.344	7.782	186.53	187.30	0.135	0.143	3.429	3.632	1.753	0.799
MS9967-270	7.469	7.907	189.71	190.48	0.135	0.143	3.429	3.632	1.782	0.813
MS9967-271	7.594	8.032	192.88	193.65	0.135	0.143	3.429	3.632	1.812	0.827
MS9967-272	7.719	8.157	196.06	196.83	0.135	0.143	3.429	3.632	1.841	0.841
MS9967-273	7.844	8.282	199.23	199.99	0.135	0.143	3.429	3.632	1.871	0.854
MS9967-274	7.969	8.407	202.41	203.18	0.135	0.143	3.429	3.632	1.900	0.868
MS9967-275	8.094	8.532	205.58	206.35	0.135	0.143	3.429	3.632	1.930	0.881
MS9967-276	8.219	8.657	208.76	209.53	0.135	0.143	3.429	3.632	1.959	0.895
MS9967-277	8.344	8.782	211.93	212.70	0.135	0.143	3.429	3.632	1.989	0.908
MS9967-278	8.469	8.907	215.11	215.88	0.135	0.143	3.429	3.632	2.018	0.922
MS9967-279	8.594	9.032	218.28	219.05	0.135	0.143	3.429	3.632	2.048	0.935
MS9967-280	8.719	9.157	221.46	222.23	0.135	0.143	3.429	3.632	2.077	0.949
MS9967-281	8.844	9.282	224.63	225.40	0.135	0.143	3.429	3.632	2.107	0.962
MS9967-282	8.969	9.407	227.81	228.58	0.135	0.143	3.429	3.632	2.136	0.976
MS9967-283	9.094	9.532	230.98	231.75	0.135	0.143	3.429	3.632	2.166	0.989
MS9967-284	9.219	9.657	234.16	234.93	0.135	0.143	3.429	3.632	2.195	1.003
MS9967-309	0.447	0.417	10.34	10.59	0.205	0.215	5.21	5.46	.332	0.151
MS9967-310	0.470	0.440	11.94	12.19	0.205	0.215	5.21	5.46	.365	0.166
MS9967-311	0.532	0.542	13.31	13.77	0.205	0.215	5.21	5.46	.398	0.181
MS9967-312	0.595	0.675	15.11	15.37	0.205	0.215	5.21	5.46	.432	0.196
MS9967-313	0.657	0.667	16.69	16.94	0.205	0.215	5.21	5.46	.465	0.211

APPROVED 22 Dec 71 REVISED

P. A. Air Force - II Other Cost	INTERNATIONAL INTEREST	TITLE	MILITARY STANDARD
Navy - AS	ASCC 17/27	PACKING, PREFORMED - ANG 7473, 'O' RING	MS9967
PROCUREMENT SPECIFICATION NONE	SUPERSEDES:	SHEET 1 OF	

DD FORM 672-1 (Limited circulation)

EDITION OF 1 SEP 67 MAY BE USED

MS9967

FED SUP CLASS
5330

PART NUMBER	ID IN.		ID (mm)		T IN.		T (mm)		APPROX MASS	
	MIN	MAX	MIN	MAX	MIN	MAX	MIN	MAX	LB./100	kg./100
MS9967-314	0.719	0.731	18.26	18.57	0.205	0.215	5.21	5.44	.498	0.226
MS9967-315	0.761	0.793	19.64	20.14	0.205	0.215	5.21	5.44	.532	0.241
MS9967-316	0.844	0.896	21.44	21.74	0.205	0.215	5.21	5.44	.566	0.257
MS9967-317	0.906	0.918	23.21	23.32	0.205	0.215	5.21	5.44	.598	0.271
MS9967-318	0.969	0.981	24.61	24.92	0.205	0.215	5.21	5.44	.632	0.287
MS9967-319	1.031	1.043	26.19	26.49	0.205	0.215	5.21	5.44	.665	0.302
MS9967-320	1.094	1.106	27.79	28.09	0.205	0.215	5.21	5.44	.698	0.317
MS9967-321	1.156	1.168	29.36	29.67	0.205	0.215	5.21	5.44	.732	0.332
MS9967-322	1.219	1.231	30.96	31.27	0.205	0.215	5.21	5.44	.765	0.347
MS9967-323	1.281	1.293	32.54	32.84	0.205	0.215	5.21	5.44	.798	0.362
MS9967-324	1.344	1.356	34.14	34.44	0.205	0.215	5.21	5.44	.818	0.371
MS9967-325	1.405	1.405	37.21	37.72	0.205	0.215	5.21	5.44	.897	0.407
MS9967-326	1.500	1.610	40.89	40.89	0.205	0.215	5.21	5.44	.965	0.438
MS9967-327	1.715	1.735	43.56	44.07	0.205	0.215	5.21	5.44	1.031	0.468
MS9967-328	1.840	1.860	46.74	47.24	0.205	0.215	5.21	5.44	1.100	0.499
MS9967-329	1.965	1.985	49.91	50.42	0.205	0.215	5.21	5.44	1.163	0.528
MS9967-330	2.090	2.110	53.09	53.59	0.205	0.215	5.21	5.44	1.231	0.559
MS9967-331	2.215	2.235	56.26	56.77	0.205	0.215	5.21	5.44	1.300	0.590
MS9967-332	2.340	2.360	59.44	59.94	0.205	0.215	5.21	5.44	1.368	0.621
MS9967-333	2.465	2.485	62.61	63.12	0.205	0.215	5.21	5.44	1.433	0.651
MS9967-334	2.590	2.610	65.79	66.29	0.205	0.215	5.21	5.44	1.498	0.680
MS9967-335	2.715	2.740	68.97	69.47	0.205	0.215	5.21	5.44	1.565	0.710
MS9967-336	2.835	2.865	72.01	72.77	0.205	0.215	5.21	5.44	1.632	0.741
MS9967-337	2.960	2.990	75.18	75.95	0.205	0.215	5.21	5.44	1.700	0.772
MS9967-338	3.085	3.115	78.34	79.12	0.205	0.215	5.21	5.44	1.765	0.801
MS9967-339	3.210	3.240	81.53	82.30	0.205	0.215	5.21	5.44	1.830	0.831
MS9967-340	3.335	3.365	84.71	85.47	0.205	0.215	5.21	5.44	1.900	0.863
MS9967-341	3.460	3.490	87.89	88.65	0.205	0.215	5.21	5.44	1.965	0.892
MS9967-342	3.585	3.615	91.06	91.82	0.205	0.215	5.21	5.44	2.030	0.922
MS9967-343	3.710	3.740	94.23	95.00	0.205	0.215	5.21	5.44	2.100	0.953
MS9967-344	3.835	3.865	97.41	98.17	0.205	0.215	5.21	5.44	2.166	0.983
MS9967-345	3.960	3.990	100.58	101.35	0.205	0.215	5.21	5.44	2.233	1.014
MS9967-346	4.085	4.115	103.76	104.52	0.205	0.215	5.21	5.44	2.300	1.044
MS9967-347	4.210	4.240	106.94	107.70	0.205	0.215	5.21	5.44	2.366	1.074
MS9967-348	4.335	4.365	110.11	110.87	0.205	0.215	5.21	5.44	2.432	1.104
MS9967-349	4.460	4.490	113.28	114.05	0.205	0.215	5.21	5.44	2.495	1.133
MS9967-350	4.585	4.615	116.46	117.22	0.205	0.215	5.21	5.44	2.565	1.164
MS9967-351	4.710	4.740	119.63	120.40	0.205	0.215	5.21	5.44	2.631	1.194
MS9967-352	4.835	4.865	122.81	123.57	0.205	0.215	5.21	5.44	2.698	1.225
MS9967-353	4.960	4.990	125.98	126.75	0.205	0.215	5.21	5.44	2.765	1.255
MS9967-354	5.077	5.123	128.96	130.12	0.205	0.215	5.21	5.44	2.831	1.285
MS9967-355	5.202	5.248	132.13	133.30	0.205	0.215	5.21	5.44	2.898	1.311
MS9967-356	5.327	5.373	135.31	136.47	0.205	0.215	5.21	5.44	2.965	1.346
MS9967-357	5.452	5.498	138.48	139.65	0.205	0.215	5.21	5.44	3.031	1.376
MS9967-358	5.577	5.623	141.66	142.82	0.205	0.215	5.21	5.44	3.098	1.406
MS9967-359	5.702	5.748	144.83	146.00	0.205	0.215	5.21	5.44	3.164	1.436
MS9967-360	5.827	5.873	148.01	149.17	0.205	0.215	5.21	5.44	3.231	1.467
MS9967-361	5.952	5.998	151.18	152.35	0.205	0.215	5.21	5.44	3.298	1.497
MS9967-362	6.077	6.123	154.36	155.52	0.205	0.215	5.21	5.44	3.364	1.526
MS9967-363	6.202	6.248	157.53	158.70	0.205	0.215	5.21	5.44	3.431	1.556
MS9967-364	6.327	6.373	160.71	161.87	0.205	0.215	5.21	5.44	3.498	1.586
MS9967-365	6.452	6.498	163.88	165.05	0.205	0.215	5.21	5.44	3.564	1.616
MS9967-366	6.577	6.623	167.06	168.22	0.205	0.215	5.21	5.44	3.631	1.646
MS9967-367	6.702	6.748	170.23	171.40	0.205	0.215	5.21	5.44	3.698	1.676
MS9967-368	6.827	6.873	173.41	174.57	0.205	0.215	5.21	5.44	3.764	1.706
MS9967-369	6.952	6.998	176.58	177.75	0.205	0.215	5.21	5.44	3.831	1.736
MS9967-370	7.077	7.123	179.76	180.92	0.205	0.215	5.21	5.44	3.898	1.766
MS9967-371	7.202	7.248	182.93	184.10	0.205	0.215	5.21	5.44	3.964	1.796
MS9967-372	7.327	7.373	186.11	187.27	0.205	0.215	5.21	5.44	4.031	1.826
MS9967-373	7.452	7.498	189.28	190.45	0.205	0.215	5.21	5.44	4.098	1.856
MS9967-374	7.577	7.623	192.46	193.62	0.205	0.215	5.21	5.44	4.164	1.886
MS9967-375	7.702	7.748	195.63	196.80	0.205	0.215	5.21	5.44	4.231	1.916

P.A. Air Force - II Other Case	INTERNATIONAL INTEREST	TITLE	MILITARY STANDARD
Navy - AS	ABCC 17/27	PACKING, PREPARED - AMS 7273, 'O' RING	MS9967
PROCUREMENT SPECIFICATION NONE	SUPERSEDES	SHEET 5 OF	

DD FORM 672-1 (Limited coordination)

EDITION OF 1 SEP 67 MAY BE USED

Review activities:
Navy - AS
Air Force - 02

This standard has been approved by the Dept of the Air Force (II) and the Department of the Navy (AS) and is mandatory for use by their activities. All other military activities are required to comply with standard where suitable.

APPROVED 22 Dec 71 REVISED

MS9967

FED. SUP CLASS
5330

PART NUMBER	ID IN.		ID (mm)		T IN.		T (mm)		APPROX MASS	
	MIN	MAX	MIN	MAX	MIN	MAX	MIN	MAX	LB/100	KG/100
MS9967-369	7.945	8.205	201.85	203.33	0.205	0.215	5.21	5.44	4.204	1.981
MS9967-370	8.125	8.255	208.15	209.68	0.205	0.215	5.21	5.44	4.497	2.041
MS9967-371	8.445	8.505	214.50	216.03	0.205	0.215	5.21	5.44	4.630	2.102
MS9967-372	8.645	8.755	220.85	222.38	0.205	0.215	5.21	5.44	4.763	2.162
MS9967-373	8.945	9.005	227.20	228.73	0.205	0.215	5.21	5.44	4.897	2.223
MS9967-374	9.145	9.255	233.55	235.08	0.205	0.215	5.21	5.44	5.030	2.284
MS9967-375	9.445	9.505	239.90	241.43	0.205	0.215	5.21	5.44	5.163	2.344
MS9967-376	9.645	9.755	246.25	247.78	0.205	0.215	5.21	5.44	5.297	2.405
MS9967-377	9.945	10.075	252.60	254.13	0.205	0.215	5.21	5.44	5.430	2.465
MS9967-378	10.445	10.575	265.30	266.83	0.205	0.215	5.21	5.44	5.697	2.586
MS9967-379	10.445	11.005	278.00	279.53	0.205	0.215	5.21	5.44	5.963	2.707
MS9967-380	11.445	11.505	290.70	292.23	0.205	0.215	5.21	5.44	6.230	2.828
MS9967-381	11.945	12.005	303.40	304.93	0.205	0.215	5.21	5.44	6.497	2.950
MS9967-382	12.945	13.005	328.80	330.33	0.205	0.215	5.21	5.44	7.030	3.192
MS9967-383	13.945	14.005	354.20	355.73	0.205	0.215	5.21	5.44	7.563	3.434
MS9967-384	14.945	15.005	379.60	381.13	0.205	0.215	5.21	5.44	8.096	3.676
MS9967-385	15.910	16.000	404.11	406.40	0.205	0.215	5.21	5.44	8.619	3.913
MS9967-386	16.910	17.000	429.51	431.80	0.205	0.215	5.21	5.44	9.151	4.154
MS9967-387	17.910	18.000	454.91	457.20	0.205	0.215	5.21	5.44	9.685	4.397
MS9967-388	18.910	19.000	480.31	482.60	0.205	0.215	5.21	5.44	10.218	4.639
MS9967-389	19.910	20.000	505.71	508.00	0.205	0.215	5.21	5.44	10.752	4.881
MS9967-390	20.910	21.000	531.11	533.40	0.205	0.215	5.21	5.44	11.285	5.123
MS9967-391	21.910	22.000	556.51	558.80	0.205	0.215	5.21	5.44	11.818	5.365
MS9967-392	22.880	23.000	581.2	584.2	0.205	0.215	5.21	5.44	12.343	5.603
MS9967-393	23.880	24.000	606.6	609.6	0.205	0.215	5.21	5.44	12.876	5.845
MS9967-394	24.880	25.000	632.0	635.0	0.205	0.215	5.21	5.44	13.409	6.087
MS9967-395	25.880	26.000	657.4	660.4	0.205	0.215	5.21	5.44	13.942	6.329
MS9967-425	4.460	4.490	113.28	114.05	0.269	0.281	6.83	7.14	4.340	1.970
MS9967-426	4.585	4.615	116.46	117.22	0.269	0.281	6.83	7.14	4.457	2.023
MS9967-427	4.710	4.740	119.63	120.45	0.269	0.281	6.83	7.14	4.610	2.093
MS9967-428	4.835	4.865	122.81	123.57	0.269	0.281	6.83	7.14	4.686	2.127
MS9967-429	4.960	4.990	125.98	126.75	0.269	0.281	6.83	7.14	4.800	2.179
MS9967-430	5.077	5.123	128.96	130.12	0.269	0.281	6.83	7.14	4.915	2.231
MS9967-431	5.202	5.248	132.13	133.30	0.269	0.281	6.83	7.14	5.029	2.283
MS9967-432	5.327	5.373	135.31	136.47	0.269	0.281	6.83	7.14	5.143	2.335
MS9967-433	5.452	5.498	138.48	139.65	0.269	0.281	6.83	7.14	5.257	2.387
MS9967-434	5.577	5.623	141.66	142.82	0.269	0.281	6.83	7.14	5.371	2.438
MS9967-435	5.702	5.748	144.83	146.00	0.269	0.281	6.83	7.14	5.486	2.482
MS9967-436	5.827	5.873	148.01	149.17	0.269	0.281	6.83	7.14	5.600	2.542
MS9967-437	5.952	5.998	151.18	152.35	0.269	0.281	6.83	7.14	5.714	2.594
MS9967-438	6.202	6.248	157.53	158.70	0.269	0.281	6.83	7.14	5.943	2.698
MS9967-439	6.452	6.498	163.88	165.05	0.269	0.281	6.83	7.14	6.172	2.802
MS9967-440	6.702	6.748	170.23	171.40	0.269	0.281	6.83	7.14	6.400	2.906
MS9967-441	6.952	6.998	176.58	177.75	0.269	0.281	6.83	7.14	6.629	3.010
MS9967-442	7.195	7.255	182.75	184.28	0.269	0.281	6.83	7.14	6.855	3.114
MS9967-443	7.445	7.505	189.10	190.63	0.269	0.281	6.83	7.14	7.066	3.206
MS9967-444	7.695	7.755	195.45	196.98	0.269	0.281	6.83	7.14	7.315	3.321
MS9967-445	7.945	8.005	201.80	203.33	0.269	0.281	6.83	7.14	7.542	3.425
MS9967-446	8.445	8.505	214.50	216.03	0.269	0.281	6.83	7.14	8.000	3.632
MS9967-447	8.945	9.005	227.20	228.73	0.269	0.281	6.83	7.14	8.457	3.839
MS9967-448	9.445	9.505	239.90	241.43	0.269	0.281	6.83	7.14	8.914	4.047

P.A. Air Force-11 Other Coast Navy-AS	INTERNATIONAL INTEREST ASCC 17/27	TITLE PACKING, PREPORMED - AMS 7273, 'O' RING	MILITARY STANDARD
			MS 9967
PROCUREMENT SPECIFICATION NONE		SUPERSEDES:	SHEET 6 OF

DD FORM 672-1 (Limited coordination)

EDITION OF 1 SEP 67 MAY BE USED.

APPROVED 22 Dec 71 REVISED

Review activities:
Navy-AS
Air Force-82

This standard has been prepared by the Dept of the Air Force (11) and the Department of the Navy (AS) and is mandatory for use by all military units. All other military activities are required to comply with this standard where applicable.

MS9967FED SUP CLASS
5330

PART NUMBER	ID IN		ID (mm)		T IN.		T (mm)		APPROX MASS	
	MIN	MAX	MIN	MAX	MIN	MAX	MIN	MAX	LB/100	Kg/100
MS9967-449	9.945	10.005	252.60	254.13	0.269	0.281	6.83	7.14	9.372	4.255
MS9967-450	10.445	10.505	265.30	266.83	0.269	0.281	6.83	7.14	9.829	4.462
MS9967-451	10.945	11.005	278.00	279.53	0.269	0.281	6.83	7.14	10.287	4.670
MS9967-452	11.445	11.505	290.70	292.23	0.269	0.281	6.83	7.14	10.743	4.877
MS9967-453	11.945	12.005	303.40	304.93	0.269	0.281	6.83	7.14	11.200	5.085
MS9967-454	12.445	12.505	316.10	317.63	0.269	0.281	6.83	7.14	11.658	5.297
MS9967-455	12.945	13.005	328.80	330.33	0.269	0.281	6.83	7.14	12.115	5.500
MS9967-456	13.445	13.505	341.50	343.03	0.269	0.281	6.83	7.14	12.572	5.707
MS9967-457	13.945	14.005	354.20	355.73	0.269	0.281	6.83	7.14	13.029	5.915
MS9967-458	14.445	14.505	366.90	368.43	0.269	0.281	6.83	7.14	13.486	6.122
MS9967-459	14.945	15.005	379.60	381.13	0.269	0.281	6.83	7.14	13.943	6.330
MS9967-460	15.445	15.505	392.30	393.83	0.269	0.281	6.83	7.14	14.401	6.538
MS9967-461	15.910	16.000	404.11	406.40	0.269	0.281	6.83	7.14	14.839	6.737
MS9967-462	16.410	16.500	416.81	419.10	0.269	0.281	6.83	7.14	15.296	6.944
MS9967-463	16.910	17.000	429.51	431.80	0.269	0.281	6.83	7.14	15.754	7.152
MS9967-464	17.410	17.500	442.21	444.50	0.269	0.281	6.83	7.14	16.211	7.360
MS9967-465	17.910	18.000	454.91	457.20	0.269	0.281	6.83	7.14	16.668	7.567
MS9967-466	18.410	18.500	467.61	469.90	0.269	0.281	6.83	7.14	17.125	7.775
MS9967-467	18.910	19.000	480.31	482.60	0.269	0.281	6.83	7.14	17.582	7.982
MS9967-468	19.410	19.500	493.01	495.30	0.269	0.281	6.83	7.14	18.039	8.189
MS9967-469	19.910	20.000	505.71	508.00	0.269	0.281	6.83	7.14	18.497	8.397
MS9967-470	20.910	21.000	518.41	520.70	0.269	0.281	6.83	7.14	19.411	8.812
MS9967-471	21.910	22.000	531.11	533.40	0.269	0.281	6.83	7.14	20.325	9.227
MS9967-472	22.880	23.000	581.2	584.2	0.269	0.281	6.83	7.14	21.226	9.636
MS9967-473	23.880	24.000	606.6	609.6	0.269	0.281	6.83	7.14	22.140	10.051
MS9967-474	24.880	25.000	632.0	635.0	0.269	0.281	6.83	7.14	23.055	10.466
MS9967-475	25.880	26.000	657.4	660.4	0.269	0.281	6.83	7.14	23.969	10.880

1. MATERIAL SILICONE RUBBER AMS 7273
2. DIMENSIONS IN INCHES METRIC CONVERSIONS ARE IN PARENTHESES INTERNATIONAL SYSTEM UNITS (SI)
3. SHOWN ARE FOR REFERENCE ONLY
4. IDENTIFICATION AND PACKAGING PER AMS 2817.
5. DIMENSIONAL INSPECTION PER AS871.
6. DO NOT USE UNASSIGNED PART NUMBERS.

AS AND AMS ARE SOCIETY OF AUTOMOTIVE ENGINEERS, INC. PUBLICATIONS.
THIS STANDARD WAS DEVELOPED COOPERATIVELY WITH THE MILITARY SERVICES BY THE SAE AEROSPACE PART
STANDARDS DIVISION

P.A. Air Force - II Other Cost Navy - AS	INTERNATIONAL INTEREST	TITLE PACKING, PREFORMED - AMS 7273, 'O' RING	MILITARY STANDARD	
	ASCC 17/27		MS9967	
PROCUREMENT SPECIFICATION NONE		SUPERSEDES:	SHEET 7	OF

DD FORM 672-1 (Limited coordination)

REVISION OF 1 SEP 67 MAY BE USED.

Review activities:
Navy - AF
Air Force - 82

This standard has been approved by the Dept. of the Air Force (II) and the
Department of the Navy (AS) and is mandatory for use by
all activities. All other military activities are required
to comply with standard when available.

APPROVED 22 Dec 71 REVISED