

**- MARK PART NUMBER
AND MANUFACTURER'S IDENT
PER AS 470 CLASS A**

MINORING CONFIDENTIALITY
PER AS 201.120

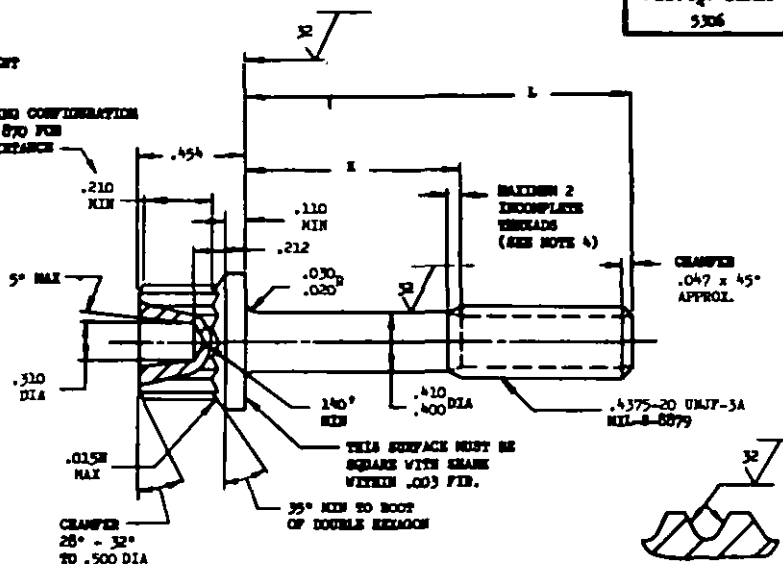
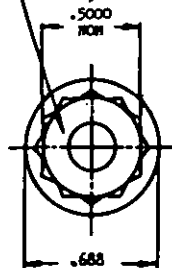

SECTION THREE
THREAD PROFILE

PART NO.	L	K	APPROX. WEIGHT LB/OZ	PART NO.	L	K	APPROX. WEIGHT LB/OZ	PART NO.	L	K	APPROX. WEIGHT LB/OZ
NS9918-04	.688	.105-.125	5.31	NS9918-22	1.812	.628-.688	9.41	NS9918-40	3.875	2.690-2.750	16.94
NS9918-05	.750	.105-.125	5.54	NS9918-23	1.875	.690-.750	9.64	NS9918-A1	4.000	2.815-2.875	17.40
NS9918-06	.812	.105-.125	5.76	NS9918-24	1.938	.752-.812	9.87	NS9918-A2	4.125	2.940-3.000	17.86
NS9918-07	.875	.105-.125	5.99	NS9918-25	2.000	.815-.875	10.10	NS9918-A3	4.250	3.065-3.125	18.31
NS9918-08	.938	.105-.125	6.22	NS9918-26	2.125	.940-1.000	10.56	NS9918-A4	4.375	3.190-3.250	18.77
NS9918-09	1.000	.105-.125	6.45	NS9918-27	2.250	1.065-1.125	11.01	NS9918-A5	4.500	3.315-3.375	19.22
NS9918-10	1.062	.105-.125	6.68	NS9918-28	2.375	1.190-1.250	11.47	NS9918-46	4.625	3.440-3.500	19.68
NS9918-11	1.125	.105-.125	6.90	NS9918-29	2.500	1.315-1.375	11.92	NS9918-47	4.750	3.565-3.625	20.14
NS9918-12	1.188	.105-.125	7.13	NS9918-30	2.625	1.440-1.500	12.38	NS9918-48	4.875	3.690-3.750	20.59
NS9918-13	1.250	.105-.125	7.36	NS9918-31	2.750	1.565-1.625	12.84	NS9918-A9	5.000	3.815-3.875	21.05
NS9918-14	1.312	.128-.188	7.59	NS9918-32	2.875	1.690-1.750	13.29	NS9918-50	5.125	3.940-4.000	21.50
NS9918-15	1.375	.190-.250	7.82	NS9918-33	3.000	1.815-1.875	13.75	NS9918-51	5.250	4.065-4.125	21.96
NS9918-16	1.438	.252-.312	8.05	NS9918-34	3.125	1.940-2.000	14.20	NS9918-52	5.375	4.190-4.250	22.42
NS9918-17	1.500	.315-.375	8.27	NS9918-35	3.250	2.065-2.125	14.66	NS9918-53	5.500	4.315-4.375	22.87
NS9918-18	1.562	.378-.438	8.50	NS9918-36	3.375	2.190-2.250	15.12	NS9918-54	5.625	4.440-4.500	23.33
NS9918-19	1.625	.440-.500	8.73	NS9918-37	3.500	2.315-2.375	15.57	NS9918-55	5.750	4.565-4.625	23.79
NS9918-20	1.688	.502-.562	8.96	NS9918-38	3.625	2.440-2.500	16.03	NS9918-56	5.875	4.690-4.750	24.24
NS9918-21	1.750	.565-.625	9.19	NS9918-39	3.750	2.565-2.625	16.49	NS9918-57	6.000	4.815-4.875	24.70

1. SHAFT SHALL BE STRAIGHT WITHIN .0025 PER INCH OF BOLT LENGTH.
2. THE CONCENTRICITY OF THREAD PD IN RELATION TO THE SHAFT SHALL BE WITHIN .006 FIR.
3. THE CONCENTRICITY OF THE SHAFT IN RELATION TO THE WASHED FACE DIAMETER AND DOUBLE HEXAGON OD SHALL BE WITHIN .010 FIR.
4. INCOMPLETE THREADS NOT TO ENTER FILLET.
5. MATERIAL: STEEL AMS 6322.
6. HARDNESS: ROCKWELL C26-32.
7. FINISH: CADMIUM PLATE AMS 2400. DIMENSIONS SPECIFIED ARE AFTER PLATING.
8. MANUFACTURING SPECIFICATION: AMS 7452 EXCEPT HEAD SHALL BE UPSET.
9. HEAD TO SHAFT FILLET SHALL BE COLD WORKED.
10. MAGNETIC PARTICLE INSPECTION PER AMS 2640 AFTER PLATING.
11. SURFACE TEXTURE: USAS B46.1-1962. UNLESS OTHERWISE SPECIFIED, SURFACES TO BE 125 MICROINCHES EXCEPT UPSET HEAD.
12. BREAK SHARP EDGES .003-.015 UNLESS OTHERWISE SPECIFIED.
13. DIMENSIONS IN INCHES. UNLESS OTHERWISE SPECIFIED, TOLERANCES: LINEAR DIMENSIONS $\pm .010$, ANGULAR DIMENSIONS $\pm 5^\circ$.
14. DO NOT USE UNASSIGNED PART NUMBERS.

AS & AMS ARE SOCIETY OF AUTOMOTIVE ENGINEERS, INC. PUBLICATIONS.
THIS STANDARD WAS DEVELOPED COOPERATIVELY WITH THE MILITARY SERVICES BY THE SAE AEROSPACE PART STANDARDS DIVISION.

P.A. USAF - 11
Other Cast
Merry - AS

TITLE

BOLT, MACHINE - DOUBLE HEXAGON EXTENDED
WASHER HEAD, PD SHANK, STEEL AMS 6122,
CADMIUM PLATED, .4375-20 UNJF-3A

MILITARY STANDARD

MS9918 (ASG)

SHEET 1 OF 1

DD FORM 672-1 (2-64) (Rev. 1-65)
GPO: 1965 O - 354-000

CONCLUSIONS AND RECOMMENDATIONS

☆U.S. GOVERNMENT PRINTING OFFICE: 1969-393-065/81743

Review motivation:
USAF - B2, B5

This military standard is approved by the Department of the Air Force and the Bureau of Naval Weapons and is satisfactory for use by these activities. All other military activities are required to employ this standard where suitable.

APPROVED	15 APR 69	REVISED
----------	-----------	---------