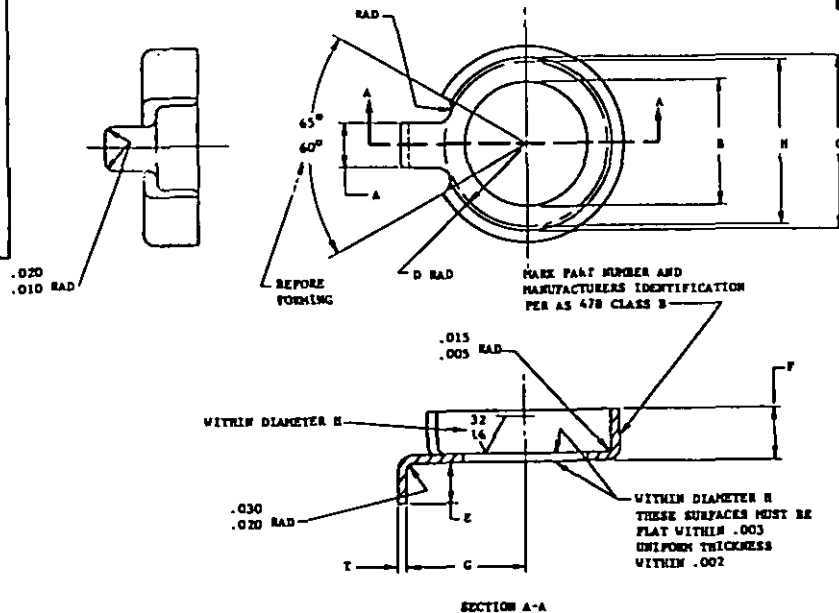

MS9880 (ASG)FED. SUP CLASS
5310

SECTION A-A

| PART NUMBERS | NOM SIZE | A +.005 -.000 | B | | C +.005 -.000 | D +.000 -.010 | E +.010 -.000 | F +.010 -.000 | G +.005 - | T | | H | APPROX WEIGHT LB/100 |
|--------------|----------|---------------------|------|------|---------------------|---------------------|---------------------|---------------------|-----------------|------|------|------|-------------------------|
| | | | MIN | MAX | | | | | | MIN | MAX | | |
| MS9880-09 | .190 | .110 | .230 | .237 | .377 | .170 | .093 | .140 | .226 | .019 | .025 | .347 | .15 |
| MS9880-10 | .250 | .110 | .290 | .299 | .440 | .203 | .100 | .165 | .270 | .028 | .036 | .410 | .30 |
| MS9880-11 | .312 | .140 | .352 | .361 | .502 | .235 | .100 | .165 | .330 | .028 | .036 | .472 | .34 |
| MS9880-12 | .375 | .140 | .415 | .425 | .564 | .265 | .140 | .165 | .370 | .028 | .036 | .534 | .38 |
| | | | | | | | | | | | | | |
| | | | | | | | | | | | | | |
| | | | | | | | | | | | | | |
| | | | | | | | | | | | | | |

1. DIAMETERS B & C SHALL BE CONCENTRIC WITHIN .005 FIL.
2. MATERIAL: CORROSION RESISTANT STEEL AMS 5310.
3. SURFACE TEXTURE: USAS B46.1-1962. UNLESS OTHERWISE SPECIFIED SURFACES TO BE 125 MICROINCHES.
4. REMOVE BURRS AND SHARP EDGES.
5. DIMENSIONS IN INCHES UNLESS OTHERWISE SPECIFIED.
6. HEAT TREATMENT: FORMED WASHERS SHALL BE ANNEALED AT 1925°F. TO 1975°F FOR 5 TO 10 MINUTES AND COOLED IN STILL AIR. WASHERS TO BE DESCALED.
7. DO NOT USE UNASSIGNED PART NUMBERS.

AS & AMS ARE SOCIETY OF AUTOMOTIVE ENGINEERS, INC. PUBLICATIONS
THIS STANDARD WAS DEVELOPED COOPERATIVELY WITH THE MILITARY SERVICES BY THE SAE AEROSPACE PART STANDARDS DIVISION.

Review activities;
IN Y - 62, 83

This military standard is approved by the Department of the Air Force and the Naval Air Systems Command and is mandatory for use by these activities. All other military activities are required to employ this standard where suitable.

P.A.
USAF-11
Other Com
Navy - AS

TITLE

WASHER, CUP, LOCK - CRES AMS 5310

MILITARY STANDARD

MS9880 (ASG)PROCUREMENT SPECIFICATION
WORK

SUPERSEDES: MS 9684

SHEET 1 OF 1
U. S. GOVERNMENT PRINTING OFFICE: 1962-357270DD FORM 672-1 (Limited coordination)
AND use only

PROHIBIT COPIES OF THIS FORM AND CONTENTS.

APPROVED 21 MAY 66 REVISED