

FED SUP CLASS
5330

MS9772

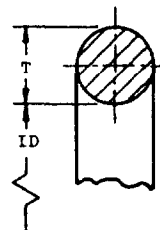
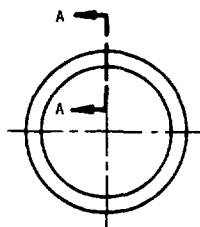

SECTION A-A

PART NUMBER	ID IN.		ID (mm)		T IN		T (mm)		APPROX MASS	
	MIN	MAX	MIN	MAX	MIN	MAX	MIN	MAX	LB/100	kg/100
MS9772-001	0.025	0.033	0.635	0.838	0.037	0.043	0.940	1.092	001	0005
MS9772-002	0.038	0.046	0.965	1.168	0.047	0.053	1.194	1.346	003	001
MS9772-003	0.052	0.060	1.321	1.524	0.057	0.063	1.448	1.600	004	002
MS9772-004	0.065	0.075	1.65	1.90	0.067	0.073	1.702	1.854	007	003
MS9772-005	0.096	0.106	2.44	2.69	0.067	0.073	1.702	1.854	009	004
MS9772-006	0.109	0.119	2.77	3.02	0.067	0.073	1.702	1.854	009	004
MS9772-007	0.140	0.150	3.56	3.81	0.067	0.073	1.702	1.854	011	005
MS9772-008	0.171	0.181	4.34	4.60	0.067	0.073	1.702	1.854	013	006
MS9772-009	0.203	0.213	5.16	5.41	0.067	0.073	1.702	1.854	014	006
MS9772-010	0.234	0.244	5.94	6.20	0.067	0.073	1.702	1.854	016	007
MS9772-011	0.296	0.306	7.52	7.77	0.067	0.073	1.702	1.854	019	009
MS9772-012	0.359	0.369	9.12	9.37	0.067	0.073	1.702	1.854	022	010
MS9772-013	0.421	0.431	10.69	10.95	0.067	0.073	1.702	1.854	025	011
MS9772-014	0.484	0.494	12.29	12.55	0.067	0.073	1.702	1.854	029	013
MS9772-015	0.546	0.556	13.87	14.12	0.067	0.073	1.702	1.854	032	015
MS9772-016	0.609	0.619	15.47	15.72	0.067	0.073	1.702	1.854	035	016
MS9772-017	0.671	0.681	17.04	17.30	0.067	0.073	1.702	1.854	038	017
MS9772-018	0.734	0.744	18.64	18.90	0.067	0.073	1.702	1.854	041	019
MS9772-019	0.795	0.807	20.19	20.50	0.067	0.073	1.702	1.854	044	020
MS9772-020	0.858	0.870	21.79	22.10	0.067	0.073	1.702	1.854	047	021
MS9772-021	0.920	0.932	23.37	23.67	0.067	0.073	1.702	1.854	050	023
MS9772-022	0.983	0.995	24.97	25.27	0.067	0.073	1.702	1.854	054	024
MS9772-023	1.045	1.057	26.54	26.85	0.067	0.073	1.702	1.854	057	026
MS9772-024	1.108	1.120	28.14	28.45	0.067	0.073	1.702	1.854	060	027
MS9772-025	1.170	1.182	29.72	30.02	0.067	0.073	1.702	1.854	063	029
MS9772-026	1.233	1.245	31.32	31.62	0.067	0.073	1.702	1.854	066	030
MS9772-027	1.295	1.307	32.89	33.20	0.067	0.073	1.702	1.854	070	032
MS9772-028	1.358	1.370	34.49	34.80	0.067	0.073	1.702	1.854	073	033
MS9772-029	1.479	1.499	37.57	38.07	0.067	0.073	1.702	1.854	079	036
MS9772-030	1.604	1.624	40.74	41.25	0.067	0.073	1.702	1.854	086	039
MS9772-031	1.729	1.749	43.92	44.42	0.067	0.073	1.702	1.854	092	042
MS9772-032	1.854	1.874	47.09	47.60	0.067	0.073	1.702	1.854	098	044
MS9772-033	1.979	1.999	50.27	50.77	0.067	0.073	1.702	1.854	105	048
MS9772-034	2.104	2.124	53.44	53.95	0.067	0.073	1.702	1.854	111	050
MS9772-035	2.229	2.249	56.62	57.12	0.067	0.073	1.702	1.854	117	053
MS9772-036	2.354	2.374	59.79	60.30	0.067	0.073	1.702	1.854	123	056
MS9772-037	2.479	2.499	62.97	63.47	0.067	0.073	1.702	1.854	130	059
MS9772-038	2.604	2.624	66.14	66.65	0.067	0.073	1.702	1.854	136	062
MS9772-039	2.729	2.754	69.31	69.95	0.067	0.073	1.702	1.854	143	065
MS9772-040	2.849	2.879	72.46	73.13	0.067	0.073	1.702	1.854	149	068
MS9772-041	2.974	3.004	75.64	76.30	0.067	0.073	1.702	1.854	155	070
MS9772-042	3.224	3.254	81.89	82.65	0.067	0.073	1.702	1.854	168	076
MS9772-043	3.474	3.504	88.24	89.00	0.067	0.073	1.702	1.854	181	082
MS9772-044	3.724	3.754	94.59	95.35	0.067	0.073	1.702	1.854	194	088
MS9772-045	3.974	4.004	100.94	101.70	0.067	0.073	1.702	1.854	206	093
MS9772-046	4.224	4.254	107.29	108.05	0.067	0.073	1.702	1.854	219	099
MS9772-047	4.474	4.504	113.64	114.40	0.067	0.073	1.702	1.854	231	105
MS9772-048	4.724	4.754	119.99	120.75	0.067	0.073	1.702	1.854	244	111
MS9772-049	4.966	5.012	126.14	127.30	0.067	0.073	1.702	1.854	257	117
MS9772-050	5.216	5.262	132.49	133.65	0.067	0.073	1.702	1.854	270	122
MS9772-102	0.044	0.054	1.12	1.37	0.100	0.106	2.540	2.692	017	008
MS9772-103	0.076	0.086	1.93	2.18	0.100	0.106	2.540	2.692	020	009
MS9772-104	0.107	0.117	2.72	2.97	0.100	0.106	2.540	2.692	024	011
MS9772-105	0.138	0.148	3.51	3.76	0.100	0.106	2.540	2.692	027	012

P. A.
Air Force - II
Other Cust
Navy - ASINTERNATIONAL
INTEREST
ASCC
17/27

TITLE

PACKING PREFORMED - AMS 3617 'O' RING

MILITARY STANDARD

MS9772

PROCUREMENT SPECIFICATION
NONE

SUPERSEDES

SHEET 1 OF 7

MS9772**FED SUP CLASS**
5330Review activities
Navy - AS
Air Force - 82

PART NUMBER	ID IN.		ID (mm)		T IN.		T (mm)		APPROX MASS	
	MIN	MAX	MIN	MAX	MIN	MAX	MIN	MAX	LB/100	kg/100
MS9772-106	0.169	0.179	4.29	4.55	0.100	0.106	2.540	2.692	031	014
MS9772-107	0.201	0.211	5.11	5.36	0.100	0.106	2.540	2.692	034	015
MS9772-108	0.232	0.242	5.89	6.15	0.100	0.106	2.540	2.692	037	017
MS9772-109	0.294	0.304	7.47	7.72	0.100	0.106	2.540	2.692	044	020
MS9772-110	0.357	0.367	9.07	9.32	0.100	0.106	2.540	2.692	051	023
MS9772-111	0.419	0.429	10.64	10.90	0.100	0.106	2.540	2.692	058	026
MS9772-112	0.482	0.492	12.24	12.50	0.100	0.106	2.540	2.692	065	029
MS9772-113	0.544	0.554	13.82	14.07	0.100	0.106	2.540	2.692	072	033
MS9772-114	0.607	0.617	15.42	15.67	0.100	0.106	2.540	2.692	079	036
MS9772-115	0.669	0.679	16.99	17.25	0.100	0.106	2.540	2.692	085	039
MS9772-116	0.732	0.742	18.59	18.85	0.100	0.106	2.540	2.692	092	042
MS9772-117	0.793	0.803	20.14	20.45	0.100	0.106	2.540	2.692	099	045
MS9772-118	0.856	0.866	21.74	22.05	0.100	0.106	2.540	2.692	106	048
MS9772-119	0.918	0.930	23.32	23.62	0.100	0.106	2.540	2.692	113	051
MS9772-120	0.981	0.993	24.92	25.22	0.100	0.106	2.540	2.692	120	054
MS9772-121	1.043	1.055	26.49	26.80	0.100	0.106	2.540	2.692	127	058
MS9772-122	1.106	1.118	28.09	28.40	0.100	0.106	2.540	2.692	134	061
MS9772-123	1.168	1.180	29.67	29.97	0.100	0.106	2.540	2.692	140	064
MS9772-124	1.231	1.243	31.27	31.57	0.100	0.106	2.540	2.692	147	067
MS9772-125	1.293	1.305	32.84	33.15	0.100	0.106	2.540	2.692	154	070
MS9772-126	1.356	1.368	34.44	34.75	0.100	0.106	2.540	2.692	161	073
MS9772-127	1.418	1.430	36.02	36.32	0.100	0.106	2.540	2.692	168	076
MS9772-128	1.481	1.493	37.62	37.92	0.100	0.106	2.540	2.692	175	079
MS9772-129	1.539	1.559	39.09	39.60	0.100	0.106	2.540	2.692	181	082
MS9772-130	1.602	1.622	40.69	41.20	0.100	0.106	2.540	2.692	189	086
MS9772-131	1.664	1.684	42.27	42.77	0.100	0.106	2.540	2.692	195	088
MS9772-132	1.727	1.747	43.87	44.37	0.100	0.106	2.540	2.692	202	092
MS9772-133	1.789	1.809	45.44	45.95	0.100	0.106	2.540	2.692	209	095
MS9772-134	1.852	1.872	47.04	47.55	0.100	0.106	2.540	2.692	216	098
MS9772-135	1.915	1.935	48.64	49.15	0.100	0.106	2.540	2.692	223	101
MS9772-136	1.977	1.997	50.22	50.72	0.100	0.106	2.540	2.692	230	104
MS9772-137	2.040	2.060	51.82	52.32	0.100	0.106	2.540	2.692	237	108
MS9772-138	2.102	2.122	53.39	53.90	0.100	0.106	2.540	2.692	244	111
MS9772-139	2.165	2.185	54.99	55.50	0.100	0.106	2.540	2.692	250	113
MS9772-140	2.227	2.247	56.57	57.07	0.100	0.106	2.540	2.692	257	117
MS9772-141	2.290	2.310	58.17	58.67	0.100	0.106	2.540	2.692	264	120
MS9772-142	2.352	2.372	59.74	60.25	0.100	0.106	2.540	2.692	271	123
MS9772-143	2.415	2.435	61.34	61.85	0.100	0.106	2.540	2.692	278	126
MS9772-144	2.477	2.497	62.92	63.42	0.100	0.106	2.540	2.692	285	129
MS9772-145	2.540	2.560	64.52	65.02	0.100	0.106	2.540	2.692	291	132
MS9772-146	2.602	2.622	66.09	66.60	0.100	0.106	2.540	2.692	299	136
MS9772-147	2.660	2.690	67.56	68.33	0.100	0.106	2.540	2.692	305	138
MS9772-148	2.722	2.752	69.14	69.90	0.100	0.106	2.540	2.692	312	142
MS9772-149	2.785	2.815	70.74	71.50	0.100	0.106	2.540	2.692	319	145
MS9772-150	2.847	2.877	72.31	73.08	0.100	0.106	2.540	2.692	326	148
MS9772-151	2.972	3.002	75.49	76.25	0.100	0.106	2.540	2.692	340	154
MS9772-152	3.222	3.252	81.84	82.60	0.100	0.106	2.540	2.692	367	166
MS9772-153	3.472	3.502	88.19	88.95	0.100	0.106	2.540	2.692	395	179
MS9772-154	3.722	3.752	94.54	95.30	0.100	0.106	2.540	2.692	422	191
MS9772-155	3.972	4.002	100.89	101.65	0.100	0.106	2.540	2.692	450	204
MS9772-156	4.222	4.252	107.24	108.00	0.100	0.106	2.540	2.692	477	216
MS9772-157	4.472	4.502	113.59	114.35	0.100	0.106	2.540	2.692	505	229
MS9772-158	4.722	4.752	119.94	120.70	0.100	0.106	2.540	2.692	532	241
MS9772-159	4.972	5.002	126.29	127.05	0.100	0.106	2.540	2.692	559	254
MS9772-160	5.214	5.260	132.44	133.60	0.100	0.106	2.540	2.692	587	266

APPROVED 22 Dec 71 REVISED

P.A. Air Force-II Other Cost	INTERNATIONAL INTEREST	TITLE	MILITARY STANDARD
Navy - AS	ASCC 17/27	PACKING, PREFORMED - AMS 3617, 'O' RING	MS9772
PROCUREMENT SPECIFICATION NONE	SUPERSEDES		SHEET 2 OF 7

MS9772

FED SUP CLASS
5330

PART NUMBER	ID IN		ID (mm)		T IN		T (mm)		APPROX MASS	
	MIN	MAX	MIN	MAX	MIN	MAX	MIN	MAX	LB / 100	Kg / 100
MS9772-161	5 464	5 510	138 79	139 95	0 100	0 106	2 540	2 692	614	278
MS9772-162	5 714	5 760	145 14	146 30	0 100	0 106	2 540	2 692	642	291
MS9772-163	5 964	6 010	151 49	152 65	0 100	0 106	2 540	2 692	669	303
MS9772-164	6 214	6 260	157 84	159 00	0 100	0 106	2 540	2 692	697	316
MS9772-165	6 464	6 510	164 19	165 35	0 100	0 106	2 540	2 692	724	328
MS9772-166	6 714	6 760	170 54	171 70	0 100	0 106	2 540	2 692	752	341
MS9772-167	6 964	7 010	176 89	178 05	0 100	0 106	2 540	2 692	780	354
MS9772-168	7 207	7 267	183 06	184 58	0 100	0 106	2 540	2 692	807	366
MS9772-169	7 457	7 517	189 41	190 93	0 100	0 106	2 540	2 692	835	379
MS9772-170	7 707	7 767	195 76	197 28	0 100	0 106	2 540	2 692	862	391
MS9772-171	7 957	8 017	202 11	203 63	0 100	0 106	2 540	2 692	890	404
MS9772-172	8 207	8 267	208 46	209 98	0 100	0 106	2 540	2 692	917	416
MS9772-173	8 457	8 517	214 81	216 33	0 100	0 106	2 540	2 692	945	429
MS9772-174	8 707	8 767	221 16	222 68	0 100	0 106	2 540	2 692	972	441
MS9772-175	8 957	9 017	227 51	229 03	0 100	0 106	2 540	2 692	999	453
MS9772-176	9 207	9 267	233 86	235 38	0 100	0 106	2 540	2 692	1 027	466
MS9772-177	9 457	9 517	240 21	241 73	0 100	0 106	2 540	2 692	1 054	478
MS9772-178	9 707	9 767	246 56	248 08	0 100	0 106	2 540	2 692	1 082	491
MS9772-201	0 166	0 176	4 22	4 47	0 135	0 143	3 429	3 632	062	028
MS9772-202	0 229	0 239	5 82	6 07	0 135	0 143	3 429	3 632	075	034
MS9772-203	0 291	0 301	7 39	7 65	0 135	0 143	3 429	3 632	087	039
MS9772-204	0 354	0 364	8 99	9 25	0 135	0 143	3 429	3 632	100	045
MS9772-205	0 416	0 426	10 57	10 82	0 135	0 143	3 429	3 632	112	051
MS9772-206	0 479	0 489	12 17	12 42	0 135	0 143	3 429	3 632	125	057
MS9772-207	0 541	0 551	13 74	14 00	0 135	0 143	3 429	3 632	137	062
MS9772-208	0 604	0 614	15 34	15 60	0 135	0 143	3 429	3 632	150	068
MS9772-209	0 666	0 676	16 92	17 17	0 135	0 143	3 429	3 632	162	073
MS9772-210	0 728	0 740	18 49	18 80	0 135	0 143	3 429	3 632	175	079
MS9772-211	0 790	0 802	20 07	20 37	0 135	0 143	3 429	3 632	187	085
MS9772-212	0 853	0 865	21 67	21 97	0 135	0 143	3 429	3 632	200	091
MS9772-213	0 915	0 927	23 24	23 55	0 135	0 143	3 429	3 632	212	096
MS9772-214	0 978	0 990	24 84	25 15	0 135	0 143	3 429	3 632	225	102
MS9772-215	1 040	1 052	26 42	26 72	0 135	0 143	3 429	3 632	237	108
MS9772-216	1 103	1 115	28 02	28 32	0 135	0 143	3 429	3 632	250	113
MS9772-217	1 165	1 177	29 59	29 90	0 135	0 143	3 429	3 632	262	119
MS9772-218	1 228	1 240	31 19	31 50	0 135	0 143	3 429	3 632	275	125
MS9772-219	1 290	1 302	32 77	33 07	0 135	0 143	3 429	3 632	287	130
MS9772-220	1 353	1 365	34 37	34 67	0 135	0 143	3 429	3 632	300	136
MS9772-221	1 415	1 427	35 94	36 25	0 135	0 143	3 429	3 632	312	142
MS9772-222	1 478	1 490	37 54	37 85	0 135	0 143	3 429	3 632	325	147
MS9772-223	1 541	1 553	39 14	39 45	0 135	0 143	3 429	3 632	338	153
MS9772-224	1 604	1 616	40 74	41 05	0 135	0 143	3 429	3 632	350	159
MS9772-225	1 667	1 679	42 34	42 65	0 135	0 143	3 429	3 632	363	165
MS9772-226	1 730	1 742	43 94	44 25	0 135	0 143	3 429	3 632	375	170
MS9772-227	1 793	1 805	45 54	45 85	0 135	0 143	3 429	3 632	388	176
MS9772-228	1 856	1 868	47 14	47 45	0 135	0 143	3 429	3 632	400	181
MS9772-229	1 919	1 931	48 74	49 05	0 135	0 143	3 429	3 632	413	187
MS9772-230	2 000	2 012	50 34	50 65	0 135	0 143	3 429	3 632	425	193
MS9772-231	2 063	2 075	51 94	52 25	0 135	0 143	3 429	3 632	438	199
MS9772-232	2 126	2 138	53 54	53 85	0 135	0 143	3 429	3 632	450	204
MS9772-233	2 189	2 201	55 14	55 45	0 135	0 143	3 429	3 632	463	210
MS9772-234	2 252	2 264	56 74	57 05	0 135	0 143	3 429	3 632	475	215
MS9772-235	2 315	2 327	58 34	58 65	0 135	0 143	3 429	3 632	488	221
MS9772-236	2 378	2 390	59 94	60 25	0 135	0 143	3 429	3 632	500	227
MS9772-237	2 441	2 453	61 54	61 85	0 135	0 143	3 429	3 632	513	233
MS9772-238	2 504	2 516	63 14	63 45	0 135	0 143	3 429	3 632	525	238
MS9772-239	2 567	2 579	64 74	65 05	0 135	0 143	3 429	3 632	538	244
MS9772-240	2 630	2 642	66 34	66 65	0 135	0 143	3 429	3 632	550	249
MS9772-241	2 693	2 705	67 94	68 25	0 135	0 143	3 429	3 632	563	255
MS9772-242	2 756	2 768	69 54	69 85	0 135	0 143	3 429	3 632	575	261
MS9772-243	2 819	2 831	71 14	71 45	0 135	0 143	3 429	3 632	588	267
MS9772-244	2 882	2 894	72 74	73 05	0 135	0 143	3 429	3 632	600	272
MS9772-245	2 945	2 957	74 34	74 65	0 135	0 143	3 429	3 632	613	278
MS9772-246	3 008	3 020	75 94	76 25	0 135	0 143	3 429	3 632	625	283
MS9772-247	3 071	3 083	77 54	77 85	0 135	0 143	3 429	3 632	638	289
MS9772-248	3 134	3 146	79 14	79 45	0 135	0 143	3 429	3 632	650	295

P A Air Force-11 Other Cust Navy-AS	INTERNATIONAL INTEREST	TITLE PACKING, PREFORMED - AMS 3617 'O' RING	MILITARY STANDARD	
	ASCC 17/27		MS9772	
PROCUREMENT SPECIFICATION NONE		SUPERSEDES	SHEET 3 OF 7	

DD FORM 672-1 (Limited coordination)

EDITION OF 1 SEP 87 MAY BE USED

APPROVED 22 Dec 71 REVISED

Activities
Navy - AS
Air Force - 82

This document has been approved by the Dept of the Air Force (11) and the Navy (AS) and is mandatory for use by all military activities. All other military activities are required to employ this standard where suitable.

MS9772

FED SUP CLASS

5330

PART NUMBER	ID IN.		ID (mm)		T IN		T (mm)		APPROX MASS	
	MIN	MAX	MIN	MAX	MIN	MAX	MIN	MAX	LB/100	kg/100
MS9772-236	3.219	3.249	81.76	82.52	0.135	0.143	3.429	3.632	675	306
MS9772-237	3.344	3.374	84.94	85.70	0.135	0.143	3.429	3.632	701	318
MS9772-238	3.469	3.499	88.11	88.87	0.135	0.143	3.429	3.632	725	329
MS9772-239	3.594	3.624	91.29	92.05	0.135	0.143	3.429	3.632	751	341
MS9772-240	3.719	3.749	94.46	95.22	0.135	0.143	3.429	3.632	775	352
MS9772-241	3.844	3.874	97.64	98.40	0.135	0.143	3.429	3.632	801	363
MS9772-242	3.969	3.999	100.81	101.57	0.135	0.143	3.429	3.632	826	375
MS9772-243	4.094	4.124	103.99	104.75	0.135	0.143	3.429	3.632	851	386
MS9772-244	4.219	4.249	107.16	107.92	0.135	0.143	3.429	3.632	876	397
MS9772-245	4.344	4.374	110.34	111.10	0.135	0.143	3.429	3.632	900	408
MS9772-246	4.469	4.499	113.51	114.27	0.135	0.143	3.429	3.632	926	420
MS9772-247	4.594	4.624	116.69	117.45	0.135	0.143	3.429	3.632	950	431
MS9772-248	4.719	4.749	119.86	120.62	0.135	0.143	3.429	3.632	976	443
MS9772-249	4.844	4.874	123.04	123.80	0.135	0.143	3.429	3.632	1 001	454
MS9772-250	4.969	4.999	126.21	126.97	0.135	0.143	3.429	3.632	1 026	465
MS9772-251	5.094	5.124	129.38	130.14	0.135	0.143	3.429	3.632	1 051	477
MS9772-252	5.219	5.249	132.56	133.32	0.135	0.143	3.429	3.632	1 076	488
MS9772-253	5.344	5.374	135.73	136.49	0.135	0.143	3.429	3.632	1 101	499
MS9772-254	5.469	5.500	138.91	139.67	0.135	0.143	3.429	3.632	1 126	511
MS9772-255	5.594	5.624	142.08	142.84	0.135	0.143	3.429	3.632	1 151	522
MS9772-256	5.719	5.750	145.26	146.02	0.135	0.143	3.429	3.632	1 176	533
MS9772-257	5.844	5.874	148.43	149.19	0.135	0.143	3.429	3.632	1 201	545
MS9772-258	5.969	6.000	151.61	152.37	0.135	0.143	3.429	3.632	1 226	556
MS9772-259	6.094	6.124	154.78	155.54	0.135	0.143	3.429	3.632	1 251	567
MS9772-260	6.219	6.250	157.96	158.72	0.135	0.143	3.429	3.632	1 276	579
MS9772-261	6.344	6.374	161.13	161.89	0.135	0.143	3.429	3.632	1 301	590
MS9772-262	6.469	6.500	164.31	165.07	0.135	0.143	3.429	3.632	1 326	601
MS9772-263	6.594	6.624	167.48	168.24	0.135	0.143	3.429	3.632	1 351	612
MS9772-264	6.719	6.750	170.66	171.42	0.135	0.143	3.429	3.632	1 376	624
MS9772-265	6.844	6.874	173.83	174.59	0.135	0.143	3.429	3.632	1 401	635
MS9772-266	6.969	7.000	177.01	177.77	0.135	0.143	3.429	3.632	1 426	647
MS9772-267	7.094	7.124	180.18	180.94	0.135	0.143	3.429	3.632	1 451	658
MS9772-268	7.219	7.250	183.36	184.12	0.135	0.143	3.429	3.632	1 476	670
MS9772-269	7.344	7.374	186.53	187.29	0.135	0.143	3.429	3.632	1 501	681
MS9772-270	7.469	7.500	189.71	190.47	0.135	0.143	3.429	3.632	1 526	693
MS9772-271	7.594	7.624	192.88	193.64	0.135	0.143	3.429	3.632	1 551	704
MS9772-272	7.719	7.750	196.06	196.82	0.135	0.143	3.429	3.632	1 576	715
MS9772-273	7.844	7.874	199.23	200.00	0.135	0.143	3.429	3.632	1 601	727
MS9772-274	7.969	8.000	202.41	203.17	0.135	0.143	3.429	3.632	1 626	738
MS9772-275	8.094	8.124	205.58	206.34	0.135	0.143	3.429	3.632	1 651	750
MS9772-276	8.219	8.250	208.76	209.52	0.135	0.143	3.429	3.632	1 676	761
MS9772-277	8.344	8.374	211.93	212.69	0.135	0.143	3.429	3.632	1 701	773
MS9772-278	8.469	8.500	215.11	215.87	0.135	0.143	3.429	3.632	1 726	784
MS9772-279	8.594	8.624	218.28	219.04	0.135	0.143	3.429	3.632	1 751	796
MS9772-280	8.719	8.750	221.46	222.22	0.135	0.143	3.429	3.632	1 776	807
MS9772-281	8.844	8.874	224.63	225.39	0.135	0.143	3.429	3.632	1 801	819
MS9772-282	8.969	9.000	227.81	228.57	0.135	0.143	3.429	3.632	1 826	830
MS9772-283	9.094	9.124	230.98	231.74	0.135	0.143	3.429	3.632	1 851	842
MS9772-284	9.219	9.250	234.16	234.92	0.135	0.143	3.429	3.632	1 876	853
MS9772-285	9.344	9.374	237.33	238.09	0.135	0.143	3.429	3.632	1 901	865
MS9772-286	9.469	9.500	240.51	241.27	0.135	0.143	3.429	3.632	1 926	876
MS9772-287	9.594	9.624	243.68	244.44	0.135	0.143	3.429	3.632	1 951	888
MS9772-288	9.719	9.750	246.86	247.62	0.135	0.143	3.429	3.632	1 976	899
MS9772-289	9.844	9.874	250.03	250.79	0.135	0.143	3.429	3.632	2 001	911
MS9772-290	9.969	10.000	253.21	253.97	0.135	0.143	3.429	3.632	2 026	922
MS9772-291	10.094	10.124	256.38	257.14	0.135	0.143	3.429	3.632	2 051	934
MS9772-292	10.219	10.250	259.56	260.32	0.135	0.143	3.429	3.632	2 076	945
MS9772-293	10.344	10.374	262.73	263.49	0.135	0.143	3.429	3.632	2 101	957
MS9772-294	10.469	10.500	265.91	266.67	0.135	0.143	3.429	3.632	2 126	968
MS9772-295	10.594	10.624	269.08	269.84	0.135	0.143	3.429	3.632	2 151	980
MS9772-296	10.719	10.750	272.26	273.02	0.135	0.143	3.429	3.632	2 176	991
MS9772-297	10.844	10.874	275.43	276.19	0.135	0.143	3.429	3.632	2 201	1003
MS9772-298	10.969	11.000	278.61	279.37	0.135	0.143	3.429	3.632	2 226	1014
MS9772-299	11.094	11.124	281.78	282.54	0.135	0.143	3.429	3.632	2 251	1026
MS9772-300	11.219	11.250	284.96	285.72	0.135	0.143	3.429	3.632	2 276	1037
MS9772-301	11.344	11.374	288.13	288.89	0.135	0.143	3.429	3.632	2 301	1049
MS9772-302	11.469	11.500	291.31	292.07	0.135	0.143	3.429	3.632	2 326	1060
MS9772-303	11.594	11.624	294.48	295.24	0.135	0.143	3.429	3.632	2 351	1072
MS9772-304	11.719	11.750	297.66	298.42	0.135	0.143	3.429	3.632	2 376	1083
MS9772-305	11.844	11.874	300.83	301.59	0.135	0.143	3.429	3.632	2 401	1095
MS9772-306	11.969	12.000	304.01	304.77	0.135	0.143	3.429	3.632	2 426	1106
MS9772-307	12.094	12.124	307.18	307.94	0.135	0.143	3.429	3.632	2 451	1118
MS9772-308	12.219	12.250	310.36	311.12	0.135	0.143	3.429	3.632	2 476	1129
MS9772-309	12.344	12.374	313.53	314.29	0.135	0.143	3.429	3.632	2 501	1141
MS9772-310	12.469	12.500	316.71	317.47	0.135	0.143	3.429	3.632	2 526	1152
MS9772-311	12.594	12.624	319.88	320.64	0.135	0.143	3.429	3.632	2 551	1164
MS9772-312	12.719	12.750	323.06	323.82	0.135	0.143	3.429	3.632	2 576	1175
MS9772-313	12.844	12.874	326.23	327.00	0.135	0.143	3.429	3.632	2 601	1187

P. A. Air Force-II Other Cust Navy - AS	INTERNATIONAL INTEREST ASCC 17/27	TITLE PACKING PREFORMED - AMS 3617 'O' RING	MILITARY STANDARD	
			MS9772	
PROCUREMENT SPECIFICATION H21E		SUPERSEDES	SHEET 4 OF 7	

DD FORM 672-1 (Limited coordination)

EDITION OF 1 SEP 75 MAY BE USED

APPROVED 22 Dec 71 REVISED

Review activities
Navy AS
Air Force - 82

This standard has been approved by the USPT of the Air Force (11) and the Department of the Navy (AS) and is mandatory for use by that activity. All other military activities are required to employ this standard where suitable.

MS9772**FED SUP CLASS**
5330

PART NUMBER	ID IN.		ID (mm)		T IN.		T (mm)		APPROX MASS	
	MIN	MAX	MIN	MAX	MIN	MAX	MIN	MAX	LB/100	kg '100
MS9772-314	0.719	0.731	18.26	18.57	0.205	0.215	5.21	5.46	427	194
MS9772-315	0.781	0.793	19.84	20.14	0.205	0.215	5.21	5.46	456	207
MS9772-316	0.844	0.856	21.44	21.74	0.205	0.215	5.21	5.46	484	220
MS9772-317	0.906	0.918	23.01	23.32	0.205	0.215	5.21	5.46	513	233
MS9772-318	0.969	0.981	24.61	24.92	0.205	0.215	5.21	5.46	541	245
MS9772-319	1.031	1.043	26.19	26.49	0.205	0.215	5.21	5.46	570	259
MS9772-320	1.094	1.106	27.79	28.09	0.205	0.215	5.21	5.46	598	271
MS9772-321	1.156	1.168	29.36	29.67	0.205	0.215	5.21	5.46	627	284
MS9772-322	1.219	1.231	30.96	31.27	0.205	0.215	5.21	5.46	656	298
MS9772-323	1.281	1.293	32.54	32.84	0.205	0.215	5.21	5.46	684	310
MS9772-324	1.344	1.356	34.14	34.44	0.205	0.215	5.21	5.46	713	323
MS9772-325	1.406	1.418	35.72	36.02	0.205	0.215	5.21	5.46	742	336
MS9772-326	1.469	1.481	37.30	37.60	0.205	0.215	5.21	5.46	770	348
MS9772-327	1.531	1.543	38.88	39.18	0.205	0.215	5.21	5.46	827	375
MS9772-328	1.594	1.606	40.46	40.76	0.205	0.215	5.21	5.46	855	401
MS9772-329	1.656	1.668	42.04	42.34	0.205	0.215	5.21	5.46	884	427
MS9772-330	1.719	1.731	43.62	43.92	0.205	0.215	5.21	5.46	912	453
MS9772-331	1.781	1.793	45.20	45.50	0.205	0.215	5.21	5.46	940	479
MS9772-332	1.844	1.856	46.78	47.08	0.205	0.215	5.21	5.46	968	505
MS9772-333	1.906	1.918	48.36	48.66	0.205	0.215	5.21	5.46	997	531
MS9772-334	1.969	1.981	49.94	50.24	0.205	0.215	5.21	5.46	1025	557
MS9772-335	2.031	2.043	51.52	51.82	0.205	0.215	5.21	5.46	1053	582
MS9772-336	2.094	2.106	53.10	53.40	0.205	0.215	5.21	5.46	1081	608
MS9772-337	2.156	2.168	54.68	54.98	0.205	0.215	5.21	5.46	1109	635
MS9772-338	2.219	2.231	56.26	56.56	0.205	0.215	5.21	5.46	1137	660
MS9772-339	2.281	2.293	57.84	58.14	0.205	0.215	5.21	5.46	1165	686
MS9772-340	2.344	2.356	59.42	59.72	0.205	0.215	5.21	5.46	1193	712
MS9772-341	2.406	2.418	61.00	61.30	0.205	0.215	5.21	5.46	1221	738
MS9772-342	2.469	2.481	62.58	62.88	0.205	0.215	5.21	5.46	1249	764
MS9772-343	2.531	2.543	64.16	64.46	0.205	0.215	5.21	5.46	1277	790
MS9772-344	2.594	2.606	65.74	66.04	0.205	0.215	5.21	5.46	1305	816
MS9772-345	2.656	2.668	67.32	67.62	0.205	0.215	5.21	5.46	1333	842
MS9772-346	2.719	2.731	68.90	69.20	0.205	0.215	5.21	5.46	1361	868
MS9772-347	2.781	2.793	70.48	70.78	0.205	0.215	5.21	5.46	1389	894
MS9772-348	2.844	2.856	72.06	72.36	0.205	0.215	5.21	5.46	1417	919
MS9772-349	2.906	2.918	73.64	73.94	0.205	0.215	5.21	5.46	1445	945
MS9772-350	2.969	2.981	75.22	75.52	0.205	0.215	5.21	5.46	1473	971
MS9772-351	3.031	3.043	76.80	77.10	0.205	0.215	5.21	5.46	1501	997
MS9772-352	3.094	3.106	78.38	78.68	0.205	0.215	5.21	5.46	1529	1023
MS9772-353	3.156	3.168	79.96	80.26	0.205	0.215	5.21	5.46	1557	1049
MS9772-354	3.219	3.231	81.54	81.84	0.205	0.215	5.21	5.46	1585	1075
MS9772-355	3.281	3.293	83.12	83.42	0.205	0.215	5.21	5.46	1613	1101
MS9772-356	3.344	3.356	84.70	85.00	0.205	0.215	5.21	5.46	1641	1127
MS9772-357	3.406	3.418	86.28	86.58	0.205	0.215	5.21	5.46	1669	1153
MS9772-358	3.469	3.481	87.86	88.16	0.205	0.215	5.21	5.46	1697	1178
MS9772-359	3.531	3.543	89.44	89.74	0.205	0.215	5.21	5.46	1725	1204
MS9772-360	3.594	3.606	91.02	91.32	0.205	0.215	5.21	5.46	1753	1230
MS9772-361	3.656	3.668	92.60	92.90	0.205	0.215	5.21	5.46	1781	1256
MS9772-362	3.719	3.731	94.18	94.48	0.205	0.215	5.21	5.46	1809	1282
MS9772-363	3.781	3.793	95.76	96.06	0.205	0.215	5.21	5.46	1837	1308
MS9772-364	3.844	3.856	97.34	97.64	0.205	0.215	5.21	5.46	1865	1334
MS9772-365	3.906	3.918	98.92	99.22	0.205	0.215	5.21	5.46	1893	1360
MS9772-366	3.969	3.981	100.50	100.80	0.205	0.215	5.21	5.46	1921	1386
MS9772-367	4.031	4.043	102.08	102.38	0.205	0.215	5.21	5.46	1949	1412
MS9772-368	4.094	4.106	103.66	103.96	0.205	0.215	5.21	5.46	1977	1437
MS9772-369	4.156	4.168	105.24	105.54	0.205	0.215	5.21	5.46	2005	1463
MS9772-370	4.219	4.231	106.82	107.12	0.205	0.215	5.21	5.46	2033	1489
MS9772-371	4.281	4.293	108.40	108.70	0.205	0.215	5.21	5.46	2061	1515
MS9772-372	4.344	4.356	110.00	110.30	0.205	0.215	5.21	5.46	2089	1541
MS9772-373	4.406	4.418	111.60	111.90	0.205	0.215	5.21	5.46	2117	1567
MS9772-374	4.469	4.481	113.20	113.50	0.205	0.215	5.21	5.46	2145	1593
MS9772-375	4.531	4.543	114.80	115.10	0.205	0.215	5.21	5.46	2173	1619
MS9772-376	4.594	4.606	116.40	116.70	0.205	0.215	5.21	5.46	2201	1645
MS9772-377	4.656	4.668	118.00	118.30	0.205	0.215	5.21	5.46	2229	1671
MS9772-378	4.719	4.731	119.60	119.90	0.205	0.215	5.21	5.46	2257	1697
MS9772-379	4.781	4.793	121.20	121.50	0.205	0.215	5.21	5.46	2285	1723
MS9772-380	4.844	4.856	122.80	123.10	0.205	0.215	5.21	5.46	2313	1749
MS9772-381	4.906	4.918	124.40	124.70	0.205	0.215	5.21	5.46	2341	1775
MS9772-382	4.969	4.981	126.00	126.30	0.205	0.215	5.21	5.46	2369	1801
MS9772-383	5.031	5.043	127.60	127.90	0.205	0.215	5.21	5.46	2397	1827
MS9772-384	5.094	5.106	129.20	129.50	0.205	0.215	5.21	5.46	2425	1853
MS9772-385	5.156	5.168	130.80	131.10	0.205	0.215	5.21	5.46	2453	1879
MS9772-386	5.219	5.231	132.40	132.70	0.205	0.215	5.21	5.46	2481	1905
MS9772-387	5.281	5.293	134.00	134.30	0.205	0.215	5.21	5.46	2509	1931
MS9772-388	5.344	5.356	135.60	135.90	0.205	0.215	5.21	5.46	2537	1957
MS9772-389	5.406	5.418	137.20	137.50	0.205	0.215	5.21	5.46	2565	1983
MS9772-390	5.469	5.481	138.80	139.10	0.205	0.215	5.21	5.46	2593	2009
MS9772-391	5.531	5.543	140.40	140.70	0.205	0.215	5.21	5.46	2621	2035
MS9772-392	5.594	5.606	142.00	142.30	0.205	0.215	5.21	5.46	2649	2061
MS9772-393	5.656	5.668	143.60	143.90	0.205	0.215	5.21	5.46	2677	2087
MS9772-394	5.719	5.731	145.20	145.50	0.205	0.215	5.21	5.46	2705	2113
MS9772-395	5.781	5.793	146.80	147.10	0.205	0.215	5.21	5.46	2733	2139
MS9772-396	5.844	5.856	148.40	148.70	0.205	0.215	5.21	5.46	2761	2165
MS9772-397	5.906	5.918	150.00	150.30	0.205	0.215	5.21	5.46	2789	2191
MS9772-398	5.969	5.981	151.60	151.90	0.205	0.215	5.21	5.46	2817	2217
MS9772-399	6.031	6.043	153.20	153.50	0.205	0.215	5.21	5.46	2845	2243
MS9772-400	6.094	6.106	154.80	155.10	0.205	0.215	5.21	5.46	2873	2269

P A Air Force-II Other Cust Navy-AS	INTERNATIONAL INTEREST ASCC 17/27	TITLE PACKING, PREFORMED - AMS 3617 'O' RING	MILITARY STANDARD	
			MS9772	
PROCUREMENT SPECIFICATION NONE		SUPERSEDES	SHEET 5 OF 7	

DD FORM 672-1 (Limited coordination)

EDITION OF 1 SEP 71 MAY BE USED

APPROVED 22 Dec 71 REVISED

This has been approved by the Dept of the Air Force (II) and the Department of the Navy (AS) and is mandatory for use by their activity. All other military activities are required to comply with this standard when suitable.

Revisions
Navy - AS
Air Force - 82

MS9772**FED. SUP CLASS**
 REVIEW ACTIVITIES
 Navy - AS
 Air Force - 82

PART NUMBER	ID IN.		ID (mm)		T IN.		T (mm)		APPROX MASS	
	MIN	MAX	MIN	MAX	MIN	MAX	MIN	MAX	LB/100	kg/100
MS9772-369	7.945	8.005	201.80	203.33	0.205	0.215	5.21	5.46	3.741	1.697
MS9772-370	8.195	8.255	208.15	209.68	0.205	0.215	5.21	5.46	3.855	1.749
MS9772-371	8.445	8.505	214.50	216.03	0.205	0.215	5.21	5.46	3.969	1.800
MS9772-372	8.695	8.755	220.85	222.38	0.205	0.215	5.21	5.46	4.083	1.852
MS9772-373	8.945	9.005	227.20	228.73	0.205	0.215	5.21	5.46	4.197	1.904
MS9772-374	9.195	9.255	233.55	235.08	0.205	0.215	5.21	5.46	4.312	1.956
MS9772-375	9.445	9.505	239.90	241.43	0.205	0.215	5.21	5.46	4.426	2.008
MS9772-376	9.695	9.755	246.25	247.78	0.205	0.215	5.21	5.46	4.541	2.060
MS9772-377	9.945	10.005	252.60	254.13	0.205	0.215	5.21	5.46	4.655	2.111
MS9772-378	10.195	10.255	258.95	260.48	0.205	0.215	5.21	5.46	4.769	2.163
MS9772-379	10.445	10.505	265.30	266.83	0.205	0.215	5.21	5.46	4.883	2.215
MS9772-380	10.695	10.755	271.65	273.18	0.205	0.215	5.21	5.46	4.997	2.267
MS9772-381	10.945	11.005	278.00	279.53	0.205	0.215	5.21	5.46	5.112	2.319
MS9772-382	11.195	11.255	284.35	285.88	0.205	0.215	5.21	5.46	5.226	2.371
MS9772-383	11.445	11.505	290.70	292.23	0.205	0.215	5.21	5.46	5.340	2.422
MS9772-384	11.695	11.755	297.05	298.58	0.205	0.215	5.21	5.46	5.454	2.474
MS9772-385	11.945	12.005	303.40	304.93	0.205	0.215	5.21	5.46	5.569	2.526
MS9772-386	12.195	12.255	309.75	311.28	0.205	0.215	5.21	5.46	5.683	2.578
MS9772-387	12.445	12.505	316.10	317.63	0.205	0.215	5.21	5.46	5.797	2.630
MS9772-388	12.695	12.755	322.45	323.98	0.205	0.215	5.21	5.46	5.911	2.682
MS9772-389	12.945	13.005	328.80	330.33	0.205	0.215	5.21	5.46	6.026	2.734
MS9772-390	13.195	13.255	335.15	336.68	0.205	0.215	5.21	5.46	6.140	2.786
MS9772-391	13.445	13.505	341.50	343.03	0.205	0.215	5.21	5.46	6.254	2.838
MS9772-392	13.695	13.755	347.85	349.38	0.205	0.215	5.21	5.46	6.368	2.890
MS9772-393	13.945	14.005	354.20	355.73	0.205	0.215	5.21	5.46	6.483	2.942
MS9772-394	14.195	14.255	360.55	362.08	0.205	0.215	5.21	5.46	6.597	2.994
MS9772-395	14.445	14.505	366.90	368.43	0.205	0.215	5.21	5.46	6.711	3.046
MS9772-425	4.460	4.490	113.28	114.05	0.269	0.281	6.83	7.14	3.722	1.688
MS9772-426	4.585	4.615	116.46	117.22	0.269	0.281	6.83	7.14	3.821	1.733
MS9772-427	4.710	4.740	119.63	120.40	0.269	0.281	6.83	7.14	3.919	1.778
MS9772-428	4.835	4.865	122.81	123.57	0.269	0.281	6.83	7.14	4.016	1.822
MS9772-429	4.960	4.990	125.98	126.75	0.269	0.281	6.83	7.14	4.114	1.866
MS9772-430	5.077	5.123	128.96	130.12	0.269	0.281	6.83	7.14	4.213	1.911
MS9772-431	5.202	5.248	132.13	133.30	0.269	0.281	6.83	7.14	4.310	1.955
MS9772-432	5.327	5.373	135.31	136.47	0.269	0.281	6.83	7.14	4.408	1.999
MS9772-433	5.452	5.498	138.48	139.65	0.269	0.281	6.83	7.14	4.506	2.044
MS9772-434	5.577	5.623	141.66	142.82	0.269	0.281	6.83	7.14	4.604	2.088
MS9772-435	5.702	5.748	144.83	146.00	0.269	0.281	6.83	7.14	4.702	2.133
MS9772-436	5.827	5.873	148.01	149.17	0.269	0.281	6.83	7.14	4.800	2.177
MS9772-437	5.952	5.998	151.18	152.35	0.269	0.281	6.83	7.14	4.898	2.222
MS9772-438	6.077	6.123	154.36	155.52	0.269	0.281	6.83	7.14	4.996	2.266
MS9772-439	6.202	6.248	157.53	158.70	0.269	0.281	6.83	7.14	5.094	2.311
MS9772-440	6.327	6.373	160.71	161.87	0.269	0.281	6.83	7.14	5.192	2.355
MS9772-441	6.452	6.498	163.88	165.05	0.269	0.281	6.83	7.14	5.290	2.400
MS9772-442	6.577	6.623	167.06	168.22	0.269	0.281	6.83	7.14	5.388	2.444
MS9772-443	6.702	6.748	170.23	171.40	0.269	0.281	6.83	7.14	5.486	2.488
MS9772-444	6.827	6.873	173.41	174.57	0.269	0.281	6.83	7.14	5.584	2.532
MS9772-445	6.952	6.998	176.58	177.75	0.269	0.281	6.83	7.14	5.682	2.577
MS9772-446	7.077	7.123	179.76	180.92	0.269	0.281	6.83	7.14	5.780	2.621
MS9772-447	7.202	7.248	182.93	184.10	0.269	0.281	6.83	7.14	5.878	2.666
MS9772-448	7.327	7.373	186.11	187.27	0.269	0.281	6.83	7.14	5.976	2.710
MS9772-449	7.452	7.498	189.28	190.45	0.269	0.281	6.83	7.14	6.074	2.755
MS9772-450	7.577	7.623	192.46	193.62	0.269	0.281	6.83	7.14	6.172	2.800
MS9772-451	7.702	7.748	195.63	196.80	0.269	0.281	6.83	7.14	6.270	2.844
MS9772-452	7.827	7.873	198.81	200.00	0.269	0.281	6.83	7.14	6.368	2.888
MS9772-453	7.952	7.998	201.98	203.15	0.269	0.281	6.83	7.14	6.466	2.933
MS9772-454	8.077	8.123	205.16	206.32	0.269	0.281	6.83	7.14	6.564	2.977
MS9772-455	8.202	8.248	208.33	209.50	0.269	0.281	6.83	7.14	6.662	3.022
MS9772-456	8.327	8.373	211.51	212.67	0.269	0.281	6.83	7.14	6.760	3.066
MS9772-457	8.452	8.498	214.68	215.85	0.269	0.281	6.83	7.14	6.858	3.111
MS9772-458	8.577	8.623	217.86	219.01	0.269	0.281	6.83	7.14	6.956	3.155
MS9772-459	8.702	8.748	221.03	222.20	0.269	0.281	6.83	7.14	7.054	3.200
MS9772-460	8.827	8.873	224.21	225.37	0.269	0.281	6.83	7.14	7.152	3.244
MS9772-461	8.952	8.998	227.38	228.55	0.269	0.281	6.83	7.14	7.250	3.289
MS9772-462	9.077	9.123	230.56	231.72	0.269	0.281	6.83	7.14	7.348	3.333
MS9772-463	9.202	9.248	233.73	234.90	0.269	0.281	6.83	7.14	7.446	3.378
MS9772-464	9.327	9.373	236.91	238.06	0.269	0.281	6.83	7.14	7.544	3.422
MS9772-465	9.452	9.498	240.08	241.25	0.269	0.281	6.83	7.14	7.642	3.467
MS9772-466	9.577	9.623	243.26	244.42	0.269	0.281	6.83	7.14	7.740	3.511
MS9772-467	9.702	9.748	246.43	247.60	0.269	0.281	6.83	7.14	7.838	3.556
MS9772-468	9.827	9.873	249.61	250.77	0.269	0.281	6.83	7.14	7.936	3.600
MS9772-469	9.952	9.998	252.78	253.95	0.269	0.281	6.83	7.14	8.034	3.645
MS9772-470	10.077	10.123	255.96	257.12	0.269	0.281	6.83	7.14	8.132	3.689
MS9772-471	10.202	10.248	259.13	260.30	0.269	0.281	6.83	7.14	8.230	3.734
MS9772-472	10.327	10.373	262.31	263.47	0.269	0.281	6.83	7.14	8.328	3.778
MS9772-473	10.452	10.498	265.48	266.65	0.269	0.281	6.83	7.14	8.426	3.823
MS9772-474	10.577	10.623	268.66	269.81	0.269	0.281	6.83	7.14	8.524	3.867
MS9772-475	10.702	10.748	271.83	273.00	0.269	0.281	6.83	7.14	8.622	3.912
MS9772-476	10.827	10.873	275.01	276.17	0.269	0.281	6.83	7.14	8.720	3.956
MS9772-477	10.952	10.998	278.18	279.35	0.269	0.281	6.83	7.14	8.818	4.001
MS9772-478	11.077	11.123	281.36	282.52	0.269	0.281	6.83	7.14	8.916	4.045
MS9772-479	11.202	11.248	284.53	285.70	0.269	0.281	6.83	7.14	9.014	4.090
MS9772-480	11.327	11.373	287.71	288.87	0.269	0.281	6.83	7.14	9.112	4.134
MS9772-481	11.452	11.498	290.88	292.05	0.269	0.281	6.83	7.14	9.210	4.179
MS9772-482	11.577	11.623	294.06	295.22	0.269	0.281	6.83	7.14	9.308	4.223
MS9772-483	11.702	11.748	297.23	298.40	0.269	0.281	6.83	7.14	9.406	4.268
MS9772-484	11.827	11.873	300.41	301.57	0.269	0.281	6.83	7.14	9.504	4.312
MS9772-485	11.952	11.998	303.58	304.75	0.269	0.281	6.83	7.14	9.602	4.357
MS9772-486	12.077	12.123	306.76	307.92	0.269	0.281	6.83	7.14	9.700	4.401
MS9772-487	12.202	12.248	309.93	311.10	0.269	0.281	6.83	7.14	9.798	4.446
MS9772-488	12.327	12.373	313.11	314.26	0.269	0.281	6.83	7.14	9.896	4.490
MS9772-489	12.452	12.498	316.28	317.44	0.269	0.281	6.83	7.14	9.994	4.535
MS9772-490	12.577	12.623	319.46	320.61	0.269	0.281	6.83	7.14	10.092	4.579
MS9772-491	12.702	12.748	322.63	323.80	0.269	0.281	6.83	7.14	10.190	4.624
MS9772-492	12.827	12.873	325.81	326.97	0.269	0.281	6.83	7.14	10.288	4.668
MS9772-493	12.952	12.998	328.98	330.15	0.269	0.281	6.83	7.14	10.386	4.713
MS9772-494	13.077	13.123	332.16	333.32	0.269	0.281	6.83	7.14	10.484	4.757
MS9772-495	13.202	13.248	335.33	336.50	0.269	0.281	6.83	7.14	10.582	4.802
MS9772-496	13.327	13.373	338.51	339.67	0.269	0.281	6.83	7.14	10.680	4.846
MS9772-497	13.452	13.498	341.68	342.85	0.269	0				

MS9772

FED SUP CLASS
5330

PART NUMBER	ID IN		ID (mm)		T IN		T (mm)		APPROX MASS	
	MIN	MAX	MIN	MAX	MIN	MAX	MIN	MAX	Lb/100	kg/100
MS9772-449	9.445	10.005	252.50	254.13	0.269	0.281	6.83	7.14	8 033	3 644
MS9772-450	10.445	10.505	265.30	266.83	0.269	0.281	6.83	7.14	8 425	3 822
MS9772-451	10.445	11.005	278.00	279.53	0.269	0.281	6.83	7.14	8 817	3 999
MS9772-452	11.445	11.505	290.70	292.23	0.269	0.281	6.83	7.14	9 208	4 177
MS9772-453	11.445	12.005	303.40	304.93	0.269	0.281	6.83	7.14	9 600	4 354
MS9772-454	12.445	12.505	316.10	317.63	0.269	0.281	6.83	7.14	9 992	4 532
MS9772-455	12.445	13.005	328.80	330.33	0.269	0.281	6.83	7.14	10 384	4 710
MS9772-456	13.445	13.505	341.50	343.03	0.269	0.281	6.83	7.14	10 776	4 888
MS9772-457	13.445	14.005	354.20	355.73	0.269	0.281	6.83	7.14	11 168	5 066
MS9772-458	14.445	14.505	366.90	368.43	0.269	0.281	6.83	7.14	11 560	5 244
MS9772-459	14.445	15.005	379.60	381.13	0.269	0.281	6.83	7.14	11 952	5 421
MS9772-460	15.445	15.505	392.30	393.83	0.269	0.281	6.83	7.14	12 343	5 599
MS9772-461	15.910	16.000	404.11	406.40	0.269	0.281	6.83	7.14	12 720	5 770
MS9772-462	16.410	16.500	416.81	419.10	0.269	0.281	6.83	7.14	13 112	5 947
MS9772-463	16.910	17.000	429.51	431.80	0.269	0.281	6.83	7.14	13 503	6 125
MS9772-464	17.410	17.500	442.21	444.50	0.269	0.281	6.83	7.14	13 895	6 303
MS9772-465	17.910	18.000	454.91	457.20	0.269	0.281	6.83	7.14	14 287	6 480
MS9772-466	18.410	18.500	467.61	469.90	0.269	0.281	6.83	7.14	14 679	6 658
MS9772-467	18.910	19.000	480.31	482.60	0.269	0.281	6.83	7.14	15 071	6 836
MS9772-468	19.410	19.500	493.01	495.30	0.269	0.281	6.83	7.14	15 463	7 014
MS9772-469	19.910	20.000	505.71	508.00	0.269	0.281	6.83	7.14	15 855	7 192
MS9772-470	20.410	21.000	531.11	533.40	0.269	0.281	6.83	7.14	16 638	7 547
MS9772-471	21.910	22.000	556.51	558.80	0.269	0.281	6.83	7.14	17 422	7 902
MS9772-472	22.880	23.000	581.2	584.2	0.269	0.281	6.83	7.14	18 194	8 253
MS9772-473	23.880	24.000	606.6	609.6	0.269	0.281	6.83	7.14	18 977	8 608
MS9772-474	24.880	25.000	632.0	635.0	0.269	0.281	6.83	7.14	19 761	8 963
MS9772-475	25.880	26.000	657.4	660.4	0.269	0.281	6.83	7.14	20 545	9 319

1. MATERIAL POLYAMIDE AMS 3617
2. DIMENSIONS IN INCHES METRIC CONVERSIONS ARE IN PARENTHESES INTERNATIONAL SYSTEM UNITS (SI) SHOWN ARE FOR REFERENCE ONLY.
3. IDENTIFICATION AND PACKAGING PER AMS 2817 PACKING SHALL NOT BE COILED OR LOOPED
4. DIMENSIONAL INSPECTION PER AS871
5. DO NOT USE UNASSIGNED PART NUMBERS.

AS AND AMS ARE SOCIETY OF AUTOMOTIVE ENGINEERS, INC. PUBLICATIONS
THIS STANDARD WAS DEVELOPED COOPERATIVELY WITH THE MILITARY SERVICES BY THE SAE AEROSPACE PART
STANDARDS DIVISION.

P. A. Air Force - II Other Code Navy - AS	INTERNATIONAL INTEREST ASCC 17/27	TITLE PACKING, PREFORMED - AMS 3617, 'O' RING	MILITARY STANDARD
			MS9772
PROCUREMENT SPECIFICATION NONE	SUPERSEDES	SHEET 7 OF	