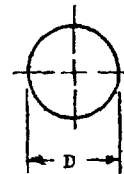
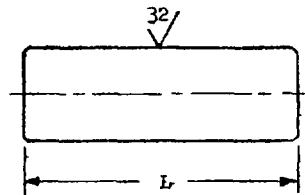

FED. SUP CLASS  
5315**MS9486**L  
±.010

## DIAMETER D AND PART NUMBERS

	.0625 ± .0002		.0938 ± .0002		.1250 ± .00025		.1875 ± .00025	
	PART NUMBER	APPROX WEIGHT LB/100	PART NUMBER	APPROX WEIGHT LB/100	PART NUMBER	APPROX WEIGHT LB/100	PART NUMBER	APPROX WEIGHT LB/100
.125	MS9486-01	.011	MS9486-24	.026	MS9486-47	.045	MS9486-71	.147
.188	MS9486-02	.016	MS9486-25	.037	MS9486-48	.066	MS9486-72	.195
.250	MS9486-03	.022	MS9486-26	.048	MS9486-49	.087	MS9486-73	.244
.312	MS9486-04	.027	MS9486-27	.060	MS9486-50	.109	MS9486-74	.293
.375	MS9486-05	.032	MS9486-28	.072	MS9486-51	.131	MS9486-75	.340
.438	MS9486-06	.038	MS9486-29	.084	MS9486-52	.152	MS9486-76	.388
.500	MS9486-07	.043	MS9486-30	.096	MS9486-53	.173	MS9486-77	.436
.562	MS9486-08	.048	MS9486-31	.108	MS9486-54	.195	MS9486-78	.486
.625	MS9486-09	.053	MS9486-32	.120	MS9486-55	.216	MS9486-79	.534
.688	MS9486-10	.058	MS9486-33	.133	MS9486-56	.238	MS9486-80	.583
.750	MS9486-11	.064	MS9486-34	.144	MS9486-57	.260	MS9486-81	.630
.812	MS9486-12	.069	MS9486-35	.156	MS9486-58	.282	MS9486-82	.680
.875	MS9486-13	.075	MS9486-36	.168	MS9486-59	.304	MS9486-83	.728
.938	MS9486-14	.080	MS9486-37	.180	MS9486-60	.326	MS9486-84	.777
1.000	MS9486-15	.085	MS9486-38	.192	MS9486-61	.347	MS9486-85	.825
1.062	MS9486-16	.091	MS9486-39	.204	MS9486-62	.369	MS9486-86	.874
1.125	MS9486-17	.096	MS9486-40	.216	MS9486-63	.390	MS9486-87	.923
1.188	MS9486-18	.102	MS9486-41	.228	MS9486-64	.413	MS9486-88	.971
1.250	MS9486-19	.107	MS9486-42	.240	MS9486-65	.434	MS9486-89	1.020
1.312			MS9486-43	.252	MS9486-66	.455	MS9486-90	1.070
1.375			MS9486-44	.264	MS9486-67	.478		
1.438			MS9486-45	.276	MS9486-68	.500		
1.500			MS9486-46	.288	MS9486-69	.520		

- 1 PIN TO BE STRAIGHT WITHIN .001 FOR LENGTHS 125 TO 1 000 AND .002 FOR LENGTHS 1.062 TO 1 500.
- 2 MATERIAL: STEEL AMS 5132
- 3 HARDNESS: ROCKWELL C19-26
- 4 IDENTIFICATION. MARK PART NO AND MANUFACTURER'S IDENTIFICATION ON CONTAINER.
- 5 SURFACE ROUGHNESS: AS 291
- 6 BREAK SHARP EDGES .003 - .015
- 7 DIMENSIONS IN INCHES
- 8 DO NOT USE UNASSIGNED PART NUMBERS

AS & AMS ARE SOCIETY OF AUTOMOTIVE ENGINEERS, INC PUBLICATIONS  
THIS STANDARD WAS DEVELOPED COOPERATIVELY WITH THE ENGINE AND PROPELLER UTILITY PARTS COMMITTEE  
OF THE SAE.

P.A. USAP - 11 Other Cust Navy - NP Army - NO	TITLE PIN, STRAIGHT, HEADLESS - AMS 5132, LOCK	MILITARY STANDARD <b>MS 9486</b>
PROCUREMENT SPECIFICATION NONE	SUPERSEDES (A) ANL50201 thru ANL50300	SHEET 1 OF 1

User activities:  
USAF  
Navy  
ArmyUser activities:  
USAF - 11, 85  
Navy - NP  
Army - NO, K, EL

This military standard is approved by the Department of Defense and is mandatory on all activities. Selection for all new engineering and design applications and for repetitive use shall be made from this document.

APPROVED 10 Dec 63  
REVISED 17 Jun 65