

This order has been approved by the Department of the Interior and is mandatory for use by this activity. All other entities are requested to employ this standard where it is applicable.

MS9176 (ASG)

MARK ETO ON SIZES -01 THRU
-14, PART NUMBER ON SIZE
-15 AND LARGER AND MANIF
FACTURE'S IDENTIFICATION
PER AS 478, CLASS 6 OR 7A-

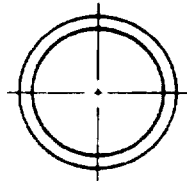
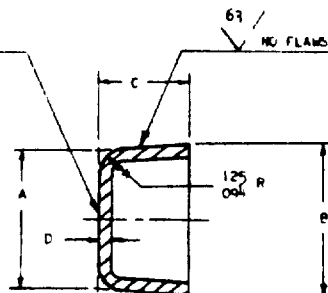

PART NO	NOMINAL PLUG DIA	A DIA		B DIA		C		D		APPROX WEIGHT LB/100
		MIN	MAX	MIN	MAX	MIN	MAX	MIN	MAX	
MS9176-01	.281	.271	.281	.286	.286	.156	.188	.030	.040	0.160
MS9176-02	.312	.302	.312	.317	.320	.156	.186	.030	.040	0.187
MS9176-03	.344	.334	.344	.349	.352	.156	.186	.030	.040	0.213
MS9176-04	.375	.365	.375	.381	.384	.220	.260	.045	.055	0.422
MS9176-05	.406	.396	.406	.412	.415	.220	.260	.045	.055	0.476
MS9176-06	.438	.428	.438	.447	.449	.220	.260	.045	.055	0.529
MS9176-07	.469	.459	.469	.475	.478	.220	.260	.045	.055	0.587
MS9176-08	.500	.490	.500	.506	.509	.360	.400	.045	.055	0.937
MS9176-09	.531	.521	.531	.537	.540	.360	.400	.045	.055	1.005
MS9176-10	.562	.552	.562	.568	.571	.360	.400	.045	.055	1.064
MS9176-11	.594	.584	.594	.600	.603	.360	.400	.045	.055	1.117
MS9176-12	.625	.615	.625	.631	.634	.360	.400	.045	.055	1.270
MS9176-13	.656	.646	.656	.662	.665	.360	.400	.045	.055	1.355
MS9176-14	.688	.678	.688	.694	.697	.360	.400	.045	.055	1.444
MS9176-15	.719	.709	.719	.725	.728	.360	.400	.045	.055	1.540
MS9176-16	.750	.740	.750	.756	.759	.360	.400	.045	.055	1.640
MS9176-17	.812	.802	.812	.818	.821	.480	.520	.045	.055	2.250
MS9176-18	.875	.865	.875	.881	.884	.480	.520	.045	.055	2.465
MS9176-19	.938	.928	.938	.944	.947	.480	.520	.045	.055	2.742
MS9176-20	1.000	.990	1.000	1.006	1.009	.480	.520	.045	.055	3.000
MS9176-21	1.062	1.052	1.062	1.069	1.073	.480	.520	.045	.055	3.230
MS9176-22	1.125	1.115	1.125	1.132	1.136	.480	.520	.045	.055	3.540
MS9176-23	1.188	1.178	1.188	1.195	1.199	.480	.520	.045	.055	3.840
MS9176-24	1.250	1.240	1.250	1.257	1.261	.480	.520	.045	.055	4.100
MS9176-25	1.312	1.302	1.312	1.319	1.323	.480	.520	.045	.055	4.330
MS9176-26	1.375	1.365	1.375	1.382	1.386	.480	.520	.045	.055	4.725
MS9176-27	1.438	1.428	1.438	1.445	1.449	.480	.520	.045	.055	5.040
MS9176-28	1.500	1.490	1.500	1.507	1.511	.480	.520	.045	.055	5.360
MS9176-29	1.625	1.615	1.625	1.633	1.637	.480	.520	.045	.055	6.030
MS9176-30	1.750	1.740	1.750	1.758	1.762	.480	.520	.045	.055	6.710
MS9176-31	1.875	1.865	1.875	1.883	1.887	.480	.520	.045	.055	7.900
MS9176-32	2.000	1.990	2.000	2.008	2.012	.480	.520	.045	.055	8.350

- 1 MATERIAL STEEL, AISC 5040
2 MATERIAL CODE E10 PER AS 267
3 FINISH BLACK OXIDE PER AS 2485
4 SURFACE ROUGHNESS AS 291 UNLESS OTHERWISE SPECIFIED SURFACES TO BE 125 MICROMETERS
5 BREAK SHARP EDGES 003- 015
6 DIMENSIONS IN INCHES.
DO NOT USE UNASSIGNED D-P-T NUMBERS

THIS STANDARD WAS DEVELOPED COOPERATIVELY WITH THE ENGINE AND PROPELLER UTILITY PARTS COMMITTEE OF THE SAF

PA USAF - AF C Other Cust: Navy - et	TITLE PLUG, EXPANSION - TAPERED, AND 504C	MILITARY STANDARD MS9176 (ASG)
PROCUREMENT SPECIFICATION NONE	SUPERSEDES	SHEET Cof