

INCH-POUND

MS9058D
 18 March 1997
 Superseding
 MS9058C
 10 June 1969

MILITARY SPECIFICATION SHEET

RING-BACK-UP, BOSS CONNECTION,
 AMS 3652, AMS 3656, AMS 3660, AMS 3667

This specification is approved for use by all Departments
 and Agencies of the Department of Defense.

The requirements for acquiring the product described herein shall consist of this specification sheet and the issue of the following specification listed in that issue of the Department of Defense Index of Specifications and Standards (DoDISS) specified in the solicitation: None

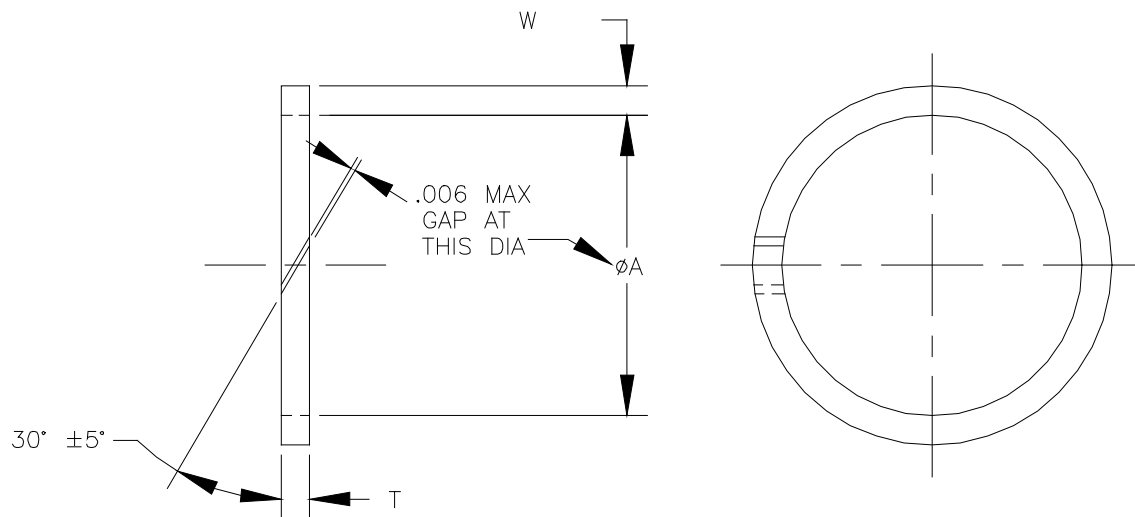

Ⓓ Entire document revised

MS9058D

Table I. Dash Numbers and Dimensions.

Part No.	NOM TUBE O.D.	ØA BASIC	W ± .002	T ± .004	APPROX. WEIGHT LB/100
MS9058-02	.125	.246	.112	.056	.056
MS9058-03	.188	.309	.112	.056	.066
MS9058-04	.250	.360	.117	.061	.085
MS9058-05	.312	.423	.117	.061	.096
MS9058-06	.375	.478	.121	.061	.110
MS9058-07	.438	.549	.121	.061	.120
MS9058-08	.500	.656	.125	.061	.149
MS9058-09	.562	.718	.125	.061	.162
MS9058-10	.625	.769	.131	.073	.216
MS9058-11	.688	.878	.159	.073	.300
MS9058-12	.750	.941	.169	.073	.342
MS9058-14	.875	1.066	.169	.073	.381
MS9058-16	1.000	1.191	.169	.073	.419
MS9058-18	1.125	1.375	.169	.073	.477
MS9058-20	1.250	1.503	.169	.073	.515
MS9058-24	1.500	1.752	.169	.073	.592
MS9058-28	1.750	2.127	.169	.073	.707
MS9058-32	2.000	2.377	.169	.073	.784

REQUIREMENTS:

1. Material: Polytetrafluoroethylene (PTFE) film in accordance with AMS 3652.
Polytetrafluoroethylene Extrusion in accordance with AMS 3656.
Polytetrafluoroethylene (PTFE) Moldings in accordance with AMS 3660.
Polytetrafluoroethylene Sheet in accordance with AMS 3667.
2. Dimensioning and Tolerancing: Dimensioning and Tolerancing shall be in accordance with ASME Y14.5M
3. Edges: Edges to be cut clean and square with in 5°.
4. Part Number: The part number shall consist of the basis MS number followed by a dash number from Table I.

Example: MS9058 -04

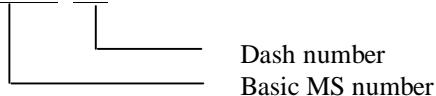

MS9058D

NOTES:

1. Dimension are in inches.
2. Do not use unassigned part numbers.
3. In the event of a conflict between the text of this document and the references cited herein, the text of this document shall take precedence.
4. Unless otherwise specified, issues of referenced documents are those in effect at the time of solicitation.
5. This standard was developed cooperatively with the Engine & Propeller Utility Parts Committee of the SAE.
6. AMS are SAE publications

Military Interests:

Custodians:

Navy - AS
Air Force - 11

Preparing activity:

DLA - IS

(Project 5330-1060)