

FED. SUP CLASS
1680USER SYMBOLS:
NAVY - MC
ARMY - GLREVIEWER SYMBOLS:
NAVY - AS
ARMY - ME
USAF - 11, 82

"Review/user information is current as of the date of this document.
For future coordination of changes to this document, draft circulation
should be based on the information in the current DODISS."

This military standard is mandatory for use by all Departments
& Agencies of the Department of Defense. Selection for all new
engineering and design applications and for repetitive use shall
be made from this document.

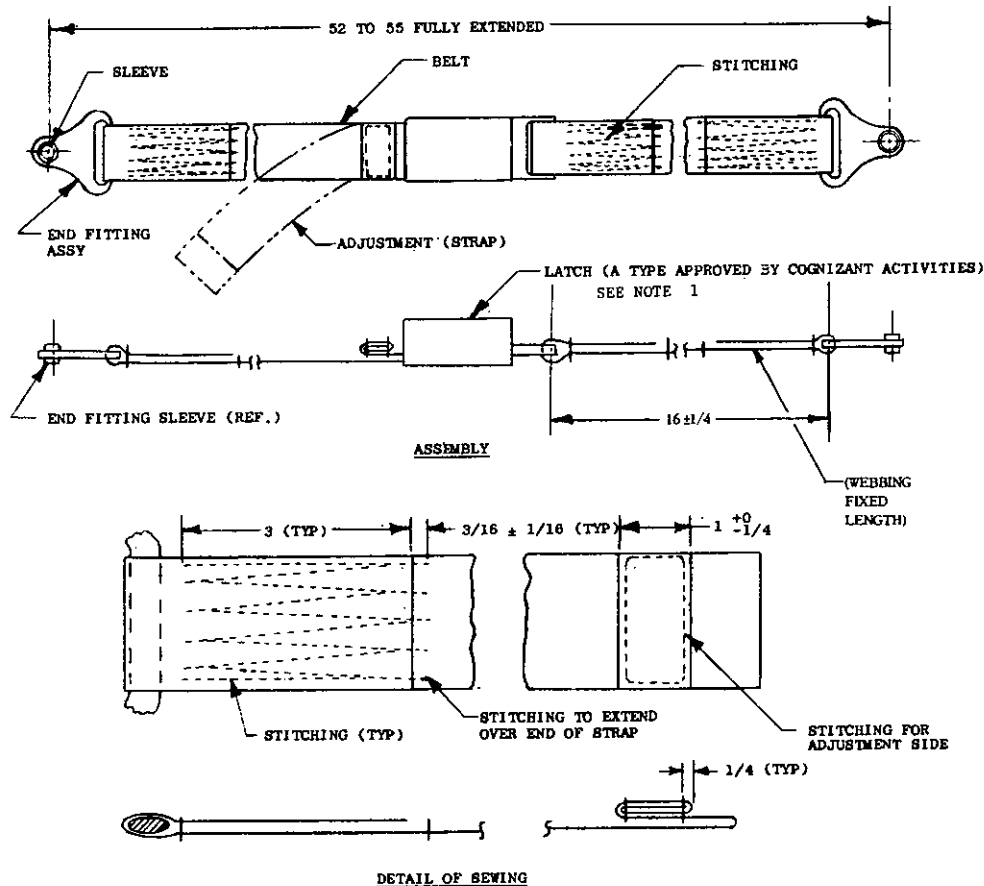

NOTES:

1. **MATERIAL:**
 - A. LATCH: STEEL WITH CAD PLATING (PROVISIONS SHALL BE MADE TO PERMIT TONGUE TO RELEASE BEFORE THE LATCH IS RAISED TO THE VERTICAL POSITION OR THE LATCH SHOULD BE DESIGNED IN SUCH A MANNER THAT THE LATCH CANNOT BE RAISED TO THE VERTICAL POSITION.)
 - B. BELT: WEBBING; TEXTILE, NYLON, LATEX IMPREGNATED, TYPE II, CONFORMING TO SPEC. MIL-W-8630, COLOR: SAGE GREEN.
 - C. END FITTING: STEEL, CONFORMING TO SPEC. MIL-S-8758.
 - D. SLEEVE: TUBING, STEEL, CONFORMING TO SPEC. MIL-T-5066.
 - E. THREAD: SHALL BE NUMBER SIZE 3 CONFORMING TO SPEC: V-T-285, TYPE I OR II, CLASS 1.
 - F. STITCHING: SHALL BE 7 TO 9 STITCHES PER INCH IN ACCORDANCE WITH STANDARD FED-STD-751. ENDS OF ALL STITCHING SHALL BE BACK STITCHED A DISTANCE OF NOT LESS THAN 1/2 INCH.
2. **FINISH:** END FITTING: CAD. PLATE IN ACCORDANCE WITH SPEC. QQ-P-416, CLASS 1, TYPE II, MAGNETIC PARTICLE INSPECTION IN ACCORDANCE WITH MIL-I-6868.
3. **HEAT TREATMENT:** END FITTING: 170,000 TO 190,000 #/in² T.S., IN ACCORDANCE WITH SPEC. MIL-R-6875.
4. **DIMENSIONS IN INCHES.** UNLESS OTHERWISE SPECIFIED, TOLERANCES: DECIMALS ±.002, FRACTIONS ±1/64.
5. SEAR ALL CUT ENDS.

Ⓒ CANCELLED AFTER (31 JAN 74)
NO SUPERSEDING STANDARD

FOR DESIGN FEATURE PURPOSES, THIS STANDARD TAKES PRECEDENCE OVER PROCUREMENT DOCUMENTS REFERENCED HEREIN.
REFERENCED DOCUMENTS SHALL BE OF THE ISSUE IN EFFECT ON DATE OF INVITATIONS FOR BID.

P.A. USAF-82 Other Cust ARMY-ME	TITLE BELT, SAFETY, PASSENGER TYPE	MILITARY STANDARD MS90368
PROCUREMENT SPECIFICATION MIL-B-8607	SUPERSEDES: USAF DWG 44G5437	SHEET 1 OF 2

USER SYMBOLS:
NAVY - MC
ARMY - GL

REVIEWER SYMBOLS:
NAVY - AS
ARMY - ME
USAF - 11, 82

FED. SUP CLASS
1680

END FITTING

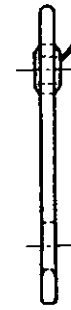
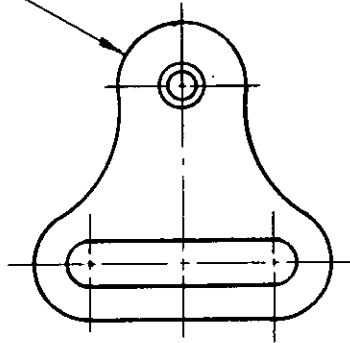

SLEEVE
(EXPAND BOTH
ENDS OF SLEEVE
TO RETAIN
SLEEVE IN PLACE
SLEEVE SHALL
ROTATE FREELY
IN HOLE AFTER
ENDS ARE EX-
PANDED)

END FITTING ASSEMBLY

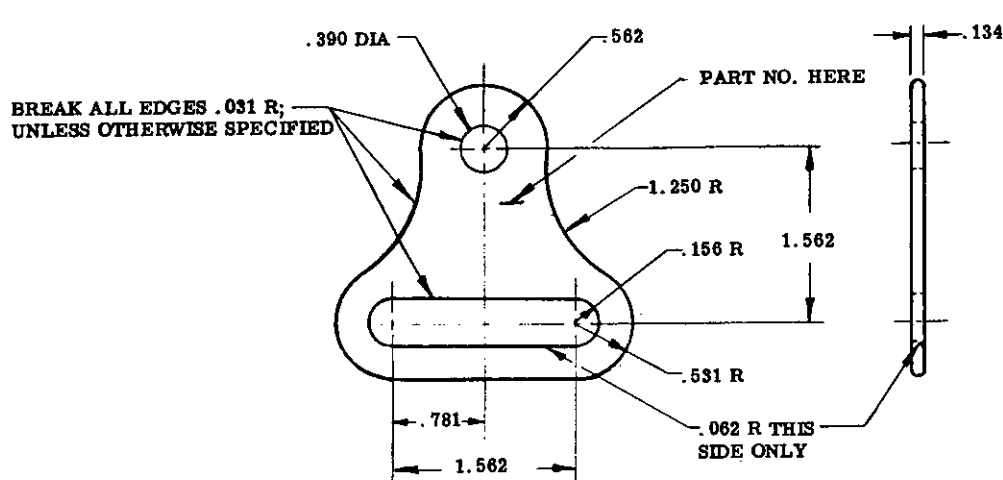

END FITTING
MATERIAL (SEE NOTE 1b)

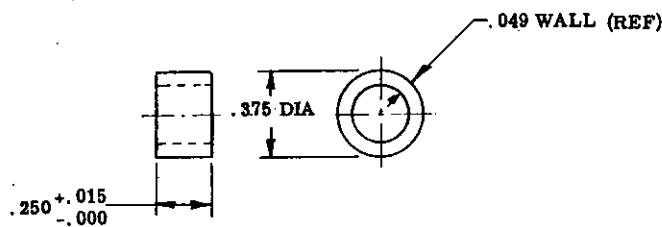

SLEEVE
MATERIAL: (SEE 1c)

"Review/user information is current as of the date of this document.
For future coordination of changes to this document, draft circulation
should be based on the information in the current DODISS."

This military standard is mandatory for use by all Departments
& Agencies of the Department of Defense. Selection for all new
engineering and design applications and for repetitive use shall
be made from this document.

P.A. USAF- 82 Other Cust ARMY - ME	TITLE BELT. SAFETY, PASSENGER TYPE.	MILITARY STANDARD MS90368
PROCUREMENT SPECIFICATION MIL-B-8607	SUPERSEDES: USAF DWG 44G5437	SHEET 2 OF 2

DD FORM 672-1 (Coordinated)

PREVIOUS EDITIONS OF THIS FORM ARE OBSOLETE.

PLATE NO. 15320

APPROVED 8 MARCH 1965 REVISED (B) FOR CHANGES SEE SHEET 1 (C) FOR CHANGES SEE SHEET 1