

FED. SUP CLASS  
5340

MS9025

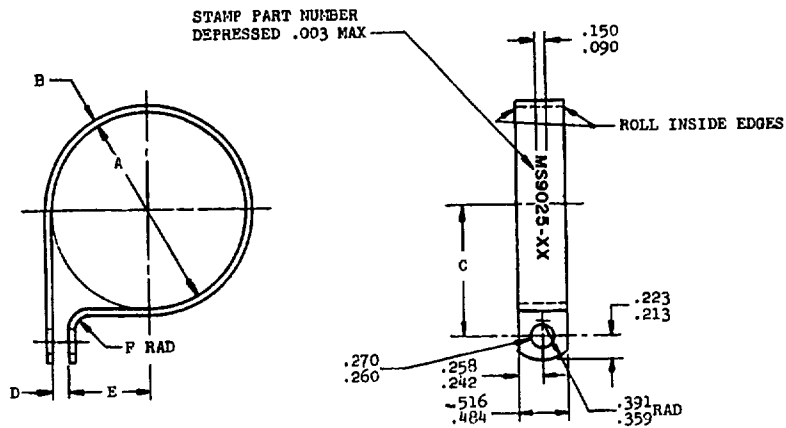

User activities:

USAF - 82, 85

Review activities:

This military standard is approved by the Department of Defense and is mandatory on all activities. Selection for use in manufacturing and design applications and for repetitive use shall be made from this document.

PART NO.	FIIN	NOM TUBE OD	A DIA BASIC	B $\pm .005$	C $\pm .010$	D	E REF	F RAD $\pm .016$	APPROX WEIGHT LBS. EA.
MS9025-01		.125	.125	.031	.360	.062-.078	0	.062	.0055
MS9025-02		.188	.188	.031	.423	.062-.078	.031	.062	.0066
MS9025-03		.250	.250	.031	.457	.062-.078	.062	.062	.0075
MS9025-04		.312	.312	.031	.498	.062-.078	.094	.062	.0085
MS9025-05		.375	.375	.031	.529	.062-.078	.125	.062	.0094
MS9025-06		.438	.438	.031	.560	.062-.078	.156	.062	.0103
MS9025-07		.500	.500	.031	.592	.062-.078	.188	.062	.0112
MS9025-08		.562	.562	.031	.623	.062-.078	.219	.062	.0122
MS9025-09		.625	.625	.031	.654	.062-.078	.250	.062	.0131
MS9025-10		.688	.688	.051	.752	.062-.078	.281	.109	.0237
MS9025-11		.750	.750	.051	.783	.062-.078	.312	.109	.0252
MS9025-12		.812	.812	.051	.814	.062-.078	.344	.109	.0267
MS9025-13		.875	.875	.051	.845	.062-.078	.375	.109	.0283
MS9025-14		.938	.938	.051	.877	.062-.078	.406	.109	.0298
MS9025-15		1.000	1.000	.051	.908	.062-.078	.438	.109	.0313
MS9025-16		1.062	1.062	.051	.939	.062-.078	.469	.109	.0331
MS9025-17		1.125	1.125	.051	.970	.062-.078	.500	.109	.0343
MS9025-18		1.188	1.188	.051	1.002	.062-.078	.531	.109	.0359
MS9025-19		1.250	1.250	.064	1.062	.094-.110	.531	.125	.0471
MS9025-20		1.312	1.312	.064	1.093	.094-.110	.562	.125	.0490
MS9025-21		1.375	1.375	.064	1.125	.094-.110	.594	.125	.0509
MS9025-22		1.438	1.438	.064	1.156	.094-.110	.625	.125	.0528
MS9025-23		1.500	1.500	.064	1.188	.094-.110	.656	.125	.0547
MS9025-24		1.562	1.562	.064	1.219	.094-.110	.688	.125	.0566
MS9025-25		1.625	1.625	.064	1.250	.094-.125	.719	.125	.0585
MS9025-26		1.750	1.750	.064	1.312	.094-.125	.781	.125	.0623
MS9025-27		1.875	1.875	.064	1.375	.094-.125	.844	.125	.0661
MS9025-28		2.000	2.000	.064	1.438	.094-.125	.906	.125	.0696

MATERIAL: CORROSION RESISTANT STEEL AMS5510.  
REMOVE BURRS AND SHARP EDGES.

DIMENSIONS IN INCHES.

CLAMP SHALL BE FORMED AS SHOWN. DIMENSION "D" SHALL FALL WITHIN THE SPECIFIED LIMITS WHEN CLAMP IS ASSEMBLED ON A BAR THE DIA OF WHICH IS EQUAL TO THE NOMINAL TUBE OD WITHIN  $\pm .001$ . HOLES SHALL BE IN ALIGNMENT WITHIN .010 AND CLAMP SHALL BE FLAT WITHIN .010 THRU CLAMP WIDTH WHEN ASSEMBLED ON TEST BAR. IN THE FREE POSITION CLAMP MAY SPRING OPEN PROVIDED THE ABOVE CONDITIONS ARE MET.

DO NOT USE UNASSIGNED PART NUMBERS.

AMS IS A SOCIETY OF AUTOMOTIVE ENGINEERS, INC. PUBLICATION.

THIS MILITARY STANDARD WAS DEVELOPED COOPERATIVELY WITH THE MILITARY SERVICES BY THE AIR AND SPACE PROTECTION DIVISION.

CUSTODIAN PIA, USAF - 11

NAVY - AS

ARMY - AV

PROCUREMENT SPECIFICATION  
None

MILITARY STANDARD

CLAMP - LOOP TYPE SUPPORT (HEAT RESISTANT) .265 HOLE

MS9025

SHEET 1 OF 1

THE FORM  
1-90W 66 233

U. S. GOVERNMENT PRINTING OFFICE: 1964-301370/AMSI 81 50178

APPROVED 10 MAY 56  
REVISED 15 MAY 68

INCH-POUND

NOTICE  
OF VALIDATION

MS9025A  
NOTICE 1  
3 October 1991

MILITARY STANDARD

CLAMP – LOOP TYPE SUPPORT (HEAT RESISTANT) .265 HOLE

MS9025A, dated 15 May 1968, has been reviewed and determined to be valid for use in acquisition.

Custodians:

Army – AV  
Navy – AS  
Air Force – 11

Preparing activity:

Navy – AS

AMSC N/A

FSC 5340

DISTRIBUTION STATEMENT A. Approved for public release; distribution is unlimited