

MS 9016(ASG)

Government drawings, specifications, or other data are used for any purpose other than in connection with a definitely related Government procurement operation, the United States Government thereby incurs no responsibility, nor any obligation whatsoever; and the fact that the Government may have furnished, furnished, or in any way supplied the said drawings, specifications, or other data is not to be regarded by implication or otherwise as in any way endorsing the holder or any other person or corporation, or conveying any rights or permission to manufacture, use, or sell any patented invention that may in any way be related thereto.

CUSTODIAN
Navy-BuAer
Air Force

PROCUREMENT SPECIFICATION
NONE

MARK OVERSIZE IDENTIFICATION
ON THIS END AS SHOWN IN TABLE

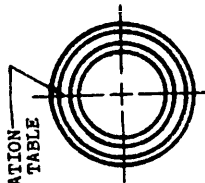

THD MARKS PERMISSIBLE

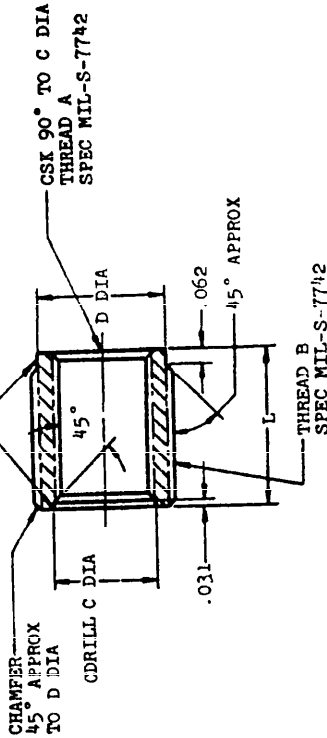

SECTION THRU THD B PROFILE

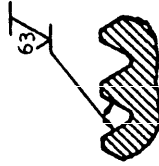

(3) .6875-16NS
MAJOR DIA = .6875 MIN
PITCH DIA = .6469-.6515
MINOR DIA = .6198-.6287

SPEC MIL-S-7742												
STANDARD				+.003 OVERSIZE				+.006 OVERSIZE				
THREAD A	L	C +.010 -.000	D +.000 -.020	SIZE	(4) THREAD B		PD THD B	PART NO.	ONE MARK		TWO MARKS	
					MAJOR DIA	MINOR DIA MAX			PD THD B	PART NO.	PD THD B	PART NO.
.190-32UNF-3B	.375	.203	.259	.3125-24NS	.3053-.3125	.2647	.2876-.2888	MS9016-10	.2906-.2918	MS9016-11	.2936-.2948	MS9016-12
.250-28UNF-3B	.500	.266	.373	.4375-20NS	.4294-.4375	.3797	.4073-.4086	MS9016-13	.4103-.4116	MS9016-14	.4133-.4146	MS9016-15
.3125-24UNF-3B	.562	.328	.436	.500-20NS	.4919-.5000	.4422	.4698-.4711	MS9016-16	.4728-.4741	MS9016-17	.4758-.4771	MS9016-18
.375-24UNF-3B	.625	.391	.491	.5625-18NS	.5538-.5625	.4983	.5289-.5304	MS9016-19	.5319-.5334	MS9016-20	.5349-.5364	MS9016-21
.4375-20UNF-3B	.688	.453	.554	.625-18NS	.6163-.6250	.5608	.5914-.5929	MS9016-22	.5944-.5959	MS9016-23	.5974-.5989	MS9016-24
.500-20UNF-3B	.750	.516	.607	.6875-16NS	.6781-.6875	.6150	.6495-.6511	MS9016-25	.6525-.6541	MS9016-26	.6555-.6571	MS9016-27
.5625-18UNF-3B	.812	.578	.670	.750-16NS	.7406-.7500	.6775	.7120-.7136	MS9016-28	.7150-.7166	MS9016-29	.7180-.7196	MS9016-30
.625-18UNF-3B	.875	.641	.733	.8125-16NS	.8031-.8125	.7404	.7747-.7765	MS9016-31	.7777-.7795	MS9016-32	.7807-.7825	MS9016-33
.6875-16NS	.938	.703	.795	.875-16NS	.8656-.8750	.8029	.8372-.8390	MS9016-34	.8402-.8420	MS9016-35	.8432-.8450	MS9016-36

NOTE: (1) PITCH DIAMETERS OF THREADS SHALL BE CONCENTRIC WITHIN .005 PIR.
(2) PITCH DIAMETER TAPER FOR THD B SHALL NOT EXCEED .002 PER INCH. IF TAPERED, LARGE END SHALL BE AT CDRILL C END.
(4) MAJOR DIA IS SAME FOR STD, + .003 AND + .006 OVERSIZES; MINOR DIA INCREASES AS PER INCREMENT OF OVERSIZE.

MATERIAL:

STEEL AMS 5024.

FINISH: CADMIUM PLATE AMS 2400.

SURFACE ROUGHNESS: AS 107.

BREAK SHARP EDGES .003-.015 UNLESS OTHERWISE SPECIFIED.

DIMENSIONS IN INCHES. UNLESS OTHERWISE SPECIFIED: TOLERANCES; LINEAR DIMENSIONS ±.010, ANGULAR DIMENSIONS ±2°.

DO NOT USE UNASSIGNED PART NUMBERS.

THIS STANDARD WAS DEVELOPED COOPERATIVELY WITH THE ENGINE AND PROPELLER UTILITY PARTS COMMITTEE OF THE SAE.

FED. SUP CLASS.
1.730

APPROVED 31 AUG 54 REVISED

MILITARY STANDARD

BUSHING - SCREW, PLAIN

MS 9016(ASG)

SHEET 1 OF 1