

REVIEWER: AT AV MI EA
USER: EL ME MU PA GL WV YD WC

Military standard is approved for use by all Departments and Agencies of the Department of Defense. Selection for all new engineering and design applications and for repetitive use shall be made from this document when applicable.

		FED. SUP CLASS 5310															
NOMINAL SIZE		1/4 (.250)		5/16 (.312)		3/8 (.375)		7/16* (.437)		1/2 (.500)		9/16* (.562)		5/8 (.625)			
THREADS PER INCH (-2B)		20 UNC	28 UNF	18 UNC	24 UNF	16 UNC	24 UNF	14 UNC	20 UNF	13 UNC	20 UNF	12 UNC	18 UNF	11 UNC	18 UNF		
B WIDTH ACROSS FLATS	NOM	.437		.500		.562		.687		.750		.875		.937			
	MAX	.4385		.5020		.5645		.6895		.7520		.8770		.9395			
	MIN	.428		.489		.551		.675		.736		.861		.922			
C WIDTH ACROSS CORNERS	REF	.488		.557		.628		.768		.840		.982		1.051			
H THICKNESS	MAX	.328		.359		.469		.524		.609		.656		.765			
	MIN	.212		.258		.320		.365		.427		.473		.535			
MATERIAL		DASH NO.		DASH NO.		DASH NO.		DASH NO.*		DASH NO.		DASH NO.*		DASH NO.			
STEEL, CARBON-CAD PLATED		1	5	9	13	17	21	25*	29*	33	37	41*	45*	49	53		
STEEL, CORROSION-RESISTING		2	6	10	14	18	22	26*	30*	34	38	42*	46*	50	54		
BRASS		3	7	11	15	19	23	27*	31*	35	39	43*	47*	51	55		
AL ALLOY			8		16		24		32*		40		48*		56		
STEEL, CARBON-UNCOATED			90*				91*		92*								
NOMINAL SIZE		3/4 (.750)		7/8* (.875)		1 (1.000)		1-1/8 (1.125)		1-1/4 (1.250)		1-3/8* (1.375)		1-1/2 (1.500)			
THREADS PER INCH (-2B)		10 UNC	16 UNF	9 UNC	14 UNF	8 UNC	12 UNF	7 UNC	12 UNF	7 UNC	12 UNF	6 UNC	12 UNF	6 UNC	12 UNF		
B WIDTH ACROSS FLATS	NOM	1.125		1.312		1.500		1.687		1.875		2.062		2.250			
	MAX	1.1270		1.3145		1.5020		1.6895		1.8770		2.0645		2.2520			
	MIN	1.088		1.269		1.450		1.631		1.812		1.994		2.175			
C WIDTH ACROSS CORNERS	REF	1.240		1.447		1.653		1.859		2.066		2.273		2.480			
H THICKNESS	MAX	.890		.999		1.124		1.281		1.422		1.609		1.671			
	MIN	.617		.724		.831		.939		1.030		1.138		1.245			
MATERIAL		DASH NO.		DASH NO.*		DASH NO.		DASH NO.		DASH NO.		DASH NO.*		DASH NO.			
STEEL, CARBON-CAD PLATED		57	61	65*	68*	72	76	80	81	82	83	84*	85	86			
STEEL, CORROSION-RESISTING			62	66*	69*		77										
BRASS		59	63	67*	70*	74	78										
AL ALLOY			64		71*		79										
<p>NOTES:</p> <ol style="list-style-type: none"> MATERIAL: Steel, Carbon, Grade B; Steel, Corrosion-Resisting; Brass; or Aluminum Alloy in accordance with procurement specification. Non-metallic insert shall be nylon or equivalent. PROTECTIVE COATING: Steel, Carbon: Cadmium plated in accordance with procurement specification. Steel, Corrosion-Resisting: Passivated in accordance with procurement specification. Aluminum Alloy-Anodized in accordance with procurement specification. Brass-Uncoated. THREADS: The threads shall be in accordance with Screw Thread Standards for Federal Services, Handbook H28. DIMENSIONS: All dimensions are in inches. PART NUMBER: The MS part number consists of the MS number, plus the dash number. Example: MS51922-1. Referenced documents shall be of the issue in effect on date of invitation for bids. For design feature purposes, this standard takes precedence over procurement documents referenced herein. INACTIVE FOR NEW DESIGN AFTER 23 JUNE 1976. <p>(E) ENTIRE STANDARD REVISED</p>																	
P.A. WC		TITLE										MILITARY STANDARD					
Other Cust 82 05		NUT, SELF-LOCKING, HEXAGON-PREVAILING TORQUE, GENERAL PURPOSE, 250°F, UNC-2B AND UNF-2B										MS 51922					
PROCUREMENT SPECIFICATION MIL-N-45913		SUPERSEDES: BBSX2 and BBSX4 in part.										SHEET 1 OF 2					

REVIEWER: EL AT AV M1 EA
USER: ME MU PA CL WY YD MC

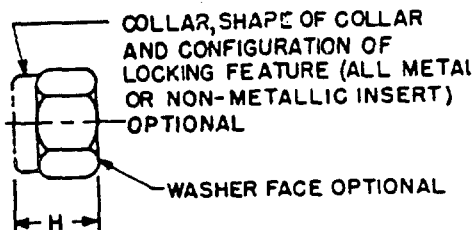
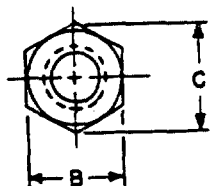

FED. SUP CLASS
5310

TABLE II
METRIC TRANSLATION OF TABLE I

NOMINAL SIZE		MM	6.350		7.938		9.525		11.112*		12.700		14.288*		15.875	
THREAD PITCH			1.270	0.907	1.411	1.058	1.588	1.058	1.814	1.270	1.954	1.270	2.117	1.411	2.309	1.411
B	WIDTH	NOM	11.112		12.700		14.288		17.462		19.050		22.225		23.812	
	ACROSS	MAX	11.138		12.751		14.338		17.513		19.101		22.276		23.863	
	FLATS	MIN	10.871		12.421		13.995		17.145		18.694		21.869		23.419	
C	ACROSS CORNERS	REF	12.395		14.148		15.951		19.507		21.336		24.943		26.695	
H	THICKNESS	MAX	8.331		9.119		11.913		13.310		15.469		16.662		19.431	
		MIN	5.384		6.553		8.128		9.271		10.845		12.014		13.589	
MATERIAL			DASH NO.		DASH NO.		DASH NO.		DASH NO.*		DASH NO.		DASH NO.*		DASH NO.	
STEEL, CARBON-CAD PLATED STEEL, CORROSION-RESIST BRASS AL ALLOY STEEL, CARBON-UNCOATED			1	5	9	13	17	21	25*	29*	33	37	41*	45*	49	53
			2	6		14	18	22	30*	34*		38	46*	50*		54
			3	7	11	15	19	23	31*	35*	35	39	47*	51*	51	55
				8		16		24	32*	36*		40	48*	52*		56
				90*			91*	92*								

NOMINAL SIZE		MM	19.050		22.225*		25.400		28.575		31.750		34.925*		38.100	
THREAD PITCH			2.540	1.588	2.822	1.814	3.175	2.117	3.629	2.117	3.629	2.117	4.233		4.233	2.117
B	WIDTH	NOM	28.575		33.338		38.100		42.862		47.625		52.388		57.150	
	ACROSS	MAX	28.626		33.388		38.151		42.913		47.676		52.438		57.201	
	FLATS	MIN	27.635		32.233		36.830		41.427		46.025		50.648		55.245	
C	ACROSS CORNERS	REF	31.496		36.754		41.986		47.219		52.476		57.734		62.992	
H	THICKNESS	MAX	22.606		25.375		28.550		32.537		36.189		40.869		42.443	
		MIN	15.671		18.389		21.107		23.850		26.162		28.905		31.523	
MATERIAL			DASH NO.		DASH NO.*		DASH NO.		DASH NO.		DASH NO.		DASH NO.*		DASH NO.	
STEEL, CARBON-CAD PLATED			57	61	65*	68*	72	76	80	81	82	83	84*		85	86
STEEL, CORROSION-RESIST				62		69*		77								
BRASS			54	63	66*	70*	74	78								
AL ALLOY				64		71*		79								

NOTE:

All dimensions are in Millimetres (mm) unless otherwise specified and are based on approximate conversion factor of 25.4mm equal one inch.

APPROVED 24 FEB 1962 REVISED (A) 24 JUN 1963 (B) 9 AUG 1965 (C) 17 MAY 1968 (D) 30 MAR 1970 (E) FOR CHANGES SEE SHEETS I AND 2

P.A. NO. Other Cust 82 05	TITLE NUT, SELF-LOCKING, HEXAGON- PREVAILING TORQUE, GENERAL PURPOSE, 250F	MILITARY STANDARD MS 51922
PROCUREMENT SPECIFICATION MIL-N-45913	SUPERSEDES: BBSX2 and BBSX4 in part	SHEET 2 OF 2