

FED. SUP CLASS  
4730

Ⓐ User Activities:  
Navy - OS, NC

Ⓐ Review Activities:  
Army - AT, ME  
Air Force - B2  
DIA - CS

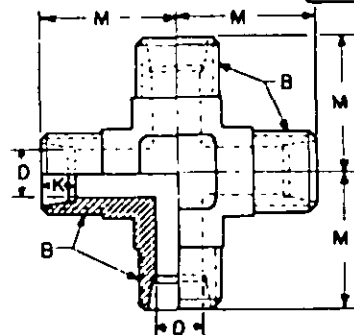
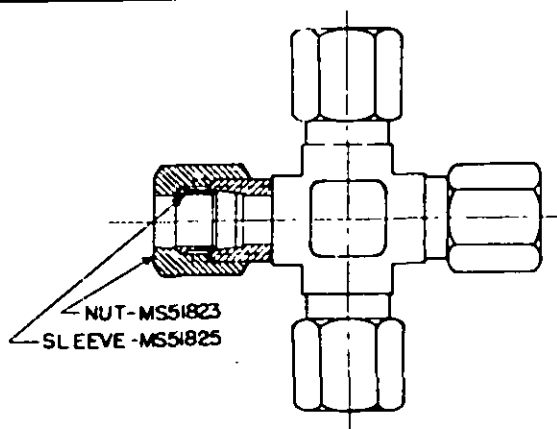

DASH NUMBER		TUBE O.D.	B	D	K	M
ASSY	*BODY	NOM	STRAIGHT THREAD CLASS 2A	DIAMETER DRILL	+0.015 -0.005	+0.03
1	21	1/8	5/16-24UNF	0.093	0.188	0.77
2	22	3/16	3/8-24UNF	0.125	0.234	0.83
3	23	1/4	7/16-20UNF	0.203	0.234	0.89
4	24	5/16	1/2-20UNF	0.234	0.250	0.95
5	25	3/8	9/16-18UNF	0.281	0.250	1.05
6	26	1/2	3/4-16UNF	0.422	0.305	1.25
7	27	5/8	7/8-14UNF	0.500	0.350	1.42
8	28	3/4	1-1/16-12UN	0.656	0.350	1.58
9	29	7/8	1-1/16-12UN	0.718	0.350	1.62
10	30	1	1-5/16-12UN	0.875	0.415	1.71
11	31	1-1/4	1-5/8-12UN	1.093	0.415	1.89
12	32	1-1/2	1-7/8-12UN	1.344	0.485	2.02
13	33	2	2-1/2-12UN	1.811	0.485	2.45

## NOTES:

- MATERIAL:** Steel, carbon in accordance with procurement specification.  
Steel, corrosion-resisting in accordance with procurement specification.
- PROTECTIVE COATING:** Cadmium plated in accordance with procurement specification.  
Zinc plated in accordance with procurement specification.  
Phosphate coating in accordance with procurement specification.  
Passivation treatment in accordance with procurement specification.
- DIMENSIONS AND TOLERANCES:** Dimensions and tolerances not shown shall be in accordance with SAE Standard for Flareless Tube Fittings (SAE J514).
- THREADS:** Threads shall be in accordance with Screw-Thread Standards for Federal Services, FED-STD-H28.
- PART NUMBER:** The MS part number consists of the MS number, plus the dash number and (for complete assembly) the applicable MS51825 sleeve style designator.
  - For complete assembly (with nuts and sleeves), cadmium plated, use the MS number, plus the assembly dash number and the sleeve style designator. Example: MS51894-1A or MS51894-1B.
  - For body only, cadmium plated, use the MS number and the body dash number. Example: MS51894-21.
  - For zinc coating add "Z" and (for complete assembly) the sleeve style designator to the dash number. Example: MS51894-1ZA or MS51894-1ZB or MS51894-21Z.
  - For phosphate coating add "P" and (for complete assembly) the sleeve style designator to the dash number. Example: MS51894-1PA or MS51894-1PB or MS51894-21P.
  - For corrosion-resisting steel add "SS" and (for complete assembly) the sleeve style designator to the dash number. Example: MS51894-1SSA or MS51894-1SSB or MS51894-21SS.
- For design feature purposes, this standard takes precedence over procurement documents referenced herein.
- Reference documents shall be of the issue in effect on date of invitations for bid.
- The illustration is for identification and is not intended to restrict designs or shapes not dimensioned.
- The bodies will be used for production only and shall not be stocked for maintenance.

Ⓐ

Ⓐ Denotes change

P.A. Other Cust.	AR NH 99	TITLE  CROSS, TUBE, FLARELESS TYPE, HYDRAULIC	MILITARY STANDARD  MS51894
PROCUREMENT SPECIFICATION MIL-F-18866	SUPERSEDES	SHEET 1 OF 1	