

NOTICE—When Government drawings, specifications, or other data are used for any purpose other than in connection with a definitely related Government procurement operation, the United States Government thereby incurs no responsibility, nor any obligation whatever; and the fact that the Government may have furnished, furnished, or in any way supplied the said drawings, specifications, or other data is not to be regarded by implication or otherwise as in any manner licensing the holder or any other person or corporation, or carrying any right of permission to manufacture, use, or sell any patented invention that may in any way be related thereto.

This standard has been approved by the QMC Department of the ARMY and is mandatory for use by that activity. All other military activities are required to employ this standard where suitable.

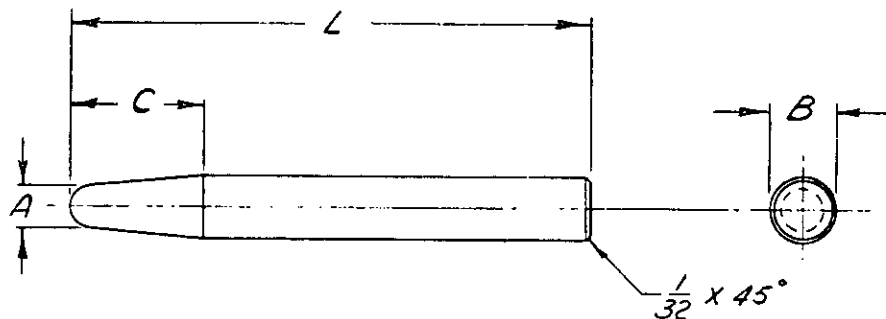

MS PART NO.	DIAMETER		LENGTH	
	A	B	C	L
MS -1	3/16	1/4	3/8	4
MS -2	5/16	1/2	1-3/4	4
MS -3	1/2	3/4	1-7/8	6
MS -4	5/8	3/4	1-7/8	12
MS -5	3/4	7/8	7-3/4	7-3/4

1. MATERIAL.— BRASS ROD, COMPOSITION 22, HALFHARD, IN ACCORDANCE WITH FEDERAL SPECIFICATION QQ-B-626.
2. MACHINED ENDS.— LARGE END CHAMFERED, SMALL END ROUNDED.
3. DIMENSIONS.— INCHES
4. TOLERANCES.— $A \pm 1/32$, $B \pm 0.002$, $C \pm 1/16$, $L \pm 1/16$.
5. MS PART NO. 6 THRU 8 OF MS 51800 (ORD) DELETED AND ARE MS PART NO. 1 THRU 3 OF MS 63046(QMC) PUNCH, DRIVE PINS, BRASS.

CANCELLED

EFFECTIVE DATE

28 MAY 1968

NOTES:

1. REFERENCED DOCUMENTS SHALL BE THE ISSUE IN EFFECT ON DATE OF INVITATION FOR BID.
2. THIS STANDARD TAKES PRECEDENCE OVER DOCUMENTS REFERENCED HEREIN

ENTIRE STANDARD REVISED

P.A.	QMC	TITLE	MILITARY STANDARD
Other Cust		DRIFT PINS, BRASS	MS 51800
Procurement Specification	NONE	SUPERSEDES: MS 51800 (ORD)	SHEET 1 OF 1

DD FORM 672 (Limited coordination) PREVIOUS EDITIONS OF THIS FORM ARE OBSOLETE.

☆ U. S. GOVERNMENT PRINTING OFFICE: 1968-301-520/6342

APPROVED 12 DEC 58 REVISED 15 NOV 60