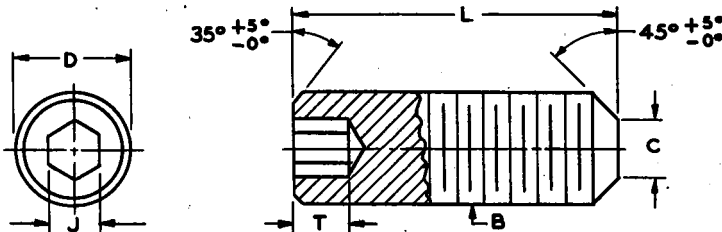

FED. SUP. CLASS.
5305

D NOMINAL SIZE		#0 (.060)		#2 (.086)		#4 (.112)		#6 (.138)		#8 (.164)	
B THREADS PER INCH		80NF-3A		64NF-3A		48NF-3A		40NF-3A		36NF-3A	
J WIDTH OF SOCKET ACROSS FLAT	MAX.	.0285		.0355		.051		.0635		.0791	
	MIN.	.028		.035		.050		.0625		.0781	
C DIAMETER OF POINT	MAX.	.033		.047		.061		.074		.087	
	MIN.	.027		.039		.051		.064		.076	
T KEY ENGAGEMENT		MIN.		.022		.028		.040		.050	
L LENGTH	TOLERANCE	DASH No.	FIIN	DASH No.	FIIN	DASH No.	FIIN	DASH No.	FIIN	DASH No.	FIIN
1/16	± 1 1/2% OF L WITH A MINIMUM OF ± .010 IN.	1*		7*		16*		25*		35*	
1/8				8*		17*		26*		36*	
3/16				9*		18*		27*		37*	
1/4						19*		28*		38*	
5/16											
3/8								29*		39*	
1/2										40*	
5/8										41*	
3/4										42*	

D NOMINAL SIZE		#10 (.190)	1/4		5/16		3/8		1/2		
B THREADS PER INCH		32NF-3A	28UNF-3A		24UNF-3A		24UNF-3A		20UNF-3A		
J WIDTH OF SOCKET ACROSS FLAT	{MAX. MIN.	.0947 .0937	.127 .125		.1532 .1562		.1895 .1875		.2520 .2500		
C DIAMETER OF POINT	{MAX. MIN.	.102 .088	.132 .118		.172 .156		.212 .194		.291 .270		
T KEY ENGAGEMENT MIN.		.075	.100		.125		.150		.200		
L LENGTH	TOLERANCE	DASH No.	FIIN	DASH No.	FIIN	DASH No.	FIIN	DASH No.	FIIN	DASH No.	FIIN
3/16	± 1 1/2% OF L WITH A MINIMUM OF ± .010 IN.	48		60		73*		86*		98*	
1/4		49		61*		74		87		99*	
5/16		50*		62		75		88		100	
3/8		51*		63*		76*					
1/2		52*									
5/8	± .010 IN.	53*		64*		77*		89*		101*	
3/4		54*		65*		78*		90*		102*	
7/8				66*		79*		91*		103*	
				67*		80*		92*		104*	
1											

* INDICATES MANUFACTURER'S NON-STOCK PRODUCTION ITEMS.

KEY ENGAGEMENT: THESE DIMENSIONS APPLY TO SCREWS ONE DIAMETER IN LENGTH OR LONGER. FOR SCREWS SHORTER THAN ONE DIAMETER IN LENGTH, SOCKET TO BE AS DEEP AS PRACTICABLE.**MATERIAL:** STEEL, HIGH-GRADE ALLOY, IN ACCORDANCE WITH PROCUREMENT SPECIFICATION.**HARDNESS:** SETSCREWS SHALL BE HARDENED BY HEAT TREATMENT TO A HARDNESS OF ROCKWELL C45 TO 53.**PROTECTIVE COATING:** CADMIUM PLATED, IN ACCORDANCE WITH SPECIFICATION QQ-P-416, TYPE II, CLASS 3.

ZINC PLATED, IN ACCORDANCE WITH SPECIFICATION QQ-Z-325, TYPE II, CLASS 3.

THREADS: THE THREADS SHALL BE IN ACCORDANCE WITH SCREW-THREAD STANDARDS FOR FEDERAL SERVICES HANDBOOK H-28.**DIMENSIONS:** ALL DIMENSIONS ARE IN INCHES UNLESS OTHERWISE SPECIFIED.**PART NUMBER:** THE MS PART NUMBER CONSISTS OF THE MS NUMBER, PLUS THE DASH NUMBER. EXAMPLE: MS51026-1.**NOTES:** (1) REFERENCED DOCUMENTS SHALL BE OF THE ISSUE IN EFFECT ON DATE OF INVITATIONS FOR BID.

(2) THIS STANDARD TAKES PRECEDENCE OVER DOCUMENTS REFERENCED HEREIN.

THIS DOCUMENT HAS BEEN PROMULGATED BY THE DEPARTMENT OF DEFENSE AS THE MILITARY STANDARD TO LIMIT THE SELECTION OF THE ITEM, PRODUCT, OR DESIGN COVERED HEREIN IN ENGINEERING, DESIGN, AND PROCUREMENT. THIS STANDARD SHALL BECOME EFFECTIVE NOT LATER THAN 90 DAYS AFTER THE LATEST DATE OF APPROVAL SHOWN.

CUSTODIANS	OTHER INT.
A - ORD	A- CESIGT
N - SHIPS	N- ANCOR
AF - USAF	AF-
PROCUREMENT SPECIFICATION	
FF-S-103	

MILITARY STANDARD
SETSCREW, HEXAGON SOCKET, FLAT POINT,
ALLOY STEEL, CADMIUM OR ZINC, NF-3A AND UNF-3A

SUPERSEDES:

MS51026

SHEET 1 OF 1