

FED. SUP CLASS  
2330

REVIEW ACTIVITIES: ARMY-MD; NAVY-MS;  
USER ACTIVITIES: NAVY-YD, AF-II

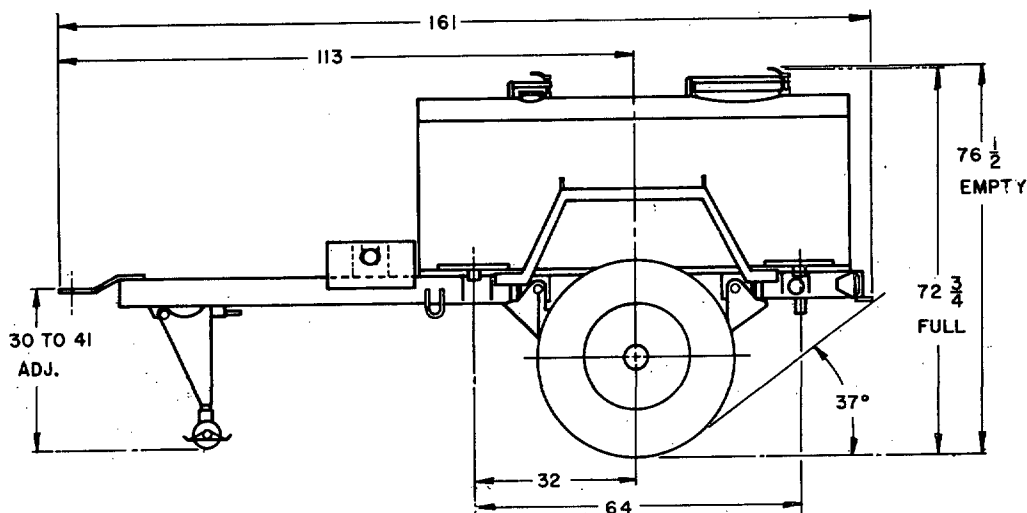
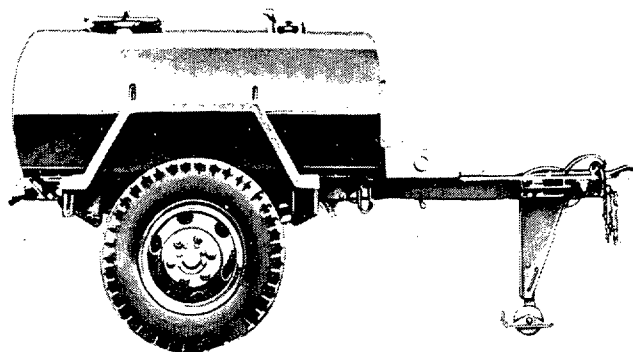

A

**CANCELLED** AFTER 24 APRIL 1974  
**SUPERSEDED BY** MS52108

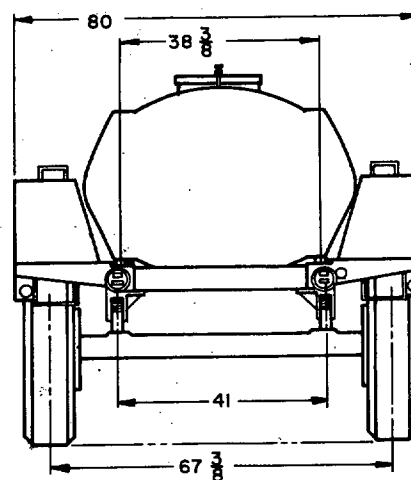
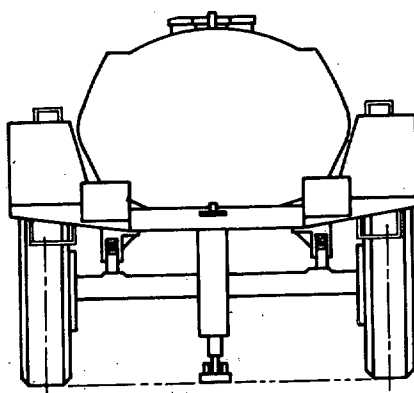

DIMENSIONS ARE IN INCHES AND ARE SHOWN  
FOR ENGINEERING REFERENCE ONLY.

P.A. MO (ATAC)

Other Cust  
NAVY-MC  
AF-84

PROCUREMENT SPECIFICATION  
MIL-T-45316

TITLE

TRAILER, TANK, WATER,  
1-1/2 TON, 2 WHEEL, M149

SUPERSEDES:

MS PART NO.

MS500024 -I

ENGINEERING

PARTS LIST

8750500

MILITARY STANDARD

MS500024

SHEET 1 OF 2

APPROVED 10 DEC 65  
REVISED A 24 APRIL 1974

FED. SUP CLASS  
2330VEHICLE CHARACTERISTICSPRIME MOVER: TRUCK, CARGO,  
2-1/2 TON, 6X6BASIC CHASSIS: M492 PART NO. 8750514CURB WEIGHT FULLY EQUIPPED: 2500 LBS.PAYLOAD:CROSS COUNTRY: 3335  
HIGHWAY: 3335 LBS.GROSS WEIGHT:CROSS COUNTRY: 5835  
HIGHWAY: 5835 LBS.WEIGHT DISTRIBUTION:

	NO LOAD	CROSS COUNTRY	HIGHWAY
LUNETTE EYE:	240	260	260
AXLE:	2260	5575	5575
LANDING GEAR:	330	380	380
AXLE:	2170 LBS.	5455 LBS.	5455 LBS.

(REFERENCED WEIGHTS ARE FOR INFORMATION ONLY.)

TANK ASSY: PART NO. 7034967GENERAL:

TRAILER, TANK, WATER, 400 GALLON, 2 WHEEL, M149, TRANSPORTS POTABLE WATER ON HIGHWAY AND CROSS COUNTRY TERRAINS. THE WATER TANK IS MADE OF TWO WALLS OF FIBERGLASS REINFORCED POLYESTER RESIN PLASTIC SEPARATED BY INSULATION THAT HAS A DENSITY OF 7 LBS. PER CUBIC FT. AND BONDED TO BOTH WALLS. IT IS EQUIPPED WITH DISPENSING EQUIPMENT CONSISTING OF FOUR BRONZE FAUCETS AND BRASS PIPING. SHUT-OFF VALVE IS PROVIDED TO PERMIT COMPLETE DRAINAGE FROM THE EXTERIOR PLUMBING.

FORDING DEPTH: 30 INCHESLUNETTE: COUPLER MS 51339-2LANDING GEAR: PART NO. 7032127ELECTRICAL SYSTEM: INST'L. DWG NO. 7055111POTENTIAL: 24 VOLTS  
STOPLIGHT, TAILLIGHT: (2) MS 51329-1  
STOPLIGHT, BLACKOUT: (1) MS 51302-1FRAME: ASSEMBLY PART NO. 10944279AXLE: ASSEMBLY PART NO. 8719916SPRINGS: (2) PART NO. 8389626  
SIZE: 2-1/2 x 48SHOCK ABSORBERS: (2) 8716992WHEELS: (2) MS 53044-5  
SIZE: 7.5 x 20TIRES: 9.00 x 20, 8 PLY, MS 35388-16  
TREAD DESIGN: NDCC  
TUBE: MS 35392-13BRAKES: PARKINGINST'L. DWG. NO. 10929853  
ACTUATION: AIR/HYDRAULICMAXIMUM TOWING SPEED:CROSS COUNTRY: 30 MPH  
HIGHWAY: 50 MPHTIE DOWNS: NO. (4)LOCATION: 2 FRONT CORNERS  
2 REAR CORNERS

(FOR DESIGN FEATURE PURPOSES, THIS STANDARD TAKES PRECEDENCE OVER PROCUREMENT DOCUMENTS REFERENCED HEREIN).  
(REFERENCED DOCUMENTS SHALL BE OF THE ISSUE IN EFFECT ON DATE OF INVITATIONS FOR BID).

THIS VEHICLE SHALL BE IN ACCORDANCE WITH DRAWINGS IN REFERENCED ENGINEERING PARTS LIST, COPIES OF WHICH MAY BE OBTAINED FROM:

U. S. ARMY TANK-AUTOMOTIVE CENTER  
ATTN: STANDARDIZATION BRANCH  
WARREN, MICHIGAN 48090.

This military standard has been approved by the Department of Defense and is mandatory for use by all Departments and Agencies of the Department of Defense. Selection for all new engineering and design applications and for repetitive use shall be made from this document.

P.A. MO (ATAC)

Other Cust

NAVY-MC

AF-84

PROCUREMENT SPECIFICATION  
MIL-T-45316

TITLE

TRAILER, TANK, WATER,  
1-1/2 TON, 2 WHEEL, M149

SUPERSEDES:

MILITARY STANDARD

MS 500024

SHEET 2