

REVIEWER: AV, EA, IS, MI, NS
USER: AT, CL, MC, ME, MU, WY

This military standard is approved for use by all Departments and Agencies of the Department of Defense. Selection for all new engineering and design applications and for repetitive use shall be made from this document.

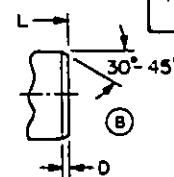
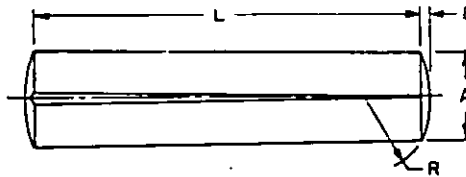
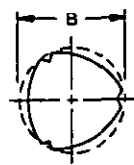

FED. SUP CLASS
5315

NOMINAL SIZE		.0469	.0625	.0781	.0938
A DIAMETER	MAX	.0469	.0625	.0781	.0938
	MIN	.0459	.0613	.0771	.0928
D CHAMFER LENGTH* (B)	MIN	----	.016	.016	.016
E CROWN HEIGHT*	REF	----	.006	.009	.009
R RADIUS	±.010	----	.078	.094	.125
RECOMMENDED HOLE SIZE	MAX	.0482	.0640	.0798	.0956
	MIN	.0469	.0625	.0781	.0938
SINGLE SHEAR STRENGTH LBS-MIN		150	270	430	620
L LENGTH	±.010	DASH NO.	B DIA ±.001	DASH NO.	B DIA ±.001
.188	(B)	1	.050	6	.066
.250		2	.050	7	.066
.375		3	.050	8	.066
.500		4	.050	9	.066
.625		5	.050	10	.066
.750				11	.082
1.000				12	.082
				13	.082
				14	.082
				15	.082
				16	.099
				17	.099
				18	.099
				19	.099
				20	.099

NOMINAL SIZE		.125	.1562	.1875	.250
A DIAMETER	MAX	.1250	.1562	.1875	.2500
	MIN	.1230	.1542	.1855	.2480
D CHAMFER LENGTH* (B)	MIN	.016	.031	.031	.031
E CROWN HEIGHT*	REF	.013	.017	.018	.026
R RADIUS	±.010	.156	.188	.250	.312
RECOMMENDED HOLE SIZE	MAX	.1271	.1587	.1903	.2534
	MIN	.1250	.1562	.1875	.2500
SINGLE SHEAR STRENGTH LBS-MIN		1100	1720	2480	4420
L LENGTH	±.010	DASH NO.	B DIA ±.002	DASH NO.	B DIA ±.002
.500	(B)	21	.132	27	.164
.625		22	.132	28	.164
.750		23	.132	29	.164
1.000		24	.131	30	.163
1.250		25	.130	31	.162
1.500		26	.130	32	.162
1.750				33	.195
2.000				34	.195
2.250				35	.195
2.500				36	.194
2.750				37	.194
				38	.194
				39	.193
				40	.193
				41	.260
				42	.260
				43	.260
				44	.260
				45	.259
				46	.259
				47	.259
				48	.259
				49	.258
				50	.258

NOTES:

- MATERIAL:** Corrosion-resisting steel, 300 series, in accordance with Fed. Std. No. 66. The minimum ultimate shear strength shall be 90,000 PSI.
- PROTECTIVE COATING:** Passivated in accordance with QQ-P-35.
- DIMENSIONS:** All dimensions are in inches, unless otherwise specified.
- APPLICATION:** Grooved pins are locked securely in place by elastic deformation, eliminating the need for tapping or reaming of tapered or sized holes.
- PART NUMBER:** The MS part number consists of the MS number, plus the dash number.
Example: MS35672-1.
- Diameter "B" is the expanded diameter as measured with a ring gage.
- Ends may be crowned or chamfered or may be square with .01 to .02 radius on the edges.
- Referenced documents shall be of the issue in effect on date of invitations for bid.
- For design feature purposes, this standard takes precedence over procurement documents referenced herein.

P.A. VC Other Case AS 82	TITLE PIN, GROOVED, HEADLESS-LONGITUDINAL TAPER GROOVE, CORROSION-RESISTING STEEL	MILITARY STANDARD MS35672
PROCUREMENT SPECIFICATION MIL-P-20700	SUPERSEDES: AEC12 in part	SHEET 1 OF 1

DD FORM 672-1 (COORDINATED)

PREVIOUS EDITIONS OF THIS FORM ARE OBSOLETE.

U.S. GOVERNMENT PRINTING OFFICE: 1977-703-020/5025

APPROVED 11 JAN 1956 REVISED (A) 17 MAR 1965 (B) 22 AUG 1975