

NOTE: When Government drawings, specifications, or other data are used for any purpose other than in connection with a definitely related Government procurement operation, the United States Government hereby disclaims any responsibility therefor. It is not to be construed as an endorsement, approval, or other data is not to be regarded as an indication of authority or otherwise as in any way licensing the holder or any other person or corporation, or conveying any right of patent or invention that may in any way be related thereto.

This document has been promulgated by the Department of Defense as the military standard to limit the selection of the item, product or design covered herein in engineering, design and procurement. This standard shall become effective not later than 90 days after the latest date of approval shown.

FED SUP CLASS  
**5940**

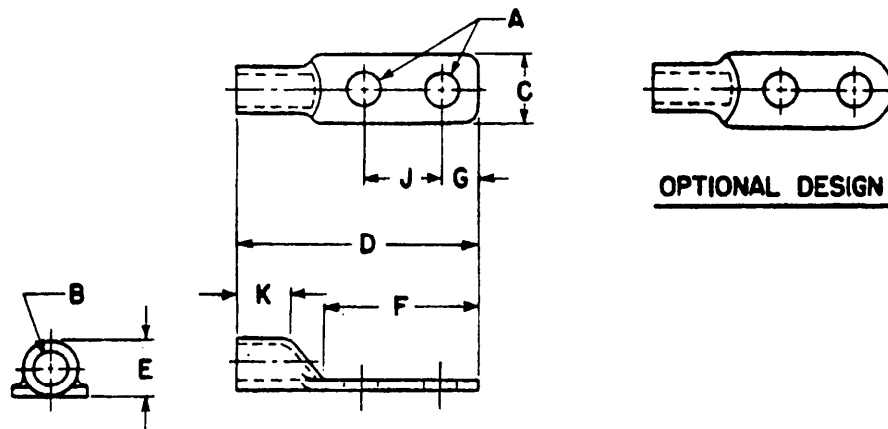

DASH NO.	PART NO. (B)	WIRE SIZE AWG NOM	STUD SIZE	A HOLE DIA		B	C	D	E	F	G	J	K
				MIN	MAX								
1	OSO-6263	10	6	.141	.153	.143	1/4	1-7/32	3/16	3/4	5/32	3/8	11/32
2	OSO-6264	8	8	.167	.179	.186	3/8	1-13/32	1/4	7/8	3/16	7/16	
3	OSO-6265	6	10	.193	.205	.238	7/16	1-3/4	5/16	1-1/16	1/4	1/2	3/8
4	OSO-6266	4	12	.221	.236	.289	17/32	1-29/32	3/8	1-1/4	5/16	5/8	7/16
5	OSO-6267	2	1/4	.258	.285	.347	5/8	2-1/8	7/16	1-3/8		11/16	1/2
6	OSO-6268	0	5/16	.320	.347	.401	3/4	2-5/8	1/2	1-11/16	3/8	7/8	9/16
7	OSO-6269	00	3/8	.383	.410	.460	13/16	3-1/16	9/16	2.	7/16	1.	11/16
8	OSO-6270	000				.519	29/32	3-1/8	5/8				25/32
9	OSO-6271	0000				.559	31/32	3-1/4	11/16	2-1/8	1/2		27/32
10	OSO-6272	250MCM	1/2	.510	.537	.660	1-3/16	4	13/16	2-5/8	5/8	1-1/4	31/32

**MATERIAL:** ELECTROLYTIC SEAMLESS COPPER TUBING.

**FINISH:** HOT TIN DIP OR ELECTRODEPOSITED TIN ALL OVER, MINIMUM THICKNESS .0005 INCHES.

**NOTES:** 1. ALL DIMENSIONS IN INCHES. TOL: FRACTIONAL  $\pm 1/64$ , DEC  $\pm .010$  UNLESS OTHERWISE SPECIFIED.

2. REMOVE ALL BURRS.

3. REFERENCED DOCUMENTS OF ISSUE IN EFFECT ON DATE OF INVITATION FOR BIDS SHALL APPLY.

4. THE MS PART NUMBER CONSISTS OF THE MS NUMBER PLUS THE DASH NUMBER.

(B)

CUSTO/MS ORD SHIPS	OTHER INT. A- Sm, TC, CE N- Wep, Docks AF-	MILITARY STANDARD		MS35449
		TERMINAL LUG, SOLDER TYPE, COPPER TUBING, TWO HOLE		
PROCUREMENT SPECIFICATION JCS-15450		SUPERSEDES:		ORIGIN   OF

APPROVED 5 JULY 55 REVISED A 23 JULY 56, (B) 10 February 1961.