

INCH-POUND

MS35254C  
 10 November 2009  
 SUPERSEDING  
 MS35254B  
 4 September 1992

## DETAIL SPECIFICATION SHEET

BRACE, CORNER, BOX 3 QUARTER-ROUND  
 FLANGES, 3 MOUNTING HOLES

Inactive for new design after 31 July 1997.

This specification sheet is approved for use by all Departments and Agencies of the Department of Defense.

The requirements for acquiring the product described herein shall consist of this specification sheet.

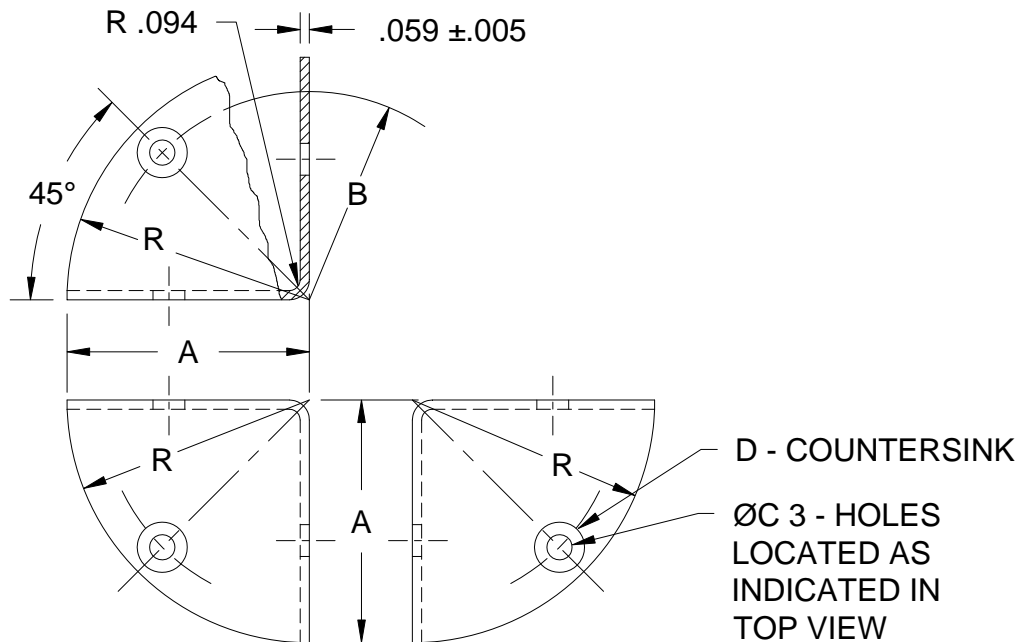

FIGURE 1. Brace.

## MS35254C

TABLE I. Part Numbers and Dimensions.

PART NUMBER	DIMENSIONS				MATERIAL
	A LENGTH	B RADIUS	ØC ±.005	D COUNTERSINK	
MS35254-1	2.000	1.750	.204	82° TO Ø.375 +.016	BRASS
MS35254-2	2.000	1.750	.204	NONE	
MS35254-3	2.000	1.750	.180	82° TO Ø.328 +.016	
MS35254-4	2.000	1.750	.180	NONE	
MS35254-5	1.500	1.250	.180	82° TO Ø.328 +.016	
MS35254-6	1.500	1.250	.180	NONE	
MS35254-7	1.500	1.250	.152	82° TO Ø.281 +.016	
MS35254-8	1.500	1.250	.152	NONE	
MS35254-9	1.250	1.000	.152	82° TO Ø.281 +.016	
MS35254-10	1.250	1.000	.152	NONE	
MS35254-11	1.250	1.000	.128	82° TO Ø.219 +.016	
MS35254-12	1.250	1.000	.128	NONE	
MS35254-13	1.125	.875	.128	82° TO Ø.219 +.016	
MS35254-14	1.125	.875	.128	NONE	
MS35254-15	2.000	1.750	.204	82° TO Ø.375 +.016	STEEL
MS35254-16	2.000	1.750	.204	NONE	
MS35254-17	2.000	1.750	.180	82° TO Ø.328 +.016	
MS35254-18	2.000	1.750	.180	NONE	
MS35254-19	1.500	1.250	.180	82° TO Ø.328 +.016	
MS35254-20	1.500	1.250	.180	NONE	
MS35254-21	1.500	1.250	.152	82° TO Ø.281 +.016	
MS35254-22	1.500	1.250	.152	NONE	
MS35254-23	1.250	1.000	.152	82° TO Ø.281 +.016	
MS35254-24	1.250	1.000	.152	NONE	
MS35254-25	1.250	1.000	.128	82° TO Ø.219 +.016	
MS35254-26	1.250	1.000	.128	NONE	
MS35254-27	1.125	.875	.128	82° TO Ø.219 +.016	
MS35254-28	1.125	.875	.128	NONE	

## Requirements:

1. Material:

Brass, in accordance with ASTM B121/B121M, H02 (half-hard).

Steel, in accordance with QQ-S-698, cold rolled, commercial quality, No. 2 temper, No. 1 finish.

2. Finish:

Brass, plain.

Steel, zinc plated in accordance with ASTM B633, Type IV, SC3.

3. Tolerance: Tolerances on decimals ±.016, on angles ±1°, unless otherwise specified.

Example: MS35254 - 1

Dash number

Basic specification sheet number

1. All dimensions are in inches, unless otherwise specified.
2. In the event of a conflict between the text of this standard and the references cited herein, the text of this standard shall take precedence.
3. Changes from previous issue. Marginal notations are not used in this revision to identify changes with respect to the previous issue due to the extent of the changes.

Preparing Activity:  
DLA -IS  
  
(Project 5340-2009-025)

3