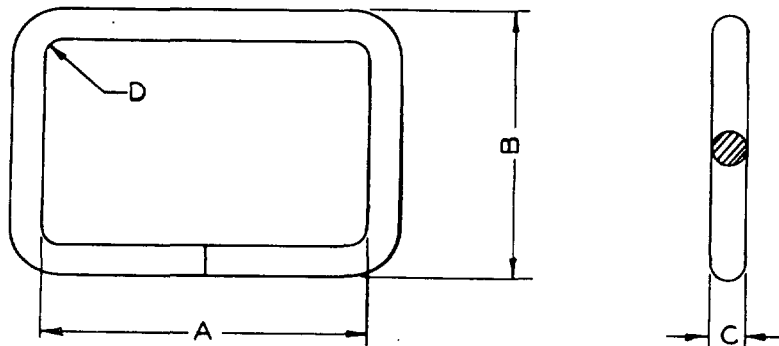

FED SUP CLASS  
4010

FINISH: BRASS-PLAIN

STEEL-ZINC PLATED CLASS 2, TYPE III, PER FEDERAL SPECIFICATION QQ-2-325 OR  
CADMIUM PLATED TYPE III, CLASS A PER FEDERAL SPECIFICATION QQ-P-416

MS PART NO.	DIMENSIONS				MATERIAL - BRASS WIRE PER FED SPEC QQ-W-321
	A	B	C	D	
MS35252-1	2-1/16	1-3/8	.250	1/8	COMPOSITION-A COLD DRAWN, HALF-HARD
MS35252-2	1-9/16	1-	.156	5/64	
MS35252-3	1-5/16	7/8	.125	1/16	
MS35252-4	1-1/16	5/8	.125	1/16	
MS35252-5	13/16	1/2	.093	3/64	
MS35252-6	11/16	1/2	.093	3/64	
MS35252-7	9/16	3/8	.062	1/32	

MS PART NO.	DIMENSIONS				MATERIAL - STEEL WIRE PER FED SPEC QQ-W-461
	A	B	C	D	
MS35252-8	2-1/16	1-3/8	.250	1/8	FORM I GRADE FS 1010 TO FS 1020
MS35252-9	1-9/16	1-	.156	5/64	
MS35252-10	1-5/16	7/8	.125	1/16	
MS35252-11	1-1/16	5/8	.125	1/16	
MS35252-12	13/16	1/2	.093	3/64	
MS35252-13	11/16	1/2	.093	3/64	
MS35252-14	9/16	3/8	.062	1/32	

**(A) INACTIVE—NOT RECOMMENDED FOR NEW DESIGN**TOLERANCES ON FRACTIONS  $\pm 1/64$ , UNLESS OTHERWISE SPECIFIED

ALL DIMENSIONS IN INCHES

P.A. ARMY W C	MILITARY STANDARD	MS35252
PROCUREMENT SPECIFICATION NONE	RING, CONNECTING, RECTANGULAR	SHEET 1 OF 1

MS FORM 233  
1 NOV 50

☆ U. S. GOVERNMENT PRINTING OFFICE: 1971-433-699/7182

81 28170

APPROVED 19 JUNE 1953 REVISED (A) 24 MAY 1971

NOTE: When Government drawings, specifications, or other data are used for any purpose other than in connection with a definitely related Government procurement operation, the United States Government thereby incurs no responsibility, nor any obligation whatsoever; and the fact that the Government may have formulated, furnished, or in any way supplied the said drawings, specifications, or other data is not to be regarded by implication or otherwise as in any manner licensing the holder or any other person or corporation, or conveying any rights or permission to manufacture, use, or sell any patented invention that may in any way be related thereto.