

FED SUP CLASS
5305

TABLE 1. DASH NUMBERS AND DIMENSIONS

ØD NOMINAL SIZE		#2 .0860	#4 .1120	#6 .1380	#8 .1640	#10 .1900	1/4 .2500	5/16 .3125	3/8 .3750
THREADS PER INCH (UNF-2A)		64	48	40	36	32	28	24	24
ØD BODY	MAX MIN	.0860 .0733	.1120 .0954	.1380 .1184	.1640 .1424	.1900 .1658	.2500 .2225	.3125 .2806	.3750 .3430
ØA HEAD	MAX MIN	.167 .155	.219 .205	.270 .256	.322 .306	.373 .357	.492 .473	.615 .594	.740 .716
H HEAD HEIGHT	MAX MIN	.062 .053	.080 .070	.097 .087	.115 .105	.133 .122	.175 .162	.218 .203	.261 .244
P HEAD RADIUS	MIN	.010	.010	.015	.015	.020	.035	.040	.040
R FILLET RADIUS	MAX	.013	.017	.021	.025	.029	.038	.047	.056
DRIVER SIZE		1	1	2	2	2	3	4	4
MINIMUM TENSILE STRENGTH LOAD (LBS)		215	360	550	810	1100	2000	3150	4800
L LENGTH	TOLERANCE	DASH NO	DASH NO	DASH NO	DASH NO	DASH NO	DASH NO	DASH NO	DASH NO
.12	+.00 -.03	1	10	21	36				
.19		2	11	22	37				
.25		3	12	23	38	51			
.31		4	13	24	39	52	66		
.38		5	14	25	40	53	67	80	
.44		6	15	26	41	54	68	81	
.50		7	16	27	42	55	69	82	93
.62		8	17	28	43	56	70	83	94
.75	+.00 -.06	9	18	29	44	57	71	84	95
.88			19	30	45	58	72	85	96
1.00			20	31	46	59	73	86	97
1.25				32	47	60	74	87	98
1.50	+.00 -.09			33	48	61	75	88	99
1.75				34	49	62	76	89	100
2.00				35	50	63	77	90	101
2.25						64	78	91	102
2.50						65	79	92	103
2.75									104
3.00									105

© ENTIRE STANDARD REVISED

P.A. ARMY-AR Other Cust NAVY-YD AIR FORCE-82	INTERNATIONAL INTEREST	TITLE SCREW, MACHINE - PAN HEAD, CROSS-RECESSED, BRASS, UNF-2A	MILITARY STANDARD MS35215
PROCUREMENT SPECIFICATION FF-S-92	SUPERSEDES: MS35213, MS35230, MS35232 AND IN PART: MS35357, MS35359 THRU MS35362, MS35364 THRU MS35366 AND AN520	PAGE 1	OF 3

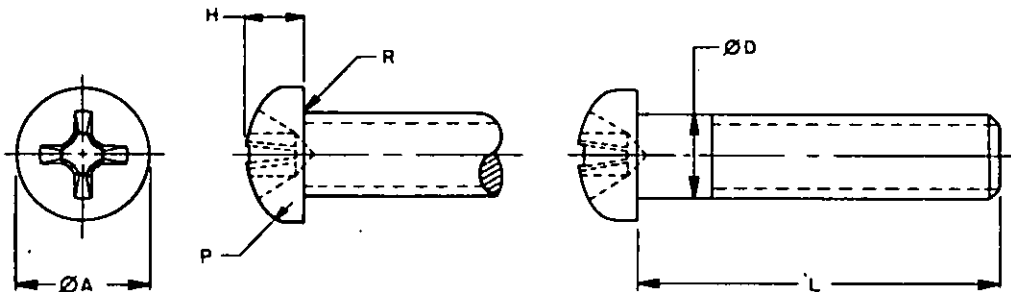
DISTRIBUTION STATEMENT A. Approved for public release; distribution is unlimited.
This military standard is approved for use by all Departments and Agencies of the Department of Defense.
Selection for all new engineering and design applications and for repetitive use shall be made from this document when applicable.

AMSC N/A

DD FORM 672-1 (COORDINATED)

PREVIOUS EDITIONS OF THIS FORM ARE OBSOLETE

5305-1630

APPROVED 25 JUN 53 REVISED 31 DEC 87

USER ACTIVITIES:
ARMY-AT, CR, ME
NAVY-MC, SH
NSA-NS

REVIEWER ACTIVITIES:
ARMY-AV, EA
DLA-IS

DD FORM

FED. SUP CLASS
5305

REQUIREMENTS:

1. **MATERIAL:** BRASS IN ACCORDANCE WITH QQ-B-613, QQ-B-626 OR QQ-W-321. THE MINIMUM ULTIMATE TENSILE STRENGTH SHALL BE 55,000 PSI.
2. **PROTECTIVE COATING:** BLACK CHEMICAL FINISH IN ACCORDANCE WITH MIL-F-495. CADMIUM PLATE IN ACCORDANCE WITH QQ-P-416, TYPE 11, CLASS 3. (WHEN CADMIUM IS REQUIRED, A "C" SHALL FOLLOW THE DASH NUMBER).
3. **THREADS:** THE THREADS SHALL BE IN ACCORDANCE WITH SCREW-THREAD STANDARDS FOR FEDERAL SERVICES FED-STD-H28.
4. **THREAD LENGTH:** FULL FORM THREADS SHALL EXTEND TO WITHIN 2 THREADS OR LESS OF HEAD BEARING SURFACE FOR LENGTHS THRU 2.00 INCHES. LONGER LENGTHS SHALL HAVE A MINIMUM FULL FORM THREAD LENGTH OF 1.50 INCHES.
5. **RECESS:** THE RECESS SHALL BE IN ACCORDANCE WITH MS9006.
6. **PART NUMBER:** THE PART NUMBER SHALL CONSIST OF THE BASIC MS SHEET NUMBER, FOLLOWED BY A DASH NUMBER FROM TABLE I AND A CODE LETTER "C" FOR CADMIUM PLATE, IF APPLICABLE.

EXAMPLE: MS35215-1
 └───┬─── DASH NUMBER
 └───┴─── BASIC MS SHEET NUMBER

MS35215-1 INDICATES - SCREW, MACHINE-PAN HEAD, CROSS RECESSED, BRASS, BLACK CHEMICAL FINISH, .0860-64 UNF-2A NOMINAL THREAD SIZE; .125 THREAD LENGTH.

MS35215-1C
 └───┬─── CADMIUM PLATE
 └───┬─── DASH NUMBER
 └───┴─── BASIC MS SHEET NUMBER

MS35215-1C INDICATES - SCREW, MACHINE-PAN HEAD, CROSS RECESSED, BRASS, CADMIUM PLATE, .0860-64 UNF-2A NOMINAL THREAD SIZE; .125 THREAD LENGTH.

NOTES:

1. ALL DIMENSIONS ARE IN INCHES.
2. IN THE EVENT OF A CONFLICT BETWEEN THE TEXT OF THIS STANDARD AND THE REFERENCES CITED HEREIN, THE TEXT OF THIS STANDARD SHALL TAKE PRECEDENCE.
3. REFERENCED GOVERNMENT (OR NON-GOVERNMENT) DOCUMENTS OF THE ISSUE LISTED IN THAT ISSUE OF THE DEPARTMENT OF DEFENSE INDEX OF SPECIFICATIONS AND STANDARDS (DoDISS) SPECIFIED IN THE SOLICITATION, FORM A PART OF THIS STANDARD TO THE EXTENT SPECIFIED HEREIN.

P.A. ARMY-AR Other Cust NAVY-YD AIR FORCE-82	INTERNATIONAL INTEREST	TITLE SCREW, MACHINE-PAN HEAD, CROSS-RECESSED, BRASS, UNF-2A	MILITARY STANDARD
			MS35215
PROCUREMENT SPECIFICATION FF-S-92	SUPERSEDES: MS35213, MS35230, MS35232 AND IN PART MS35357, MS35359 THRU MS35362, MS35364 THRU MS35366 AND AN520		PAGE 2 OF 3

DD FORM 672-1 (COORDINATED)

PREVIOUS EDITIONS OF THIS FORM ARE OBSOLETE

5305-1630

APPROVED 25 JUN 53 REVISED (C) FOR CHANGES SEE PAGES 1, 2 AND 3

USER ACTIVITIES:
 ARMY-AT, CR, ME
 NAVY-MC, SH
 NSA-NS

REVIEWER ACTIVITIES:
 ARMY-AV, EA
 DLA-IS

This military standard is approved for use by all Departments and Agencies of the Department of Defense. Selection for all new engineering and design applications and for repetitive use shall be made from this document when applicable.

FED. SUP. CLASS
5305

SCREWS COVERED BY DASH NUMBERS GIVEN IN MS35213, MS35230, MS35232 AND AN520 IN PART ARE CANCELED AFTER 17 DECEMBER 1962. THE CANCELED SCREWS CANNOT ALWAYS BE REPLACED BY THE SUPERSEDING SCREWS AND SHOULD BE USED UNTIL EXISTING STOCKS ARE DEPLETED. USE ONLY THE SUPERSEDING SCREWS FOR NEW DESIGN AND ENGINEERING. REPLACEMENT SHALL BE IN ACCORDANCE WITH THIS TABLE AND AS FOLLOWS:

- A. MS35213 SCREWS ARE SUPERSEDED BY MS35215 SCREWS HAVING THE SAME DASH NUMBERS.
- B. AN520 DASH NUMBERS HAVING A "R" IN PLACE OF THE "-" ARE SUPERSEDED BY THE SAME MS35215 DASH NUMBERS AS THOSE WITH THE "-".

TABLE 11. INTERCHANGEABILITY

DASH NUMBER			DASH NUMBER			DASH NUMBER		
CANCELED		SUPERSEDING	CANCELED		SUPERSEDING	CANCELED		SUPERSEDING
MS35230 MS35232	AN520	MS35215	MS35230 MS35232	AN520	MS35215	MS35230 MS35232	AN520	MS35215
	B0-2 THRU B0-8 B1-2 THRU B1-8	✓ ✓ ✓ ✓ ✓ ✓	37	B6-26 B6-28 B6-30 B6-32 B6-36 B6-40	34 ✓ 35 ✓ ✓	75	B10-48	✓ 66 67 68 69 70
1		1	39		36	81	B416-12	71
2	B2-3	2	40		37	82	B416-14	72
3	B2-4	3	41	B8-4	38	83	B416-16	73
4	B2-5	4	42	B8-5	39		B416-18	✓ 74
5	B2-6	5	43	B8-6	40	84	B416-20	✓ 75
6	B2-7	6	44	B8-7	41	85	B416-22	✓ 76
7	B2-8	7	45	B8-8	42		B416-24	✓ 77
8	B2-10	8	46	B8-10	43	86	B416-26	✓ 78
9	B2-12	9	47	B8-12	44		B416-28	✓ 79
10	B3-3 THRU B3-12	✓ ✓ ✓	48	B8-14	45	87	B416-30	✓ 80
			49	B8-16	46	88	B416-32	✓ 81
			50	B8-18	47		B416-36	✓ 82
11		10		B8-20	✓ 48	89	B416-40	✓ 83
12	B4-3	11	51	B8-22	✓ 49	90	B416-44	✓ 84
13	B4-4	12		B8-24	✓ 50	91	B416-48	✓ 85
14	B4-5	13		B8-26	✓ 51	92		86
15	B4-6	14	52	B8-28	✓ 52	93		87
16	B4-7	15		B8-30	✓ 53	94		88
17	B4-8	16	53	B8-32	✓ 54	95		89
18	B4-10	17	54	B8-36	✓ 55	96		90
19	B4-12	18	55	B8-40	✓ 56	97		91
20	B4-14	19	56	B8-44	✓ 57	98		92
21	B4-16	20	57	B8-48	✓ 58	99		✓ 93
22	B4-18	✓ 21	58		✓ 59	100		94
23	THRU B4-28 B5-4 THRU B5-28	✓ ✓ ✓ ✓ ✓	59	B10-4	51	101		95
			60	B10-5	52	102		96
			61	B10-6	53	103		97
			62	B10-7	54	104		98
			63	B10-8	55	105		99
24		21	64	B10-10	56	106		100
25		22	65	B10-12	57	107		101
26	B6-4	23	66	B10-14	58	108		102
27	B6-5	24	67	B10-16	59	109		103
28	B6-6	25		B10-18	✓ 60	110		104
29	B6-7	26	68	B10-20	✓ 61	111		105
30	B6-8	27		B10-22	✓ 62	112		106
31	B6-10	28	69	B10-24	✓ 63	113		107
32	B6-12	29		B10-26	✓ 64	114		108
33	B6-14	30	70	B10-28	✓ 65	115		109
34	B6-16	31		B10-30	✓ 66	116		110
	B6-18	✓ 32	71	B10-32	✓ 67	117		111
35	B6-20	✓ 33	72	B10-36	✓ 68	118		112
	B6-22	✓ 34	73	B10-40	✓ 69	119		113
36	B6-24	✓ 35	74	B10-44	✓ 70			114

✓ NO REPLACEMENT

USER ACTIVITIES:
ARMY-AT, CR, ME
NAVY-MC, SH
NSA-NS

REVIEWER ACTIVITIES:
ARMY-AV, EA
DLA-IS

This military standard is approved for use by all Departments and Agencies of the Department of Defense. Selection for all new engineering and design applications and for repetitive use shall be made from this document when applicable.

P.A. ARMY-AR Other Cust NAVY-YD AIR FORCE-82	INTERNATIONAL INTEREST	TITLE SCREW, MACHINE - PAN HEAD, CROSS-RECESSED, BRASS, UNF - 2A	MILITARY STANDARD MS35215
PROCUREMENT SPECIFICATION FF-S-92	SUPERSEDES: MS35213, MS35230, MS35232 AND IN PART: MS35357, MS35359 THRU MS35362, MS35364 THRU MS35366 AND AN520	PAGE 3	OF 3