

FED SUP CLASS
5305

TABLE 1. DASH NUMBERS AND DIMENSIONS

ØD NOMINAL SIZE	#2	#4	#6	#8	#10	1/4	5/16	3/8
	.0860	.1120	.1380	.1640	.1900	.2500	.3125	.3750
THREADS PER INCH (UNC-2A)	56	40	32	32	24	20	18	16
ØD BODY	MAX MIN	.0860 .0717	.1120 .0925	.1380 .1141	.1640 .1399	.1900 .1586	.2500 .2127	.3125 .2712
ØA HEAD	MAX MIN	.167 .155	.219 .205	.270 .256	.322 .306	.373 .357	.492 .473	.615 .594
H HEAD HEIGHT	MAX MIN	.062 .053	.080 .070	.097 .087	.115 .105	.133 .122	.175 .162	.218 .203
P HEAD RADIUS	MIN	.010	.010	.015	.015	.020	.035	.040
R FILLET RADIUS	MAX	.013	.017	.021	.025	.029	.038	.056
DRIVER SIZE		1	1	2	2	2	3	4
MINIMUM TENSILE STRENGTH LOAD (LBS)		200	330	500	770	960	1750	2800
L LENGTH	TOLERANCE	DASH NO	DASH NO	DASH NO	DASH NO	DASH NO	DASH NO	DASH NO
.12		1	10	21	36			
.19		2	11	22	37			
.25		3	12	23	38	51		
.31		4	13	24	39	52	66	
.38		5	14	25	40	53	67	80
.44	+.00	6	15	26	41	54	68	81
.50	-.01	7	16	27	42	55	69	82
.56		136	106 1/2	108 1/2	114 1/2	120	124	128
.62		8	17	28	43	56	70	83
.75		9	18	29	44	57	71	84
.88			19	30	45	58	72	85
1.00			20	31	46	59	73	86
1.12			107 1/2	109 1/2	115 1/2	121	125	129
1.25				32	47	60	74	87
1.38		137		110 1/2	116 1/2	122	126	130
1.50	+.00 -.06			33	48	61	75	88
1.75				34	49	62	76	89
1.88				111 1/2	117	123	127	131
2.00				35	50	63	77	90
2.25				112 1/2	118	64	78	91
2.50	+.00			113 1/2	119	65	79	92
2.75	-.09							102
3.00								103
								104
								105

NOTE: LINED OUT DASH NUMBERS ARE INACTIVE FOR NEW DESIGN AFTER 12 JUNE 1974.

1/2 DASH NUMBERS 106 THRU 116 ARE NON-PREFERRED FOR NEW DESIGN.

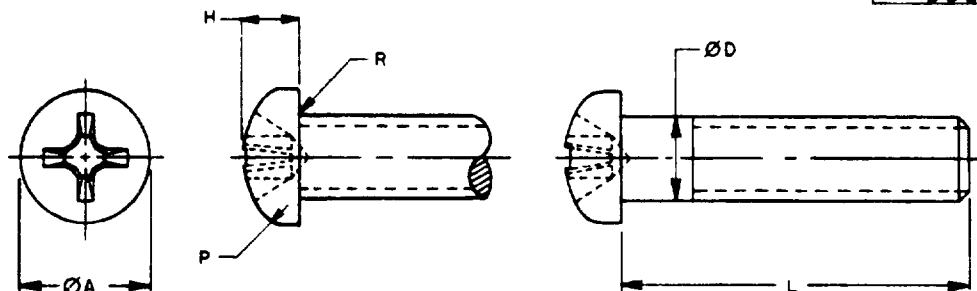
(D) ENTIRE STANDARD REVISED

PA ARMY-AR Other: Guit NAVY-YD AIR FORCE-82	INTERNATIONAL INTEREST	TITLE SCREW, MACHINE-PAN HEAD, CROSS-RECESSED BRASS, UNC-2A	MILITARY STANDARD MS35214
PROCUREMENT SPECIFICATION FF-S-92	SUPERSEDES MS35212, MS35229, MS35231, AND IN PART: MS35357, MS35359 THRU MS35362, MS35364 THRU MS35366 AND AN515	PAGE 1	OF 3

AMSC N/A

DD FORM 672-1 COORDINATED

5305-1631

DISTRIBUTION STATEMENT A. Approved for public release; distribution is unlimited.

This military standard is approved for use by all Departments and Agencies of the Department of Defense. Selection for all new engineering and design applications and for repetitive use shall be made from this document when applicable.

USER ACTIVITIES:
ARMY-AT, CR, ME
NAVY-MC, SH
NSA-NSREVIEWER ACTIVITIES:
ARMY-AV, EA
DLA-ISREVISED (D) 31 DEC 87
APPROVED 25 JUN 53

USER ACTIVITIES:
ARMY-AT, CR, ME
NAVY-MC, SH
NSA-NS

REVIEWER ACTIVITIES:
ARMY-AV, EA
DLA-IS

This military standard is approved for use by all Departments and Agencies of the Department of Defense. Selection for all new engineering and design applications and for repetitive use shall be made from this document when applicable.

FED. SPEC. CLASS
5305

REQUIREMENTS:

1. **MATERIAL:** BRASS IN ACCORDANCE WITH QQ-B-613, QQ-B-626 OR QQ-W-321. THE MINIMUM ULTIMATE TENSILE STRENGTH SHALL BE 55,000 PSI.
2. **PROTECTIVE COATING:** BLACK CHEMICAL FINISH IN ACCORDANCE WITH MIL-P-495. CADMIUM PLATE IN ACCORDANCE WITH QQ-P-416, TYPE II, CLASS 3. (WHEN CADMIUM IS REQUIRED, A "C" SHALL FOLLOW THE DASH NUMBER).
3. **THREADS:** THE THREADS SHALL BE IN ACCORDANCE WITH SCREW-THREAD STANDARDS FOR FEDERAL SERVICES FED-STD-112B.
4. **THREAD LENGTH:** FULL FORM THREADS SHALL EXTEND TO WITHIN 2 THREADS OR LESS OF HEAD BEARING SURFACE FOR LENGTHS THRU 2.00 INCHES. LONGER LENGTHS SHALL HAVE A MINIMUM FULL FORM THREAD LENGTH OF 1.50 INCHES.
5. **RECESS:** THE RECESS SHALL BE IN ACCORDANCE WITH MS9006.
6. **PART NUMBER:** THE PART NUMBER SHALL CONSIST OF THE BASIC MS SHEET NUMBER, FOLLOWED BY A DASH NUMBER FROM TABLE I AND A CODE LETTER "C" FOR CADMIUM PLATE, IF APPLICABLE.

EXAMPLE: MS35214-1

DASH NUMBER
BASIC MS SHEET NUMBER

MS35214-1 INDICATES - SCREW, MACHINE-PAN HEAD, CROSS RECESSED, BRASS, BLACK CHEMICAL FINISH; .0860-56 UNC-2A, NOMINAL THREAD SIZE; .125 LENGTH.

EXAMPLE: MS35214-1C

CADMIUM PLATE
DASH NUMBER
BASIC MS SHEET NUMBER

MS35214-1C INDICATES - SCREW, MACHINE-PAN HEAD, CROSS RECESSED, BRASS, CADMIUM PLATE, .0860-56 UNC-2A, NOMINAL THREAD SIZE; .125 LENGTH.

NOTES:

1. ALL DIMENSIONS ARE IN INCHES.
2. IN THE EVENT OF A CONFLICT BETWEEN THE TEXT OF THIS STANDARD AND THE REFERENCES CITED HEREIN, THE TEXT OF THIS STANDARD SHALL TAKE PRECEDENCE.
3. REFERENCED GOVERNMENT (OR NON-GOVERNMENT) DOCUMENTS OF THE ISSUE LISTED IN THAT ISSUE OF THE DEPARTMENT OF DEFENSE INDEX OF SPECIFICATIONS AND STANDARDS (DDISS) SPECIFIED IN THE SOLICITATION, FORM A PART OF THIS STANDARD TO THE EXTENT SPECIFIED HEREIN.

APPROVED 25 JUN 53
REVISED ① FOR CHANGES SEE PAGES 1, 2 AND 3

PA	ARMY-AR	INTERNATIONAL INTEREST	TITLE	MILITARY STANDARD
Other: Curt	NAVY-YD		SCREW, MACHINE-PAN HEAD, CROSS-RECESSED, BRASS, UNC-2A	MS35214
AIR FORCE-82				
PROCUREMENT SPECIFICATION	FF-S-92	SUPERSEDES	MS36212, MS36229, MS35231, AND IN PART: MS35357, MS35359 THRU MS35362, MS35364 THRU MS35366 AND AN515	PAGE 2 OF 3

DD FORM 672-1 (COORDINATED)

5305-1631

FED SUP CLASS
5305

SCREWS COVERED BY DASH NUMBERS GIVEN IN MS35213, MS35230, MS35212 AND AN515 IN PART ARE CANCELLED AFTER 17 DECEMBER 1962. THE CANCELED SCREWS CANNOT ALWAYS BE REPLACED BY THE SUPERSEDING SCREWS AND SHOULD BE USED UNTIL EXISTING STOCKS ARE DEPLETED. USE ONLY THE SUPERSEDING SCREWS FOR NEW DESIGN AND ENGINEERING. REPLACEMENT SHALL BE IN ACCORDANCE WITH THIS TABLE AND AS FOLLOWS:

- A. MS35212 SCREWS ARE SUPERSEDED BY MS35214 SCREWS HAVING THE SAME DASH NUMBERS.
- B. AN515 DASH NUMBERS HAVING A "R" IN PLACE OF THE "-" ARE SUPERSEDED BY THE SAME MS35214 DASH NUMBERS AS THOSE WITH THE "-".

TABLE 11. INTERCHANGEABILITY

DASH NUMBER			DASH NUMBER			DASH NUMBER		
CANCELED		SUPERSEDING	CANCELED		SUPERSEDING	CANCELED		SUPERSEDING
MS35229 MS35231	AN515	MS35214	MS35229 MS35231	AN515	MS35214	MS35229 MS35231	AN515	MS35214
1	B2-2	1		B6-36	112	80	B416-10	70
2	B2-3	2		B6-40	113	81	B416-12	71
3	B2-4	3	39		36	82	B416-14	72
4	B2-5	4	40		37	83	B416-16	73
5	B2-6	5	41	B8-4	38		B416-18	125
6	B2-7	6	42	B8-5	39	84	B416-20	74
7	B2-8	7	43	B8-6	40		B416-22	126
8	B2-10	8	44	B8-7	41	85	B416-24	75
9	B2-12	9	45	B8-8	42		B416-26	2/
10	B3-2	2/	46	B8-10	43	86	B416-28	76
	THRU	2/	47	B8-12	44		B416-30	127
	B3-16	2/	48	B8-14	45	87	B416-32	77
							B416-24	75
11		10	49	B8-16	46	88	B416-36	78
12	B4-3	11		B8-18	115	89	B416-40	79
13	B4-4	12	50	B8-20	47	90	B416-44	2/
14	B4-5	13		B8-22	116	91	B416-48	2/
15	B4-6	14	51	B8-24	48	92		80
16	B4-7	15		B8-26	2/	93		81
17	B4-8	16	52	B8-28	49	94	B516-8	82
18	B4-10	17		B8-30	117	95	B516-10	83
19	B4-12	18	53	B8-32	50	96	B516-12	84
20	B4-14	19	54	B8-36	118	97	B516-14	85
21	B4-16	20	55	B8-40	119	98	B516-16	86
	B4-18	107	56	B8-44	2/	99	B516-18	129
22	B4-20	2/	57	B8-48	2/			83
	B4-22	137	58		2/	99	B516-20	87
23	B4-24	2/	59	B10-4	51	100	B516-22	130
	B4-26	2/	60	B10-5	52		B516-24	88
	B4-28	2/	61	B10-6	53	101	B516-26	2/
						100	B516-28	89
	B5-3	2/	62	B10-7	54		B516-30	131
	THRU	2/	63	B10-8	55	102	B516-32	90
	B5-28	2/	64	B10-10	56	103	B516-36	91
24		21	65	B10-12	57	104	B516-40	92
25	B6-3	22	66	B10-14	58	105	B516-44	2/
26	B6-4	23	67	B10-16	59	106	B516-48	2/
27	B6-5	24		B10-18	121	107	B616-8	93
28	B6-6	25	68	B10-20	60	108	B616-10	94
29	B6-7	26		B10-22	122	109	B616-12	95
30	B6-8	27	69	B10-24	61	110	B616-14	96
31	B6-10	28		B10-26	2/	111	B616-16	97
32	B6-12	29	70	B10-28	62		B616-18	133
33	B6-14	30		B10-30	123	112	B616-20	98
34	B6-16	31	71	B10-32	63		B616-22	134
	B6-18	109	72	B10-36	64	113	B616-24	99
35	B6-20	32	73	B10-40	65		B616-26	2/
	B6-22	110	74	B10-44	2/	114	B616-28	100
36	B6-24	33	75	B10-46	2/		B616-30	135
	B6-26	2/	76	B416-5	66	115	B616-32	101
37	B6-28	34	77	B416-6	67	116	B616-36	102
	B6-30	111	78	B416-7	68	117	B616-40	103
38	B6-32	35	79	B416-8	69	118	B616-44	104
						119	B616-48	105

2/ NO REPLACEMENT

USER ACTIVITIES:
ARMY-AT, CR, ME
NAVY-MC, SH
NSA-NS

REVIEWER ACTIVITIES:
ARMY-AV, EA
DLA-IS

This military standard is approved for use by all Departments and Agencies of the Department of Defense.
Selection for all new engineering and design applications and for repetitive use shall be made from this document when applicable.

PA	ARMY-AR	INTERNATIONAL INTEREST	TITLE	SCREW, MACHINE-PAN HEAD, CROSS-RECESSED, BRASS, UNC - 2A	MILITARY STANDARD
Other Cust	NAVY-YD				MS35214
AIR FORCE-82					
PROCUREMENT SPECIFICATION	FF-S-92	SUPERSEDES	MS35212, MS35229, MS35231, AND IN PART: MS35357, MS35359 THRU MS35362, MS35364 THRU MS35366 AND AN515	PAGE	3 OF 3

DD FORM 672-1 (COORDINATED)

PRELIMINARY EDITION, SUBJECT TO CHANGE WITHOUT NOTICE 5305-1631

APPROVED 25 JUN 53
REVISED 10 FOR CHANGES SEE PAGES 1, 2 AND 3