

INCH-POUND

MS27513E

12 July 2002

SUPERSEDING

MS27513D

15 June 1984

## DETAIL SPECIFICATION SHEET

CONNECTORS, RECEPTACLE, ELECTRICAL, BOX MOUNTING  
FLANGE, CRIMP TYPE, BAYONET COUPLING, SERIES II

This specification is approved for use by all Departments  
and Agencies of the Department of Defense.

The requirements for acquiring the product described herein  
shall consist of this specification and MIL-DTL-38999.

Inactive for new design

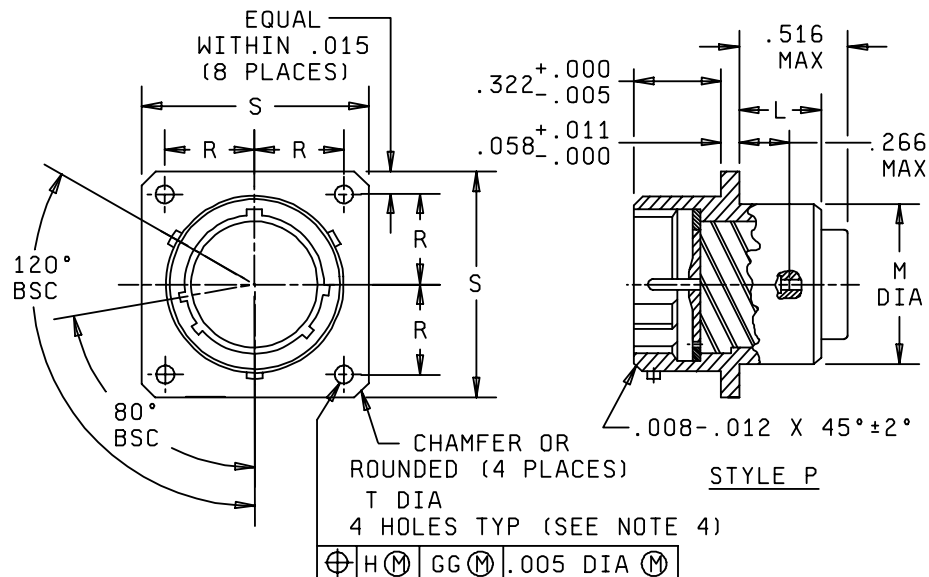
FIGURE 1. Receptacle.

MS27513E

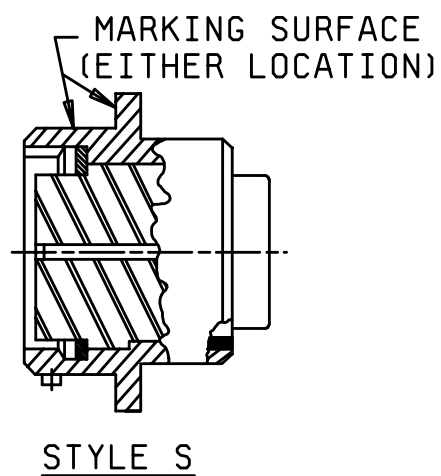

Shell size	L max	M dia max	R BSC	S max	T dia +.010 -.005
8	.312	.453	.297	.828	.120
10		.578	.3595	.954	
12		.703	.406	1.047	
14		.828	.453	1.141	
16		.953	.4845	1.234	
18		1.062	.531	1.328	
20		1.188	.578	1.453	
22		1.312	.625	1.578	
24		1.438	.6875	1.703	.147

FIGURE 1. Receptacle – Continued.

## MS27513E

Inches	mm	Inches	mm	Inches	mm	Inches	mm
.005	.03	.266	6.76	.703	17.386	1.391	35.33
.007	.18	.297	7.54	.828	21.03	1.438	36.53
.008	.20	.312	7.92	.953	24.21	1.453	36.91
.010	.25	.322	8.18	.954	24.23	1.516	38.51
.012	.30	.3595	9.13	1.047	26.59	1.578	40.08
.015	.38	.406	10.31	1.062	26.97	1.641	41.68
.036	.91	.453	11.51	1.078	27.38	1.703	43.26
.058	1.47	.4845	12.31	1.141	28.98	1.766	44.86
.069	1.75	.516	13.11	1.188	30.18	1.891	48.03
.120	3.05	.531	13.49	1.234	31.34	2.016	51.21
.139	3.53	.578	14.68	1.266	32.16	2.204	55.98
.147	3.73	.625	15.88	1.312	33.32		
.223	5.66	.6875	17.46	1.328	33.73		

## NOTES:

1. Dimensions are in inches.
2. Metric equivalents are given for general information only.
3. For main keyway and keyway positions, see MIL-DTL-38999.
4. The gage feature for GG shall be .010 inch (0.25 mm) smaller than the MMC size at basic location.

FIGURE 1. Receptacle – Continued.

## MS27513E

## REQUIREMENTS:

Dimensions and configuration: See figure 1.

Interface dimensions shall conform to MIL-DTL-38999.

Mating connectors: MS27473, MS27480, MS27484 and MS27500.

Insert arrangements: See MIL-STD-1560.

Procurement specification: MIL-DTL-38999.

Part or Identifying Number (PIN) example:

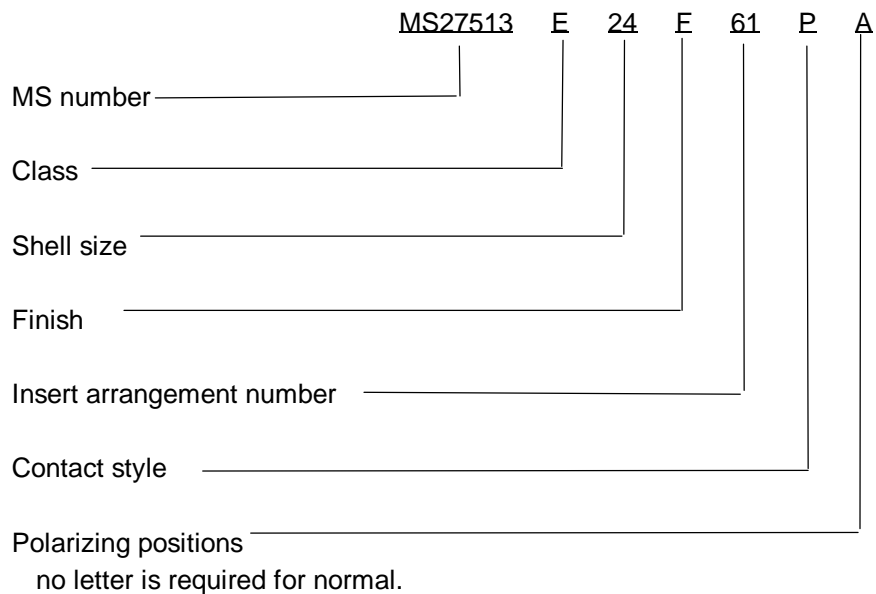

## CONCLUDING MATERIAL

## Custodians:

Army – CR

Navy – AS

Air Force – 11

DLA – CC

## Preparing activity:

DLA – CC

(Project 5935–4385)

## Review activities:

Army – AR, MI

Navy – EC, MC, OS

Air Force – 19, 99

DLA – IS