

INCH-POUND

MS27487F

6 August 2012

SUPERSEDING

MS27487E

12 July 2002

## DETAIL SPECIFICATION SHEET

CONNECTORS, ADAPTER, ELECTRICAL, THREADED, KIT, STRAIGHT  
AND 90 DEGREES, EMR HARDWARE, SERIES I AND II

Inactive for new design after 6 August 2012. For new design  
for 90 degree type adapter only, use SAE-AS85049/32.

This specification is approved for use by all Departments  
and Agencies of the Department of Defense.

The requirements for acquiring the product described herein  
shall consist of this specification sheet and MIL-DTL-38999.

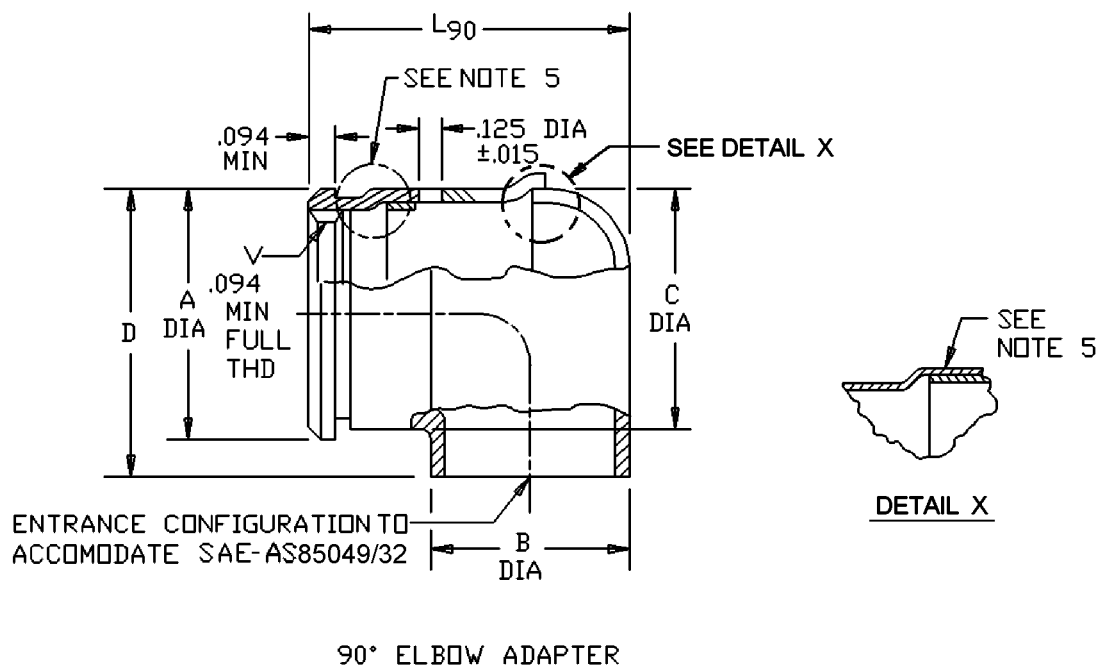
FIGURE 1. Adapter.

MS27487F

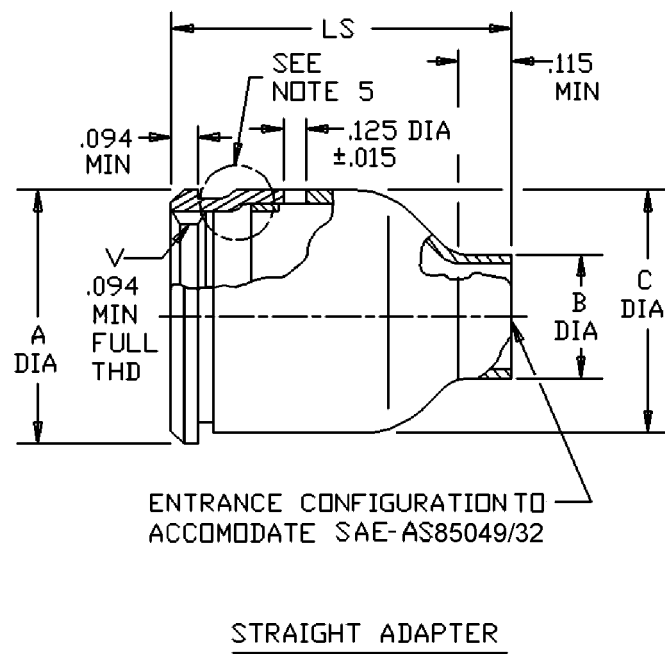

FIGURE 1. Adapter – Continued.

## MS27487F

Shell size series I	Shell size series II	A dia max	B dia max	C dia max	D dia max	LS max	L <sub>90</sub> max	V Thread UNEF class 2B
9	8	.594 (15.09)	.359 (9.12)	.516 (13.11)	.656 (16.66)	.844 (21.44)	.719 (18.26)	.4375-28
11	10	.719 (18.26)	.406 (10.31)	.641 (16.28)	.781 (19.84)	.969 (24.61)	.766 (19.46)	.5625-24
13	12	.844 (21.44)	.500 (12.70)	.766 (19.46)	.938 (23.83)	1.094 (27.79)	.859 (21.82)	.6875-24
15	14	.969 (24.61)	.578 (14.68)	.891 (22.63)	1.062 (26.97)	1.156 (29.36)	.938 (23.83)	.8125-20
17	16	1.094 (27.79)	.641 (16.28)	1.016 (25.81)	1.219 (30.96)	1.219 (30.96)	1.000 (25.40)	.9375-20
19	18	1.219 (30.96)	.688 (17.48)	1.141 (28.98)	1.344 (34.14)	1.344 (34.14)	1.047 (26.59)	1.0625-18
21	20	1.344 (34.14)	.734 (18.64)	1.265 (32.13)	1.469 (37.31)	1.469 (37.31)	1.094 (27.79)	1.1875-18
23	22	1.469 (37.31)	.796 (20.22)	1.391 (35.33)	1.594 (40.49)	1.594 (40.49)	1.156 (29.36)	1.3125-18
25	24	1.594 (40.49)	.859 (21.82)	1.516 (38.51)	1.719 (43.66)	1.719 (43.66)	1.219 (30.96)	1.4375-18

## NOTES:

1. Dimensions are in inches.
2. Metric equivalents are given for information only.
3. Material: Copper alloy. Finish shall be tin-lead, solder plated. The use of pure tin is prohibited both internally and externally. Tin content of connectors, their components and solder shall not exceed 97 percent, by mass. Tin shall be alloyed with a minimum of 3 percent lead, by mass.
4. Type 1 may be of a two-piece construction. Type 2 may be of a three-piece construction. Individual pieces shall be shipped unassembled.
5. Method of joining components is optional.

FIGURE 1. Adapter – Continued.

## MS27487F

## REQUIREMENTS:

Dimensions and configuration: See figure 1.  
 Interface dimensions shall conform to MIL-DTL-38999.  
 Mating connectors: MIL-DTL-38999 series I and series II.

## Qualification:

Examination of product.  
 Mating and unmating forces.  
 Humidity.  
 Salt spray (corrosion).  
 Altitude immersion.

Group A sampling inspection. 100% inspection is not applicable. Sampling inspection shall be in accordance with table I:

TABLE I. Group A sampling plan.

Lot size	Sample size
1 to 13	100 percent
14 to 150	13 units
151 to 280	20 units
281 to 500	29 units
501 to 1,200	34 units
1,201 to 3,200	42 units

Part or Identifying Number (PIN) example:

MS27487    -12    -1  
 MS number    \_\_\_\_\_  
 Shell size    \_\_\_\_\_  
 Adapter geometry    \_\_\_\_\_  
   -1: Straight adapter  
   -2: 90° elbow adapter

Changes from previous issue. Marginal notations are not used in this revision to identify changes with respect to the previous issue, due to the extent of the changes.

Referenced documents. In addition to MIL-DTL-38999, this document references the following:

SAE-AS85049/32

MS27487F

CONCLUDING MATERIAL

Custodians:

Army - CR  
Navy - AS  
Air Force – 85  
DLA - CC

Preparing activity:

DLA - CC

(Project 5935-2012-039)

Review activities:

Army - AR, MI  
Navy - EC, MC, OS  
Air Force - 19, 99

NOTE: The activities listed above were interested in this document as of the date of this document. Since organizations and responsibilities can change, you should verify the currency of the information above using the ASSIST Online database at <https://assist.dla.mil>.