

INCH-POUND

MS27235D
 14 May 2007
 SUPERSEDING
 MS27235C
 22 September 2000

DETAIL SPECIFICATION SHEET

ELBOW TUBE, 45°

This specification is approved for use by all Departments and Agencies of the Department of Defense.

The requirements for acquiring the product described herein shall consist of this specification sheet and MIL-DTL-5070.

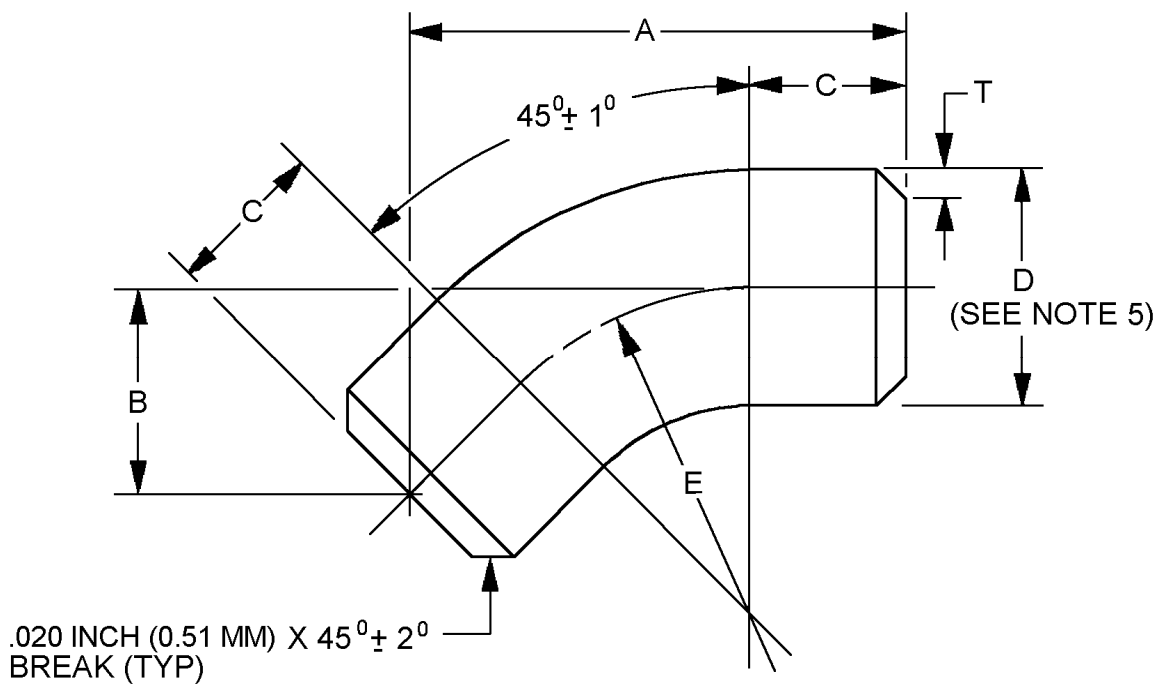

FIGURE 1. Elbow dimensions and configuration.

MS27235D

| Dash number | A ±.015 (0.38) inches (mm) | B ±.015 (0.38) inches (mm) | C +.031 (0.79) -.000 inches (mm) | D Dia ±.005 (0.13) inches (mm) (see note 5) | E Rad ±.060 (1.52) inches (mm) | T tube wall thickness inches (mm) | X inches (mm) (see note 6) |
|-------------|-------------------------------------|-------------------------------------|---|--|--|--|----------------------------------|
| -4 | .531 (13.49) | .220 (5.59) | .156 (3.96) | .245 (6.22) | .375 (9.53) | .035 (.89) | .010 (.25) |
| -5 | .575 (14.61) | .238 (6.05) | | .307 (7.80) | .438 (11.13) | .049 (1.24) | .012 (.30) |
| -6 | .620 (15.75) | .256 (6.50) | | .370 (9.40) | 500 (12.70) | | .014 (.36) |
| -8 | .708 (17.98) | .293 (7.44) | | .495 (12.57) | | .016 (.41) | |
| -10 | 1.024 (26.01) | .424 (10.77) | | .620 (15.75) | .625 (15.88) | .065 (1.65) | .018 (.46) |
| -12 | 1.112 (28.24) | .461 (11.71) | .745 (18.92) | .844 (21.44) | .020 (.51) | | |
| -16 | 1.266 (32.16) | .525 (13.34) | .995 (25.27) | .969 (24.61) | .022 (.56) | | |
| -20 | 1.399 (35.53) | .580 (14.73) | .250 (6.35) | 1.245 (31.62) | 1.188 (30.18) | .083 (2.11) | .024 (.61) |
| -24 | 1.664 (42.27) | .690 (17.53) | | 1.495 (37.97) | 1.375 (34.93) | | .026 (.66) |
| -32 | 1.885 (47.88) | .781 (19.84) | | 1.995 (50.67) | 1.750 (44.45) | .028 (.71) | |
| -40 | 2.062 (52.37) | .854 (21.69) | | 2.370 (60.20) | 2.062 (52.37) | .095 (2.41) | .030 (.76) |
| -48 | | | | 2.995 (76.07) | 2.312 (58.72) | | |

NOTES:

1. Dimensions are in inches.
2. Metric equivalents are for information only.
3. Unless otherwise specified, break all corners, radius .010/.005 inch (0.25/0.13 mm).
4. Break all edges and remove all burrs and slivers.
5. Ovality at bend shall not exceed 5% of tubing outside diameter.
6. Face of tube must be perpendicular to centerline of the tube within X total indicator reading.

FIGURE 1. Elbow dimensions and configuration - Continued.

MS27235D

REQUIREMENTS:

Dimensions and configurations: The design, construction, and physical dimensions shall be in accordance with MIL-DTL-5070 and figure 1 in case of conflict between this drawing and MIL-DTL-5070, this drawing shall govern.

Intended use. This part is a component of MS27225 and MS27229. As part of an assembly this part is used on MS27226 and MS27230 hose to tube adapters. This item shall not be procured for stocking purposes.

Materials: Materials shall be in accordance with MIL-DTL-5070.

Finish: Finish shall be in accordance with MIL-DTL-5070. Platings are applied after heat treats.

Color identification: Color identification shall be in accordance with MIL-DTL-5070.

Part or Identifying Number (PIN) example:

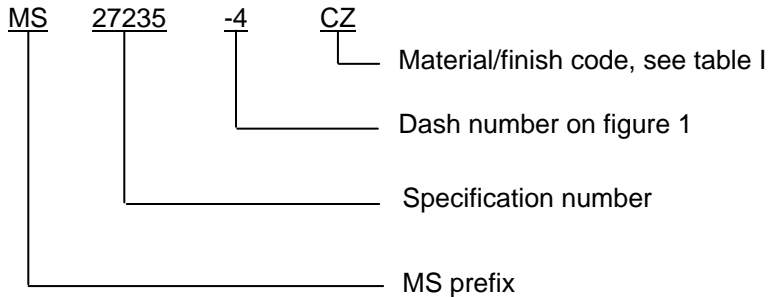

TABLE I. Code for material and finish.

| Code | Dash size | Material/finish |
|------|----------------|---|
| CC | -4 through -6 | Carbon Steel - cadmium plating |
| CZ | -4 through -6 | Carbon steel - zinc plating |
| SS | -4 through -6 | Corrosion resistant steel - N/A |
| AA | -8 through -48 | Aluminum - anodic coating |
| TA | -4 through -48 | Titanium - anodized or fluoride phosphated. |

Changes from previous issue. Marginal notations are not used in this revision to identify changes with respect to the previous issue, due to the extent of the changes.

Referenced documents: In addition to MIL-DTL-5070, this document references the following:

MS27225
 MS27226
 MS27229
 MS27230

MS27235D

CONCLUDING MATERIAL

Custodians:

Army - AT
Navy - AS
Air Force - 99
DLA - CC

Preparing activity:

DLA - CC

(Project 4730-2005-053)

Review activities:

Army - AV
Navy - MC, SA
Air Force - 11, 70, 71

NOTE: The activities listed above were interested in this document as of the date of this document. Since organizations and responsibilities can change, you should verify the currency of the information above using the ASSIST Online database at <http://assist.daps.dla.mil>.