

INCH-POUND

MS27234C  
 14 May 2007  
 SUPERSEDING  
 MS27234B  
 22 September 2000

## DETAIL SPECIFICATION SHEET

## ELBOW TUBE, 90°

This specification is approved for use by all Departments and Agencies of the Department of Defense.

The requirements for acquiring the product described herein shall consist of this specification sheet and MIL-DTL-5070.

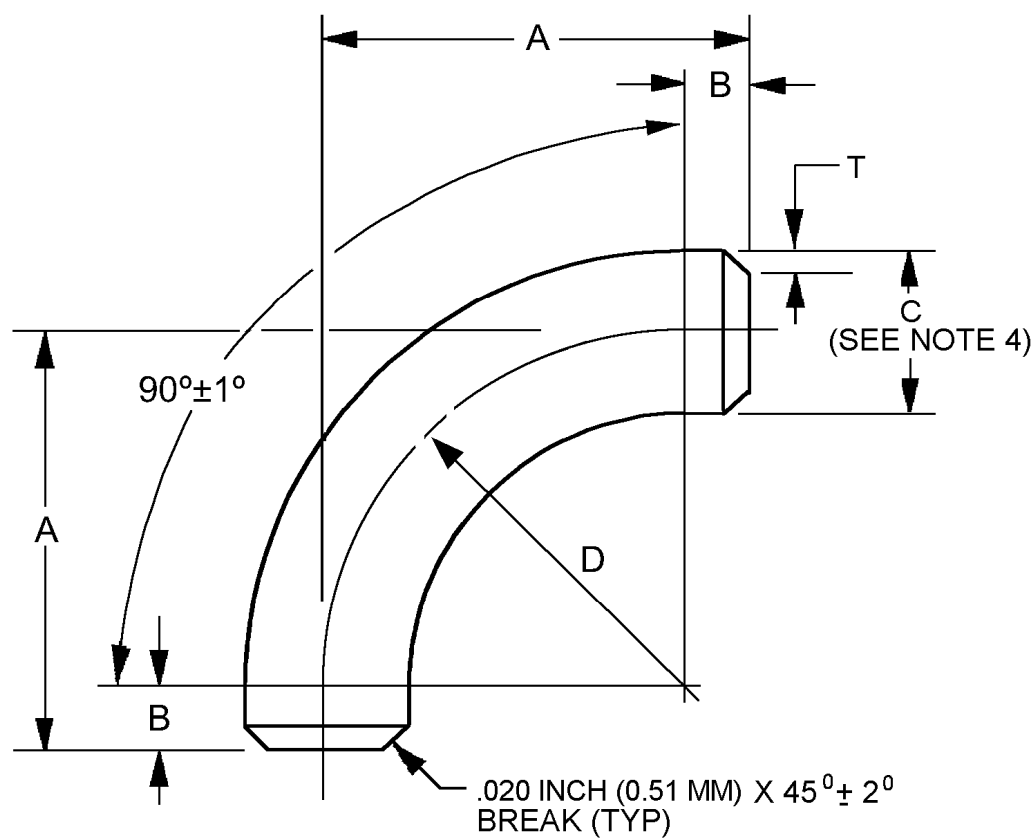

FIGURE 1. Elbow dimensions and configuration.

## MS27234C

Dash number	A ±.015 (0.38 inches (mm)	B +.031 (0.20) -.000 inches (mm)	C Dia (see note 4 ±.005 (0.13) inches (mm)	D Rad ±.060 (1.52) inches (mm)	T tube wall thickness inches (mm)	X (see note 5) inches (mm)
-4	.531 (13.49)	.156 (3.96)	.245 (6.22)	.375 (9.53)	.035 (.89)	.010 (.25)
-5	.594 (15.09)		.307 (7.80)	.438 (11.13)	.049 (1.24)	.012 (.30)
-6	.656		.370 (9.40)	.500		.014 (.36)
-8	(16.66)		.495 (12.57)	(12.70)		.016 (.41)
-10	.781 (19.84)		.620 (15.75)	.625 (15.88)		.018 (.46)
-12	1.094 (27.79)	.250 (6.35)	.745 (18.92)	.844 (21.44)	.065 (1.65)	.020 (.51)
-16	1.219 (30.96)		.995 (25.27)	.969 (24.61)		.022 (.56)
-20	1.438 (36.53)		1.245 (31.62)	1.188 (30.18)		.024 (.61)
-24	1.625 (41.28)		1.495 (37.97)	1.375 (34.93)	.083 (2.11)	.026 (.66)
-32	2.000 (50.80)		1.995 (50.67)	1.750 (44.45)		.028 (.71)
-40	2.312 (58.72)		2.370 (60.20)	2.062 (52.37)	.095 (2.41)	.030 (.76)
-48	2.562 (65.07)		2.995 (76.07)	2.312 (58.72)		

## NOTES:

1. Dimensions are in inches.
2. Metric equivalents are given for information only.
3. Unless otherwise specified, break all corners, radius .010/.005 inch (.25/.01 mm).
4. Ovality at bend shall not exceed 5% of tubing outside diameter.
5. Face of tube must be perpendicular to centerline of the tube within X total indicator reading.
6. Break all sharp edges and remove all burrs and slivers.

FIGURE 1. Elbow dimensions and configuration - Continued.

## MS27234C

## REQUIREMENTS

Dimensions and configurations: The design, construction, and physical dimensions shall be in accordance with MIL-DTL-5070 and figure 1 in case of conflict between this drawing and MIL-DTL-5070, this drawing shall govern.

Intended use. This part is a component of MS27223 and MS27227. As part of an assembly this part is used on MS27224 and MS27228 hose to tube adapters. This item shall not be procured for stocking purposes.

Materials: Materials shall be in accordance with MIL-DTL-5070.

Finish: Finish shall be in accordance with MIL-DTL-5070. Platings are applied after heat treats.

Color identification: Color identification shall be in accordance with MIL-DTL-5070.

Part or Identifying Number (PIN) example:

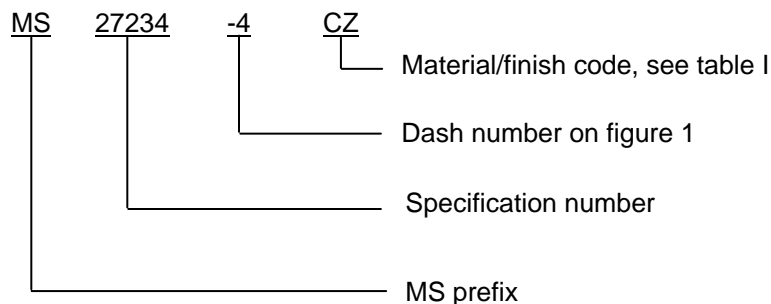

TABLE I. Code for material and finish.

Code	Dash size	Material/finish
CC	-4 through -6	Carbon Steel - cadmium plating
CZ	-4 through -6	Carbon steel - zinc plating
SS	-4 through -6	Corrosion resistant steel - N/A
AA	-8 through -48	Aluminum - anodic coating
TA	-4 through -48	Titanium - anodized or fluoride phosphated.

Identification of product. The PIN and the manufacturer's Commercial and Government Entity (CAGE) code or trademark shall be permanently marked on the assembly, see figure 1, or on a removable tag securely attached to the assembly.

Changes from previous issue. Marginal notations are not used in this revision to identify changes with respect to the previous issue, due to the extent of the changes.

Referenced documents. In addition to MIL-DTL-5070, this document references the following:

MS27223  
MS27224  
MS27227  
MS27228

MS27234C

CONCLUDING MATERIAL

Custodians:

Army - AT  
Navy - AS  
Air Force - 99  
DLA - CC

Preparing activity:

DLA - CC

(Project 4730-2005-052)

Review activities:

Army - AV  
Navy - MC, SA  
Air Force - 11, 70, 71

NOTE: The activities listed above were interested in this document as of the date of this document. Since organizations and responsibilities can change, you should verify the currency of the information above using the ASSIST Online database at <http://assist.daps.dla.mil>.