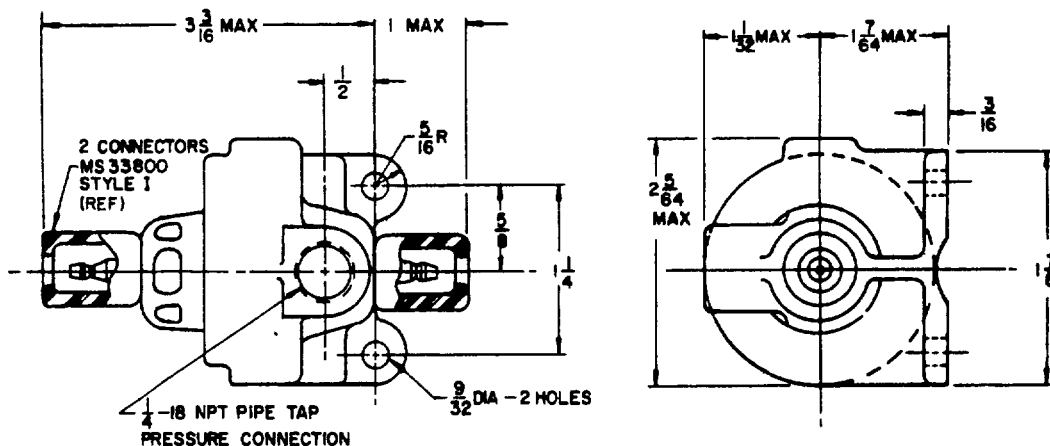

FED SUP CLASS  
5930

⑧  
NOTES:

1. TYPE I (LOW PRESSURE CLOSING CONTACTS) GRADE A (WATERPROOF) CLASS 2 (LOW VIBRATION) OF PROCUREMENT SPECIFICATION.
2. SWITCH CONTACTS SHALL CLOSE AT  $60 \pm 6$  PSI AND REMAIN CLOSED ON DECREASING PRESSURE.
3. SWITCH CONTACT RATING AT 24 VOLTS DC: RESISTANCE LOAD 5 AMP. OR LAMP LOAD 3 AMP, OR INDUCTIVE LOAD 3 AMP. (L/R RATIO .026).
4. WITH SWITCH CONDUCTING RATED RESISTIVE LOAD CURRENT, THE TERMINAL TO TERMINAL VOLTAGE DROP SHALL NOT EXCEED 150 MILLIVOLTS PRIOR TO THE ENDURANCE TEST OF THE PROCUREMENT SPECIFICATION AND SHALL NOT EXCEED 300 MILLIVOLTS AFTER ENDURANCE TEST.
5. DIMENSIONS ARE IN INCHES. UNLESS OTHERWISE SPECIFIED, TOLERANCES ARE  $\pm 1/64$  ON FRACTIONS.
6. THREADS SHALL BE IN ACCORDANCE WITH SCREW THREAD STANDARDS FOR FEDERAL SERVICES, HANDBOOK H28.
7. FOR DESIGN FEATURE PURPOSES, THIS STANDARD TAKES PRECEDENCE OVER PROCUREMENT DOCUMENTS REFERENCED HEREIN.
8. THIS STANDARD IS NOT INTENDED TO LIMIT CONSTRUCTION TO FEATURES OTHER THAN AS SHOWN HEREON BY DIMENSIONS, NOTATIONS OR REFERENCED DOCUMENTS.
9. REFERENCED DOCUMENTS SHALL BE OF THE ISSUE IN EFFECT ON DATE OF INVITATIONS FOR BID.
10. MARKING SHALL CONSIST OF THE MS PART NUMBER AND MANUFACTURER'S IDENTIFICATION IN ACCORDANCE WITH MIL-STD-130.

MS PART NO	FORMER ARMY PART NO
MS 27152-1	6376997

P A ARMY-AT	TITLE	MILITARY STANDARD
Other Cust	SWITCH, PRESSURE-WARNING, LOW AIR PRESSURE, 60 PSI, SPST, WATERPROOF	MS 27152
PROCUREMENT SPECIFICATION MIL-S-12211	SUPERSEDES	SHEET 1 OF 1

DD FORM 672-1 (Coordinated)

PREVIOUS EDITIONS OF THIS FORM ARE OBSOLETE

USER ACTIVITIES: ARMY-ME, NAVY-MC, AF-11, B4, B5

This military standard is mandatory for use by all Departments and Agencies of the Department of Defense. Selection for all new engineering and design applications and for repetitive use shall be made from this document.

APPROVED 15 AUGUST 1961 REVISED 20 AUGUST 1962 ⑧ 13 JUNE 1968