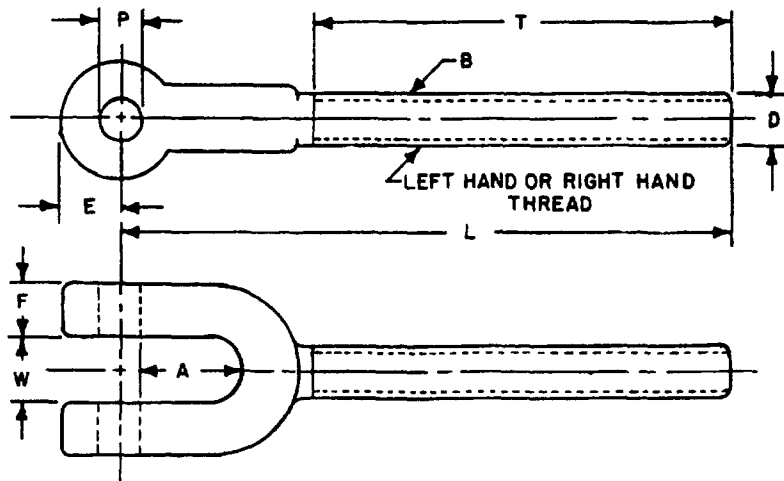

FED SUP CLASS
5340

L. H. THREAD DASH NO	R. H. THREAD DASH NO	NOM DIA D	THREAD UNC-2A B	BREAKING STRENGTH LBS MIN	RECOM- MENDED WORKING LOAD LBS	E REF	A MIN	F MIN	P DIA MIN	W MIN	L REF	T REF	** TURNBUCKLE BODY CLEAR OPENING (TAKE-UP)
1	2	.250	1/4-20	1550	310	.34	.62	.12	.25	.38	3.69	2.56	4
3	4	.312	5/16-18	2700	540	.34	.72	.12	.25	.47	4.34	3.00	4.5
5	6	.375	3/8-16	4100	820	.47	.81	.19	.31	.50	5.38	3.94	6
7	8	.500	1/2-13	7550	1500	.56	1.03	.25	.38	.62	6.00	4.25	6
9	10										7.50	5.75	9
11	12										9.00	7.25	12
13	14	.625	5/8-11	12100	2400	.75	1.25	.31	.50	.75	8.94	4.56	6
15	16										8.44	6.06	9
17	18										9.94	7.56	12
19	20										11.44	9.06	18
21	22										7.44	4.88	6
23	24	.750	3/4-10	18100	3600	.97	1.50	.38	.62	.94	8.94	6.38	9
25	26										10.44	7.88	12
27	28										13.44	10.88	18
29	30										16.44	13.88	24
31	32										8.19	5.19	6
33	34	.875	7/8-9	25100	5000	1.09	1.75	.44	.75	1.12	11.19	8.19	12
35	36										14.19	11.19	18
37	38										9.06	5.50	6
39	40	1	1 -8	33100	6600	1.28	2	.50	.88	1.19	12.06	8.50	12
41	42										15.06	11.50	18
43	44										18.06	14.50	24
45	46										21.06	17.50	36
47	48										12.56	8.75	12
* 49	50	1.125	1 1/8-7	41600	8300	1.44	2.19	.56	1	1.50	15.56	11.75	18
51	52										18.56	14.75	24
53	54	1.250	1 1/4-7	53600	10700	1.62	2.38	.62	1.12	1.75	13.12	9.12	12
55	56										16.12	12.12	18
57	58										19.12	15.12	24
59	60	1.500	1 1/2-6	77700	15500	1.94	2.75	.69	1.38	2.06	15.12	11.06	12
61	62										18.12	14.06	18
63	64										21.12	17.06	24
65	66										24.12	20.06	36
67	68	1.750	1 3/4-5	105000	21000	1.31	3	.75	1.62	2.38	20.12	16.06	18
69	70										23.62	19.56	24
71	72	2	2-4 1/2	138000	27600	2.69	3.75	.81	1.88	2.50	26.62	22.56	36
73	74										26.12	22.06	24
75	76	2.500	2 1/2-4	223000	44600	3.06	4.25	1	2.25	2.88	29.12	25.06	36
77	78										32.12	28.06	48

** See note 4.
* See note 11.

(A) ENTIRE STANDARD REVISED

P. A. 6C
Other Cust
52TITLE
CLEVIS, ROD END-TURNBUCKLE
(GENERAL PURPOSE)

MILITARY STANDARD

MS27120

PROCUREMENT SPECIFICATION
FF-T-791

SUPERSEDES

SHEET 1 OF 2

DD FORM 672-1 (Coordinated)

PREVIOUS EDITIONS OF THIS FORM ARE OBSOLETE

This military standard is mandatory for use by all Departments and Agencies of the Department of Defense. Selection for all new engineering and design applications and for repetitive use shall be made from this document.

APPROVED 3 MAR 61
REVISED 26 JUN 68

REVIEWER IS, ME, 85
USER AT, AV, EL, GL, MC, SH

FED SUP CLASS
5340

NOTES.

1. MATERIAL Steel, forged, in accordance with the procurement specification
2. PROTECTIVE COATING Hot-dip galvanized in accordance with ASTM A153
3. THREADS The threads shall be in accordance with the Screw Thread Standards for Federal Services, Handbook H-28.
4. These dimensions are given for reference only.
5. All dimensions are in inches, unless otherwise specified.
6. The MS part number consists of the MS number, plus the dash number
Example MS27120-1.
7. The recommended working load (safety factor 5 to 1) is based on the breaking strength at the thread root.
8. For design feature purposes, this standard takes precedence over procurement documents referenced herein.
9. Reference documents shall be of the issue in effect on date of invitations for bid.
10. The illustration is for identification and is not intended to restrict designs or shapes not dimensioned
11. Dash numbers 47 thru 52, inclusive, are inactive for new design No longer manufactured

APPROVED 3 MAR 61 REVISED (A) FOR CHANGES SEE SHEET 1

P. A. 100 Other Cust 82	TITLE CLEVIS, ROD END-TURNBUCKLE (GENERAL PURPOSE)	MILITARY STANDARD MS27120
PROCUREMENT SPECIFICATION FF-T-701	SUPERSEDES	SHEET 2 OF

DD FORM 672-1 (Coordinated)

PREVIOUS EDITIONS OF THIS FORM ARE OBSOLETE

This military standard is mandatory for use by all Departments and Agencies of the Department of Defense. Selection for all new engineering and design applications and for repetitive use shall be made from this document.

REVIEWER IS, ME, 85
SER AT, AV, EL, GL, MC, SH