

FED. SUP CLASS
4730

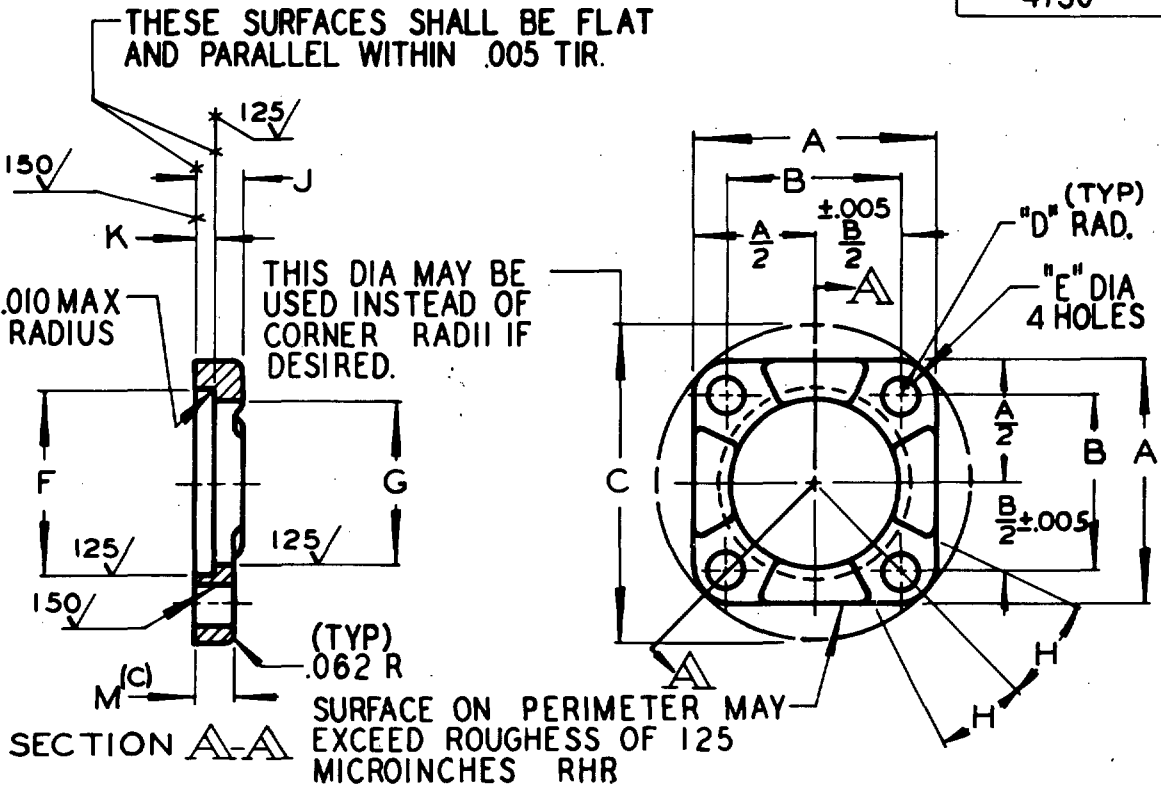

MATERIAL: CORROSION RESISTING STEEL, CLASS 304, CONDITION "A", SPECIFICATION QQ-S-763.

PASSIVATE PER MIL-F-27272.

(a) DIAMETERS "G" AND "F" SHALL BE CONCENTRIC WITHIN .010 TIR.

(b) REDUCTION OF DIMENSIONS BY 7° MAX DRAFT ANGLE PERMISSIBLE IF FORGED.

PART MAY BE FORGED OR MACHINED FROM BAR. (C) IF MACHINED, THICKNESS SHALL BE TO DIMENSION "M".

DIMENSIONS IN INCHES. UNLESS OTHERWISE SPECIFIED: RADIUS OR BREAK ALL CORNERS .005 ±.005/-.000. REMOVE ALL BURRS AND SLIVERS. SURFACE ROUGHNESS PER ASA B46.1-1962.

THIS STANDARD TAKES PRECEDENCE OVER DOCUMENTS REFERENCED HEREIN.

THIS IS A DESIGN STANDARD FOR MANUFACTURING PURPOSES. THE ITEM IS ONLY PROCURED AS AN INTEGRAL PART OF ADAPTER ASSY. NEXT ASSEMBLY MS27062, MS27064 AND MS27066.

ⓑ ENTIRE STANDARD REVISED.

ⓑ FOR CHANGES SEE SHEETS 1 AND 2.

PA AIR FORCE-II	TITLE	MILITARY STANDARD
Other Cust ARMY-MO NAVY-WP	FLANGE, SWIVEL, RETAINING	MS27077
Procurement Specification	SUPERSEDES	SHEET 1 OF 2

Review Activities - MO
 Army - MI
 Navy - SH
 Air Force - 11, 69

This standard is approved by the Department of Defense and is mandatory on all activities. Selection for all new engineering and design applications and for repetitive use shall be made from this document.

APPROVED 1 SEP 61 REVISED ⓐ 2 JUL 63 ⓑ 2 MAY 66

FED SUP CLASS

4730

Review Activities:
 Army - MO
 Navy - WP
 Air Force - 11, 69

User Activities:
 Army - MT
 Navy - SH

MS PART NUMBER	A(b)	B	C	D	E	F(a)	G(a)	H	J	K	M
MS27077-8C	1.390	.950	1.782			.885	.750	± 1/2			
MS27077-10C	1.468	1.038	1.906			1.010	.880	20°			
MS27077-12C	1.594	1.156	2.094	.219	.205	1.260	1.125		.297	.136	.234
MS27077-16C	1.750	1.312	2.312			1.510	1.375	18°			
MS27077-20C	2.188	1.656	2.875	.266	.266	1.854	1.688	16°			
MS27077-24C	2.375	1.812	3.094	.281		2.135	1.938		.359	.168	.297

ENTIRE STANDARD REVISED

APPROVED 1 SEP 61 REVISED (A) 2 JUL 63 (B) FOR CHANGES SEE SHEETS 1 AND 2.

PA AIR FORCE - 11 Other Cust ARMY - MO NAVY - WP	TITLE FLANGE, SWIVEL, RETAINING	MILITARY STANDARD
		MS27077
Procurement Specification	QUANTITIES	SHEET 2 OF 2