

INCH-POUND

MS27072E
 24 September 2003
 SUPERSEDING
 MS27072C
 30 June 1972

DETAIL SPECIFICATION SHEET

WIRE, RETAINER

This specification is approved for use by all Departments
 and Agencies of the Department of Defense.

The requirements for acquiring the product described herein
 shall consist of this specification and MIL-DTL -27272.

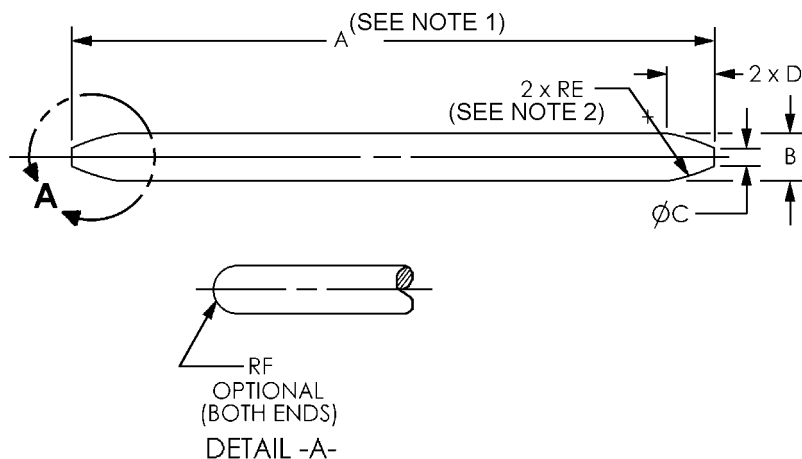

NOTES:

1. Wire shall be straight within .020 full indicator movement.
2. Radius shall be concentric to wire OD within .005 full indicator movement.

FIGURE 1. Wire, retainer illustration.

REQUIREMENTS

AMSC N/A
 DISTRIBUTION STATEMENT A. Approved for public release; distribution is unlimited.

MS27072E

Intended use. This part is a component of MS27062 through MS27068 and MS27387 through MS27390. This is a design standard for manufacturing purposes. The item is only procured as an integral part of adapter assemblies.

Identification of product. The Part of Identifying Number (PIN) for this part shall be as specified in table I (e.g., MS27072-4C).

Dimensions and tolerances. Dimensions are in inches. Unless otherwise specified, break or radius all corners .005, +.005, -.000.

Material. Corrosion-resistant steel, class 305 or 304, condition A in accordance with ASTM A580 or ASTM A313.

Finish. Passivate in accordance with SAE AMS-QQ-P-35. Dry-film lubricate with lubrication conforming to SAE AS1701 or MIL-PRF-46010.

Wire, retainer illustration. See figure 1.

Remove all burrs and slivers.

Surface roughness. Unless otherwise specified, maximum surface roughness shall not exceed 125 μin . R_a in accordance with ASME B46.1.

Order of precedence. This specification takes precedence over the documents referenced herein. Unless otherwise specified, referenced documents shall be of the issue in effect on the date of solicitation.

TABLE I. Wire, retainer requirements.

PIN MS27072	A ^{1/} $\pm .015$	B		C $\pm .010$	D $\pm .005$	E ^{2/} +.010 - .005	F	
-4C	1.203	.072	+ .000 - .005	.017	.065	.139	.026	$\pm .005$
-5C	1.325	.080	+ .000 - .004	.020	.073	.156	.030	
-6C	1.545			.023	.087	.186	.037	
-8C	1.969	.095		.031	.115	.246	.050	$\pm .010$
-10C	2.250							
-12C	2.625							
-16C	3.703							
-20C	4.500							
-24C	5.375	.125						

^{1/} Wire shall be straight within .020 full indicator movement.

^{2/} Radius shall be concentric to wire OD within .005 full indicator movement.

MS27072E

Changes from previous issue. Marginal notations are not used in this revision to identify changes with respect to the previous issue, due to the extent of the changes.

CONCLUDING MATERIAL

Custodians:

Army - AV
Navy - AS
Air Force - 99
DLA - CC

Preparing activity:

DLA - CC

(Project 4730-2260-000)

Review activities:

Army - AT, MI
Navy - MC, SA, SH
Air Force - 71