

INCH-POUND

MS25223H
30 August 2005

SUPERSEDING
MS25223G
20 December 1982

DETAIL SPECIFICATION SHEET

Guard, Switch, 3 Position

INACTIVE FOR NEW DESIGN AFTER 30 AUGUST 2005

This specification is approved for use by all
Departments and Agencies of the Department of Defense.

The complete requirements for acquiring the switch described herein shall consist of this specification and the latest issue of MIL-DTL-7703.

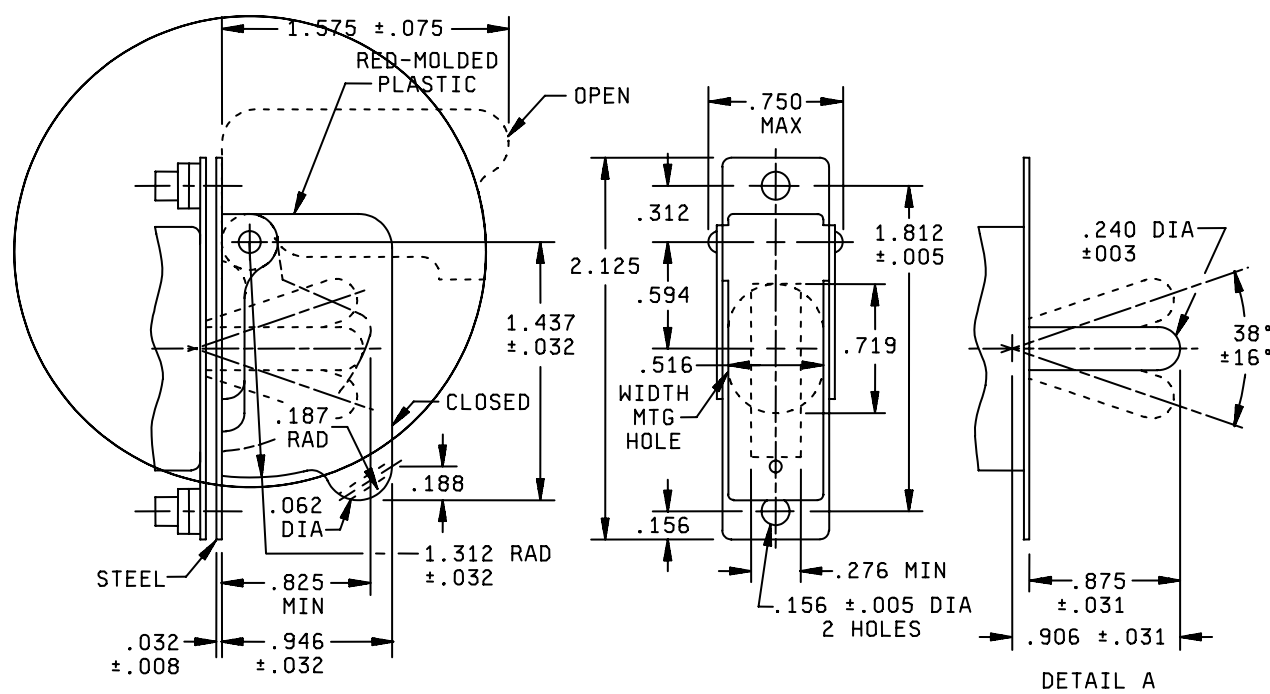

-1

Suitable for use with switches having toggle levers in accordance with detail A.

FIGURE 1 Dimensions and configuration

MS25223H

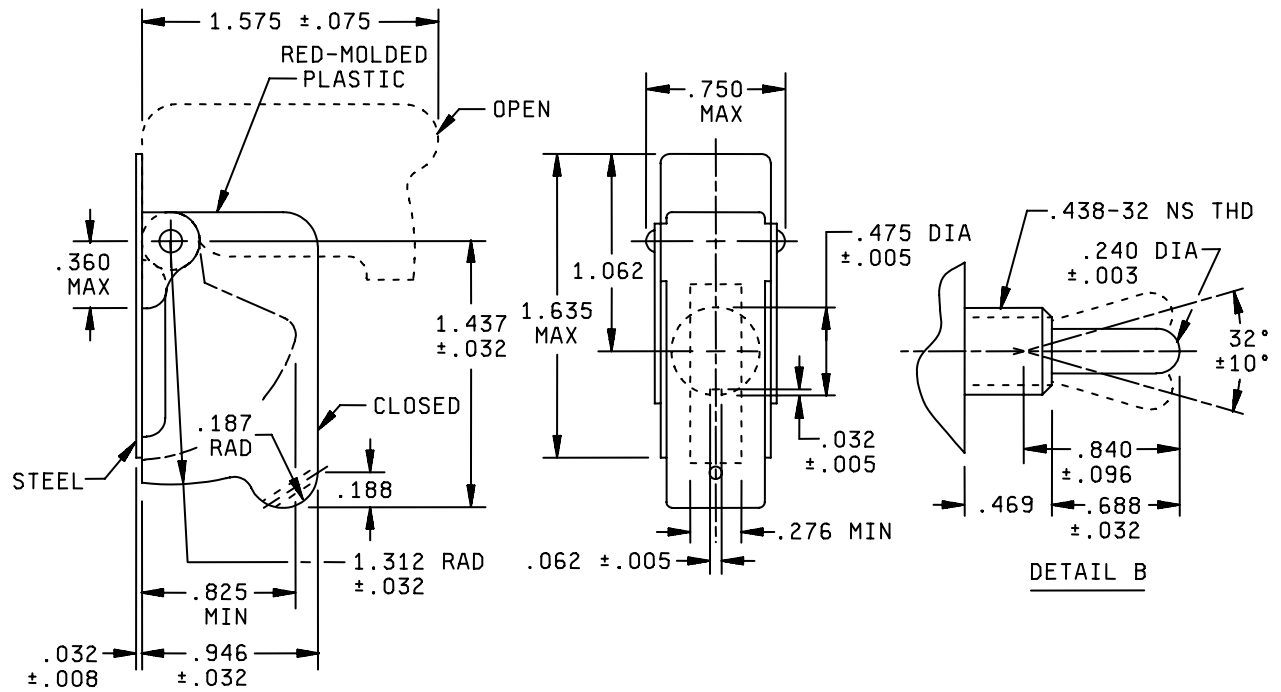

-2

Suitable for use with switches having toggle lever in accordance with detail B.

DASH NO.	TYPE	PANEL THICKNESS (REF)	OPERATING FORCE
-1	3- HOLE MOUNTING	.050 TO .081	.1 TO .7 LB
-2	1- HOLE MOUNTING	.050 TO .248	

FIGURE.1: Dimensions and configuration Continued

Inches	mm	Inches	mm	Inches	mm
.003	.08	.188	4.77	.750	19.05
.005	.13	.240	6.10	.825	20.95
.008	.20	.248	6.30	.840	21.34
.016	.41	.276	7.01	.875	22.22
.031	.79	.312	7.92	.906	23.01
.032	.81	.360	9.14	.946	24.03
.050	1.27	.469	11.91	1.062	26.97
.062	1.57	.475	12.06	1.312	33.32
.075	1.90	.516	13.11	1.437	36.50
.081	2.06	.575	14.60	1.575	40.00
.096	2.44	.594	15.09	1.635	41.53
.156	3.96	.688	17.47	1.812	46.02
.187	4.75	.719	18.26	2.125	53.98

MS25223H

NOTES:

1. Dimensions are in inches.
2. Unless otherwise specifies, Tolerances are $\pm .016$ on decimals.
3. For design feature purposed, this standard takes precedence over procurement documents referenced herein.
4. Referenced documents shall be of the issue in effect on date of invitations for bid.
5. Finish: Zinc plate, ASTM B 633, type III, or cadmium plate, SAE-AMS-QQ-P-416, type III, with optional supplementary treatment per MIL-C-8514 or DOD-P-15328, black enamel, lusterless, color number 37038 or semi-gloss, color number 27038, FED-STD-595 or equivalent.
6. Material: Plastic, molded, red color shade 11136, FED-STD- 595. Steel, commercial, shall be smooth and free from burrs.

REQUIREMENTS

Opening the guard shall not move the switch contacts.

Closing the guard shall place the switch lever in the center position from closing the guard shall place the switch lever in the center position from either the up or down position.

Referenced documents

MIL-DTL-7703
MIL-C-8514
ASTMB 633
SAE-AMS-QQ-P-416
DOD-P-15328
FED-STD-595

Marginal notations are not used in this revision to identify changes with respect to the previous issue due to the extent of the changes.

Custodians:

Army – CR
Navy – AS
Air Force – 11
DLA – CC

Preparing activity

DLA -CC
(Project 5930-2005-008)

Review activities:

Air Force – 99

NOTE: The activities listed above were interested in this document as of the date of this document. Since organizations and responsibilities can change, you should verify the currency of the information above using the ASSIST Online database at <http://assist.daps.dla.mil/>.