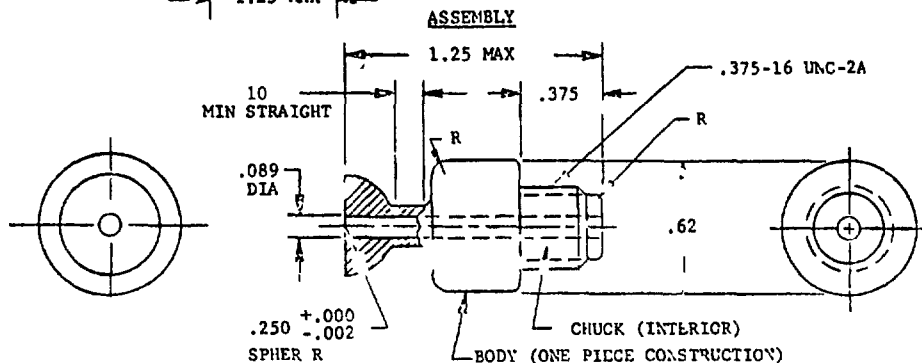
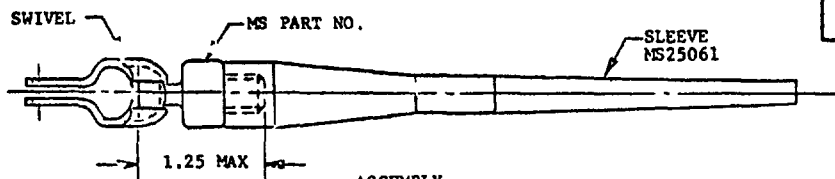
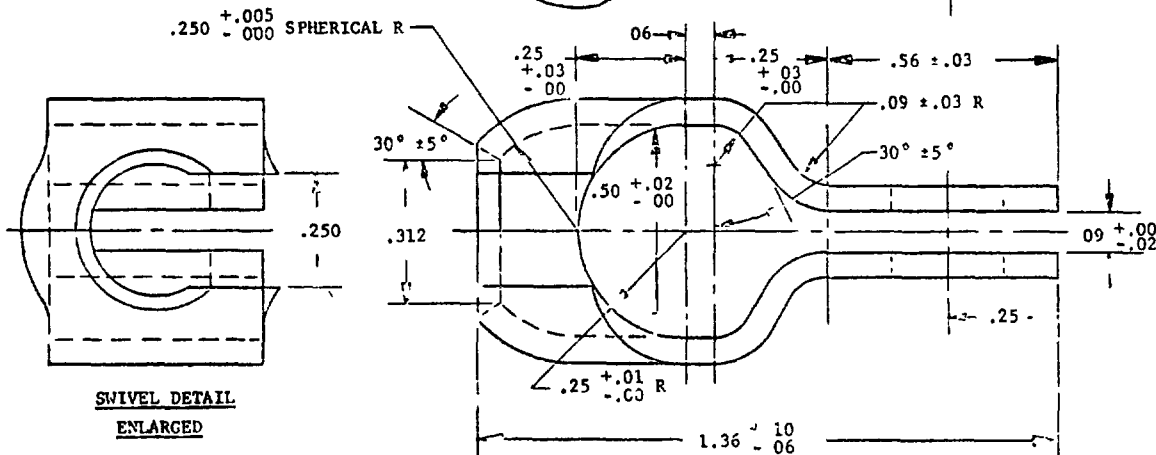
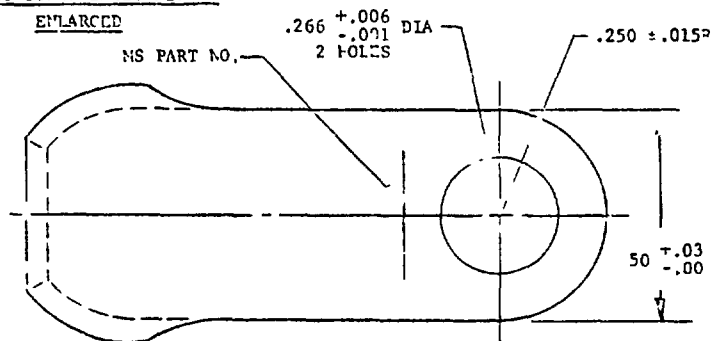

FED. SUP CLASS
5985TAKEUP SUBASSEMBLY DETAILENLARGED

MS PART NO.

MS25057-1

FOR NOTES SEE SHEET 2

FOR DESIGN FEATURE PURPOSES, THIS STANDARD TAKES PRECEDENCE OVER PROCUREMENT DOCUMENTS REFERENCED HEREIN
REFERENCED DOCUMENTS SHALL BE OF THE ISSUE IN EFFECT ON DATE OF INVITATIONS FOR BID

(A) REVISED

P A NAVY - AS Other Cust USAF - 85	TITLE TAKEUP, ANTENNA	MILITARY STANDARD MS25057
PROCUREMENT SPECIFICATION MIL-A-7965	SUPERSEDES MS25057 (ASG)	SHEET 1 OF 2

USER BY: 13 L

REVIEWER SYMBOLS:

"Review/user information is current as of the date of this document
For future coordination of changes to this document, draft circulation
should be based on the information in the current DODIGS"

This military standard is approved for use by all Departments
of the Department of Defense. Selection for all new
engineering and design applications and for repetitive use shall
be made from this document.

 APPROVED 18 AUG 55
 (A)
 18 JUNE 76

- 2 BYMS 010 -

S M M

REV

Test/User information is current as of the date of this document.
For future coordination of changes to this document draft circulation
should be based on the information in the current DODISS.

This military standard is approved by staff of all Departments.
Agencies of the Department of Defense. Selection for all new
engineering and design applications and for repetitive use shall
be made from this document.

FED SUP CLASS
5985

NOTES:

1. MATERIAL: SWIV'L, 06 CORROSION RESISTANT STEEL, MIL-S-5059
SOCKET AND TAKEUP BODY, CORROSION RESISTANT STEEL MIL-S-5059
2. REMOVE BURRS AND SHARP EDGES.
3. DIMENSIONS IN INCHES UNLESS OTHERWISE SPECIFIED, TOLERANCES TWO PLACE DECIMALS - .01,
THREE PLACE DECIMALS - .005.
4. THREADS SHALL CONFORM TO MIL-S-7742.
5. MAXIMUM WEIGHT 0.11 POUND

APPROVED 18 AUG 55 REVISED (A) FOR CIVILIAN USE SHEET 1

P A NAVY - AS Other Cust USAF - 85	TITLE TAKEUP, ANTENNA	MILITARY STANDARD MS25057
PROCUREMENT SPECIFICATION MIL-A-7965	SUPERSEDES MS25057 (ASG)	SHEET 2 OF 2