

FED SUP CLASS
6695

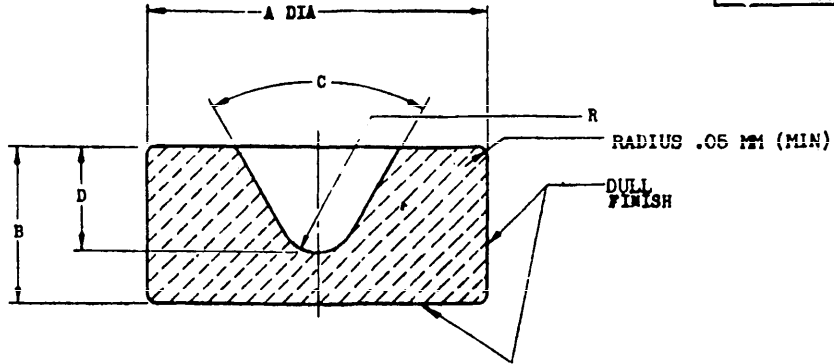

MS PART NO.	FIN	A DIA		B THK		C CONE ANGLE	D		R RAD	
		INCHES	.01MM	INCHES	.01MM		INCHES	.01MM	INCHES	.01MM
MS24598-1		.0493	125	.0394	100	75°	.0197	50	.0020	5 ±1
MS24598-2		.0493	125	.0394	100	75°	.0197	50	.0032	8 ±2
MS24598-3		.0591	150	.0473	120	75°	.0237	60	.0020	5 ±1
MS24598-4		.0591	150	.0473	120	75°	.0237	60	.0032	8 ±2
MS24598-5		.0788	200	.0591	150	75°	.0296	75	.0032	8 ±2
MS24598-6		.0788	200	.0591	150	75°	.0296	75	.0047	12 ±2
MS24598-7		.0788	200	.0591	135	95°	.0257	65	.0079	20 ±2

INACTIVE FOR NEW DESIGN
AFTER 11 SEPTEMBER 1969

NOTICE: When Government drawings, specifications, or other data are used for any purpose other than in connection with a definitely related Government procurement operation, the United States Government thereby incurs no responsibility, and the fact that the Government may have furnished, furnished, or in any way supplied the said drawings, specifications, or other data is not to be regarded as an implication or attribution of any manner licensing the holder or any other person or corporation, or conveying any rights of permission to manufacture, use, or sell any patented invention that may in any way be related thereto.

MATERIAL: SYNTHETIC WHITE SAPPHIRE.
FINISH: ALL SURFACES TO BE POLISHED EXCEPT WHERE OTHERWISE INDICATED.
BEARING SURFACE TO BE FREE OF CHIPS AND SCRATCHES VISIBLE WITH AN 18X EYE GLASS.

NOTE: OUTSIDE DIAMETER AND AXIS OF CONE TO BE CONCENTRIC WITHIN .01 MM TOTAL INDICATOR READING.

THE MS PART NUMBER CONSISTS OF THE MS NUMBER, PLUS THE DASH NUMBER.
EXAMPLE: MS 24598-1.

THESE STANDARD ITEMS ARE MANDATORY FOR USE IN DESIGN, ENGINEERING AND PROCUREMENT FOR ALL SIZES OF JEWEL BEARINGS REQUIRED BETWEEN THE MAXIMUM AND MINIMUM SIZES SHOWN ON THE STANDARD.

INCH DIMENSIONS ARE FOR INFORMATION ONLY.

APPROVED 25 AUG 1969 REVISED 8 APR 1960 (5) 11 SEPT 1969

PA-MU SH	OTHER INT.	MILITARY STANDARD	MS24598
	AF-		
PROCUREMENT SPECIFICATION NONE		SUPERSEDES:	SHEET 1 OF 1