

Army ME, AM, WC
Navy MC, SH
Air Force

User activities

Army MI, MU, AT
Navy AS, OS
Air Force II

This military standard is mandatory for use by all Departments and Agencies of the Department of Defense. Selection for all new engineering and design applications and for repetitive use shall be made from this document.

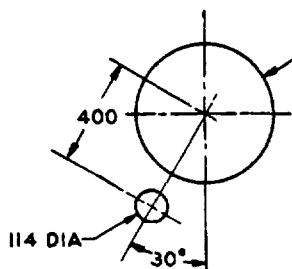
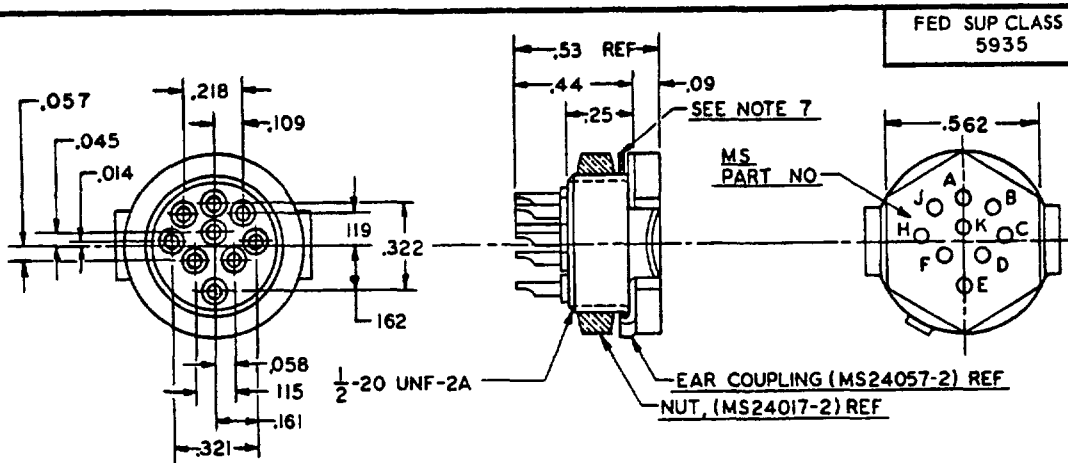

PANEL DRILLING TYP
MAY BE ROTATED TO PLACE
TERMINALS AS DESIRED

SUGGESTED MOUNTING
CONFIGURATION

INCHES	MM	INCHES	MM
.014	.36	.162	4.11
.045	1.14	.218	5.54
.057	1.45	.25	6.35
.058	1.47	.321	8.15
.09	2.29	.322	8.18
.109	2.77	.400	10.16
.114	2.90	.44	11.18
.115	2.92	.515	13.08
.119	3.02	.53	13.46
.161	4.09	.562	14.27

MS Part No. MS24055-1

(D)

INACTIVE FOR NEW DESIGN
AFTER 6 December 1971

NOTES:

- Dimensions are in inches.
- Unless otherwise specified, tolerances are ± 0.02 (.51 mm) for two place decimals, and ± 0.005 (.13 mm) for three place decimals.
- Metric equivalents (to the nearest .01 mm) are given for general information only and are based upon 1 inch = 25.4 mm.
- Tolerance between any two adjacent contact centers shall be ± 0.002 (.05 mm). Tolerance between any two contact centers, other than adjacent contacts, shall be ± 0.003 (.08 mm).
- Contact identification may be located on either side of the contact hole but shall appear on the front and rear face of each insert.
- For mating connector see connector MS 24056.
- Lockwasher, internal tooth, phosphor, bronze, shakeproof no. 1924-02-00, or equal.
- For design feature purpose, this standard takes precedence over procurement documents referenced herein.
- Referenced documents shall be of the issue in effect on date of invitation for bid.
- For shield for use with this connector, see MS 24018.
- Without nut and lockwasher connector may be used as a plug on cable MS 24120-2 is also needed in this application.
- Group A and B inspection is required in lieu of qualification.

(D)

REDRAWN

P A NAVY-EC Other Cust AF 80 ARMY-EL	International interest	TITLE CONNECTOR, PLUG-RECEPTACLE, ELECTRICAL, HEXAGONAL, 9 CONTACTS, FEMALE, 7.5 AMPS.	MILITARY STANDARD
Procurement Specification MIL-C-28748		SUPERSEDES	MS24055
			SHEET 1 OF 1

DD FORM 10 APR 64 672

(Coordinated) PREVIOUS EDITIONS OF THIS FORM ARE OBSOLETE

5935-1722-8

APPROVED 12 Aug 1954 REVISED (D) 6 Dec 1971