

User activities: Army ME, AM, WC
Navy MC, SH
Air Force

Army MI, MU, AT
Navy AS, OS
Air Force II

Reviewer activities

This military standard is mandatory for use, by all Departments and Agencies of the Department of Defense. Selection for all new engineering and design applications and for repetitive use shall be made from this document.

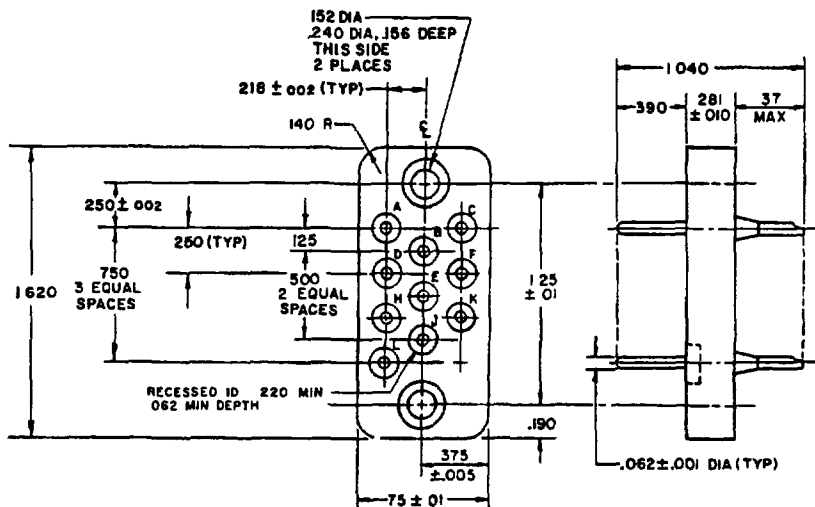

INCHES	MM
.001	.03
.002	.05
.005	.13
.010	.25
.062	1.57
.125	3.18
.140	3.56
.152	3.86
.156	3.96
.190	4.83
.218	5.54
.220	5.59
.240	6.10
.250	6.35
.281	7.14
.37	9.40
.375	9.53
.390	9.91
.500	12.70
.750	19.05
1.040	26.42
1.25	31.75
1.620	41.15

MS Part No. MS24030-1

④

INACTIVE FOR NEW DESIGN
AFTER 6 DECEMBER 1971

NOTES

- 1 Dimensions are in inches.
2 Unless otherwise specified, tolerance is ± 0.015 (.38 mm)
3 Metric equivalents (to the nearest .01 mm) are given for general information
4 only and are based upon 1 inch = 25.4 mm.
5 Tolerance between any two adjacent contact centers shall be ± 0.004 (.10 mm).
6 Tolerance between any two contact centers, other than adjacent contacts,
7 shall be ± 0.006 (.16 mm).
8 Contact identification may be located on either side of the contact hole
9 but shall appear on the front and rear face of each insert.
10 For mating connector see connector, MS24029.
11 For design feature purposes, this standard takes precedence over procurement
documents referenced herein
Referenced documents shall be of the issue in effect on date of invitation
for bid
For shield for use with this connector, see MS24132
At the option of the manufacturer, a land, boss, or pad of 0.010 inch
maximum may be added to the mating face of the molding for protection of
raised letters where used
Group A and B inspection is required in lieu of qualification.

D

REDRAWN

PA NAVY-EC	International interest	TITLE CONNECTOR, RECTANGULAR,	MILITARY STANDARD
Other Cust AF-80 ARMY-EL		ELECTRICAL, RACK AND PANEL, 10, SIZE 16 PIN CONTACTS	MS24030
Procurement Specification MIL-C-28748		SUPERSEDES	SHEET OF

DD FORM 672
10 APR 64

(Coordinated) PREVIOUS EDITIONS OF THIS FORM ARE OBSOLETE

5935-1722-6