

Army - MC  
Navy - MC  
USAF -

User activities:  
Navy - EC  
USAF - 11, 17, 99

Review activities:  
Navy - EC  
USAF - 11, 17, 99

This military standard is approved by the Department of the Air Force and the Naval Air Systems Command and is mandatory for use by these activities. All other military activities are required to employ this standard where suitable.

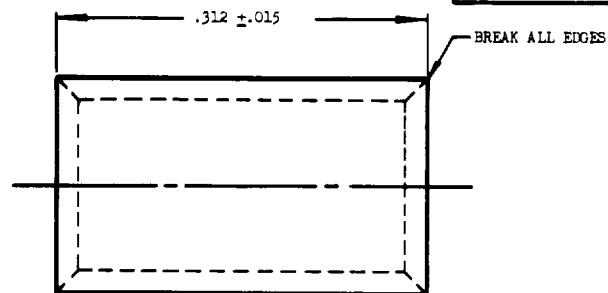
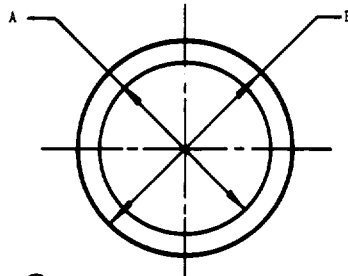

FED. SUP CLASS  
5940

DASH NO.	COLOR CODE	A DIA		B DIA	
		MIN	MAX	MIN	MAX
-046	NO COLOR	.043	.049	.067	.073
-058	YELLOW	.055	.061	.080	.086
-063	RED	.060	.066	.085	.091
-071	GREEN	.068	.074	.093	.099
-080	BLUE	.077	.083	.101	.107
-090	ORANGE	.087	.093	.111	.117
-096	PURPLE	.093	.099	.116	.122
-101	YELLOW	.098	.104	.121	.127
-109	RED	.106	.112	.128	.134
-115	NO COLOR	.112	.118	.143	.149
-124	GREEN	.121	.127	.142	.148
-128	NO COLOR	.125	.131	.149	.155
-134	ORANGE	.131	.137	.153	.159
-149	BLUE	.146	.152	.176	.182
-156	RED	.153	.159	.189	.195
-165	NO COLOR	.162	.168	.191	.197
-175	GREEN	.172	.178	.212	.218
-187	YELLOW	.184	.190	.224	.230
-194	BLUE	.191	.197	.222	.229
-205	ORANGE	.202	.208	.242	.248
-219	NO COLOR	.216	.222	.240	.253
-225	YELLOW	.222	.228	.253	.259
-232	RED	.229	.235	.260	.266
-250	GREEN	.247	.253	.278	.284
-261	BLUE	.258	.264	.294	.300
-266	NO COLOR	.263	.269	.294	.300
-275	ORANGE	.272	.278	.303	.309
-281	YELLOW	.278	.284	.328	.334
-287	NO COLOR	.284	.290	.324	.330
-297	RED	.294	.300	.332	.338
-312	PURPLE	.309	.315	.359	.365
-348	ORANGE	.345	.351	.397	.403
-375	BLUE	.372	.378	.403	.409

MATERIAL: BRASS ALLOY, ROCKWELL B61 to B90.

FINISH: TIN PLATED, PER MIL-T-10727, TYPE 1. COLOR CODE IN ACCORDANCE WITH TABLE.

- NOTES: (D) 1. MS18121 OUTER FERRULES ARE USED WITH MS21981 INNER FERRULES AS AN INSULATED REPLACEMENT. MS21980 OUTER FERRULES ARE USED WITH MS21981 INNER FERRULE AS AN UNINSULATED REPLACEMENT.
2. REMOVE ALL BURRS AND SHARP EDGES. CHAMFER OR ROUNDED EDGES ACCEPTED.
3. DIMENSIONS IN INCHES.
- (D) 4. METRIC EQUIVALENTS (TO THE NEAREST .01 mm) ARE GIVEN FOR GENERAL INFORMATION ONLY AND ARE BASED UPON 1 INCH = 25.4 mm.

(D) REVISED FOR DESIGN FEATURE PURPOSES, THIS STANDARD TAKES PRECEDENCE OVER ACQUISITION DOCUMENTS REFERENCED HEREIN. REFERENCED DOCUMENTS SHALL BE OF THE ISSUE IN EFFECT ON DATE OF INVITATIONS FOR BID.

SUPERSEDED MS25311 ONE-PIECE FERRULE DASH NO.	REPLACED BY TWO-PIECE COMBINATION (REF)	
	MS21981 INNER FERRULE DASH NO.	MS21980 OUTER FERRULE DASH NO.
-90	-058	-128, -149, -156
-100	-063	-156, -175
-110	-080	-156, -175, -187
-120	-101	-187, -194, -199
-130	-115	-199, -205, -219
-150	-134	-225, -232, -261
-160	-156	-232, -261, -275
-180	-175, -187	-287, -297
-200	-205, -219	-312, -327, -348

UNINSULATED TWO-PIECE COMBINATION (REF)	
MS21981 INNER FERRULE DASH NO.	MS21980 OUTER FERRULE DASH NO.
-058	-128, -149, -156
-063	-156, -175
-080	-156, -175, -187
-101	-187, -194, -199
-115	-199, -205, -219
-134	-225, -232, -261
-156	-232, -261, -275
-175, -187	-287, -297
-205, -219	-312, -327, -348

P.A. NAVY - AS	TITLE FERRULE, INNER, UNINSULATED, SHIELD TERMINATING, TYPE I TWO-PIECE, CLASS I, FOR SHIELDED CABLE	MILITARY STANDARD MS21981
Other Code USAF - 85		
ACQUISITION SPECIFICATION MIL-F-21608	SUPERSEDES:	SHEET 1 OF 2

DD FORM 672-1 (Limited coordination)  
ASG use only

PREVIOUS EDITIONS OF THIS FORM ARE OBSOLETE. U. S. GOVERNMENT PRINTING OFFICE: 1985-341-512/A-1000

Project No. 5940-0944

APPROVED 12 Oct 64 REVISED 20 Jan 65 1 Jul 65 16 SEP 68 13 Aug 82

FED. SUP CLASS  
5940

(D)

USER SYMBOLS:  
Army - MC  
Navy - 11, 17, 99  
USAF -

REVIEWER SYMBOLS:  
Navy - EC  
USAF - 11, 17, 99

"Review/User information is current as of the date of this document.  
For future coordination of changes to this document, draft circulation  
should be based on the information in the current DODISS."

This military standard is approved for use by all Departments  
& Agencies of the Department of Defense. Selection for all new  
engineering and design applications and for repetitive use shall  
be made from this document.

INCHES	mm	INCHES	mm
.043	1.09	.169	4.80
.049	1.24	.190	4.83
.055	1.40	.191	4.85
.060	1.52	.195	4.95
.061	1.55	.197	5.00
.066	1.68	.202	5.13
.067	1.70	.208	5.20
.068	1.73	.212	5.38
.073	1.85	.216	5.49
.074	1.88	.218	5.54
.077	1.96	.222	5.64
.080	2.03	.224	5.69
.083	2.11	.228	5.79
.085	2.16	.229	5.82
.086	2.18	.230	5.84
.087	2.21	.235	5.97
.091	2.31	.240	6.10
.093	2.36	.242	6.15
.098	2.49	.247	6.27
.099	2.51	.248	6.30
.101	2.57	.253	6.43
.104	2.64	.258	6.55
.106	2.69	.259	6.58
.107	2.72	.260	6.60
.111	2.82	.263	6.68
.112	2.84	.264	6.71
.116	2.95	.266	6.76
.117	2.97	.269	6.83
.118	3.00	.272	6.91
.121	3.07	.278	7.06
.122	3.10	.284	7.21
.125	3.18	.290	7.37
.127	3.23	.294	7.47
.128	3.25	.300	7.62
.131	3.33	.303	7.70
.134	3.40	.309	7.85
.137	3.48	.315	8.00
.142	3.61	.324	8.23
.143	3.63	.328	8.33
.146	3.71	.330	8.38
.146	3.76	.332	8.43
.149	3.78	.334	8.48
.152	3.86	.336	8.59
.153	3.89	.345	8.76
.155	3.94	.351	8.92
.159	4.04	.359	9.12
.162	4.11	.365	9.27
.168	4.27	.372	9.45
.172	4.37	.376	9.60
.176	4.47	.397	10.08
.178	4.52	.403	10.24
.182	4.62	.409	10.39
.184	4.67		

P.A.  
NAVY - AS  
Other Cust  
USAF - 85

## TITLE

FERRULE, INNER, UNINSULATED, SHIELD TERMINATING  
TYPE I, TWO-PIECE, CLASS I, FOR SHIELDED CABLE

## MILITARY STANDARD

MS21981

PROCUREMENT SPECIFICATION  
MIL-F-21608

## SUPERSEDES:

SHEET 2 OF 2

DD FORM 672-1 (Coordinated)

PREVIOUS EDITIONS OF THIS FORM ARE OBSOLETE.

PLATE NO. 52080

APPROVED 12 Oct 64 REVIEWED (D) FOR CHANGES SEE SHEETS 1 AND 2