

**INCH-POUND**

MS21255T  
 20 November 2002  
 SUPERSEDING  
 MS212155R  
 5 November 2001

# DETAIL SPECIFICATION SHEET

## EYE END, TURNBUCKLE, CLIP LOCKING (FOR WIRE ROPE)

This specification is approved for use by all Departments and Agencies of the Department of Defense.

The requirements for acquiring the product described herein shall consist of this specification sheet and the issue of MIL-DTL-8878 and QPL-8878 listed in that issue of the Department of Defense Index of Specifications and Standards (DoDISS) specified in the solicitation.

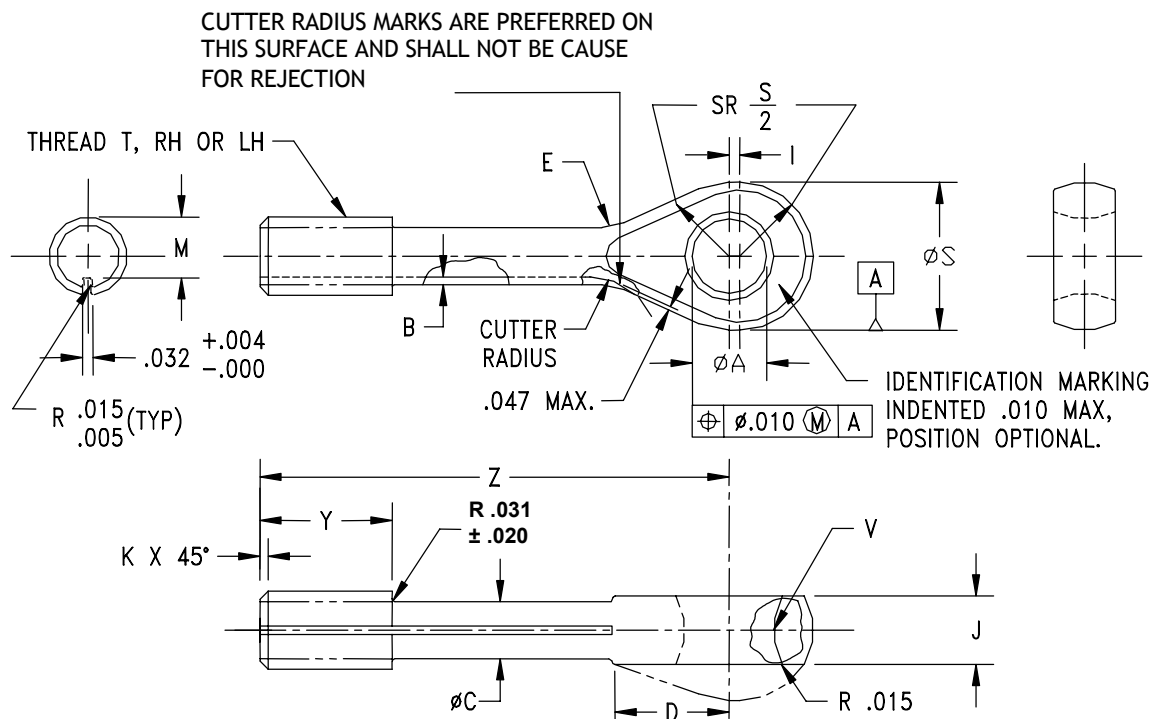

FIGURE 1. Eye end, turnbuckle, clip locking (for wire rope).

## MS21255T

TABLE I. Dash numbers and dimensions.

Dash number		Wire rope diameter		Minimum breaking strength lbs.	Thread T UNF-3A	ØA +0.010 -0.000	B	ØC +0.006 -0.000	D ±0.031
Direction of thread							Maximum		
RH	LH	Nominal reference	Minimum						
-2RS	-2LS	1/16	0.062	800	0.1380 (#-6)-40	0.188	0.0096	0.094	0.325
-2RL	-2LL								
-3RS	-3LS	3/32	0.093	1,600	0.1900 (#10)-32	0.219	0.0077	0.133	0.416
-3RL	-3LL								
-5RS	-5LS	5/32 1/	0.156	3,200	0.2500(1/4)-28	0.281	0.0103	0.189	0.512
-5RL	-5LL								
-6RS	-6LS	3/16	0.187	4,600	0.3125 (5/16)-24	0.313	0.0064	0.243	0.527
-6RL	-6LL								
-8RL	-8LL	1/4	0.250	8,000	0.3750 (3/8)-24	0.375	0.0057	0.306	0.678
-9RL	-9LL	9/32	0.281	12,500	0.4375 (7/16)-20	0.469	0.0056	0.362	0.831
-10RL	-10LL	5/16	0.312	17,500	0.5000 (1/2)-20	0.563	0.0058	0.425	0.900

1/ See note 7.

TABLE I. Dash numbers and dimensions - Continued.

Dash number		E	I	J	K	M		$\varnothing S$	V	Y	Z
Direction of thread		$\pm 0.031$ radius	+0.010 -0.000	$\pm 0.005$	+0.000 -0.015	Maximum	Minimum	+0.025 -0.010	$\pm 0.016$ radius	$\pm 0.047$ 2/	+0.031 -0.015
RH	LH										
-2RS	-2LS	0.125	0.031	0.125	0.031	0.1139	0.1094	0.375	0.094	0.375	1.500
-2RL	-2LL										2.375
-3RS	-3LS	0.156	0.047	0.188	0.047	0.1638	0.1568	0.500	0.172	0.500	1.625
-3RL	-3LL										2.500
-5RS	-5LS	0.219	0.078	0.219	0.078	0.2224	0.2152	0.625	0.203	0.625	1.750
-5RL	-5LL										2.625
-6RS	-6LS	0.250	0.063	0.281	0.063	0.2830	0.2754	0.688	0.250	0.750	1.875
-6RL	-6LL										2.750
-8RL	-8LL	0.281	0.078	0.328	0.078	0.3454	0.3378	0.875	0.375	0.875	2.875
-9RL	-9LL	0.359		0.375		0.4052	0.3972	1.063	0.453	1.000	3.375
-10RL	-10LL	0.406		0.469		0.4678	0.4597	1.188	0.500		3.625

2/ Includes last full thread engagement.

## REQUIREMENTS:

1. Material: Material shall be in accordance with MIL-DTL-8878.
2. Protective treatment: Protective treatment shall be in accordance with MIL-DTL-8878.
3. Heat treatment: Heat treatment shall be in accordance with MIL-DTL-8878.
4. Finish: Finish shall be in accordance with MIL-DTL-8878.
5. Threads: Threads shall be in accordance with FED-STD-H28/20.
6. Outside diameter (O.D.): O.D. of the "I" dimension may be a flat area.
7. Tolerances: Unless otherwise specified, tolerances: decimals  $\pm 0.010$ , angles  $\pm 0.5^\circ$ .

## MS21255T

## NOTES:

1. The part or identifying number (PIN) consists of the letters MS, the specification sheet number, and a dash number taken from table I. A "C" in lieu of dash indicates 17-4PH; a dash indicates carbon or alloy steel. The first letter following the dash number or letter C indicates direction of thread (left or right hand) and the second letter indicates length (short or long).

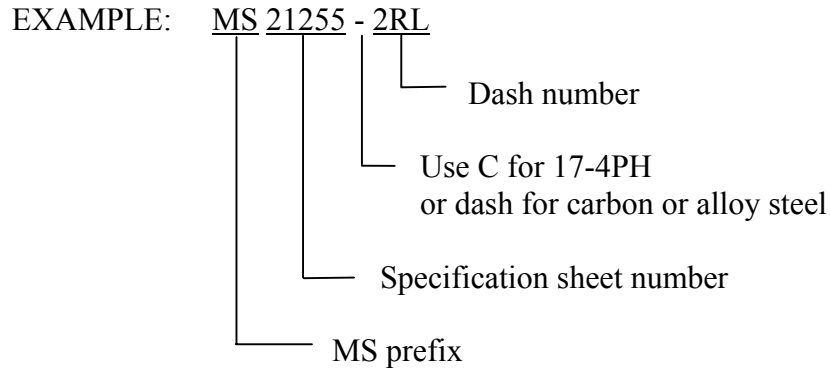

MS21255C2LS Indicates - Eye, turnbuckle, 17-4PH, 0.1380 (#6)-40, left hand thread, short.

MS21255-2RL Indicates - Eye, turnbuckle, steel, 0.1380 (#6)-40, right hand thread, long.

2. Dimensions are in inches.
3. Remove burrs and sharp edges. (See MIL-DTL-8878.)
4. Interpret drawing in accordance with ASME Y14.5M.
5. In the event of a conflict between the text of this document and the references cited herein, the text of this document takes precedence.
6. Unless otherwise specified, issues of referenced documents are those in effect at the time of solicitation.
7. For 0.125 (1/8) inch diameter wire rope use -5 parts, minimum breaking strength 2,200 pounds (lbs.) (reference).
8. Steel, carbon and alloy eye end turnbuckles are inactive for new design. 17-4PH stainless steel eye end turnbuckles shall be used for new design and can be used to replace comparable steel parts.
9. For clip locking of turnbuckles, see MS33736 and MIL-DTL-8878.
10. The parts covered by dash numbers shown on AN170 are canceled after 25 November 1963. Use the dash numbers given in table I. The canceled parts cannot replace the new parts and should be used until existing stock is depleted. Use only the MS21255 parts for new design and substitution. Substitution shall be in accordance with table II.

## MS21255T

TABLE II. Substitution table.

PART NUMBERS	
Canceled part AN170	New part MS21255
Dash number	Dash number
5	None
8	2
16	3
22	5
32	5
46	6
61	8
80	8
125	9
175	10

CHANGES FROM PREVIOUS ISSUE: The margins of this specification sheet are marked with asterisks to indicate where changes from the previous issue were made. This was done as a convenience only and the Government assumes no liability whatsoever for any inaccuracies in these notations. Bidders and contractors are cautioned to evaluate the requirements of this document based on the entire content irrespective of the marginal notations and relationship to the previous issue.

## Custodians:

Army - AV

Navy - AS

Air Force - 99

## Preparing Activity:

DLA - GS5

(Project 1560-0023)

## Review Activity:

Air Force - 71