

FED SUPCLASS
5311USER SYMBOLS
ARMY - GL
NAVY - OS,SHREVIEWER SYMBOLS
ARMY - M, ER, A, V, AT
USAF - 11, 82

Review/spec information is current as of the date of this document.
For future coordination of changes to this document, draft circulation
should be based on the information in the current DODDS.

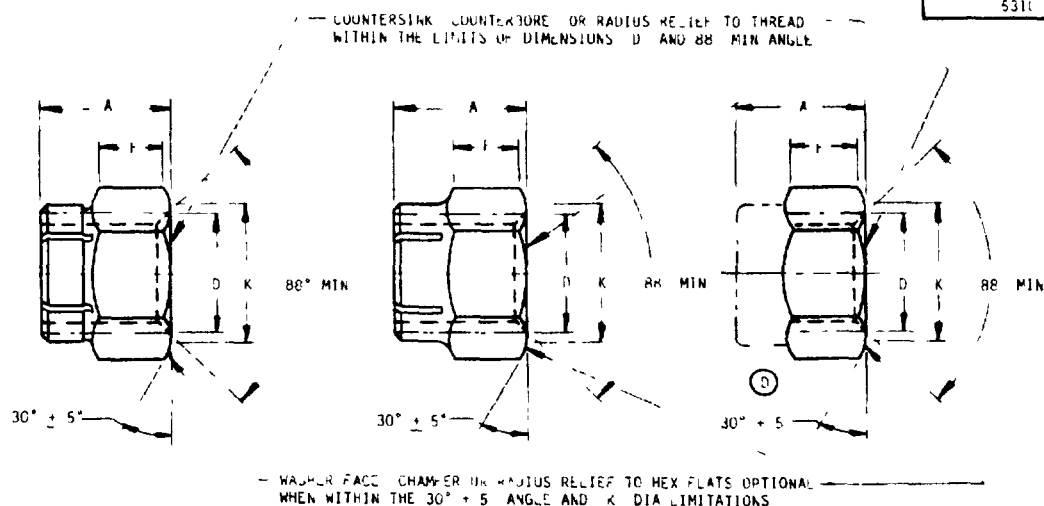

(D)

STYLE A

STYLE B

ELLIPTICAL LOCK

EITHER STYLE A OR B TO BE SUPPLIED AT MANUFACTURER'S OPTION

SEGMENTED BEAM LOCK

NOTE

CONFIGURATION OF NUT OPTIONAL
LIMITATIONS IMPOSED ONLY ON
DIMENSIONS AND REQUIREMENTS
SPECIFIED HEREIN. SEE EXAMPLE
OF PART NUMBERS.

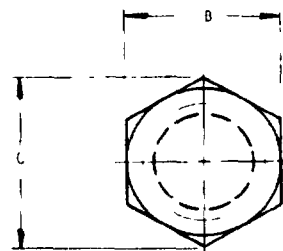

TYPICAL END VIEW

DASH NOS	(a) THREAD MIL S-8879	(c)		B	C	D DIA ± 0.02	F	X	AXIAL STRENGTH BS MIN	WEIGHT LBS/100 REF	K DIA MIN
		MAX	MIN	MAX	MIN						
C04	1120-40UNJC-3B	157	133	251	243	268	136	004	750	15	223
C06	1380-32UNJC-3B	188	160	313	305	339	161	072	1,130	30	285
C08	1640-32UNJC-3B	250	219	345	336	374	188	091	1,720	50	316
C3	1900-32UNJF-3B	250	208	376	367	410	210	085	2,460	58	347
C4	2500-28UNJF-3B	328	240	439	430	482	273	116	4,580	99	410
C5	3125-24UNJF-3B	360	271	502	492	552	336	123	7,390	140	472
C6	3750-24UNJF-3B	469	318	564	553	622	398	153	11,450	215	533
C7	4375-20UNJF-3B	469	435	690	679	766	467	178	15,450	340	659
C8	5000-20UNJF-3B	610	575	752	741	837	531	221	21,110	470	721
C9	5625-18UNJF-3B	704	623	877	865	978	594	243	26,810	780	865
C10	6250-18UNJF-3B	766	732	940	928	1,051	656	274	34,130	950	908
C12	7500-16UNJF-3B	891	855	1,064	1,052	1,191	767	316	50,020	1360	1,032
C14	8750-14UNJF-3B	1,016	965	1,252	1,239	1,403	918	370	68,440	2100	1,219
C16	10000-12UNJF-3B	1,141	1,010	1,440	1,427	1,615	1,044	435	92,180	3100	1,427
C18	11250-12UNJF-3B	1,266	1,130	1,627	1,614	1,826	1,171	510	116,700	4600	1,594
C20	12500-12UNJF-3B	1,454	1,300	1,814	1,801	2,038	1,295	595	147,940	6500	1,781

(a) THREADS IN ACCORDANCE WITH MIL-S-8879

(b) BEARING SURFACE (DIA K) SHALL BE SQUARE WITH PITCH DIAMETER WITHIN X WHEN MEASURED IN ACCORDANCE WITH MIL-N-2502

(c) DIMENSIONS ACROSS FLATS MAY INCLUDE DEFORMATION OF SELF-LOCKING DEVICE

(D) DENOTES HANGERS

P A NAVY - AS Other Cust ARMY - AR USAF - 99	TITLE NUT SELF LOCKING, HEXAGON REGULAR HEIGHT R00 F 125 KSI FEM	MILITARY STANDARD	
		MS21046	
PROCUREMENT SPECIFICATION MIL-N-25027	SUPERSEDES IN PART ANJ61 AND NAS1021 (SEE STATUS NOTE)	SHEET	OF
		1	2

DD FORM
1 MAR 72 672-1 (Coordinated)

PREVIOUS EDITIONS OF THIS FORM ARE OBSOLETE

PROJECT NO 5310-1473

DISTRIBUTION STATEMENT A. APPROVED FOR PUBLIC RELEASE. DISTRIBUTION IS UNLIMITED.

This military standard is approved for use by all Departments
& Agencies of the Department of Defense. Selection for all new
engineering and design applications and for repetitive use shall
be made from this document.

AMSC N/A

APPROVED 23 AUG 61
REVISED A 11 SEP 62 B 1 APR 65 C 27 SEP 85 D 9 JAN 1987

FED SUPCLASS
5310

- ⑦ MATERIALS CORROSION RESISTANT STEEL TYPE 303 (UNS S30300) PER ASTM A194
CORROSION RESISTANT STEEL TYPE XM-7 (UNS S30430) PER ASTM A493
CORROSION RESISTANT STEEL TYPE 905 (UNS S66200) PER ASM 5640
CORROSION RESISTANT STEEL TYPE A286 (UNS S66286) PER ASTM A453
- PLATING SILVER PLATE ALL THREADED SURFACES ON NUT PER AM. 2410. THREADS SHALL SHOW COMPLETE COVERAGE. IF PLATING ON ALL OTHER SURFACES OPTIONAL. TARNISHING OR DISCOLORATION OF SILVER NOT CAUSE FOR REJECTION.
- ⑩ MAGNETIC PERMEABILITY IN ACCORDANCE WITH MIL-N 45027
- ⑨ BREAK ALL SHARP EDGES AND REMOVE ALL BURRS AND SLIVERS.
SURFACE ROUGHNESS IN ACCORDANCE WITH ANSI/ASME B46.1 THE SURFACE ROUGHNESS SHALL NOT EXCEED 1/4 MIL ROUNDED DIMENSIONS IN INCHES.
- ⑩ AN ADDITIONAL DASH 5 CODE INDICATES SEGMENTED BEAM LOCK AND - DASH 000 INDICATES ELLIPTICAL BEAM LOCK
- ⑩ EXAMPLE OF PART NUMBERS
- MS21046L4 2500-28 CORROSION RESISTANT STEEL NUT SILVER PLATE SEGMENTED BEAM LOCK OR ELLIPTICAL LOCK
- MS21046L85 5000-20 CORROSION RESISTANT STEEL NUT SILVER PLATE SEGMENTED BEAM LOCK
- MS21046L25 4000-20 CORROSION RESISTANT STEEL NUT SILVER PLATE ELLIPTICAL LOCK
- ⑩ DESIGN AND USAGE LIMITATIONS THESE NUTS ARE DESIGNED TO DEVELOP THE TENSILE STRENGTH OF BOLT AND SCREWS WITH AN ULTIMATE STRESS (F_{tu}) OF 125 KSI BASED ON THE GROSS SECTIONAL AREA AT THE BASIC ROOT DIAMETER OF THE THREAD. THESE NUTS ARE DESIGNED TO BE USED ON SA EXTERNAL THREADS. THESE NUTS SHALL BE USED IN ACCORDANCE WITH THE LIMITATIONS OF MS33588
- ⑩ INTERCHANGEABILITY RELATIONSHIP (STATUS NOTE) MS21046 NUTS CAN REPLACE ALL AN315 AND NAS1021 NUTS OF LIKE MATERIAL, PLATING AND THREAD SIZE.
ALL AN365 AND NAS1021 NUTS CAN NOT REPLACE MS21046 NUTS.

INTERCHANGEABILITY TABLE

SEC INTERCHANGEABILITY RELATIONSHIP STATUS: 01

CANCELLED PART NUMBER		SUBSTITUTIVE PART NUMBER	CANCELLED PART NUMBER		SUBSTITUTIVE PART NUMBER
AN363	NAS1021	MS21046	AN363	NAS1021	MS21046
	C04	C04	CR 1		NO REPLACEMENT
C632	C06	C06	CR20	C8	C8
C632	C08	C08	CR21		NO REPLACEMENT
C1024		NO REPLACEMENT	CR28	C9	C9
C1032	C3	C3	CR101		NO REPLACEMENT
C420		NO REPLACEMENT	CR101A	C10	C10
C426	C4	C4	CR210		NO REPLACEMENT
C519		NO REPLACEMENT	CR216	C12	C12
C524	C5	C5		C14	C14
C616		NO REPLACEMENT		C16	C16
C624	C6	C6		C17	NO REPLACEMENT
C714		NO REPLACEMENT		C18	C18
C720		NO REPLACEMENT		C20	C20
	C7	C7			

BIDS SHALL BE SOLICITED ONLY FROM THE MANUFACTURERS LISTED ON OPL-25027

- (C) IN THE EVENT OF A CONFLICT BETWEEN THE TEXT OF THIS STANDARD AND THE REFERENCES CITED HEREIN THE TEXT OF THIS STANDARD SHALL TAKE PRECEDENCE
- (D) REFERENCED GOVERNMENT (OR NON GOVERNMENT) DOCUMENTS OF THE ISSUE LISTED IN THAT ISSUE OF THE DEPARTMENT OF DEFENSE INDEX OF SPECIFICATIONS AND STANDARDS (DoDISS) SPECIFIED IN THE SOLICITATION FORM A PART OF THIS STANDARD TO THE EXTENT SPECIFIED HEREIN

REVISED (D) FOR CHANGES SEE SHEETS 1 AND 2

APPROVED 23 AUG 61

PA NAVY — AS Other Cust ARMY — AR USAF — 99	TITLE NUT, SELF-LOCKING, HEXAGON-REGULAR HEIGHT, 800°F 125 KSI Ftu	MILITARY STANDARD
		MS21046
PROCUREMENT SPECIFICATION MIL-N-251022	SUPERSEDES IN PART AN 101 AND NAS1021 (SEE STATUS NOTE)	SHEET OF