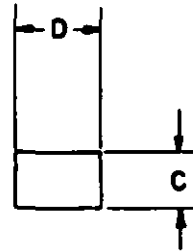
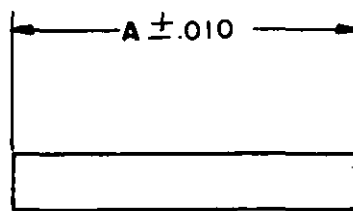

FED. SUP CLASS
5315

REVIEWER: IS, WP, 69, WC, MO
USER : MC, SH, MU, YD, NSA

NOMINAL SIZE		7/16 X 5/16		1/2 X 5/16		9/16 X 3/8	
C	MAX.	.3135		.3135		.3760	
	MIN..	.3120		.3120		.3745	
D	MAX.	.4385		.5010		.5635	
	MIN.	.4370		.4995		.5620	
LENGTH A		DASH NUMBER		DASH NUMBER		DASH NUMBER	
		GRADE B	GRADE C	GRADE B	GRADE C	GRADE B	GRADE C
1		1	26	51	76	101	126
1 1/8		2	27	52	77	102	127
1 1/4		3	28	53	78	103	128
1 3/8		4	29	54	79	104	129
1 1/2		5	30	55	80	105	130
1 5/8		6	31	56	81	106	131
1 3/4		7	32	57	82	107	132
1 7/8		8	33	58	83	108	133
2		9	34	59	84	109	134
2 1/8		10	35	60	85	110	135
2 1/4		11	36	61	86	111	136
2 3/8		12	37	62	87	112	137
2 1/2		13	38	63	88	113	138
2 5/8		14	39	64	89	114	139
2 3/4		15	40	65	90	115	140
2 7/8		16	41	66	91	116	141
3		17	42	67	92	117	142
3 1/4		18	43	68	93	118	143
3 1/2		19	44	69	94	119	144
3 3/4		20	45	70	95	120	145
4		21	46	71	96	121	146
4 1/4		22	47	72	97	122	147
4 1/2		23	48	73	98	123	148
4 3/4		24	49	74	99	124	149
5		25	50	75	100	125	150

- Ⓐ **MATERIAL:** Alloy steel, Grade B, in accordance with procurement specification.
Carbon steel, Grade C, in accordance with procurement specification.
- Ⓐ **SHEAR STRENGTH (MIN.):** Shear strength for grades B and C materials shall conform to the procurement specification.
- Ⓐ **HARDNESS:** Grade B keys shall be hardened in accordance with procurement specification.
- PROTECTIVE COATING:** Uncoated.
- DIMENSIONS:** All dimensions are in inches unless otherwise specified.
- PART NUMBER:** The MS part number consists of the MS number plus the dash number. Example: MS20065-1.
- NOTES:**
- (1) Edges and corners shall be rounded (.010-.020 Rad.).
 - (2) The keys covered on this standard correspond to Type III of the procurement specification.
 - (3) For design feature purposes, this standard takes precedence over procurement documents referenced herein.
 - (4) Referenced documents shall be of the issue in effect on date of invitations for bid.
- Ⓐ FIIN columns removed.

P.A. WC Other Cost WP 69	TITLE KEY, MACHINE-RECTANGULAR IN CROSS SECTION, BOTH ENDS SQUARE	MILITARY STANDARD MS 20065
PROCUREMENT SPECIFICATION 00-K-220	SUPERSEDES:	SHEET 1 OF 1