

FED. SUP CLASS
5935

User activities Army - ME, AM, AR
 Navy - MC, SH, OS, YD
 Air Force -
 Review activities Army - MI, AT
 Navy - AS
 Air Force - II, 99
 DLA-ES

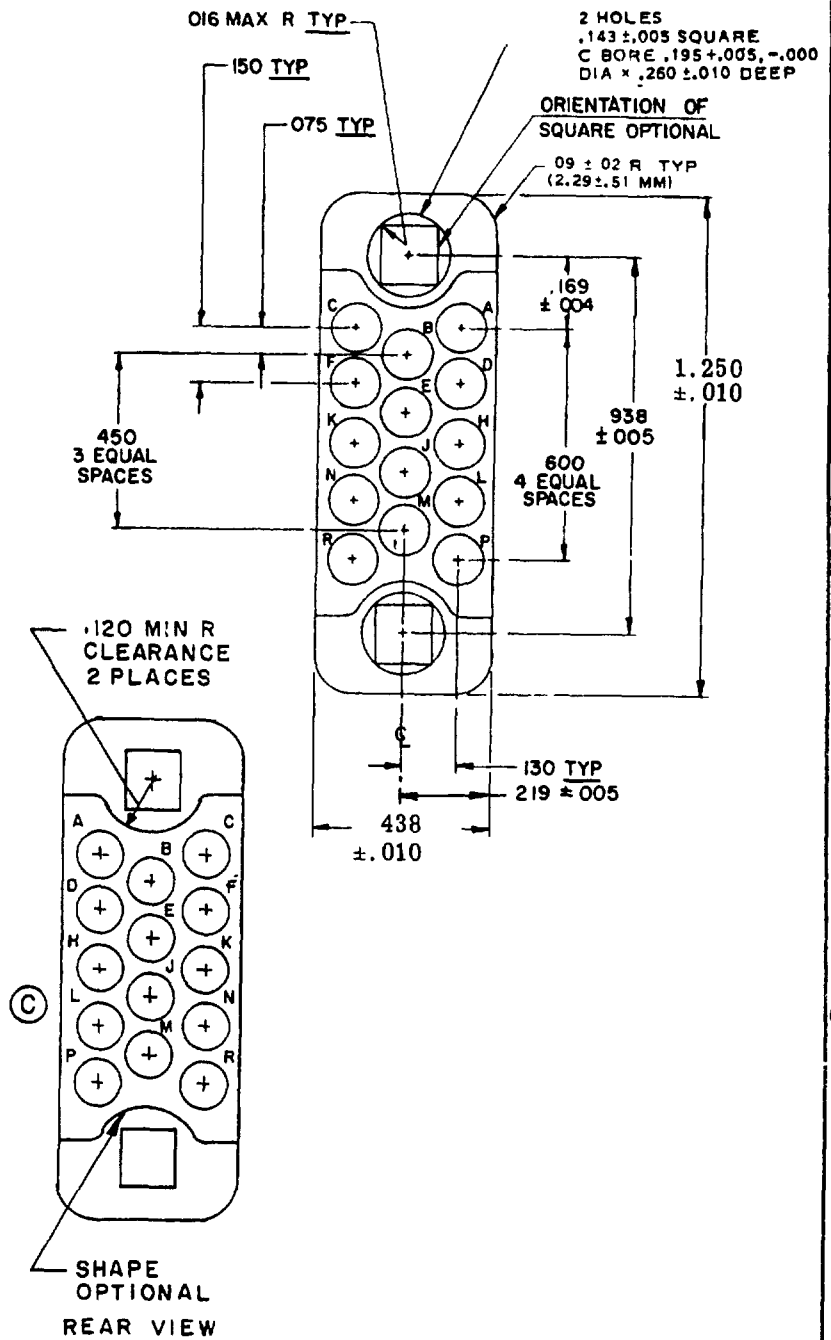
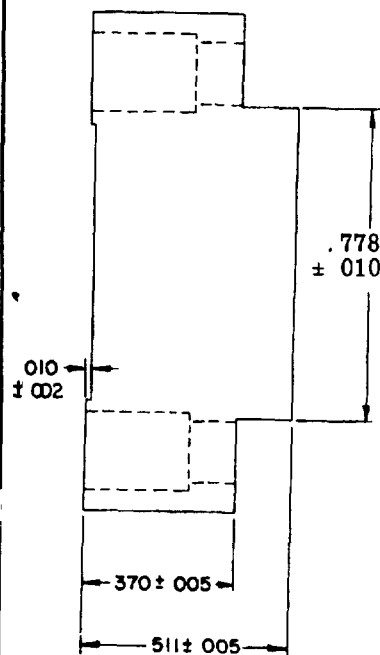

MS Part No. MS18174-1

DESIGN STANDARD FOR USE WITH MIL-C-28748/3.

© denotes changes

P A Navy - EC Other Cust AF-85 Army - CR	International Interest	TITLE Insert (insulator) rectangular connector, electrical, 14 (size 16 and 20 crimp removable) pin contacts	MILITARY STANDARD MS 18174
Procurement Specification MIL-C-28748	SUPERSEDES	PAGE 1 OF 2	

DD FORM 1 MAY 73 672 (Coordinated) PREVIOUS EDITIONS OF THIS FORM ARE OBSOLETE

5935-3223-4

This military standard is approved for use by all Departments and Agencies of the Department of Defense. Selection for all new engineering and design applications and for repetitive use shall be made from this document when applicable.

APPROVED 20 Dec. 1965
 REVISED 20 May 1970 © 23 June 1972 © 2 August 1982

FED SUP CLASS
5935

User activities
 Army - ME, AM, AR
 Navy - MC, SH, OS, YD
 Air Force -
 DLA-ES

Review activities
 Army - MI, AT
 Navy - AS
 Air Force - I, 99
 DLA-ES

INCHES MM

.002	.05
.004	.10
.005	.13
.010	.25
.016	.41
.02	.51
.075	1.91
.09	2.29
.120	3.06
.130	3.30
.143	3.63
.150	3.81
.169	4.29
.195	4.95
.219	5.56
.260	6.60
.370	9.40
.438	11.13
.450	11.43
.51	12.95
.511	12.98
.600	15.24
.778	19.76
.938	23.83
1.250	31.75
2.290	58.17

NOTES:

1. Dimensions are in inches.
2. Unless otherwise specified, tolerance is $\pm .015$ (.38 mm).
3. Metric equivalents are given for general information only and are based upon 1 inch = 25.4 mm.
4. Tolerance between any two adjacent contact centers shall be $\pm .004$ (.10 mm). Tolerance between any two contact centers, other than adjacent contacts, shall be $\pm .006$ (.15 mm).
5. Contact identification may be located on either side of the contact hole but shall appear on the front and rear of each insert.
6. For design feature purposes, this standard takes precedence over procurement documents referenced herein.
7. Referenced documents shall be of the issue in effect on date of invitation for bid.
8. Designed for use with MIL-C-39029/34 contacts.
9. Contact hole details shall be in accordance with MIL-C-28748.
10. The maximum insertion and withdrawal force (connector assembly) shall be 17.5 pounds.
11. Insert material shall be in accordance with MIL-C-28748.

REVISED (A) 20 May 1970 (B) 23 June 1972 (C) 2 August 1982

APPROVED 20 Dec. 1965

P.A Navy-EC Other Cust AF-85 Army- CR	International Interest	TITLE Insert (insulator) rectangular connector, electrical, 14 (size 16 and 20 crimp removable) pin contacts	MILITARY STANDARD MS18174
Procurement Specification MIL-C-28748		SUPERSEDES	PAGE 2 OF 2

DD FORM 1 MAY 73 672 (Coordinated) PREVIOUS EDITIONS OF THIS FORM ARE OBSOLETE

5935-3223-4

This military standard is approved for use by all Departments and Agencies of the Department of Defense. Selection for all new engineering and design applications and for repetitive use shall be made from this document when applicable.