

FED SUP CLASS
6210

NOTICE.—When Government drawings, specifications, or other data are used for any purpose other than in connection with a definitely related Government procurement operation, the United States Government thereby incurs no responsibility, nor any obligation whatsoever; and the fact that the Government may have formulated, furnished, or in any way supplied the said drawings, specifications, or other data is not to be regarded by implication or otherwise as in any manner licensing the holder or any other person or corporation, or conveying any rights or permission to manufacture, use, or sell any patented invention that may in any way be related thereto.

This standard has been approved by the BUREAU OF SHIPS Department of the NAVY and is mandatory for use by that activity. All other military activities are required to employ this standard where suitable.

SYMBOL 64.1

A

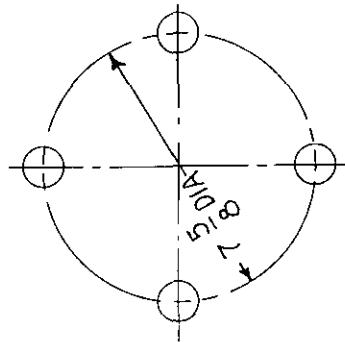
MOUNTING BOLTS
TO BE 3/8-16

CANCELED 23 MAY 1983.
MS PART NUMBERS MS17222-1 AND -2 ARE SUPERSEDED BY MIL-F-16377
SPECIFICATION SHEETS:
MS17222-1 USE MIL-F-16377/27-92.2
MS17222-2 USE MIL-F-16377/20-64.1

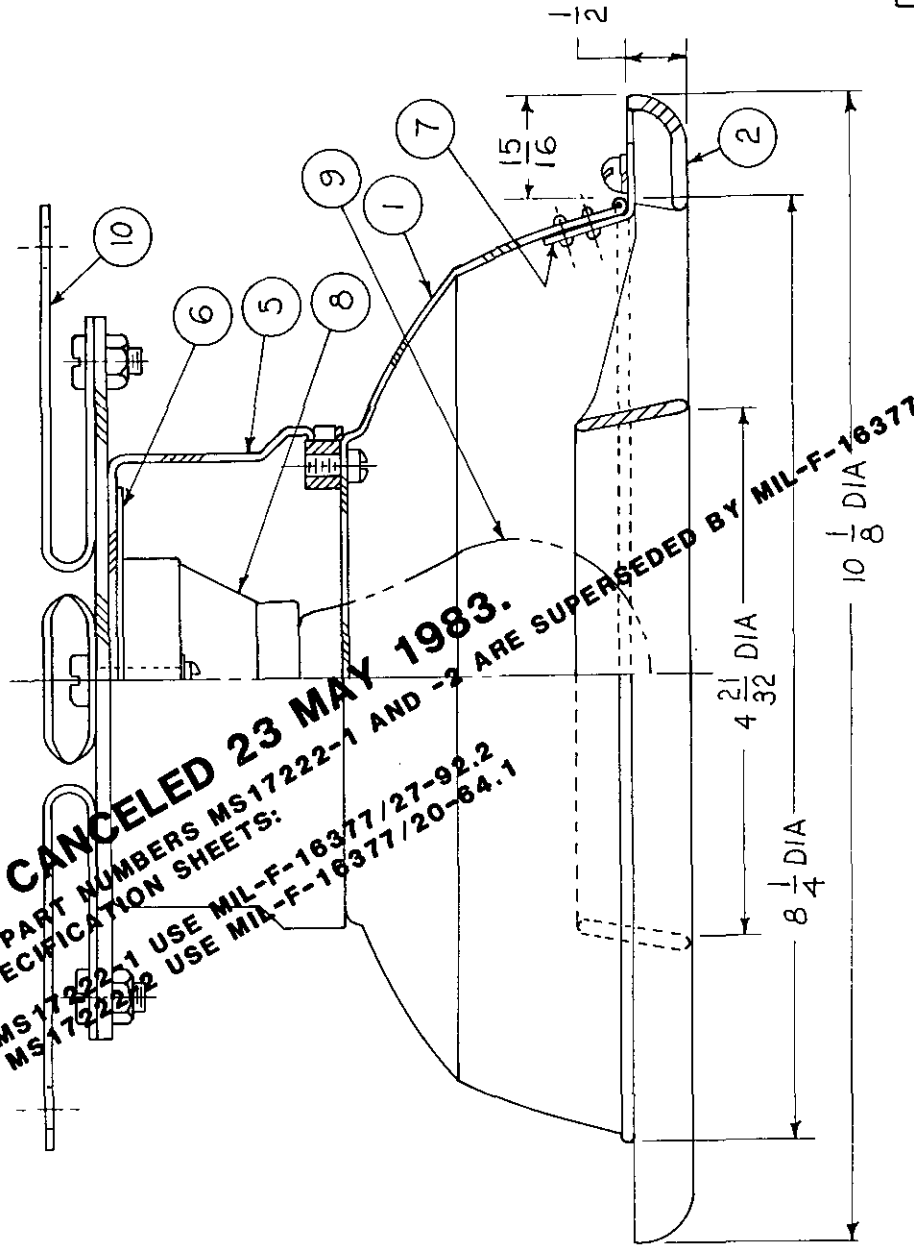

MS PART NO.	SYMBOL NUMBER
MS 17222-1	62.1 WITH GUARD
MS 17222-2	64.1 WITH REFLECTOR & BAFFLE

P.A. SHIPS Other Cust	TITLE LIGHTING FIXTURE- 50 WATT OVERHEAD	MILITARY STANDARD MS 17222(SHIPS)
PROCUREMENT SPECIFICATION MIL-F-16377	SUPERSEDES: 9000-S6401-73971	SHEET 1 OF 5

APPROVED 29 MAY 1963 REVISED (A) 23 MAY 1983