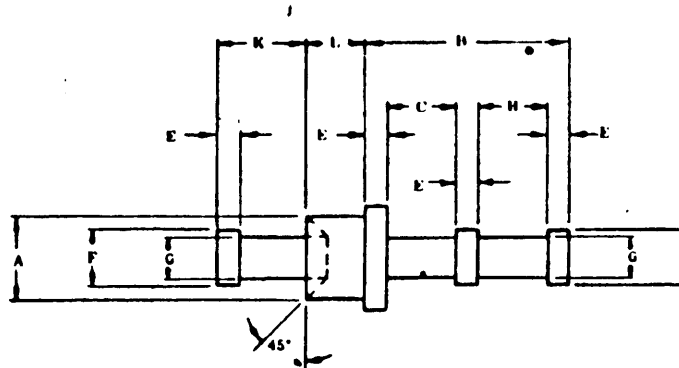
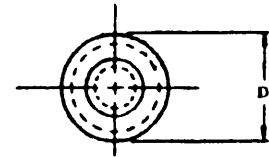

FED. SUP CLASS
59-40OPTIONAL CONSTRUCTION
OF TURRET ENDS

PART NUMBER	THK OF MOUNTING BOARD	A DIA. +.002	B HEIGHT +.015	C +.010	D DIA. +.006	E +.006	F +.005	G +.010	H +.010	K +.010	L +.005
MS17156 -1	1/32	.072	.188	.062	.093	.021	.050	.038	.062	.082	.054
MS17156 -2		.090	.210	.093	.125	.021	.062	.040	.062	.104	.062
MS17156 -3		.156	.344	.156	.187	.031	.093	.062	.093	.125	.075
MS17156 -4	1/16	.072	.188	.062	.093	.021	.050	.038	.062	.082	.054
MS17156 -5		.090	.210	.093	.125	.021	.062	.040	.062	.104	.093
MS17156 -6		.156	.344	.156	.187	.031	.093	.062	.093	.125	.105
MS17156 -7	3/32	.072	.188	.062	.093	.021	.050	.038	.062	.082	.115
MS17156 -8		.090	.210	.093	.125	.021	.062	.040	.062	.104	.125
MS17156 -9		.156	.344	.156	.187	.031	.093	.062	.093	.125	.135
MS17156 -10	1/8	.072	.188	.062	.093	.021	.050	.038	.062	.082	.147
MS17156 -11		.090	.210	.093	.125	.021	.062	.040	.062	.104	.156
MS17156 -12		.156	.344	.156	.187	.031	.093	.062	.093	.125	.165
MS17156 -13	5/32										.195
MS17156 -14	3/16										.230

MATERIAL: BRASS - QQ-B-626, COMP. 22, 1/2 HARD.

(A) FINISH: GOLD FLASH, MIL-G-45204, TYPE II, .000030 THK OVER SILVER PLATE, QQ-S-365, TYPE II, GRADE A, .0003 THK.

NOTES:

REMOVE BURRS AND SHARP EDGES.

TOLERANCES NOT ACCUMULATIVE.

DIMENSIONS IN INCHES.

THIS STANDARD TAKES PREFERENCE OVER DOCUMENTS REFERENCED HEREIN.

REFERENCED DOCUMENTS SHALL BE OF THE ISSUE IN EFFECT ON DATE OF INVITATION FOR BIDS.

This standard has been approved by the Bureau of Naval Weapons
Department of the Navy and is mandatory for use by
that activity. All other military activities are required
to employ this standard where suitable.

P.A. Wep Other Cost	TITLE TERMINAL STUD, FEEDTHRU, SINGLE - DOUBLE	MILITARY STANDARD MS17156 (Wep)
PROCUREMENT SPECIFICATION NINE	SUPERSEDES	SHEET 1 OF 1

DD FORM 672-1 (Limited coordination)

PREVIOUS EDITIONS OF THIS FORM ARE OBSOLETE

APPROVED 27 April 1960
REVISED (A) 6 March 1963