

NOTICE—When Government drawings, specifications, or other data are used for any purpose other than in connection with a definitely related Government procurement operation, the United States Government hereby accepts no responsibility, nor any obligation whatsoever; and the fact that the Government may have furnished, furnished, or in any way supplied the said drawings, specifications, or other data is not to be regarded by replication or otherwise as in any manner licensing the holder or any other person or corporation, or conveying any rights or permission to manufacture, use, or sell any patented invention that may in any way be related thereto.

This standard has been approved by the Bureau of Ships, Navy, and it is mandatory for use by all other activities are required to employ this standard where suitable.

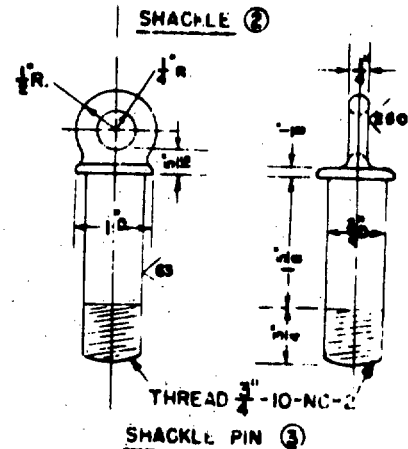
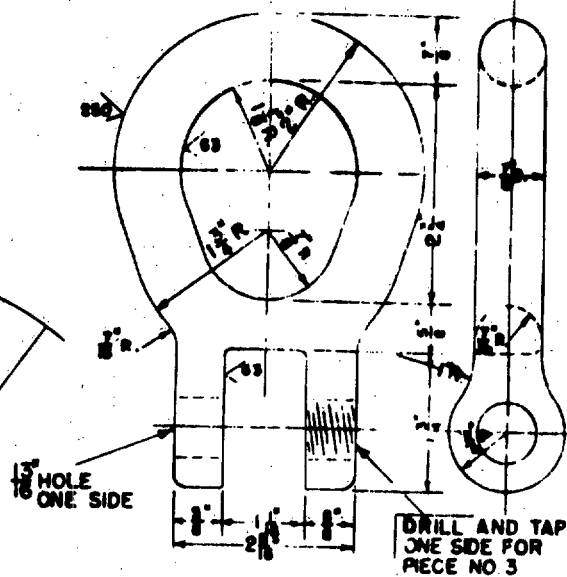
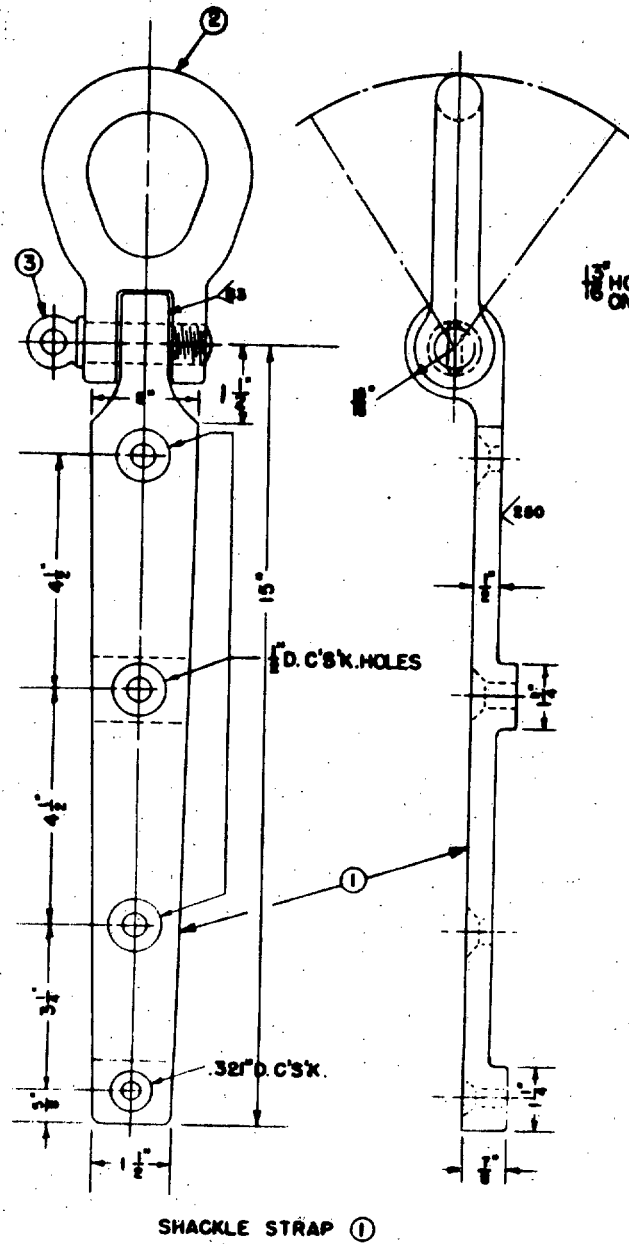

ENTIRE STANDARD REVISED

P.A. Ships Other Coast	TITLE SHACKLE; STRAP AND PIN—MOORING, MARINE HARDWARE	MILITARY STANDARD MS16833 (SHIPS)
PROCUREMENT SPECIFICATION NONE	SUPERSEDES:	SHEET 1 OF 2

DD FORM 672-1 N

LIMITED COORDINATION

PREVIOUS EDITIONS OF THIS FORM ARE OBSOLETE.

REF. SEC. 7 JUL 1959
NOV 1958

FED. SUP CLASS
2040

MS part number		FIN
MS16833-1	Shackle strap	369-4347
MS16833-2	Shackle	
MS16833-3	Shackle pin	377-6663

NOTES:

1. Shackle strap, shackle and pin to be commercial bronze having a tensile strength of not less than 30,000 pounds per square inch (p.s.i.).
2. Tolerances: plus or minus 1/16 inch on all dimensions except shackle pin which shall be $\pm 1/64$ inch tolerance.
3. Remove all sharp edges and burrs.
4. Used in running mooring line from boat to ship's boat boom.

NOTICE—When Government drawings, specifications, or other data are used for any purpose other than in connection with a definitely related Government procurement operation, the United States Government hereby incurs no responsibility, nor any obligation whatsoever; and the fact that the Government may have furnished, furnished, or is in any way supplying this and drawings, specifications, or other data is not to be regarded by implication or otherwise as in any manner licensing the holder or any other person in connection, or conveying any right or permission to manufacture, use, or sell any patented invention that may in any way be related thereto.

This standard has been issued by the Bureau of Ships, Department of the Navy, and is mandatory for use by all naval activities. All other military activities are required to supply this standard where suitable.

PA Ships Other Code	TITLE	MILITARY STANDARD
	SHACKLE; STRAP AND PIN—MOORING, MARINE HARDWARE	MS16833 (SHIPS)
PROCUREMENT SPECIFICATION	SUPersedes	SHEET 2 OF 2

DD FORM 672-1 N

LIMITED COORDINATION

PREVIOUS EDITIONS OF THIS FORM ARE OBSOLETE.

(Project 2040-00802)

APPROVED 5 NOV 1968 REVISED 7 JUL 1968