

User activities:
Navy - MC, SH

Review activities:
ARMY - AV, ME, MI
DLA - IS
NSA - NS

DISTRIBUTION STATEMENT A: Approved for public release; distribution is unlimited.
This military standard is approved for use by all Departments and Agencies of the Department of Defense. Selection for all new engineering and design applications and for repetitive use shall be made from this document, when applicable.

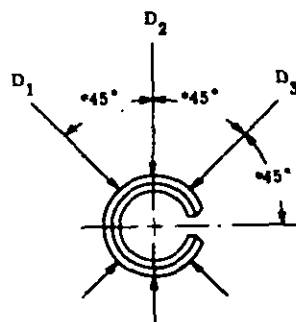

*APPROXIMATE
MIN AVERAGE DIA.

$$\frac{D_1 + D_2 + D_3}{3}$$

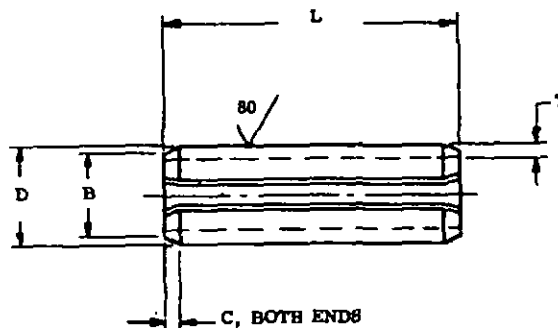

ALTERNATE
END DESIGN

TABLE I

NOM SIZE	D DIA		C CHAMFER		B CHAMFER DIA	T WALL THICKNESS NOM	DOUBLE SHEAR STRENGTH LBS-MIN	RECOMMENDED HOLE SIZE	
	MAX	MIN AVG	MAX	MIN	MAX			MAX	MIN
.062	.069	.066	.026	.007	.059	.012	425	.065	.062
.078	.086	.083	.033	.008	.075	.018	650	.081	.078
.094	.103	.099	.038	.008	.091	.022	1,000	.097	.094
.125	.135	.131	.044	.008	.122	.028	2,100	.129	.125
.156	.167	.162	.048	.010	.151	.032	3,000	.160	.156
.188	.199	.194	.055	.011	.182	.040	4,400	.192	.187
.219	.232	.226	.065	.011	.214	.048	5,700	.224	.219
.250	.264	.258	.066	.012	.245	.048	7,700	.256	.250
.312	.328	.321	.080	.014	.306	.062	11,500	.318	.312
.375	.392	.386	.095	.016	.368	.077	17,600	.382	.375
.438	.456	.448	.095	.017	.430	.077	20,000	.445	.437
.500	.521	.513	.110	.025	.485	.094	25,800	.510	.500

REQUIREMENTS:

1. MATERIAL: STEEL, CARBON, GRADES 1070 THRU 1095 (UNS G10700 THRU G10950) IN ACCORDANCE WITH PROCUREMENT SPECIFICATION.
STEEL, CORROSION-RESISTANT, TYPES 410 (UNS S41000) AND 420 (UNS S42000) IN ACCORDANCE WITH PROCUREMENT SPECIFICATION.
2. SURFACE ROUGHNESS: SURFACE ROUGHNESS SHALL BE IN ACCORDANCE WITH ANSI B46.1 BEFORE MEETING PROTECTIVE COATING AND SURFACE TREATMENT REQUIREMENT.
3. PROTECTIVE COATING AND SURFACE TREATMENT:
CARBON STEEL-CADMIUM PLATED IN ACCORDANCE WITH QQ-P-416, TYPE II, CLASS 2.
PHOSPHATE COATED IN ACCORDANCE WITH DOD-P-16232, TYPE 2, CLASS 2.
CORROSION-RESISTANT STEEL-CLEANED, DESCALED AND PASSIVATED IN ACCORDANCE WITH ASTM A380.
4. HARDNESS: CARBON STEEL-46 TO 53 HRC.
CORROSION-RESISTANT STEEL-43 TO 52 HRC.
5. PART NUMBER: THE PART NUMBER SHALL CONSIST OF THE BASIC MS NUMBER FOLLOWED BY A DASH NUMBER FROM TABLE II.
EXAMPLE: MS16562-1

MS16562-1 = PIN, SPRING-TUBULAR, SLOTTED, .062 NOMINAL SIZE, .188 LENGTH, CARBON STEEL, CADMIUM PLATED.

© ENTIRE STANDARD REVISED

P.A. AR Other Cust 06 99	TITLE PIN, SPRING - TUBULAR, SLOTTED	MILITARY STANDARD MS16562
PROCUREMENT SPECIFICATION MIL-P-10971	SUPERSEDES:	PAGE 1 OF 4

FED. SUP CLASS
5315

NOTES:-

1. ALL DIMENSIONS ARE IN INCHES.
2. IN THE EVENT OF A CONFLICT BETWEEN THE TEXT OF THIS STANDARD AND THE REFERENCES CITED HEREIN, THE TEXT OF THIS STANDARD SHALL TAKE PRECEDENCE.
3. REFERENCED GOVERNMENT (OR NONGOVERNMENT) DOCUMENTS OF THE ISSUE LISTED IN THAT ISSUE OF THE DEPARTMENT OF DEFENSE INDEX OF SPECIFICATIONS AND STANDARDS (DoDISS) SPECIFIED IN THE SOLICITATION FORM A PART OF THIS STANDARD TO THE EXTENT SPECIFIED HEREIN.

User activities:
MC, SHReview activities:
ARMY - AV, ME, MI
DLA - JS
NSA-NS

This military standard is approved by the Department of Defense and is mandatory on all activities. Selection for all new engineering and design applications and for repetitive use shall be made from this document.

APPROVED
REVISED
© FOR CHANGES SEE PAGES 1, 2, 3 AND 4

P.A. AR	TITLE	MILITARY STANDARD
Other Cust OS 99	P.IN, SPRING-TUBULAR, SLOTTED	MS16562
PROCUREMENT SPECIFICATION	SUPERSEDES:	PAGE 2 OF 4

DD FORM 672-1 (Coordinated)
1 SEP 87

PREVIOUS EDITIONS OF THIS FORM ARE OBSOLETE.

5315-0419

User activities:
MC, SHReview activities:
ARMY - AV, ME, MI
DLA - IS
NSA - NS

This military standard is approved for use by all Departments & Agencies of the Department of Defense. Selection for all new engineering and design applications and for repetitive use shall be made from this document, when applicable.

TABLE II					FED. SUP CLASS 5315				
L LENGTH	TOL	CARBON STEEL		CORROSION RESISTANT STEEL	L LENGTH	TOL	CARBON STEEL		CORROSION- RESISTANT STEEL
		CADMIUM PLATED	PHOSPHATE COATED				CADMIUM PLATED	PHOSPHATE COATED	
		DASH NO.	DASH NO.				DASH NO.	DASH NO.	
.062 NOMINAL SIZE					.168 NOMINAL SIZE				
.188	±.015	1	95	189	.500	±.015	46	140	234
.250		2	96	190	.625		47	141	235
.312		3	97	191	.750		48	142	236
.375		4	98	192	.875		49	143	237
.438		5	99	193	1.000		50	144	238
.500		6	100	194	1.250	51	145	239	
.562		7	101	195	1.500	52	146	240	
.625		8	102	196	1.750	53	147	241	
.688		9	103	197					
.750		10	104	198					
.078 NOMINAL SIZE					.219 NOMINAL SIZE				
.250	±.015	11	105	199	.750	±.015	54	148	242
.312		12	106	200	.875		55	149	243
.375		13	107	201	1.000		56	150	244
.438		14	108	202	1.250		57	151	245
.500		15	109	203	1.500		58	152	246
.562		16	110	204	1.750	59	153	247	
.625		17	111	205	2.000	60	154	248	
.750		18	112	206	2.500	61	155	249	
.875		19	113	207					
1.000		20	114	208					
.094 NOMINAL SIZE					.250 NOMINAL SIZE				
.250	±.015	21	115	209	.750	±.015	62	156	250
.312		22	116	210	.875		63	157	251
.375		23	117	211	1.000		64	158	252
.438		24	118	212	1.250		65	159	253
.500		25	119	213	1.500		66	160	254
.562		26	120	214	1.750	67	161	255	
.625		27	121	215	2.000	68	162	256	
.750		28	122	216	2.500	69	163	257	
.875		29	123	217					
1.000		30	124	218					
.125 NOMINAL SIZE					.312 NOMINAL SIZE				
.375	±.015	31	125	219	1.000	±.015	70	164	258
.438		32	126	220	1.250		71	165	259
.500		33	127	221	1.500		72	166	260
.562		34	128	222	1.750		73	167	261
.625		35	129	223	2.000		74	168	262
.750		36	130	224	2.500	75	169	263	
.875		37	131	225	3.000	76	170	264	
1.000		38	132	226					
1.250		39	133	227					
.156 NOMINAL SIZE					.375 NOMINAL SIZE				
.500	±.015	40	134	228	1.000	±.015	77	171	265
.625		41	135	229	1.250		78	172	266
.750		42	136	230	1.500		79	173	267
.875		43	137	231	1.750		80	174	268
1.000		44	138	232	2.000		81	175	269
1.250		45	139	233	2.500	82	176	270	
					3.000	83	177	271	

(C) FOR CHANGES SEE PAGES 1, 2, 3 AND 4

APPROVED 24 JUL 1959

P.A. AR Other Cust OS 99	TITLE PIN, SPRING - TUBULAR, SLOTTED	MILITARY STANDARD MS16562
PROCUREMENT SPECIFICATION MIL-P-10971	SUPERSEDES:	PAGE 3 OF 4

FED. SUP CLASS
6315

TABLE II. (Continued)

L LENGTH	TOL	CARBON STEEL		CORROSION RESISTANT STEEL
		CADMIUM PLATED	PHOSPHATE COATED	
		DASH NO.	DASH NO.	DASH NO.
. 438 NOMINAL SIZE				
1.250	±.020	84	178	272
1.500		85	179	273
1.750		86	180	274
2.000		87	181	275
2.500	±.025	88	182	276
3.000		89	183	277
. 500 NOMINAL SIZE				
1.500	±.020	90	184	278
1.750		91	185	279
2.000		92	186	280
2.500		93	187	281
3.000	±.025	94	188	282

User activities:
MC, SHReview activities:
ARMY - AV, ME, MI
DLA - /S
NSA - NS

This military standard is approved for use by all Departments & Agencies of the Department of Defense. Selection for all new engineering and design applications and for repetitive use shall be made from this document, when applicable.

APPROVED 24 JUL 1959 (C) FOR CHANGES SEE PAGES 1, 2, 3 AND 4

P.A. AR Other Cust OS 99	TITLE PIN, SPRING - TUBULAR, SLOTTED	MILITARY STANDARD MS16562
PROCUREMENT SPECIFICATION MIL-P-10971	SUPERSEDES.	PAGE 4 OF 4

DD FORM 1 MAR 7, 672-1 (Coordinated)

PREVIOUS EDITIONS OF THIS FORM ARE OBSOLETE.

5315-0419 PLATE NO. 23085