

INCH-POUND

MS14308C
15 December 2009
SUPERSEDING
MS14308B
28 February 1994

DETAIL SPECIFICATION SHEET

ELBOWS, PIPE, BRASS OR BRONZE, THREADED,
90-DEG., REDUCING, CLASS 125

This specification is approved for use by all Departments and
Agencies of the Department of Defense.

The requirements for acquiring the product described herein shall consist of this specification sheet and WW-P-460.

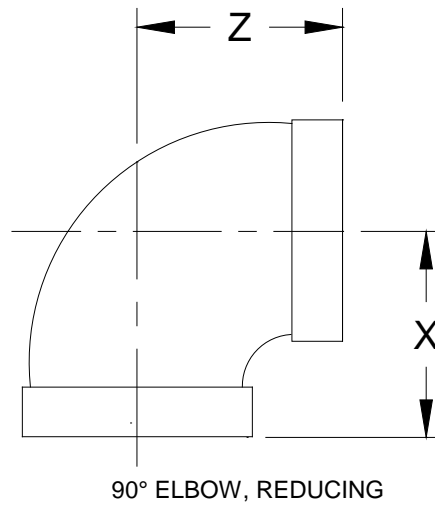

FIGURE 1. Reducing elbow fitting.

MS14308C

Dash number to pipe size.

Dash number	Pipe size		mm
- 1	1/4 X 1/8	(.250 X .125)	6.35 X 3.18
- 2	3/8 X 1/4	(.375 X .250)	9.53 X 6.35
- 3	1/2 X 3/8	(.500 X .375)	12.70 X 9.53
- 4	3/4 X 1/2	(.750 X .500)	19.05 X 12.70
- 5	1 X 3/4	(1.000 X .750)	25.40 X 19.05
- 6	1 X 1/2	(1.000 X .500)	25.40 X 12.70
- 7	1-1/4 X 1	(1.250 X 1.000)	31.75 X 25.40
- 8	1-1/4 X 3/4	(1.250 X .750)	31.75 X 19.05
- 9	1-1/2 X 1-1/4	(1.500 X 1.250)	38.10 X 31.75
- 10	1-1/2 X 1	(1.500 X 1.000)	38.10 X 25.40
- 11	2 X 1-1/2	(2.000 X 1.500)	50.80 X 38.10
- 12	2-1/2 X 2	(2.500 X 2.000)	63.50 X 50.80
- 13	3 X 2-1/2	(3.000 X 2.500)	76.20 X 63.50
- 14	4 X 3	(4.000 X 3.000)	101.60 X 76.20

NOTES:

1. Dimensions are in inches.
2. Metric equivalents are given for information only.
3. Material: Brass or bronze in accordance with ASME-B16.15.
4. Protective Coating: None
5. Dimensions: In accordance with ASME-B16.15, table titled "Dimensions of 90-deg Elbows (Reducing Sizes) – Class 125".
6. Thread: As specified in ASME-B16.15.
7. Marking: In accordance with ASME-B16.15.
8. Part or Identifying Number (PIN): The MS PIN consists of the MS number, the dash number, and the fitting Identification letter(s). When left-hand threads are required, add the letter "L" to the PIN.

FIGURE 1. Reducing elbow fitting – Continued.

PIN:

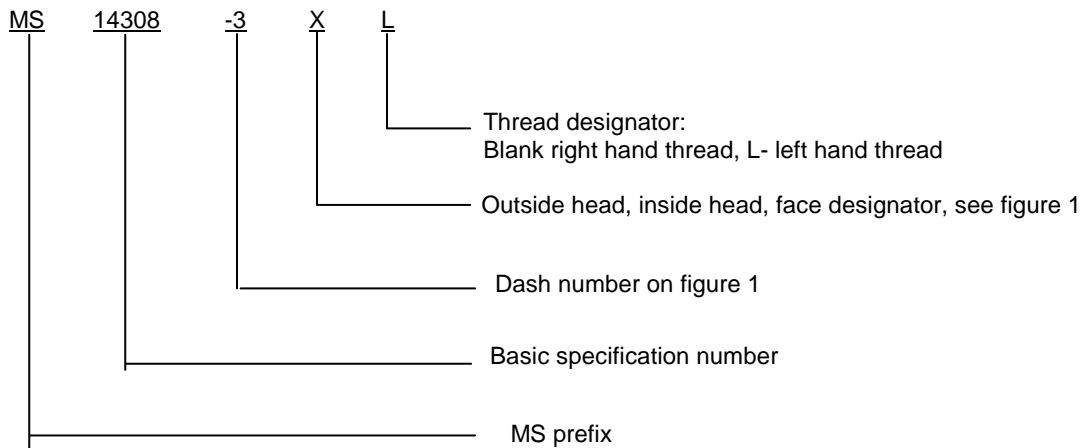

Examples:

MS14308 - 4 represents a 3/4 NPS X 1/2 NPS 90° reducing elbow.

MS14308 - 7L represents a 1-1/4 NPS X 1 NPS° reducing elbow left-hand threads.

MS14308C

Changes from previous issue. Marginal notations are not used in this revision to identify changes with respect to the previous issue, due to the extent of the changes.

Referenced documents. In addition to WW-P-460, this document references the following:

ASME-B16.15

CONCLUDING MATERIAL

Custodians:

Army - AT
Navy - MC
Air Force - 99
DLA - CC

Preparing activity:

DLA - CC

(Project 4730-2009-006)

Review activities:

Army - AR, CE, EA
Navy - SA, SH, YD
Air Force - 71

NOTE: The activities listed above were interested in this document as of the date of this document. Since organizations and responsibilities can change, you should verify the currency of the information above using the ASSIST Online database at <http://assist.daps.dla.mil>