

NOTES: When Government drawings, specifications, or other data are used for any purpose other than in connection with a definitely related Government procurement operation, the United States Government thereby incurs no obligation, and no liability, for any such use. The Government makes no warranty, expressed or implied, for any such use. The Government shall not be responsible for any such use. The Government shall not be responsible for any such use. The Government shall not be responsible for any such use.

MS122900
THRU
MS122939

FED. SUP CLASS
5340

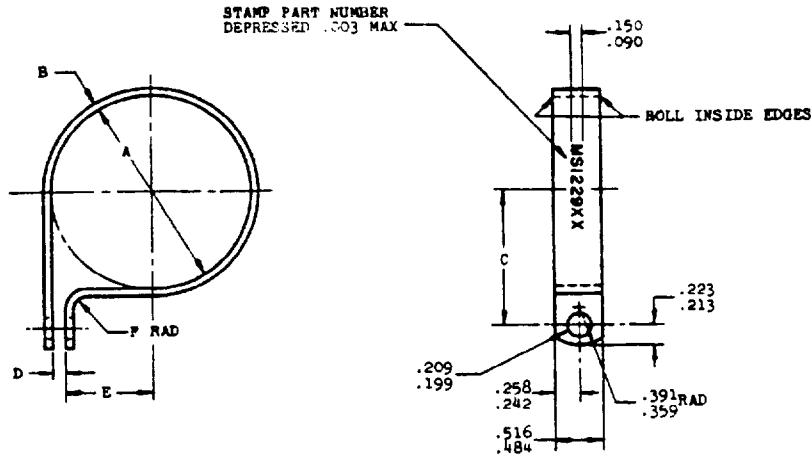

NOM TUBE OD	A DIA BASIC	B ±.005	C ±.010	D	E REF	F RAD ±.016	APPROX WEIGHT LBS. EA.	PART NUMBERS
.125	.125	.031	.360	.062-.078	0	.062	.0055	MS122900
.188	.188	.031	.423	.062-.078	.031	.062	.0066	MS122901
.250	.250	.031	.457	.062-.078	.062	.062	.0075	MS122902
.312	.312	.031	.498	.062-.078	.094	.062	.0085	MS122903
.375	.375	.031	.529	.062-.078	.125	.062	.0094	MS122904
.438	.438	.031	.560	.062-.078	.156	.062	.0103	MS122905
.500	.500	.031	.592	.062-.078	.188	.062	.0112	MS122906
.562	.562	.031	.623	.062-.078	.219	.062	.0122	MS122907
.625	.625	.031	.654	.062-.078	.250	.062	.0131	MS122908
.688	.688	.051	.752	.062-.078	.281	.109	.0237	MS122909
.750	.750	.051	.783	.062-.078	.312	.109	.0252	MS122910
.812	.812	.051	.814	.062-.078	.344	.109	.0267	MS122911
.875	.875	.051	.845	.062-.078	.375	.109	.0283	MS122912
.938	.938	.051	.877	.062-.078	.406	.109	.0298	MS122913
1.000	1.000	.051	.908	.062-.078	.438	.109	.0313	MS122914
1.062	1.062	.051	.939	.062-.078	.469	.109	.0331	MS122915
1.125	1.125	.051	.970	.062-.078	.500	.109	.0343	MS122916
1.188	1.188	.051	1.002	.062-.078	.531	.109	.0359	MS122917
1.250	1.250	.064	1.062	.094-.110	.531	.125	.0471	MS122918
1.312	1.312	.064	1.093	.094-.110	.562	.125	.0490	MS122919
1.375	1.375	.064	1.125	.094-.110	.594	.125	.0509	MS122920
1.438	1.438	.064	1.156	.094-.110	.625	.125	.0528	MS122921
1.500	1.500	.064	1.188	.094-.110	.656	.125	.0547	MS122922
1.562	1.562	.064	1.219	.094-.110	.688	.125	.0566	MS122923
1.625	1.625	.064	1.250	.094-.110	.719	.125	.0585	MS122924
1.750	1.750	.064	1.312	.094-.125	.781	.125	.0623	MS122925
1.875	1.875	.064	1.375	.094-.125	.844	.125	.0661	MS122926
2.000	2.000	.064	1.438	.094-.125	.906	.125	.0696	MS122927

MATERIAL: CORROSION RESISTANT STEEL AMS5510.

REMOVE BURRS AND SHARP EDGES.

DIMENSIONS IN INCHES.

CLAMP SHALL BE FORMED AS SHOWN. DIMENSION "D" SHALL FALL WITHIN THE SPECIFIED LIMITS WHEN CLAMP

IS ASSEMBLED ON A BAR THE DIA OF WHICH IS EQUAL TO THE NOMINAL TUBE OD WITHIN ±.001.

HOLES SHALL BE IN ALIGNMENT WITHIN .010 AND CLAMP SHALL BE FLAT WITHIN .010 THRU CLAMP WIDTH

WHEN ASSEMBLED ON TEST BAR. IN THE FREE POSITION CLAMP MAY SPRING OPEN PROVIDED THE

ABOVE CONDITIONS ARE MET.

DO NOT USE UNASSIGNED PART NUMBERS.

AMS IS A SOCIETY OF AUTOMOTIVE ENGINEERS, INC. PUBLICATION.

MILITARY STANDARD WAS DEVELOPED COOPERATIVELY WITH THE MILITARY SERVICES BY THE SAE AEROSPACE PROPOSITION DIVISION

ENGINEERING P.A. USAP - 11

Navy - A3

Army - A7

PROPOSED SPECIFICATION
NONE

MILITARY STANDARD

CLAMP - LOOP TYPE SUPPORT (HEAT RESISTANT).204 HOLE

MS122900

THRU

MS122939

SHEET 1 OF 1

MS FORM
1 097 56 233

APPROVED 24 Mar 53 REVISED 5 Jul 56 15 May 68