

NOTICE: These Government drawings, specifications, or other data are used for any purpose other than in connection with a definitely related Government procurement operation, the United States Government thereby incurs no responsibility, nor any obligation whatsoever; and the fact that the Government may have furnished, furnished, or in any way supplied the said drawings, specifications, or other data is not to be regarded by implication or otherwise as in any manner endorsing the holder or any other person or corporation, or constituting any rights or privileges of the holder or any other person or corporation.

MS122026(ASG)
THRU
MS122075(ASG)

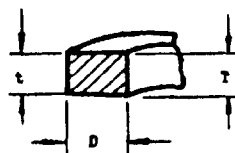

SECTION A-A

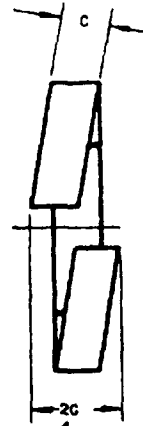
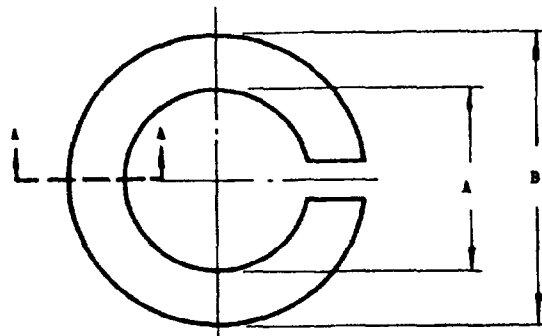

APPROX

NOMINAL SIZE	MEDIUM						LIGHT					
	A	B MAX	C (a)	D MIN	WT/M	PART NO.	A	B MAX	C (a)	D MIN	WT/M	PART NO.
.112	.115 - .124	.212	.025 - .031	.040	0.17	MS122026	.115 - .124	.202	.020 - .026	.035	0.12	MS122051
.125	.128 - .137	.239	.031 - .037	.047	0.27	MS122027	.128 - .137	.225	.025 - .031	.040	0.18	MS122052
.138	.141 - .151	.251	.031 - .037	.047	0.28	MS122028	.141 - .151	.237	.025 - .031	.040	0.19	MS122053
.164	.168 - .178	.296	.040 - .046	.055	0.50	MS122029	.168 - .178	.280	.031 - .037	.047	0.32	MS122054
.190	.194 - .205	.337	.047 - .053	.062	0.75	MS122030	.194 - .205	.323	.040 - .046	.055	0.56	MS122055
.216	.221 - .232	.380	.056 - .062	.070	1.12	MS122031	.221 - .232	.364	.047 - .053	.062	0.82	MS122056
.250	.255 - .267	.493	.062 - .072	.109	2.47	MS122032	.255 - .267	.489	.047 - .057	.107	1.87	MS122057
.3125	.319 - .333	.591	.078 - .088	.125	4.27	MS122033	.319 - .333	.575	.056 - .066	.117	2.88	MS122058
.375	.382 - .398	.688	.094 - .104	.141	6.75	MS122034	.382 - .398	.678	.070 - .080	.136	4.88	MS122059
.4375	.446 - .464	.784	.109 - .119	.156	9.44	MS122035	.446 - .464	.780	.085 - .095	.154	7.68	MS122060
.500	.509 - .529	.879	.125 - .135	.171	14.40	MS122036	.509 - .529	.877	.099 - .109	.170	11.03	MS122061
.5625	.573 - .595	.979	.141 - .151	.188	19.30	MS122037	.573 - .595	.975	.113 - .123	.186	15.30	MS122062
.625	.636 - .660	1.086	.156 - .166	.203	25.50	MS122038	.636 - .660	1.082	.126 - .136	.201	20.40	MS122063
.6875	.700 - .726	1.184	.172 - .192	.219	34.80	MS122039	.700 - .726	1.178	.138 - .158	.216	27.20	MS122064
.750	.763 - .791	1.279	.188 - .208	.234	42.80	MS122040	.763 - .791	1.277	.153 - .173	.233	35.70	MS122065
.8125	.827 - .857	1.377	.203 - .223	.250	52.80	MS122041	.827 - .857	1.375	.168 - .188	.249	44.20	MS122066
.875	.890 - .922	1.474	.219 - .239	.266	65.00	MS122042	.890 - .922	1.470	.179 - .199	.264	53.20	MS122067
.9375	.954 - .988	1.570	.234 - .254	.281	78.00	MS122043	.954 - .988	1.562	.191 - .211	.277	63.50	MS122068
1.000	1.017 - 1.053	1.672	.250 - .270	.297	93.80	MS122044	1.017 - 1.053	1.656	.202 - .222	.289	74.10	MS122069
① .086	.088 - .097	.175	.020 - .026	.035	0.10	MS122045	.088 - .097	.165	.015 - .021	.030	0.07	MS122070

MATERIAL: STEEL AMS 7240

FINISH - CADMIUM PLATE AMS 2400

(a) WASHER THICKNESS: NOMINAL MEAN THICKNESS IS SPECIFIED IN COLUMN C WHERE $C = \frac{T + t}{2}$. INCREASE IN

THICKNESS FROM OUTER PERIPHERY TO INNER PERIPHERY SHALL BE (T-t) MIN = .032D
(T-t) MAX = .064D

BREAK SHARP EDGES .003 - .015

DIMENSIONS IN INCHES.

DO NOT USE UNASSIGNED PART NUMBERS.

THIS STANDARD WAS DEVELOPED COOPERATIVELY WITH THE ENGINE AND PROPULSION UTILITY PARTS COMMITTEE OF THE SAE.

CUSTODIAN
Navy - BuAer
Air Force

PROCUREMENT SPECIFICATION
NONE

MILITARY STANDARD

WASHER - LOCK, SPRING

MS 122026(ASG)
THRU
122075(ASG)

SHEET 1 OF 1

APPROVED 9 Apr 53 REVISED 17 JUNE 57