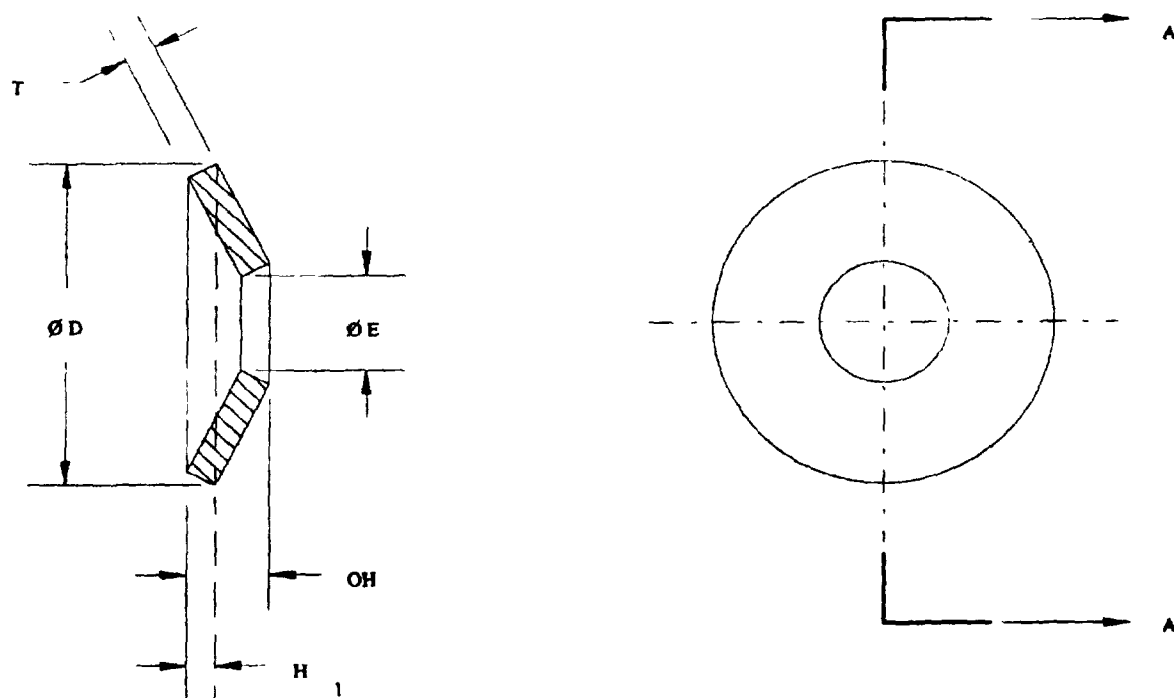

**INCH-POUND****MIL-W-12133/2B****17 JUNE 1994****SUPERSEDING****MIL-W-12133/2A****25 April 1986****MILITARY SPECIFICATION SHEET****WASHER, SPRING TENSION, BELLEVILLE SPRING,  
CORROSION RESISTANT STEEL**

This specification is approved for use by all Departments and Agencies of the Department of Defense. The complete requirements for acquiring the washers described herein shall consist of this specification and the latest issue of MIL-W-12133.

**SECTION A-A****NOTES**

- 1 All dimensions are in inches. See Table I herein for tabulated data.

**FIGURE 1 WASHER, SPRING TENSION, BELLEVILLE SPRING, CORROSION RESISTANT STEEL**

AMSC N/A

1 OF 3

FSC 5310

**DISTRIBUTION STATEMENT A.** Approved for public release, distribution is unlimited

## MIL-W-12133/2B

## REQUIREMENTS

1 **Material** Corrosion resistant steel (CRES), Type 301 (UNS S30100) Temper full hard or extra full hard, Type 302 (UNS S30200) Temper full hard as specified per AMS 5519 and AMS 5906, respectively, or CRES Type 17-7 PH (UNS S17700), Temper TH 1050 in accordance with MIL-S-25403 or AMS 5528

2 **Cleaning, descaling and passivation** Corrosion resistant steel washers shall be cleaned, descaled and passivated in accordance with ASTM A380

3 **Part number.** The part number consists of the letter "M", the basic number of this specification, followed by a dash number taken from table I

EXAMPLE M12133/2-1P

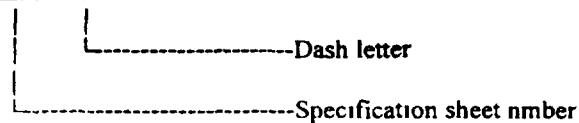

M12133/2-093 Indicates - Washer, Spring Tension, Belleville Spring, Corrosion Resistant Steel (CRES) Type 302 (UNS S30200) Temper full hard 187 OD, .093 ID, .010 thick, .015 free height

TABLE I DASH NUMBERS AND DIMENSIONS.

DASH NO	Ø D		Ø E		T THICKNESS		OH FREE HEIGHT	H I TEST DEFLECTION (REF)	LBS LOAD AT TEST DEFLECTION (LBS)	LOAD AT FLAT (LBS) REF HEIGHT (NOM)	BOL DIAMETER REF
	OD	TOL + .000	ID	TOL - .000	NOM	TOL	NOM				
093	187	- .020	093	+ .020	010	+/- .001	.015	002	15-18	27	094
125	250	- .020	125	+ .020	.013	+/- .001	020	003	22-27	45	125
156	312	- .020	156	+ .020	.017	+/- .001	025	.004	34-49	77	.156
190	375	- .020	190	+ .020	020	+/- .001	030	005	50-72	110	188
200	.375	- .020	190	+ .020	015	+/- .001	027	006	33-45	55	188
255	.500	- .030	255	+ .030	.025	+/- .001	038	007	80-109	157	.250
400	625	- .030	317	+ .030	022	+/- .002	042	010	56-85	104	.313
317	625	- .030	317	+ .030	032	+/- .002	048	008	123-175	259	313
380	750	- .035	380	+ .035	040	+/- .002	059	010	210-281	418	375
505	1 000	- .035	.505	+ .035	.050	+/- .002	075	013	308-428	596	.500
567	1.125	- .035	.567	+ .035	056	+/- .002	084	014	374-499	745	563
630	1.250	- .040	630	+ .040	.062	+/- .002	092	015	440-582	876	625
755	1 500	- .040	755	+ .040	045	+/- .002	093	024	239-301	367	750
100	2 000	- .040	1 000	+ .040	065	+/- .002	130	032	547-651	842	1 000
900	2 500	- .040	1 250	+ .040	125	+/- .005	180	030	1683-2161	3268	1 250

1 All dimensions are in inches See Table I herein for tabulated data

**MIL-W-12133/2B**

**Custodians**

**Army - AR**

**Navy - OS**

**Air Force - 99**

**Preparing Activity**

**DLA - IS**

**Review Activities**

**Army - ER, MI, AT, CR, ME, MI**

**Navy - AS, MC, YD**

**Air Force - 11, 82**

**(Project 5310-1892)**