

INCH-POUND

MIL-S-24235/5A(SH)

21 August 1989

SUPERSEDING

MIL-S-24235/5(SHIPS)

18 July 1967

MILITARY SPECIFICATION SHEET

STUFFING TUBES, METAL, AND PACKING ASSEMBLIES FOR
ELECTRIC CABLES, BALLAST TANK

This specification is approved for use by the Naval Sea Systems Command, Department of the Navy, and is available for use by all Departments and Agencies of the Department of Defense.

The requirements for acquiring the product described herein shall consist of this specification sheet and the issue of the following specification listed in that issue of the Department of Defense Index of Specifications and Standards (DODISS) specified in the solicitation: MIL-S-24235.

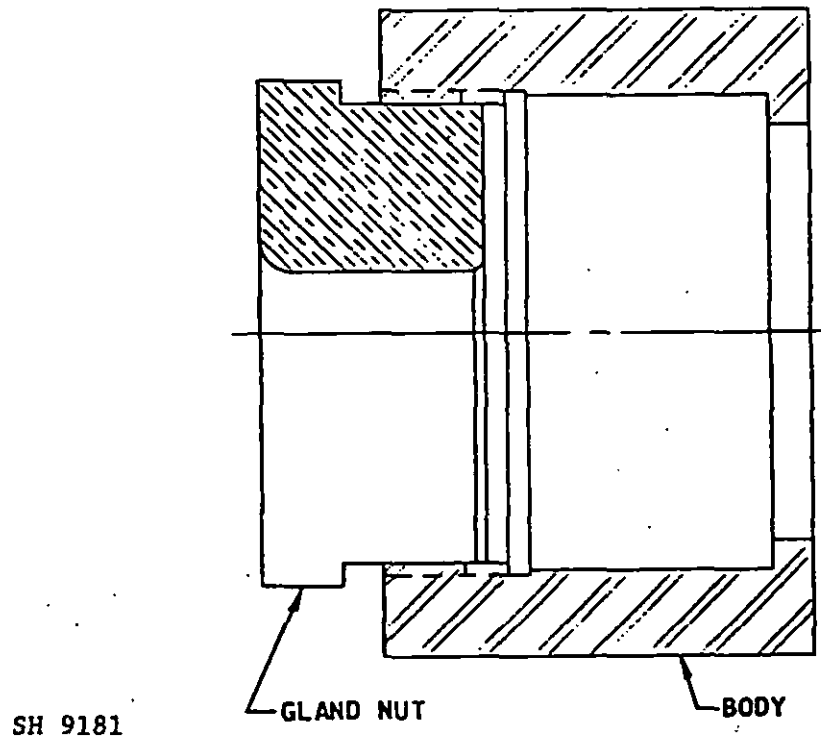
FIGURE 1. Stuffing tube assembly. (01)

NOTES:

1. Dimensions are in inches.
2. Unless otherwise specified, tolerances shall be as follows:
 Decimals - plus or minus 0.005 inch.
 Fractions - plus or minus 1/64 inch.
 Angular dimensions - plus or minus 30 minutes.

AMSC N/A

FSC 5975

DISTRIBUTION STATEMENT A. Approved for public release; distribution is unlimited.

MIL-S-24235/5A(SH)

TABLE I. Part or identifying numbers.

Symbol number	Assembly part or identifying number	Part or identifying numbers of components	
		Body 1 required	Gland nut 1 required
2425	M24235/5-001	M24235/5-011	M24235/5-021
2425.1	M24235/5-002	M24235/5-012	M24235/5-022
2425.2	M24235/5-003	M24235/5-012	M24235/5-022

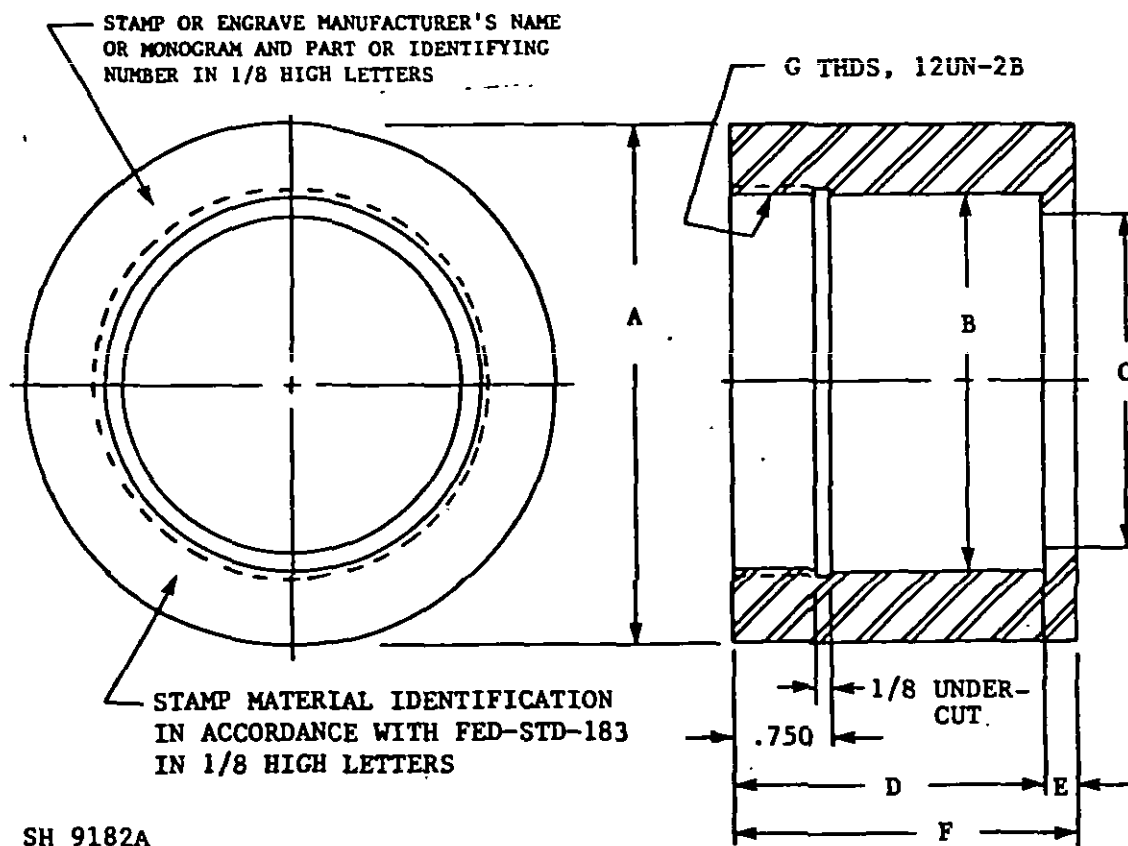
FIGURE 2. Body configuration. (02)TABLE II. Body dimensions.

Part or identifying number	A DIA	B DIA	C DIA	D	E	F	G THDS
M24235/5-011	3-1/2	2.415	2.062	2.000	3/16	2-3/16	2.500
M24235/5-012	4	2.915	2.562	2.375	1/4	2-5/8	3.000

MIL-S-24235/5A(SH)

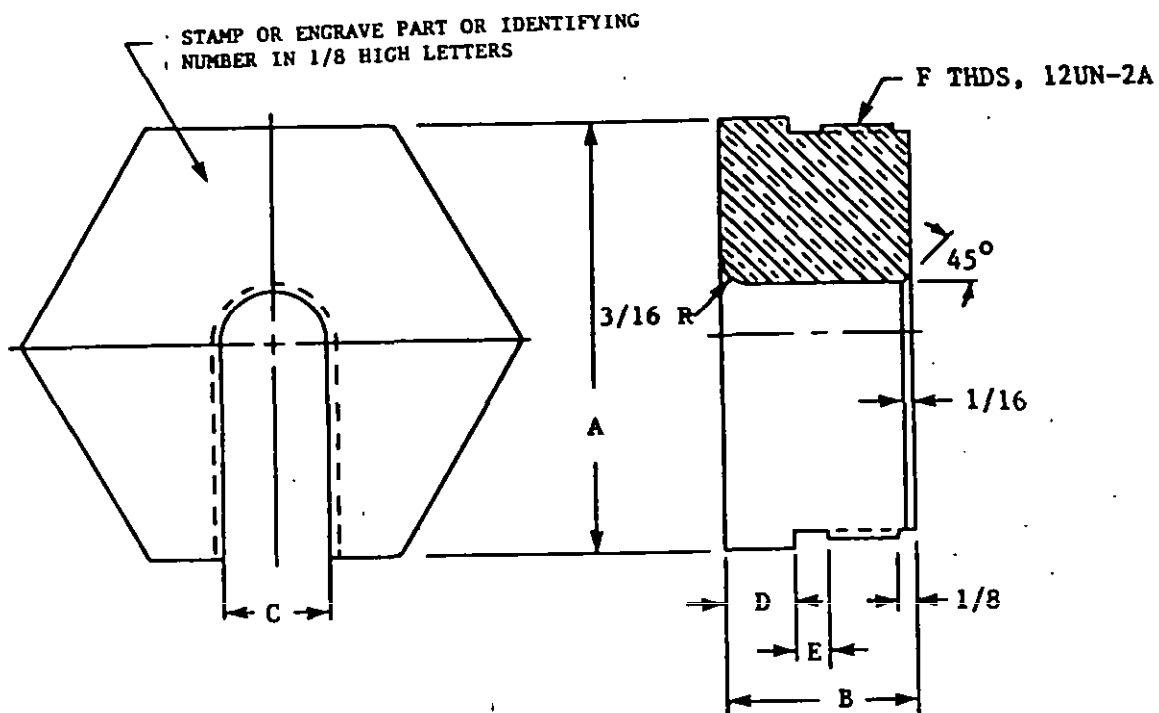

SH 9183A

FIGURE 3. Gland nut configuration. (03)

TABLE III. Gland nut dimensions.

Part or identifying number	A	B	C	D	E	F THDS
M24235/5-021	2-3/4	1-1/4	5/8	3/8	3/16	2.500
M24235/5-022	3-1/8	1-3/8	3/4	1/2	1/4	3.000

MIL-S-24235/5A(SH)

REQUIREMENTS:

1. Stuffing tubes are designed to accept a single 1/2 or 5/8 inch diameter cable with a molded plug in accordance with DOD-STD-2003, section 3.
2. Packing assemblies: For information only, not furnished with stuffing tube.

TABLE IV. Packing assemblies.

Symbol number	Stuffing tube part or identifying number	Packing assembly part or identifying number	Molded plug MIL-C-24231 symbol number
2425	M24235/5-001	M24235/6-001	713
2425.1	M24235/5-002	M24235/6-002	713.1
2425.2	M24235/5-002	M24235/6-003	713.1

3. Intended use: Single electric cable penetration of submarine ballast tank bulkheads.
4. Application: See DOD-STD-2003, section 3.

TABLE V. Parts list.

Item no.	Description ^{1/}	Qty ^{2/}	Material and specification	Remarks
01	Stuffing tube assemblies	-	--	See figure 1 and table I
02	Tube body	1	CRES, type 316L, condition A, ^{3/} QQ-S-763	See figure 2 and table II
03	Gland nut	1	Aluminum bronze, QQ-C-465 or MIL-B-24480	See figure 3 and table III

- ^{1/} See applicable figure and table listed in "Remarks" column for part numbers and dimensions.
- ^{2/} Quantity is for one complete assembly of each size.
- ^{3/} May be of another material when specified in the contract or order (see MIL-S-24235).

MIL-S-24235/5A(SH)

The previous issue of this specification sheet replaced that part of Drawing, NAVSEA No. 815-1197090 covering stuffing tubes.

Revision letters are not used to denote changes due to the extensiveness of the changes.

Preparing activity:
Navy - SH
(Project 5975-N626-5)