

INCH-POUND

MIL-R-24243/2C

22 June 1994

SUPERSEDING

MIL-R-24243/2B

21 September 1987

## MILITARY SPECIFICATION SHEET

RIVETS, BLIND, NONSTRUCTURAL, RETAINED MANDREL,  
OPEN-END, DOMED HEAD, NICKEL-COPPER ALLOY

This specification is approved for use by all Departments and Agencies of the Department of Defense.

The requirements for acquiring the retained mandrel, nonstructural, blind rivets described herein shall consist of this specification and the latest issue of MIL-R-24243.

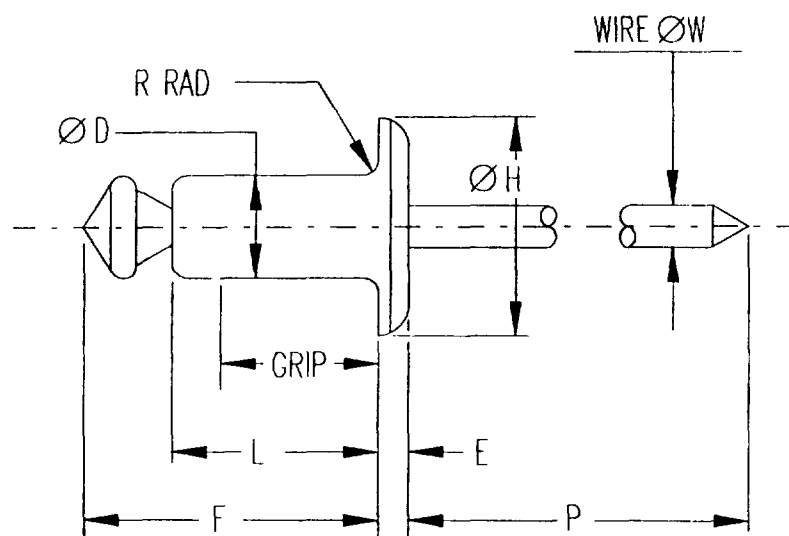

## NOTES:

1. All dimensions are in inches.

FIGURE 1. RIVETS

## REQUIREMENTS:

1. Material. Blind rivets shall be furnished in the following material combinations and dimensions.

AMSC N/A

FSC 5320

DISTRIBUTION STATEMENT A. Approved for public release; distribution is unlimited.

## MIL-R-24243/2C

TABLE I. MATERIAL COMBINATION SYMBOLS

SYMBOL	COMBINATION	
	BODY	MANDREL
E	Nickel-Copper Alloy (UNS N04400)	1030-1060 Steel (UNS G10300-G10600)

TABLE II. BASIC DIMENSIONS

NOM DIA	BASIC DIMENSIONS							RECOMMENDE D HOLE SIZE
	ØD	H	E	R MAX	W NOM	F MAX	P MIN	
.125	.128 .122	.262 .238	.040 .030	.020	.076	L MAX +.120	1.00	.129-.133
.156	.159 .153	.328 .296	.050 .037	.020	.095	L MAX +.140	1.00	.160-.164
.188	.191 .183	.394 .356	.060 .045	.035	.114	L MAX +.160	1.00	.192-.196
.250	.255 .246	.525 .475	.080 .065	.060	.151	L MAX +.180	1.00	.257-.261

2. Part Number. The part number shall consist of the letter "M", the basic number of this specification sheet, followed by a dash number consisting of a material combination symbol, a nominal body diameter size code in thirty-seconds of an inch, and a maximum grip code in sixteenths of an inch taken from Table III.

EXAMPLE: M24243/2 E 4 02

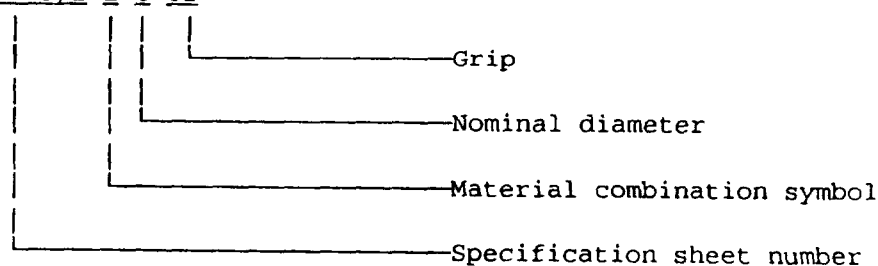

M24243/2E402 Indicates - Rivet, blind, nonstructural, retained mandrel, open-end, domed head, nickel-copper (UNS N04400) alloy body, 1030-1060 (UNS G10300-G10600) steel mandrel; nominal body diameter size, .125; grip range, .063-.125.

3. Changes from previous issues. Asterisks are not used in this revision to identify changes with respect to the previous issue due to the extensiveness of the changes.

## MIL-R-24243/2C

TABLE III. DASH NUMBERS AND DIMENSIONS

DASH NUMBER	L	RECOMMENDED GRIP RANGE
E401	.182-.212	.020-.062
E402	.245-.275	.063-.125
E403	.308-.337	.126-.187
E404	.370-.400	.188-.250
E502	.270-.300	.020-.125
E503	.332-.362	.126-.187
E504	.395-.425	.188-.250
E602	.295-.325	.020-.125
E604	.420-.450	.188-.250
E606	.545-.575	.251-.375
E608	.670-.700	.376-.500
E804	.470-.500	.126-.250
E808	.720-.750	.375-.500

## Custodians:

Army - AR

Navy - AS

Air Force - 99

## Preparing Activity:

DLA-IS

## Review Activities:

Army - AV, MI

Air Force - 82

National Security Agency - NS

(Project 5320-0809-02)