

MIL-P-21143/2
20 June 1984

MILITARY SPECIFICATION SHEET

PIN, STRAIGHT, HEADLESS, (DOWEL) (.0002 UNDER SIZE), CRES 303

This specification is approved for use by all Departments and Agencies of the Department of Defense.

The complete requirements for acquiring the pins described herein shall consist of this specification and the latest issue of MIL-P-21143.

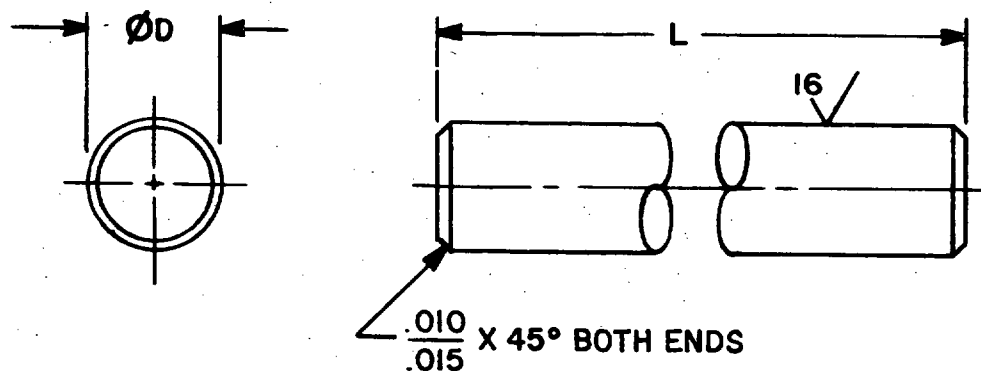

NOTES:

1. All dimensions are in inches.

FIGURE 1. PIN, STRAIGHT, HEADLESS, (DOWEL) (.0002 UNDER SIZE), CRES 303

MIL-P-21143/2

REQUIREMENTS:

1. Material. CRES, Type 303 (UNS S30300) as specified in ASTM A582.
2. Cleaning, descaling and passivation. The pins shall be cleaned, descaled and passivated in accordance with ASTM A380.
3. Part number. The part number consists of the letter "M", the basic number of this specification sheet and a dash number taken from Table I.

Example: M21143/2-32

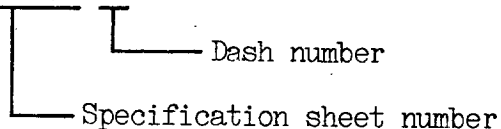

M21143/2-32 = Pin, straight, headless, (dowel) (.0002 under size),
CRES, Type 303 (UNS S30300) length .750, diameter .0625.

MIL-P-21143/2

TABLE I. DASH NUMBERS AND DIMENSIONS.

L Length ±.010	$\varnothing D$ +.0000 −.0002							
	.0313	.0625	.0938	.1250	.1562	.1875	.2188	.2500
	DASH NUMBERS							
.093	1	21	41	61	—	—	—	—
.125	2	22	42	62	—	—	—	—
.156	3	23	43	63	—	—	—	—
.187	4	24	44	64	84	—	—	—
.218	5	25	45	65	85	—	—	—
.250	6	26	46	66	86	106	—	—
.312	7	27	47	67	87	107	127	—
.375	8	28	48	68	88	108	128	148
.437	9	29	49	69	89	109	129	149
.500	10	30	50	70	90	110	130	150
.625	11	31	51	71	91	111	131	151
.750	12	32	52	72	—	112	132	152
.875	13	33	53	73	—	—	133	153
1.000	—	—	—	—	—	—	—	154
1.125	—	—	—	—	—	—	—	—
1.250	—	—	—	—	—	—	—	—

MIL-P-21143/2

Custodians:

Army - AR
Navy - OS
Air Force - 99

Preparing activity:

Army - AR

(Project 5315-0374)

Review activities:

Army - EA, ER, MI
DLA - IS

User activities:

Army - CE, GL
Navy - MC, YD

Agent:

DLA-IS